

RECORD OF SURVEY

IN THE NW 1/4 & NE 1/4 OF THE NW 1/4 AND THE NW 1/4 & NE 1/4 OF THE NE 1/4 OF SECTION 6, T2N, R5E, W.M. SKAMANIA COUNTY, WA

- LEGEND:**
- INDICATES MONUMENT FOUND AS NOTED
 - () INDICATES RECORD INFORMATION PER ROS 15-152
 - / — INDICATES LINE MARKED WITH 1/2" x 72" FIBER GLASS RODS WITH BLUE AND ORANGE RIBBON. TREES ALONG LINE PAINTED AND BLAZED WITH ORANGE PAINT.
- ROS RECORD OF SURVEY

SURVEY REFERENCE
1) ROS 15-152

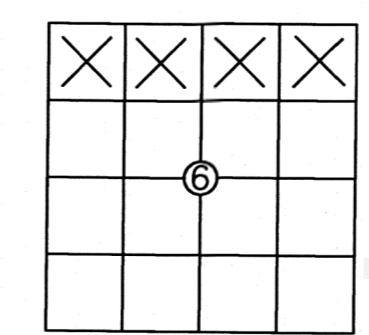

SECTION DIAGRAM
NOT TO SCALE

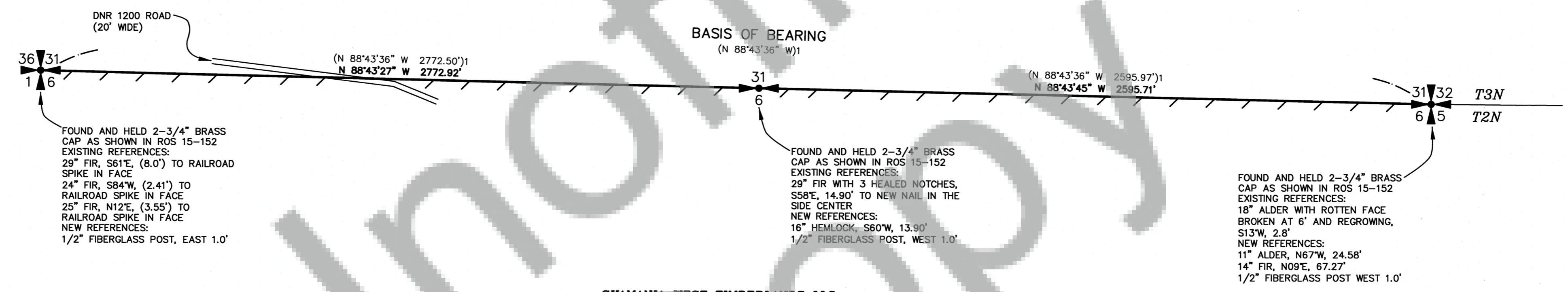
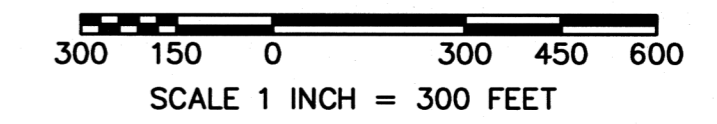
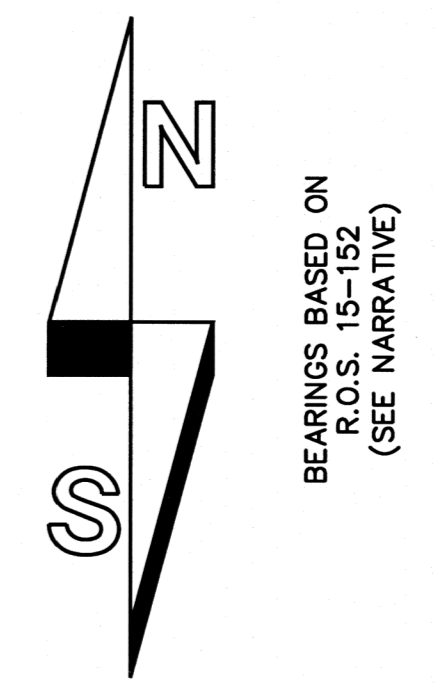

FOUND AND HELD 2-3/4" BRASS CAP AS SHOWN IN ROS 15-152 EXISTING REFERENCES:
29" FIR, S61°E, (8.0') TO RAILROAD SPIKE IN FACE
24" FIR, S84°W, (2.41') TO RAILROAD SPIKE IN FACE
25" FIR, N12°E, (3.55') TO RAILROAD SPIKE IN FACE
NEW REFERENCES:
1/2" FIBERGLASS POST, EAST 1.0'

FOUND AND HELD 2-3/4" BRASS CAP AS SHOWN IN ROS 15-152 EXISTING REFERENCES:
29" FIR WITH 3 HEALED NOTCHES, S58°E, 14.90' TO NEW NAIL IN THE SIDE CENTER
NEW REFERENCES:
16" HEMLOCK, S60°W, 13.90'
1/2" FIBERGLASS POST, WEST 1.0'

FOUND AND HELD 2-3/4" BRASS CAP AS SHOWN IN ROS 15-152 EXISTING REFERENCES:
18" ALDER WITH ROTTEN FACE BROKEN AT 6' AND REGROWING, S13°W, 2.8'
NEW REFERENCES:
11" ALDER, N67°W, 24.58'
14" FIR, N09°E, 67.27'
1/2" FIBERGLASS POST WEST 1.0'

SKAMANIA WEST TIMBERLANDS LLC
AFN 2025-000081

DEED REFERENCE
BARGAIN SALE DEED
WEYERHAEUSER TIMBER HOLDINGS, INC.
TO
SKAMANIA WEST TIMBERLANDS LLC
AFN 2025-000081
(01/15/2025)

NARRATIVE
THE PURPOSE OF THIS SURVEY WAS TO POST THAT PORTION OF LINE SHOWN AS MARKED FOR THE "SKAMANIA TIMBERLANDS LLC TRACT" CITED FOR FUTURE TIMBER HARVEST. A RANDOM CONTROL TRAVERSE WAS RAN BETWEEN THE NORTHEAST SECTION CORNER FOR SECTION 6 AND THE NORTHWEST SECTION CORNER OF SECTION 6. THE TRAVERSE WAS THEN ROTATED TO THE RECORD BEARING OF N 88° 43' 36" W AS SHOWN IN ROS 15-152 WHICH WAS THE BASIS OF BEARING FOR THIS SURVEY. A CLOSED LOOP TRAVERSE WAS THEN RAN ALONG THE LINES SHOWN AS MARKED. NO NEW CORNERS WERE SET DURING THIS SURVEY.

REFERENCE TREE NOTE
NEW REFERENCE TREES WERE MEASURED TO A 6" NAIL SET IN SIDE CENTER OF TREE. ALSO PLACED A BEARING TREE SIGN AND 4 NOTCHES FACING TOWARD THE CORNER. BEARINGS WERE TAKEN WITH A HAND HELD COMPASS WITH DECLINATION SET TO 16° EAST.

BROWN SURVEYING, PLLC MAKES NO WARRANTIES AS TO MATTERS OF UNWRITTEN TITLE SUCH AS ADVERSE POSSESSION, ACQUIESCENCE, ESTOPPLE, ETC.

A FIELD TRAVERSE WAS PERFORMED USING A NIKON NIVO 3.0C THREE SECOND TOTAL STATION WITH TDS DATA COLLECTION SYSTEM. THE FIELD TRAVERSE MET THE MINIMUM STANDARDS FOR SURVEYS AS DESIGNATED IN WAC 332-130-090. ALL CORNERS NOTED AS FOUND WERE VISITED ON MARCH 1-12, 2026.

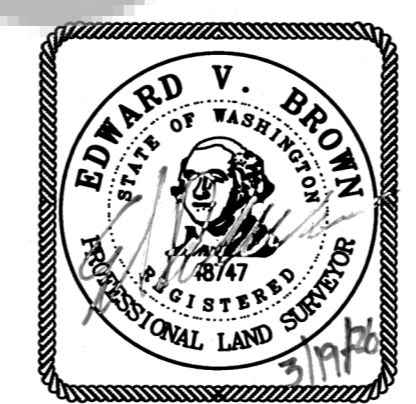

SURVEYOR'S CERTIFICATE
THIS MAP CORRECTLY REPRESENTS A SURVEY MADE BY ME OR UNDER MY DIRECTION IN CONFORMANCE WITH THE REQUIREMENTS OF THE SURVEY RECORDING ACT AT THE REQUEST OF SKAMANIA WEST TIMBERLANDS LLC IN MARCH, 2026.

Edward V. Brown 3-19-26
EDWARD V. BROWN, PROFESSIONAL LAND SURVEYOR, LS# 48747

AUDITOR'S CERTIFICATE
FILED FOR RECORD THIS 23rd DAY OF March 2026 AT 3:46 P.M. IN BOOK OF SURVEYS AT PAGE AT THE REQUEST OF BROWN SURVEYING, PLLC. AF# 2026-000421
Kurt M.
DEPUTY COUNTY AUDITOR

SCALE: 1"=300'	<p>PO BOX 414 AMBOY, WA 98601 360-600-0846 ebrownsurveying@gmail.com</p>
JOB NO. 26-033	
DATE: 03/17/26	
CALC BY: KAK	
DRAWN BY: KAK	
CHECKED BY: EVB	SHEET 1 OF 1