

- 1) PROJECT NO. 2111 WASHINGTON, PACIFIC POWER & LIGHT COMPANY, SWIFT NO. 1 H.E. DEVELOPMENT, PROJECT AREA & PROJECT BOUNDARY (NO DATE), ON FILE WITH DNR
- 2) PACIFIC POWER & LIGHT COMPANY PLAT OF SECTION 30 (DATED 10/16/1959), "RIGHT TO INUNDATE". ON FILE WITH DNR
- 3) ROS AFN 2015001275

THE PURPOSE OF THIS SURVEY WAS TO POST THAT PORTION OF THE WEST LINE OF THE NORTHWEST QUARTER AND SOUTHWEST QUARTER OF SECTION 30 AS SHOWN FOR THE "RAYONIER FOREST RESOURCES, L.P. TRACT" CITED. CONTROLLING CORNERS SHOWN WERE TIED BY CONVENTIONAL TRAVERSE METHODS ORIGINATING FROM NEARBY "RTK GPS POINTS". THE GPS POINTS WERE COLLECTED ON "WASHINGTON STATE PLANE COORDINATE SYSTEM, SOUTH ZONE" (NAD 83/2011) WHICH WAS THE BASIS OF BEARING FOR THIS SURVEY. A CLOSED LOOP TRAVERSE WAS RUN ALONG THE WEST LINE OF SECTION 30 BEGINNING AND ENDING ON SAID GPS POINTS. DISTANCES SHOWN ARE GRID DISTANCES. TO OBTAIN GROUND DISTANCES DIVIDE THE DISTANCES SHOWN BY THE COMBINED SCALE FACTOR OF 0.99986979.

IN GOV'T LOT 2, THE SW 1/4
NW 1/4 AND GOV'T LOT 3,
THE NW 1/4 SW 1/4 OF
SECTION 30, T7N, R6E, W.M.
SKAMANIA COUNTY, WA.

FOUND AND HELD DNR CONCRETE
MONUMENT WITH 3" BRASS CAP AS
SHOWN IN ROS AFN 2015001275
(SEE LCR ON FILE WITH DNR)
EXISTING REFERENCES:
39' CEDAR WITH HEALED BLAZE, S76'E, 21.50'
TO NAIL IN SIDE CENTER
10' HEMLOCK WITH HEALED BLAZE AND 4
NOTCHES, S82'E, 33.53' TO NAIL IN FACE
METAL "T" POST BEARS NORTH, 1.0'
METAL "T" POST BEARS S47'W, 10.7'

PACIFICORP
BOOK 205, PAGE 557

LOCATION OF 90 ROAD SHOWN
IS APPROXIMATE, SHOWN FOR
ORIENTATION ONLY.

CORNER NO. 91

(S 82°13'30" E) 1
S 80°58'43" E
676.77'
(676.76') 1

PACIFIC POWER & LIGHT COMPANY
BOOK 48, PAGE 352

CORNER

CORNER NO. 93M
FOUND AND HELD 3" BRASS CAP SET IN
CONCRETE AS SHOWN IN PACIFIC POWER AND
LIGHT COMPANY PLAN FOR PROJECT BOUNDARY
OF "SWIFT NO.1 H.E. DEVELOPMENT"
(SEE LCR ON FILE WITH DNR)
EXISTING REFERENCES:
60" FIR STUMP (ROTTEN), N38°E, 23.0'
TO CENTER
30" FIR STUMP (ROTTEN), S25°E, 29.4'
TO CENTER
NEW REFERENCES:
12" FIR, N51°E, 2.3'
17" MAPLE, N52°W, 16.8'
FIBERGLASS POST BEARS NORTH. 1.0'

RAYONIER FOREST RESOURCES, L.P.
AFN 2023-000113

FOUND AND HELD ROCK NAIL ON NORTH SIDE OF
THE 90 ROAD ON CUT BANK. SEE CORNER NOTE
(SEE LCR ON FILE WITH DNR)
EXISTING REFERENCE:
BEARING TREE TAG NAILED INTO ROCK FACE,
EAST, 1.0' TO TAG
NEW REFERENCES:
4" FIR, S60°W, 7.7' TO NAIL IN SIDE CENTER
4" FIR, N63°W, 9.4' TO NAIL IN SIDE CENTER
(THE ABOVE TWO 4" FIRS WERE NOT NOTCHED)

RAYONIER FOREST RESOURCES, L.P.
AFN 2023-000113

GOV'T LOT 3
 (N 04°23'30" W)²
 N 03°16'16" W
 161.06'
 (161.01')²
 (N 82°28'30" E)²
 N 83°43'05" E
 560.44'
 (560.76')²
 CORNER NO. 96
 CORNER NO. 95

STATE OF WASHINGTON
(PER SKAMANIA COUNTY GIS)

THE FOLLOWING RECORDS ARE WHAT I FOUND DURING MY RESEARCH OF THE WEST
QUARTER CORNER OF SECTION 30.

1. 9/1/1900 - GLO SURVEYOR LEWIS D. SHELTON UNDER HIS CONTRACT NO. 552, DATED 7/27/1899 NOTES SETTING A FIR POST WITH 2 BEARING TREES.
2. 7/5/1957 - HARBOR PLYWOOD CORPORATION PREPARED A "RIGHT OF WAY PLAT" IN SECTION 30 AND SHOWS A "CORNER FOUND" NOTE FOR THE QUARTER CORNER.
3. OCTOBER, 1957 - PETTIJOHN ENGINEERING PERFORMS A "RETRACEMENT AND SUBDIVISION OF SECTION 30" AND NOTES THAT THEY FOUND 2 BEARING TREES.
4. 7/21/1960 - PACIFIC POWER AND LIGHT COMPANY PREPARED A "RIGHT OF WAY PLAT" IN SECTION 30 AND SHOWS THEY FOUND 2 BEARING TREES.
5. 7/14/1964 - THE STATE OF WASHINGTON - DIVISION OF FORESTRY PREPARES A SECTION CORNER RECORD AND NOTES FINDING A WEYERHAEUSER TAG ON ROCK FACE OF ROAD CUT. THEY ALSO NOTE AN "ALUMINUM TAG ON NORTH EDGE OF R/W CLEARING BEING A 100' N. OF CORNER.

THE ORIGIN OF THE ROCK NAIL WE FOUND IS UNKNOWN. THE WEYERHAEUSER TAG WE FOUND ON THE ROCK FACE NOTED ABOVE HAD SCRIBING ON IT REFERENCING THE ROCK NAIL WITH A BEARING AND DISTANCE TO IT. I BELIEVE THAT WEYERHAEUSER MOST LIKELY SET THIS NAIL WHEN THE TAG WAS NAILED TO THE ROCK WALL. THE DISTANCE SOUTH TO CORNER 93M ON THE PROJECT BOUNDARY FOR SWIFT LAKE IS WITHIN 0.27 FEET OF RECORD. THE DISTANCE RUNNING NORTH TO THE SECTION CORNER DOES NOT CHECK BY OVER 7 FEET WITH THE RECORD DISTANCE WHICH WAS CONCERNING. THE DISTANCE ALONG THE NORTH LINE OF THE NORTHWEST QUARTER IS ALMOST 5 FEET DIFFERENT THAN THE RECORD. I FEEL THERE WERE SOME ERRORS MADE ON THE MAPS REFERENCED ABOVE, BECAUSE OF THESE ERRORS AND THE DISTANCE SOUTH TO CORNER 93M CHECKING VERY CLOSE TO RECORD, I CHOSE TO HOLD THE ROCK NAIL AS THE BEST EVIDENCE OF THE CORNER. THE 90 ROAD WAS MOVED TO ITS CURRENT LOCATION IN THE LATE 1950'S WHICH WOULD HAVE MOST LIKELY REMOVED ANY ORIGINAL EVIDENCE THAT REMAINED AT THAT TIME. I DON'T FEEL THAT A PROPORTIONED POSITION FOR THIS CORNER WOULD HAVE BEEN THE BEST SCENARIO WITH THE ERRORS MENTIONED ABOVE.

FOUND AND HELD DNR CONCRETE
MONUMENT WITH 3" BRASS CAP AS
SHOWN IN ROS AFN 2015001275
(SEE LCR ON FILE WITH DNR)
EXISTING REFERENCES:
18" FIR STUMP WITH HEALED BLAZE AND
4 NOTCHES, N08'E, 33.85' TO NAIL IN FACE
14" HEMLOCK WITH HEALED BLAZE AND 4
NOTCHES, S74'E, 3.55' TO NAIL IN FACE
18" HEMLOCK STUMP WITH HEALED BLAZE AND
4 NOTCHES, N76'W, 16.27' TO NAIL IN FACE
SET 1/2" FIBERGLASS POST SOUTH, 1.0'

~~DEED REFERENCE~~
BARGAIN AND SALE DEED
AND FORESTS OF LEWIS RIVER INC.
TO
RAYONIER FOREST RESOURCES, L.P.
AFN 2023-000113
(01/25/2023)

BEARINGS ARE
NAD 83/2011 BASED ON
GPS OBSERVATIONS
(SEE NARRATIVE)

300 150 0 300 450 600

SCALE 1 INCH = 300 FEET

- INDICATES MONUMENT FOUND AS NOTED
- ✱ INDICATES FOUND AND HELD 5/8" IRON ROD WITHOUT CAP ON THE PROJECT BOUNDARY AS SHOWN IN PACIFIC POWER & LIGHT COMPANY PLAT OF SECTION 25 AND 30 (UNLESS NOTED OTHERWISE)
- () INDICATES RECORD INFORMATION PER SURVEY REFERENCE NUMBER
- /— INDICATES LINE MARKED WITH 1/2" x 72" FIBER GLASS RODS WITH RED RIBBON. TREES ALONG LINE BLAZED AND PAINTED WITH BLUE PAINT.
- ROS RECORD OF SURVEY
- AFN AUDITOR'S FILE NUMBER
- LCR LAND CORNER RECORD
- DNR DEPARTMENT OF NATURAL RESOURCES
- GPS GLOBAL POSITIONING SYSTEM
- RTK REAL TIME KINEMATIC

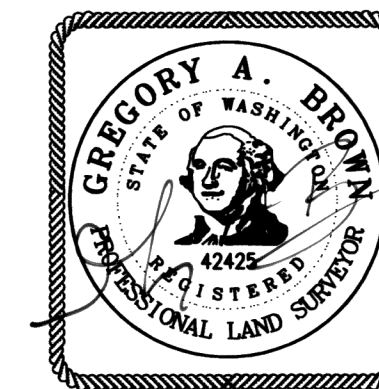

1-19-2026

THIS MAP CORRECTLY REPRESENTS A SURVEY MADE BY ME OR UNDER MY DIRECTION
IN CONFORMANCE WITH THE REQUIREMENTS OF THE SURVEY RECORDING ACT AT THE
REQUEST OF RAYONIER FOREST RESOURCES, L.P. IN OCTOBER, 2025.

 1/19/2020
GREGORY A. BROWN, PROFESSIONAL LAND SURVEYOR, LS# 42425

FILED FOR RECORD THIS 27th DAY OF January 2026 AT
11:55 A.M. IN BOOK 1 OF SURVEYS AT PAGE 1
AT THE REQUEST OF BROWN SURVEYING, PLLC.

2026-0001

AUDITOR'S FILE NUMBER

DEPUTY COUNTY AUDITOR

BROWN SURVEYING, PLLC MAKES NO WARRANTIES AS TO MATTERS OF UNWRITTEN TITLE SUCH AS ADVERSE POSSESSION, ACQUIESCENCE, ESTOPPLE, ETC.

A FIELD TRAVERSE WAS PERFORMED USING A NIKON NIVO 3.0C THREE SECOND TOTAL STATION WITH TDS DATA COLLECTION SYSTEM. THE FIELD TRAVERSE MET THE MINIMUM STANDARDS FOR SURVEYS AS DESIGNATED IN WAC 332-130-090. ALL CORNERS NOTED AS FOUND WERE VISITED ON 10/23 THROUGH 11/3/2025.

SCALE: 1"=300'
JOB NO. 25-106
DATE: 1-15-2026
CALC BY: GAB
DRAWN BY: GAB
CHECKED BY: GAB
SHEET 1 OF 1

BROWN
SURVEYING PLLC
PO BOX 414
AMBOY, WA 98601
360-600-0846
ebrownsurveying@gmail.com