

NARRATIVE

THE PURPOSE OF THIS SURVEY WAS TO LOCATE AND MONUMENT THE BOUNDARY OF THE NATIONAL FOREST SYSTEM LANDS (NFSL) WITHIN SECTION 22, TOWNSHIP 3 NORTH, RANGE 9 EAST, WILLAMETTE MERIDIAN. ADDITIONALLY THE BOUNDARIES OF THE NFSL WERE CLEARED, BLAZED AND MARKED WITH "ALUMINUM POSTS". MONUMENTS ESTABLISHED AT THE NORTH, WEST AND EAST QUARTER CORNERS OF SECTION 22 BY THE GLO AND SUBSEQUENTLY RESTORED WERE RECOVERED DURING THIS SURVEY. THE SOUTH QUARTER CORNER WAS SET AT A SINGLE PROPORTION POSITION IN 1977 BY OLSON ENGINEERING IN ROS 1-119. THE SOUTH SIXTEENTH CORNER ON THE WEST LINE OF THE SOUTHWEST QUARTER WAS ESTABLISHED IN 1972 BY JERRY OLSON IN A UNRECORDED RECORD OF SURVEY FOR THE DNR. THE SECTION SUBDIVISION WAS BASED ON THESE CONTROLLING MONUMENTS DESCRIBED ABOVE. NEW MONUMENTS ESTABLISHED WERE SET FROM RANDOM CONTROL TRAVERSES RUN BETWEEN GPS POINTS SET IN AND AROUND SECTION 22. THE GPS POINTS WERE COLLECTED ON "WASHINGTON STATE PLANE COORDINATE SYSTEM, SOUTH ZONE" (NAD 83/2011) WHICH WAS OUR BASIS OF BEARING. A "TRIMBLE R10 GPS UNIT" WAS USED FOR GPS OBSERVATIONS.

COLUMBIA RIVER GORGE NATIONAL SCENIC AREA (CRGNSA)

THE CRGNSA ACT WAS PASSED BY CONGRESS AND SIGNED INTO LAW BY PRESIDENT RONALD REAGAN ON NOVEMBER 17, 1986. THE MAPS THAT CONGRESS ENACTED AS PART OF THE NATIONAL SCENIC AREA ACT IN 1986 WERE NOT DRAWN TO CARTOGRAPHIC OR SURVEYING STANDARDS AND CONGRESS DID NOT PROVIDE ANY LEGAL BOUNDARY DESCRIPTION. IN 1987, THE U.S. FOREST SERVICE PREPARED NEW MAPS ADDRESSING MANY OF THE ISSUES WITH THE ORIGINAL MAPS THAT CONGRESS ENACTED. THE COLUMBIA RIVER GORGE COMMISSION (CRGC), U.S. FOREST SERVICE (USFS), AND OTHERS HAVE USED THE 1987 MAPS ALMOST EXCLUSIVELY FOR ADMINISTRATION OF THE NATIONAL SCENIC AREA ACT. THE CRGC ADOPTED THE EXTERIOR BOUNDARY, SPECIAL MANAGEMENT AREAS, AND URBAN AREAS LEGAL DESCRIPTIONS CONTAINED IN APPENDICES A, B, AND C CONTAINED WITHIN CHAPTER 350, DIVISION 10 AS AMENDED THROUGH DECEMBER 31, 2018. THE MONUMENTS SHOWN ON THIS MAP WERE SET BASED ON TOPOGRAPHY CALLS IN SAID LEGAL DESCRIPTION.

- AP 114 [AP 35] - THE SUMMIT OF AUGSPURGER MOUNTAIN;
THENCE ALONG THE CREST OF A RIDGE LINE EASTERLY AND SOUTHERLY,
APPROXIMATELY 14,160 FT. TO
- AP 115 [AP 36] - THE SUMMIT OF COOK HILL;
THENCE DESCENDING ALONG THE CREST OF A RIDGE LINE, NORTHEASTERLY,
APPROXIMATELY 1,665 FT. TO
- AP 116 [AP 37] - AT INTERSECTION OF THE CENTER LINE OF BUNKER KEYS ROAD WITH THE THREAD
OF AN UNNAMED RAVINE TO THE SOUTHEAST

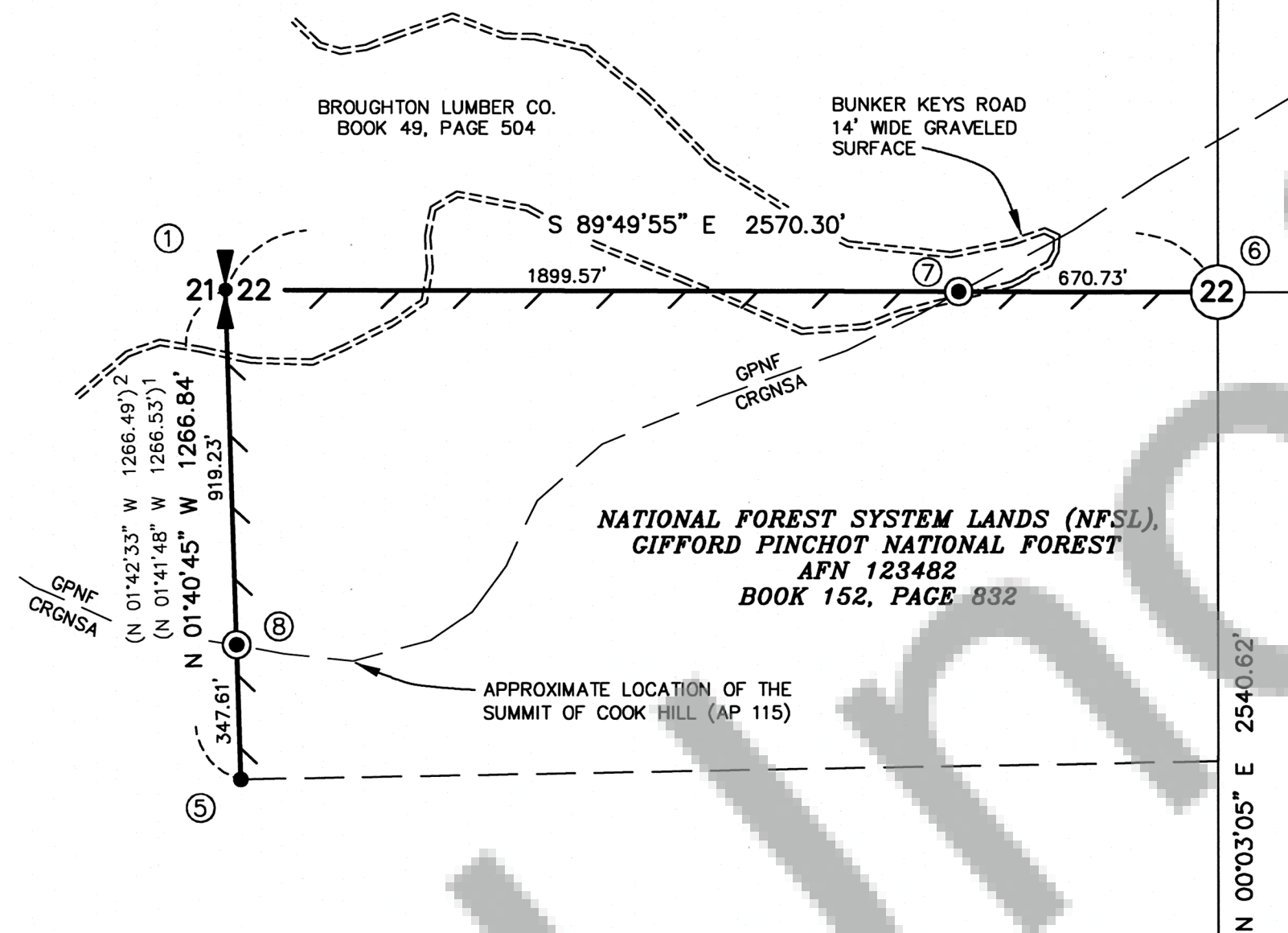

DEED REFERENCE

WARRANTY DEED
BROUGHTON LUMBER CO.
TO
UNITED STATES OF AMERICA
UNDER PROVISIONS OF SEC. 9 OF THE CRGNSA ACT
NATIONAL FOREST SYSTEM LANDS
GIFFORD PINCHOT NATIONAL FOREST
AFN 123482
BOOK 152, PAGE 832
(OCTOBER 10, 1995)

SURVEY REFERENCE

- 1) 1972 DNR SURVEY BY JERRY OLSON
2) ROS 1-119

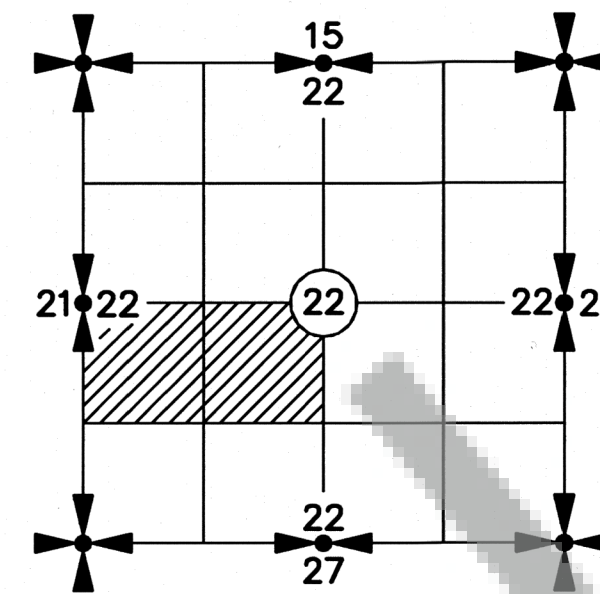

SECTION DIAGRAM
NOT TO SCALE

RECORD OF SURVEY IN THE NW 1/4 AND NE 1/4 OF THE SW 1/4 OF SECTION 22, T3N, R9E, W.M. SKAMANIA COUNTY, WA.

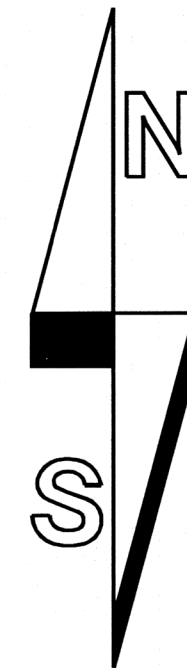

BEARINGS ARE
NAD 83/2011 BASED ON
GPS OBSERVATIONS
(SEE NARRATIVE)

400 200 0 400 600 800
SCALE 1 INCH = 400 FEET

LEGEND:

- MONUMENT FOUND AS NOTED (TIED APRIL-MAY 2025)
SEE SHEET 2 FOR DESCRIPTIONS
- ⊙ SET "DEEP-ONE" MAGNET BENEATH A 2-1/4" ALUMINUM
PIPE WITH A 3-1/4" USFS EMBOSSED ALUMINUM CAP AS
SHOWN ON SHEET 2, SET ON 5/7 & 5/8/2025
- () INDICATES RECORD INFORMATION PER SURVEY REFERENCE NUMBER
- LINE CLEARED, BLAZED AND MARKED WITH ALUMINUM POSTS
- ① MONUMENT I.D. NUMBER, SEE SHEET 2 FOR DESCRIPTIONS
- ROS RECORD OF SURVEY
- AFN AUDITOR'S FILE NUMBER
- GLO GENERAL LAND OFFICE
- NFSL NATIONAL FOREST SYSTEM LANDS
- CRGNSA COLUMBIA RIVER GORGE NATIONAL SCENIC AREA
- USFS UNITED STATES FOREST SERVICE
- GPNF GIFFORD PINCHOT NATIONAL FOREST
- GPS GLOBAL POSITIONING SYSTEM

SURVEY HISTORY

THE EAST LINE OF SECTION 22 WAS ORIGINALLY SURVEYED BY SMITH AND
SPRAY, DEPUTY SURVEYORS, UNDER THEIR JOINT CONTRACT NO. 216
(8/26/1875). THE SOUTH, WEST AND NORTH LINES OF SECTION 22 WERE
THEN COMPLETED BY LEWIS SHELTON, DEPUTY SURVEYOR, UNDER HIS
SPECIAL INSTRUCTIONS DATED 5/17/1880. IN 1972, THE DNR SURVEYED THE
WEST LINE OF THE SOUTHWEST QUARTER OF SECTION 22 AND ESTABLISHED
THE SOUTH SIXTEENTH CORNER WHICH WAS RECOVERED IN THIS SURVEY AS
SHOWN. NO OTHER SURVEYS WERE FOUND FOR THE LINES SHOWN AS
MARKED IN THIS SURVEY.

THIS PLAT EXAMINED AND ACCEPTED FOR THE UNITED STATES FOREST SERVICE
THIS 14th DAY OF August, 2025.

Erin M.
CONTRACTING OFFICER'S REPRESENTATIVE (C.O.R.)

I CERTIFY THAT THIS SURVEY WAS PERFORMED AT THE REQUEST OF
THE GIFFORD PINCHOT NATIONAL FOREST.
Shirley W.
FOREST SUPERVISOR

BROWN SURVEYING, PLLC MAKES NO WARRANTIES AS TO MATTERS OF UNWRITTEN
TITLE SUCH AS ADVERSE POSSESSION, ACQUIESCENCE, ESTOPPLE, ETC.

A FIELD TRAVERSE WAS PERFORMED USING A NIKON NIVO 3.0C THREE SECOND
TOTAL STATION WITH TDS DATA COLLECTION SYSTEM. THE FIELD TRAVERSE MET THE
MINIMUM STANDARDS FOR SURVEYS AS DESIGNATED IN WAC 332-130-090. ALL
CORNERS NOTED AS FOUND WERE VISITED IN APRIL AND MAY OF 2025.

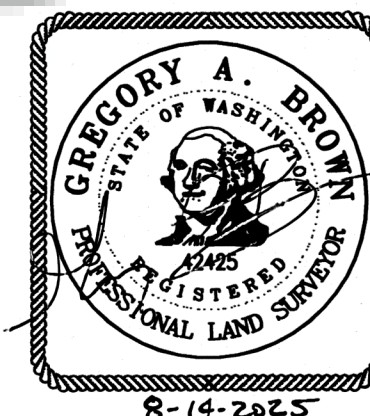

AUDITOR'S CERTIFICATE

FILED FOR RECORD THIS 21st DAY OF August 2025 AT
12:53 P.M. IN BOOK OF SURVEYS AT PAGE
2025-001324
AUDITOR'S FILE NUMBER

ktm
DEPUTY COUNTY AUDITOR

SURVEYOR'S CERTIFICATE

THIS MAP CORRECTLY REPRESENTS A SURVEY MADE BY ME OR UNDER MY DIRECTION
IN CONFORMANCE WITH THE REQUIREMENTS OF THE SURVEY RECORDING ACT AT THE
REQUEST OF UNITED STATES DEPARTMENT OF IN OCTOBER, 2024.
AGRICULTURE - FOREST SERVICE

Gregory A. Brown 8/14/2025
GREGORY A. BROWN, PROFESSIONAL LAND SURVEYOR, LS# 42425

SCALE: 1"=400'
JOB NO. 25-013
DATE: 8-14-2025
CALC BY: GAB
DRAWN BY: KAK
CHECKED BY: GAB
SHEET 1 OF 2

BROWN
SURVEYING PLLC

PO BOX 414
AMBOY, WA 98601
360-600-0846
ebrownsurveying@gmail.com

RECORD OF SURVEY

IN THE NW 1/4 AND NE 1/4
OF THE SW 1/4 OF
SECTION 22, T3N, R9E, W.M.
SKAMANIA COUNTY, WA.

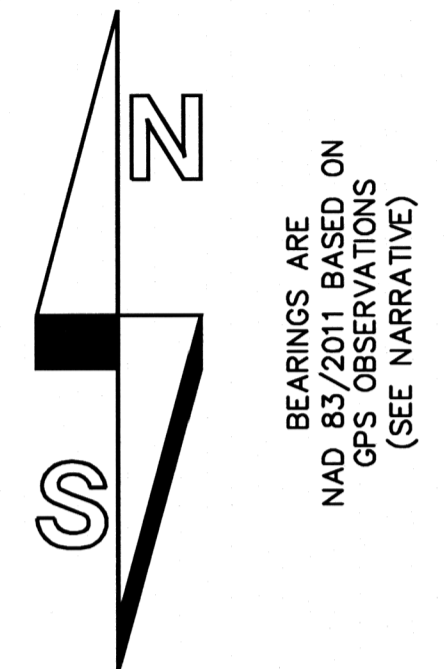

400 200 0 400 600 800
SCALE 1 INCH = 400 FEET

LEGEND:

ROS	RECORD OF SURVEY
AFN	AUDITOR'S FILE NUMBER
USFS	UNITED STATES FOREST SERVICE
DNR	DEPARTMENT OF NATURAL RESOURCES
CRGNSA	COLUMBIA RIVER GORGE NATIONAL SCENIC AREA
54-2	A 7" X 10" METAL "PROPERTY BOUNDARY" SIGN
54-3	A 4-1/2" X 5" METAL "BEARING TREE" SIGN
54-9	A 7" X 10" METAL "LAND SURVEY MONUMENT" SIGN

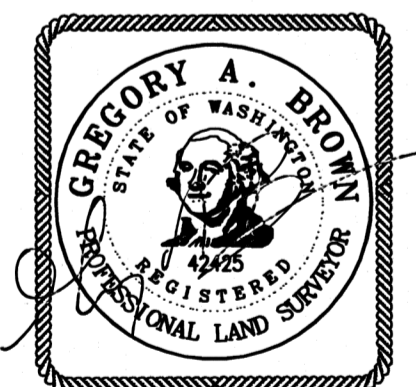

8-14-2025

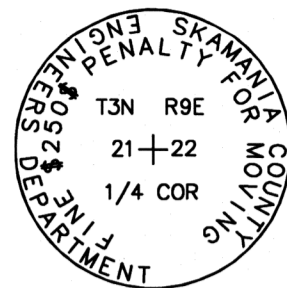

- ① FOUND SKAMANIA COUNTY MONUMENT WITH 3" BRASS CAP SET IN ROCK MOUND AS SHOWN LCR AFN 110351:
- FOUND DNR REFERENCE TREE: 16" DOUGLAS FIR WITH DNR TAG, N85°45'E, 8.74' TO NEW NAIL IN SOUTH SIDE CENTER
- FOUND DNR REFERENCE TREE: 15" HEMLOCK WITH DNR TAG, S28°45'E, 9.42' TO NEW NAIL IN NORTHEAST SIDE CENTER
- FOUND DNR REFERENCE TREE: 17" FIR WITH DNR TAG, S16°30'W, 13.27' TO NEW NAIL IN NORTHWEST SIDE CENTER
- FOUND DNR REFERENCE TREE: 6" FIR WITH DNR TAG, N35°W, 14.02', DOWN ON GROUND
- FOUND CARSONITE POST, N25°W, 3.2'
- SET NEW REFERENCE: 1/2" REBAR WITH RED PLASTIC CAP STAMPED "BROWN CONTROL", N60°30'W, 17.12'

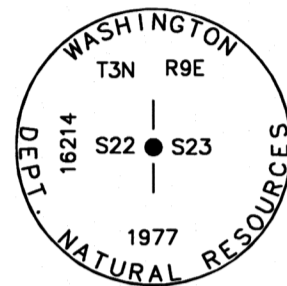

- ② FOUND DNR CONCRETE MONUMENT WITH 3" BRASS CAP AS SHOWN IN ROS 3-85 (SEE LCR AFN 84880):
- FOUND ORIGINAL BEARING TREE: 24" FIR SNAG WITH AXE MARKS, N48°00'E, 14.9' TO FACE
- FOUND DNR REFERENCE TREE: 23" FIR, N09°00'E, 19.97' TO NEW NAIL IN WEST SIDE CENTER
- FOUND DNR REFERENCE TREE: 9" UPROOTED FIR WITH DNR TAG, S70°E, LAYING DOWN HILL
- FOUND DNR REFERENCE TREE: 10" FIR, 4' TALL HIGH STUMP WITH DNR TAG AND HEALED BLAZE, N78°30'W, 10.54'
- FOUND CARSONITE POST, NORTH, 3.85'
- NEW REFERENCE POINT: SET 5/8" REBAR, S61°15'W, 24.96' WITH ORANGE PLASTIC CAP STAMPED "BROWN 42425" APPROXIMATELY ONE FOOT IN FRONT OF A 12" FIR TREE WITH 54-3 & 54-9 SIGNS & PAINTED RED BAND. (TREE USED ONLY TO NAIL REFERENCE TAGS TO)

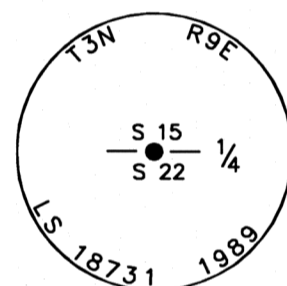

- ③ FOUND 2-1/2" BRASS CAP SET IN IRON PIPE AS SHOWN IN LCR AFN 110353:
- FOUND 5/8" REBAR WITHOUT CAP, S01°30'W, 7.41'
- FOUND DNR REFERENCE TREE: 37" FIR WITH DNR TAG, S23°30'W, 91.76' TO NAIL IN NORTHEAST SIDE CENTER
- FOUND CHISELED NOTCH IN BOLT ON EAST LEG OF BPA TOWER 3.0' ABOVE CONCRETE BASE, S77°00'W, 87.16'
- FOUND CHISELED NOTCH IN BOLT ON SOUTH LEG OF BPA TOWER 1.0' ABOVE CONCRETE BASE, N62°15'W, 151.56'
- FOUND CARSONITE POST, NORTH, 2.8'



- ④ FOUND 3/4" (OUTSIDE DIAMETER) IRON PIPE WITH YELLOW PLASTIC CAP STAMPED "OLSON 9025" AS SHOWN IN ROS 1-119. THIS MONUMENT WAS SET BY SINGLE PROPORTION METHOD IN SAID SURVEY:
- FOUND OLSON REFERENCE TREE: 31" FIR, S21°00'E, 24.70' TO NEW NAIL IN NORTHEAST SIDE CENTER
- FOUND OLSON REFERENCE TREE: 27" FIR, S02°30'W, 14.41' TO NEW NAIL IN EAST SIDE CENTER
- FOUND OLSON REFERENCE TREE: 13" FIR, N55°30'W, 7.46' TO NEW NAIL IN SOUTHWEST SIDE CENTER, SCRIBED "1/4 S22 BT" WITH TACK AND WASHER "LS 42425" IN NEWLY SCRIBED "B"
- SET ALUMINUM POST WITH 54-9 SIGN, NORTH, 3.0'

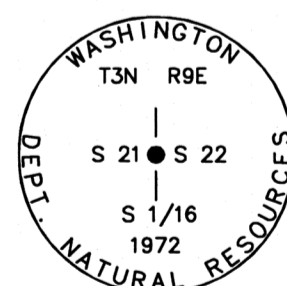

- ⑤ FOUND DNR CONCRETE MONUMENT WITH 3" BRASS CAP AS SHOWN IN A 1972 DNR SURVEY OF SECTION 21 BY JERRY OLSON:
- NEW REFERENCE POINT: SET 5/8" REBAR, N32°00'E, 19.68' WITH ORANGE PLASTIC CAP STAMPED "BROWN 42425" APPROXIMATELY ONE FOOT IN FRONT OF A 40" DOUGLAS FIR TREE WITH 54-3 & 54-9 SIGNS & PAINTED RED BAND. (TREE USED ONLY TO NAIL REFERENCE TAGS TO)
- NEW REFERENCE POINT: SET 5/8" REBAR, S85°30'W, 34.25' WITH ORANGE PLASTIC CAP STAMPED "BROWN 42425" APPROXIMATELY ONE FOOT IN FRONT OF A 29" SILVER FIR TREE WITH 54-3 & 54-9 SIGNS & PAINTED RED BAND. (TREE USED ONLY TO NAIL REFERENCE TAGS TO)
- SET ALUMINUM POST WITH 54-2 SIGN NORTH, 5.0'

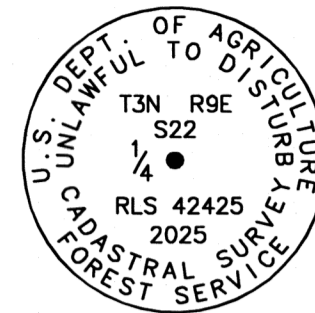

- ⑥ SET 2-1/4" ALUMINUM PIPE WITH 3-1/4" USFS EMBOSSED ALUMINUM CAP IN ROCK MOUND AT POINT OF INTERSECTION BETWEEN THE CORRESPONDING QUARTER-SECTION CORNERS NOTED AS MONUMENT I.D. NO. 1 & 2 AND 3 & 4, STAMPED AS SHOWN:
- NEW REFERENCE POINT: SET 5/8" REBAR, N77°30'E, 15.90' WITH ORANGE PLASTIC CAP STAMPED "BROWN 42425" APPROXIMATELY ONE FOOT IN FRONT OF A 23" DOUGLAS FIR TREE WITH 54-3 & 54-9 SIGNS & PAINTED RED BAND. (TREE USED ONLY TO NAIL REFERENCE TAGS TO)
- NEW REFERENCE POINT: SET 5/8" REBAR, S32°30'E, 5.73' WITH ORANGE PLASTIC CAP STAMPED "BROWN 42425" APPROXIMATELY ONE FOOT IN FRONT OF A 17" DOUGLAS FIR TREE WITH 54-3 & 54-9 SIGNS & PAINTED RED BAND. (TREE USED ONLY TO NAIL REFERENCE TAGS TO)
- SET ALUMINUM POST WITH 54-9 SIGN WEST, 3.0'

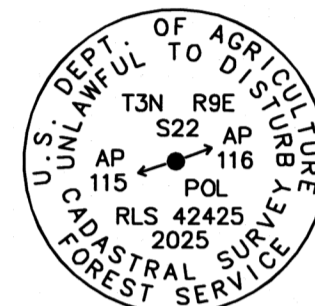

- ⑦ SET 2-1/4" ALUMINUM PIPE WITH 3-1/4" USFS EMBOSSED ALUMINUM CAP IN ROCK MOUND ON NORTH SIDE OF BUNKER KEYS ROAD ON TOP OF RIDGE LINE. SET AS A POINT ON LINE FOR THE CRGNSA BETWEEN THE SUMMIT OF COOK HILL (AP 115) AND INTERSECTION OF THE CENTERLINE OF BUNKER KEYS ROAD WITH THE THREAD OF AN UNNAMED RAVINE TO THE SOUTHEAST (AP 116) STAMPED AS SHOWN:
- NEW REFERENCE POINT: SET 5/8" REBAR, S49°30'E, 28.88' WITH ORANGE PLASTIC CAP STAMPED "BROWN 42425" APPROXIMATELY ONE FOOT IN FRONT OF A 11" DOUGLAS FIR TREE WITH 54-3 & 54-9 SIGNS & PAINTED RED BAND. (TREE USED ONLY TO NAIL REFERENCE TAGS TO)
- NEW REFERENCE POINT: SET 5/8" REBAR, S33°45'W, 39.55' WITH ORANGE PLASTIC CAP STAMPED "BROWN 42425" APPROXIMATELY ONE FOOT IN FRONT OF A 14" DOUGLAS FIR TREE WITH 54-3 & 54-9 SIGNS & PAINTED RED BAND. (TREE USED ONLY TO NAIL REFERENCE TAGS TO)
- SET ALUMINUM POST WITH 54-9 SIGN EAST, 3.5'
- SET ALUMINUM POST WITH 54-2 SIGN WEST, 10.7'



- ⑧ SET 2-1/4" ALUMINUM PIPE WITH 3-1/4" USFS EMBOSSED ALUMINUM CAP IN ROCK MOUND ON TOP OF RIDGE LINE. SET AS A POINT ON LINE FOR THE CRGNSA BETWEEN THE SUMMIT OF AUGSPURGER MOUNTAIN (AP 114) AND THE SUMMIT OF COOK HILL (AP 115) STAMPED AS SHOWN:
- NEW REFERENCE POINT: SET 5/8" REBAR, S45°00'E, 12.46' WITH ORANGE PLASTIC CAP STAMPED "BROWN 42425" APPROXIMATELY ONE FOOT IN FRONT OF A 12" DOUGLAS FIR TREE WITH 54-3 & 54-9 SIGNS & PAINTED RED BAND. (TREE USED ONLY TO NAIL REFERENCE TAGS TO)
- NEW REFERENCE POINT: SET 5/8" REBAR, S36°45'W, 27.00' WITH ORANGE PLASTIC CAP STAMPED "BROWN 42425" APPROXIMATELY ONE FOOT IN FRONT OF A 15" DOUGLAS FIR TREE WITH 54-3 & 54-9 SIGNS & PAINTED RED BAND. (TREE USED ONLY TO NAIL REFERENCE TAGS TO)
- SET ALUMINUM POST WITH 54-2 SIGN NORTH, 3.0'

CORNER REFERENCE NOTE

BEARINGS SHOWN FOR BEARING TREES AND REFERENCE POINTS ARE BASED ON ACTUAL TIES FROM CORNER POSITIONS TO THE REFERENCES NOTED WITH A NIKON NIVO 3.00 THREE SECOND TOTAL STATION WITH TDS DATA COLLECTION SYSTEM.

RECOVERED BEARING/REFERENCE TREES HAVE A PAINTED 6" RED BAND APPROXIMATELY 6 FEET ABOVE GROUND, 54-3 SIGN NAILED ON THE FRONT OF THE TREE FACING TOWARD THE CORNER AND HAVE A 54-9 SIGN NAILED ON THE BACK. TREES NOTED AS BEING SCRIBED HAVE A BRASS WASHER (LS 42425) TACKED IN THE NEWLY SCRIBED "B".

NEW REFERENCE POINTS: CONSIST OF A 5/8" REBAR WITH ORANGE PLASTIC CAP STAMPED "BROWN 42425" APPROXIMATELY ONE FOOT IN FRONT OF THE NOTED TREE WITH 54-3 & 54-9 SIGNS & PAINTED RED BAND ON TREE. (TREE USED ONLY TO NAIL REFERENCE TAGS TO)

SCALE: 1"=400'
JOB NO. 25-013
DATE: 8-14-2025
CALC BY: GAB
DRAWN BY: KAK
CHECKED BY: GAB
SHEET 2 OF 2

BROWN
SURVEYING PLLC

PO BOX 414
AMBOY, WA 98601
360-600-0846
ebrownsurveying@gmail.com