

SURVEY REFERENCES:

- 1) SHORT PLAT #2, BOOK 2, PAGE 83A (1978)
- 2) HAGEDORN SURVEY, BOOK 1, PAGES 244-247 (1979-1980)
- 3) HAGEDORN SURVEY, BOOK 3 SHORT PLATS, PAGE 277 (1995)
- 4) SWART SURVEY, BOOK 3, PAGE 418 (2002)
- 5) OLSON SURVEY, BOOK 1, PAGE 83 (1975)

DEED REFERENCE:

1) REAL ESTATE CONTRACT
GRANTOR: MATT CALIFF AND ELAINE J. CALIFF
GRANTEE: DWIGHT K. SHANNON AND TINA SHANNON
AFN: 2004151903
DATE: FEBRUARY 5, 2004

NARRATIVE

THE PURPOSE OF THIS SURVEY WAS TO MONUMENT THE BOUNDARY AND SURVEY FENCES ON THE "SHANNON" PARCEL AS DESCRIBED IN DEED REFERENCE 1 WHICH IS LOT 2 OF THE "W. JACK SPRINKEL" SHORT PLAT AS RECORDED IN BOOK 2 OF SHORT PLATS, AT PAGE 83, SKAMANIA COUNTY, WASHINGTON, AUDITORS RECORDS. THE CONTROL FOR THIS PROJECT WAS ESTABLISHED BY OCCUPYING A BASE CONTROL POINT FOR 8 PLUS HOURS AND PROCESSING THE DATA USING THE NGS-OPUS SOFTWARE. ONCE THE BASE CONTROL POINT WAS ESTABLISHED THEN A TRIMBLE R12 GNSS BASE RECEIVER OPERATING IN A RTK MODE WAS SET ON THE BASE POINT. A TRIMBLE R12I GNSS ROVER OPERATING IN A RTK MODE WAS USED TO SET CONTROL, TIE MONUMENTS, TIE USE LINES AND SET MONUMENTS. A 1 SECOND TRIMBLE S8 ROBOTIC TOTAL STATION WAS USED IN AREAS WHERE THE GPS WOULD NOT WORK (TREE COVER). ALL MONUMENTS WERE FOUND AND SET ON MAY 2, 2025. MINISTER AND GLAESER SURVEYING, INC. MAKES NO WARRANTIES AS TO MATTERS OF UNWRITTEN TITLE SUCH AS ADVERSE POSSESSION, ACQUIESCENCE, ESTOPPEL, ETC.

BOUNDARY RESOLUTION:

THE PERIMETER BOUNDARY OF THE "W. JACK SPRINKEL" SHORT PLAT, AS RECORDED IN BOOK 2 OF SHORT PLATS, AT PAGE 83, SKAMANIA COUNTY, WASHINGTON, AUDITORS RECORDS. WAS PARCEL 19 OF BOOK 1 OF SURVEYS, AT PAGE 150, SKAMANIA COUNTY, WASHINGTON AUDITORS RECORDS. THAT SURVEY WAS RECORDED ON JUNE 2, 1978. TWO YEARS LATER ON JULY 14, 1980, THE SURVEY WAS AMENDED IN BOOK 1 OF SURVEYS, AT PAGE 247, SKAMANIA COUNTY, WASHINGTON AUDITORS RECORDS. THE NORTH AND EAST LINES OF SAID PARCEL 19 BECAME LONGER. I HELD THE RECORD DISTANCE FOR THE SOUTH LINE OF LOT 2 OF SAID SHORT PLAT. I HELD THE RECORD DISTANCE FOR THE NORTH LINE OF LOT 2 OF SAID SHORT PLAT. THE EAST LINE OF SAID LOT 2 BECAME LONGER BY 0.07' AND THE WEST LINE OF SAID LOT 2 BECAME LONGER BY 0.06'. ALL OF THE EXCESS WAS ADDED TO LOT 1 AND LOT 4 OF SAID SHORT PLAT. REFER TO THIS SURVEY FOR THE MONUMENTS I FOUND AND HELD.

RECORD OF SURVEY

LOCATED IN A PORTION OF
THE SE 1/4 OF THE SW 1/4
OF SECTION 34,
T. 2 N., R. 5 E., W.M.
SKAMANIA COUNTY,
WASHINGTON

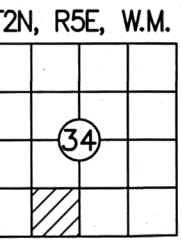

LEGEND:

- INDICATES MONUMENT FOUND AS NOTED
- INDICATES CALCULATED POSITION
- ⊙ INDICATES 1/2" x 24" REBAR WITH YELLOW PLASTIC CAP "RENTON 37535" SET 05/02/2025
- (DATA)R# INDICATES RECORD DATA PER SURVEY REFERENCE NUMBER
- REF. INDICATES SURVEY REFERENCE NUMBER
- SF INDICATES SQUARE FEET
- AFN: INDICATES AUDITOR'S FILE NUMBER
- PIN: INDICATES PROPERTY IDENTIFICATION NUMBER
- N.O.L. INDICATES NORTH OF LINE
- E.O.L. INDICATES EAST OF LINE
- S.O.L. INDICATES SOUTH OF LINE
- W.O.L. INDICATES WEST OF LINE
- X—X— INDICATES FENCE LINE

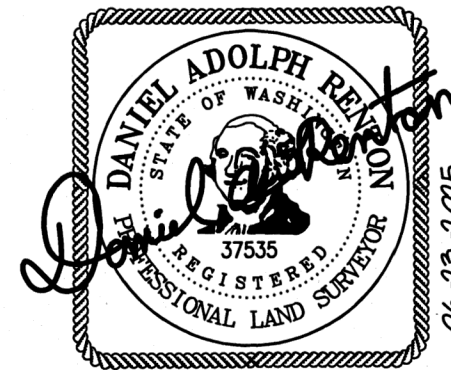

80 40 0 80 120 160
SCALE 1 INCH = 80 FEET

AUDITOR'S CERTIFICATE

FILED FOR RECORD THIS 24th DAY OF JUNE, 2025,
AT 10:59 O'CLOCK AM/PM,
AT THE REQUEST OF MINISTER AND GLAESER SURVEYING INC.

DEPUTY/COUNTY AUDITOR

AUDITORS FILE NUMBER

SURVEYOR'S CERTIFICATE

THIS MAP CORRECTLY REPRESENTS A SURVEY MADE BY ME OR UNDER MY DIRECTION IN CONFORMANCE WITH THE REQUIREMENTS OF THE SURVEY RECORDING ACT AT THE REQUEST OF DWIGHT & TINA SHANNON, IN MAY 2025.

Daniel Adolph Renton
DANIEL ADOLPH RENTON, PROFESSIONAL LAND SURVEYOR, LS# 37535

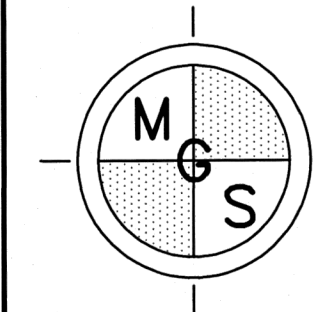

MINISTER-GLAESER
SURVEYING INC.
2200 E. EVERGREEN BLVD.
VANCOUVER, WA 98661
(360) 694-3313

JOB NO. 25-196
DATE: 06-23-2025
CALC BY: DAR
DRAWN BY: ZMB
CHECKED BY: DAR
FILE: 25196S1
SHEET 1 OF 1

