

RECORD OF SURVEY

OF THE HOME VALLEY PARK SITE
LOCATED IN THE JOSEPH ROBBINS D.L.C.
IN A PORTION OF
THE NW 1/4 OF THE NE 1/4
OF SECTION 34
T. 3 N., R 8 E., W.M.
SKAMANIA COUNTY, WASHINGTON



US Army Corps
of Engineers®

PREPARED FOR:
U.S. ARMY CORPS OF ENGINEERS
PORTLAND DISTRICT
333 SW FIRST AVE
PORTLAND OR 97204

SURVEY DATE:
01-03-2025

DESIGNED BY:
DANIEL A. RENTON

DRAWN BY:
DAR

FILE NUMBER:

SUBMITTED BY:
DANIEL A. RENTON

PLOT SCALE: 1"=100'

FILE NAME:
2324751.DWG

U.S. ARMY
CORPS OF ENGINEERS
PORTLAND DISTRICT
333 SW FIRST AVE
PORTLAND OR 97204

RECORD OF SURVEY
2023 REAL ESTATE SURVEYS
CONTRACT NO. W9127N21D0008, MINISTER & GLAESER
PREAWARD NO. PANND-23-P-0000-003621
TASK ORDER W9127N23F00043
MANDATORY TASK 0001: BOUNDARY RESOLUTION, MARKING
AND POSTING VICINITY OF HOME VALLEY PARK

SHEET
IDENTIFICATION
1 OF 2

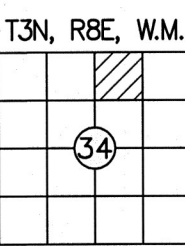

CURVE TABLE					
CURVE	RADIUS	DELTA	ARC DIST.	CHORD BEARING	CHORD DIST.
C1	150.00'	32°05'11"	84.00'	S 53°50'20" W	82.91'
C2	150.00'	19°44'44"	51.69'	S 79°45'18" W	51.44'

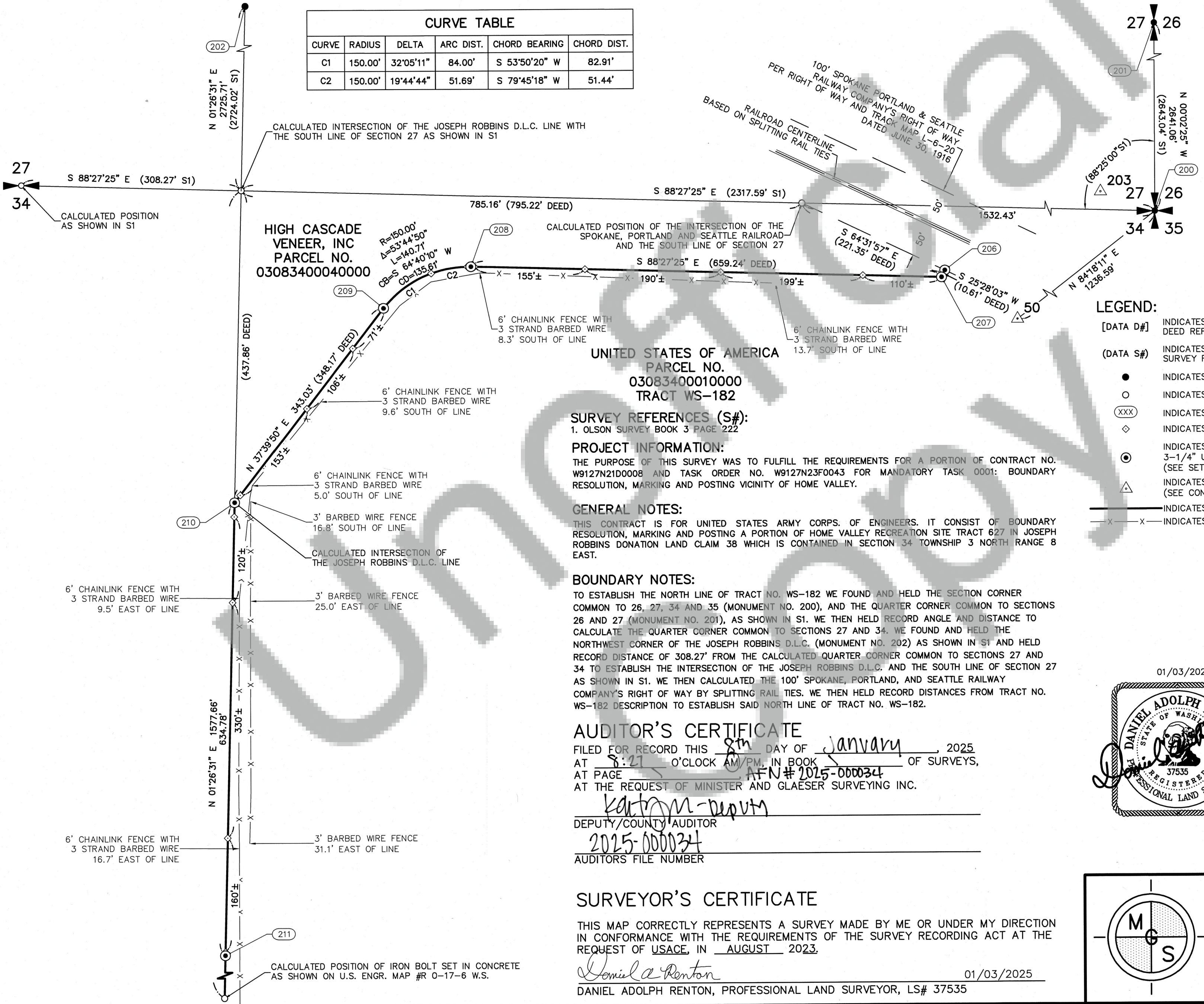

UNITED STATES OF AMERICA
PARCEL NO.
03083400010000
TRACT WS-182

SURVEY REFERENCES (S#):
1. OLSON SURVEY BOOK 3 PAGE 222

PROJECT INFORMATION:
THE PURPOSE OF THIS SURVEY WAS TO FULFILL THE REQUIREMENTS FOR A PORTION OF CONTRACT NO. W9127N21D0008 AND TASK ORDER NO. W9127N23F00043 FOR MANDATORY TASK 0001: BOUNDARY RESOLUTION, MARKING AND POSTING VICINITY OF HOME VALLEY.

GENERAL NOTES:
THIS CONTRACT IS FOR UNITED STATES ARMY CORPS. OF ENGINEERS. IT CONSIST OF BOUNDARY RESOLUTION, MARKING AND POSTING A PORTION OF HOME VALLEY RECREATION SITE TRACT 627 IN JOSEPH ROBBINS DONATION LAND CLAIM 38 WHICH IS CONTAINED IN SECTION 34 TOWNSHIP 3 NORTH RANGE 8 EAST.

BOUNDARY NOTES:
TO ESTABLISH THE NORTH LINE OF TRACT NO. WS-182 WE FOUND AND HELD THE SECTION CORNER COMMON TO 26, 27, 34 AND 35 (MONUMENT NO. 200), AND THE QUARTER CORNER COMMON TO SECTIONS 26 AND 27 (MONUMENT NO. 201), AS SHOWN IN S1. WE THEN HELD RECORD ANGLE AND DISTANCE TO CALCULATE THE QUARTER CORNER COMMON TO SECTIONS 27 AND 34. WE FOUND AND HELD THE NORTHWEST CORNER OF THE JOSEPH ROBBINS D.L.C. (MONUMENT NO. 202) AS SHOWN IN S1 AND HELD RECORD DISTANCE OF 308.27' FROM THE CALCULATED QUARTER CORNER COMMON TO SECTIONS 27 AND 34 TO ESTABLISH THE INTERSECTION OF THE JOSEPH ROBBINS D.L.C. AND THE SOUTH LINE OF SECTION 27 AS SHOWN IN S1. WE THEN CALCULATED THE 100' SPOKANE, PORTLAND, AND SEATTLE RAILWAY COMPANY'S RIGHT OF WAY BY SPLITTING RAIL TIES. WE THEN HELD RECORD DISTANCES FROM TRACT NO. WS-182 DESCRIPTION TO ESTABLISH SAID NORTH LINE OF TRACT NO. WS-182.

AUDITOR'S CERTIFICATE
FILED FOR RECORD THIS 8th DAY OF January, 2025
AT 8:41 O'CLOCK AM/PM, IN BOOK S OF SURVEYS,
AT PAGE AFN# 2025-000034
AT THE REQUEST OF MINISTER AND GLAESER SURVEYING INC.
Kathryn - Deputy
DEPUTY/COUNTY AUDITOR
2025-000034
AUDITORS' FILE NUMBER

SURVEYOR'S CERTIFICATE
THIS MAP CORRECTLY REPRESENTS A SURVEY MADE BY ME OR UNDER MY DIRECTION IN CONFORMANCE WITH THE REQUIREMENTS OF THE SURVEY RECORDING ACT AT THE REQUEST OF USACE, IN AUGUST 2023.
Daniel A. Renton
01/03/2025
DANIEL ADOLPH RENTON, PROFESSIONAL LAND SURVEYOR, LS# 37535

- LEGEND:
- [DATA D#] INDICATES RECORD DATA PER DEED REFERENCE NUMBER
 - [DATA S#] INDICATES RECORD DATA PER SURVEY REFERENCE NUMBER
 - INDICATES MONUMENT FOUND AS NOTED IN TABLE
 - INDICATES CALCULATED POSITION
 - XXX INDICATES MONUMENT TAG AND NUMBER
 - ◇ INDICATES CARSONITE POST SET POINT ON LINE
 - ⊙ INDICATES 5/8" x 30" REBAR WITH 3-1/4" USACE ALUMINUM CAP, SET (SEE SET MONUMENT TABLE SHEET 2 OF 2)
 - △ INDICATES MGS CONTROL POINT (SEE CONTROL DIAGRAM SHEET 2 OF 2)
 - INDICATES BOUNDARY
 - x-x- INDICATES FENCE LINE

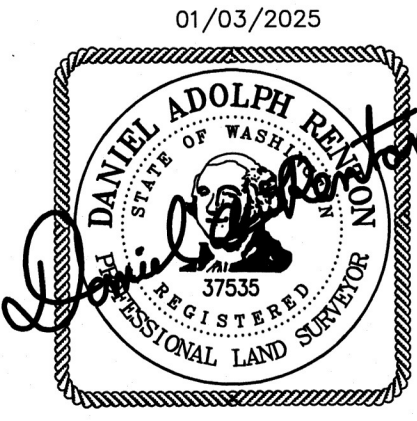

BASIS OF BEARING:
NAD 83(2011) (EPOCH: 2010.0000) WASHINGTON
STATE PLANE COORDINATE SYSTEM SOUTH ZONE,
U.S. SURVEY FEET
N 62°00'28" W, BETWEEN CONTROL POINTS
LABELED 50 & 51 AS SHOWN ON THIS SURVEY

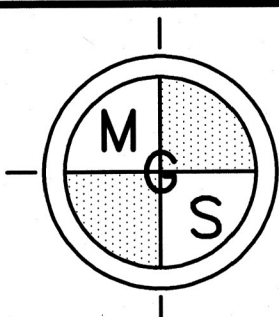

MINISTER-GLAESER
SURVEYING INC.
2200 E. EVERGREEN BLVD.
VANCOUVER, WA 98661
(360) 694-3313

RECORD OF SURVEY

OF THE HOME VALLEY PARK SITE
LOCATED IN THE JOSEPH ROBBINS D.L.C.
IN A PORTION OF
THE NW 1/4 OF THE NE 1/4
OF SECTION 34
T. 3 N., R 8 E., W.M.
SKAMANIA COUNTY, WASHINGTON



US Army Corps
of Engineers®

PREPARED FOR:
U.S. ARMY CORPS OF ENGINEERS
PORTLAND DISTRICT
333 SW FIRST AVE
PORTLAND OR 97204

SURVEY DATE:
01-03-2025

DESIGNED BY:
DANIEL A. RENTON

U.S. ARMY
CORPS OF ENGINEERS
PORTLAND DISTRICT
333 SW FIRST AVE
PORTLAND OR 97204

RECORD OF SURVEY
2023 REAL ESTATE SURVEYS
CONTRACT NO. W9127N21D0008, MINISTER & GLAESER
PREAWARD NO. PANNWD-23-P-0000-003621
TASK ORDER W9127N23F0043
MANDATORY TASK 0001: BOUNDARY RESOLUTION, MARKING
AND POSTING VICINITY OF HOME VALLEY PARK

SHEET
IDENTIFICATION
2 OF 2

FOUND MONUMENT
NO. 200

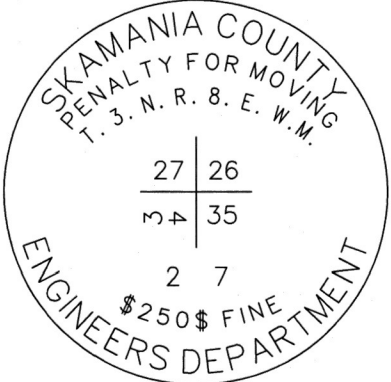

FOUND MONUMENT
NO. 201

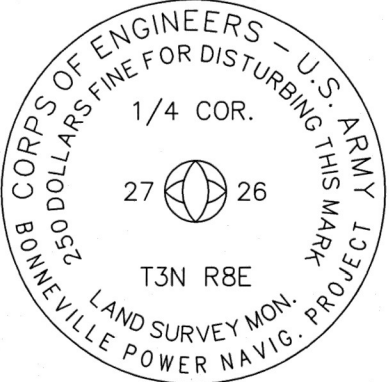

FOUND MONUMENT
NO. 202

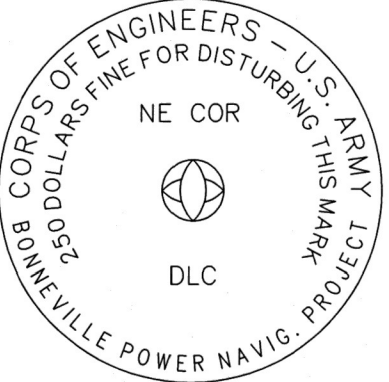

FOUND MONUMENT TABLE			
POINT NO.	NORTHING	EASTING	DESCRIPTION
200	140499.45	1315167.59	3" BRASS DISK (HELD)
201	143140.52	1315165.74	4" BRASS DISK (HELD)
202	143286.70	1312919.44	3 1/2" BRASS DISK (HELD)

SET MONUMENT TABLE		
POINT NO.	NORTHING	EASTING
206	140445.55	1313835.57
207	140435.94	1313830.98
208	140453.70	1313171.97
209	140395.67	1313049.43
210	140124.16	1312839.83
211	139489.56	1312823.83

SET MONUMENT
NO. 206

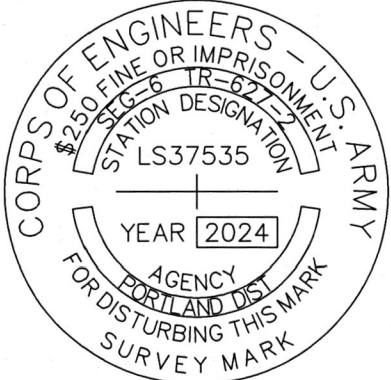

SET MONUMENT
NO. 207

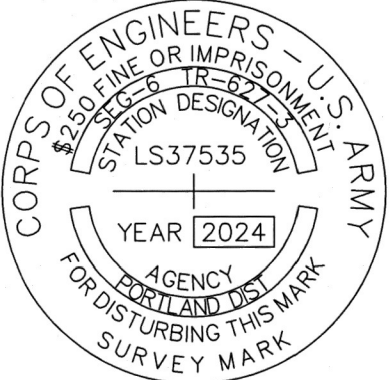

SET MONUMENT
NO. 208

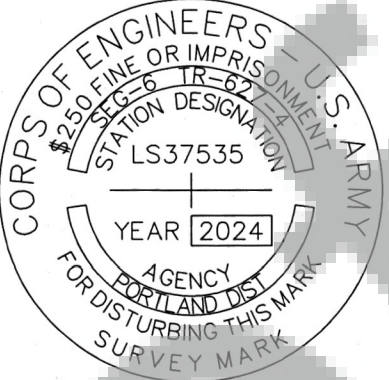

SET MONUMENT
NO. 209

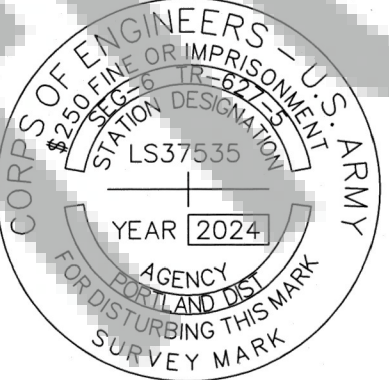

SET MONUMENT
NO. 210

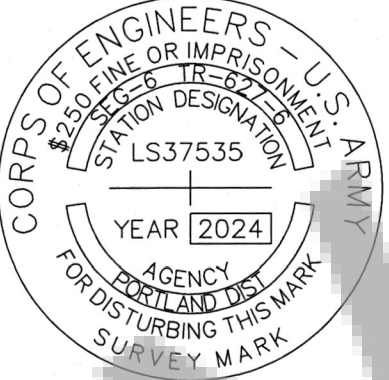

SET MONUMENT
NO. 211

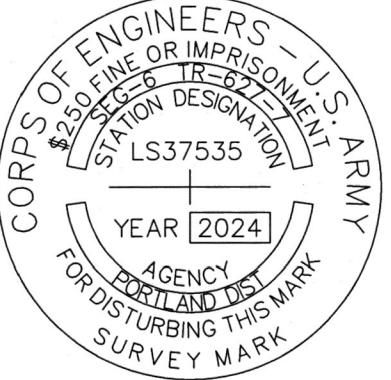

CONTROL PROCEDURE:

A TRIMBLE R12 GNSS BASE RECEIVER WAS USED TO COLLECT OVER 8 HOURS OF STATIC DATA ON THE PRIMARY CONTROL POINTS 50 AND 51. THE STATIC DATA WAS THEN POST PROCESSED USING THE NATIONAL GEODETIC SURVEY ONLINE POSITIONING USER SERVICE (OPUS).
THE MONUMENTS SHOWN HEREIN WERE TIED AND SET DIRECTLY USING A TRIMBLE R12 GNSS BASE RECEIVER OPERATING IN A REAL TIME KINEMATIC (RTK) MODE, WHILE SET ON THE PRIMARY OPUS CONTROL AND TRANSMITTING REAL TIME CORRECTIONS TO A TRIMBLE R12I GNSS RECEIVER ALSO OPERATING IN (RTK) MODE.

CONTROL POINT TABLE				
POINT NO.	NORTHING	EASTING	ELEV.	DESCRIPTION
50	140376.699	1313937.113	107.87	2" ALUMINUM CAP PID:BBJW81
51	141958.549	1310961.100	104.22	2" ALUMINUM CAP PID:BBJW82
203	140555.025	1314053.996	115.63	2" ALUMINUM CAP

LEGEND:

INDICATES MGS CONTROL POINT

CONTROL POINT: 50

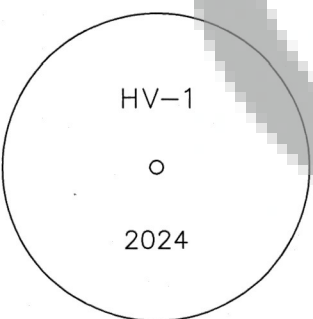

CONTROL POINT: 51

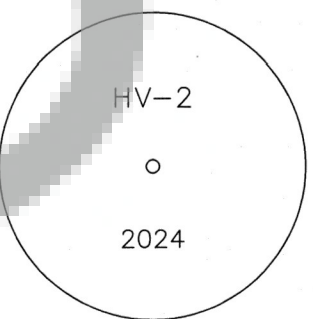

CONTROL POINT: 203

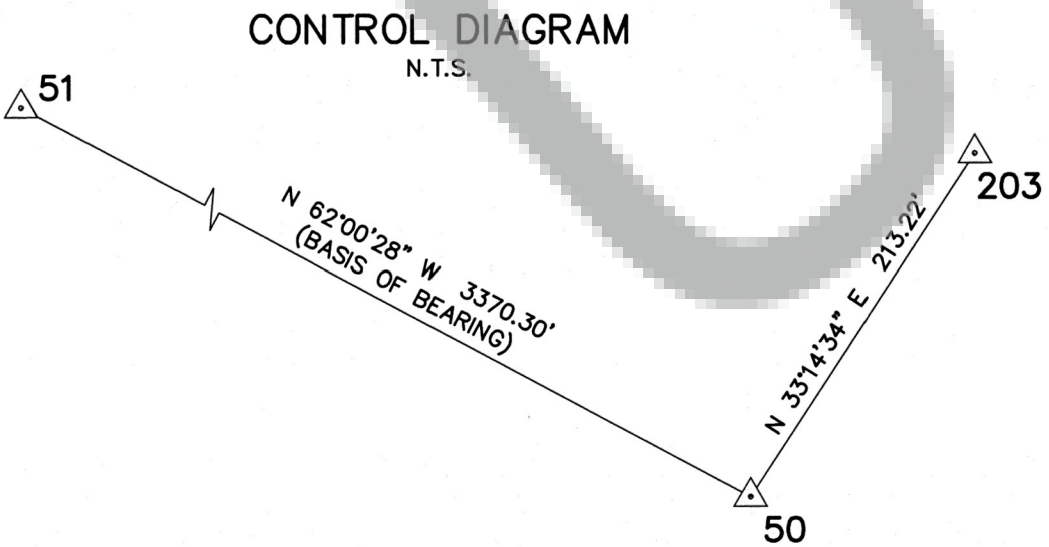

LEGEND:

- [DATA D#] INDICATES RECORD DATA PER DEED REFERENCE NUMBER
- [DATA S#] INDICATES RECORD DATA PER SURVEY REFERENCE NUMBER
- INDICATES MONUMENT FOUND AS NOTED IN TABLE
- INDICATES CALCULATED POSITION
- (XXX) INDICATES MONUMENT TAG AND NUMBER
- ◇ INDICATES CARSONITE POST SET POINT ON LINE
- ⊙ INDICATES 5/8" x 30" REBAR WITH 3-1/4" USACE ALUMINUM CAP, SET (SEE SET MONUMENT TABLE)
- △ INDICATES MGS CONTROL POINT (SEE CONTROL DIAGRAM)
- x—x— INDICATES BOUNDARY
- x—x— INDICATES FENCE LINE

01-03-2025

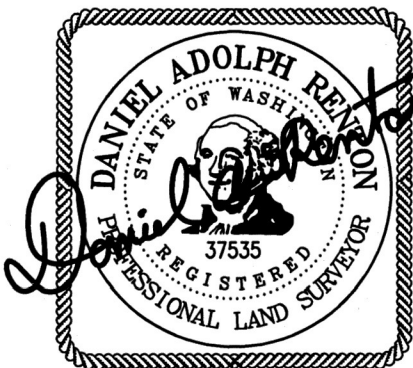

BASIS OF BEARING:
NAD 83(2011)(EPOCH:2010.0000) WASHINGTON
STATE PLANE COORDINATE SYSTEM SOUTH ZONE,
U.S. SURVEY FEET
N 62°00'28" W, BETWEEN CONTROL POINTS
LABELED 50 & 51 AS SHOWN ON THIS SURVEY

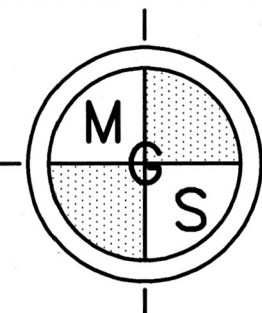

MINISTER-GLAESER
SURVEYING INC.
2200 E. EVERGREEN BLVD.
VANCOUVER, WA 98661
(360) 694-3313

HORIZONTAL DATUM:
NAD 83(2011)(EPOCH:2010.000) WASHINGTON STATE PLANE
COORDINATE SYSTEM SOUTH ZONE,
N 62°00'28" W, BETWEEN CONTROL POINTS
LABELED 50 & 51 AS SHOWN ON THIS SURVEY