

AFTER RECORDING, MAIL TO:
Brewer Exploration
26 Hay Hook Dr.
Salmon, ID 83467

NOTICE & CERTIFICATE OF LOCATION
LODE MINING CLAIM – WASHINGTON

Name and address of the locator is: **Stream Metals LLC., PO Box 1928, Laramie, WY 82073**

The name of the Lode mining claim being Queen 1

Located on the 15 day of June 2024

The Lode Mining Claim is situated in the unknown / unnamed Mining District, Skamania County, State of Washington.

The boundaries of the claim are marked by four substantial monuments, one at each corner of the claim. Said monuments consist of wooden posts at least 4 inches in diameter and at least 4 feet in length securely set into the ground. Each monument is marked with a scribed metal tag which states the claim name and number and the location of the monument with respect to the claim. Further described as follows:

Beginning at the northeast corner of the claim, post No. 1
Thence 1,500 feet in a south direction to the southeast corner, post No. 2,
Thence 600 feet in a west direction to the southwest corner, post No. 3,
Thence 1,500 feet in a north direction to the northwest corner, post No. 4,
Thence 600 feet in an east direction, returning to post No. 1.

The claim is approximately 1,500 feet long and 600 feet wide, such that 1,470 feet are claimed in a south direction and 30 feet in a north direction from the point of discovery, at which the Notice of Location was posted, together with 300 feet on each side of the monument of location and center line of the claim. The general course of the lode or vein is from the north to south direction.

To tie this claim to the Public Survey, begin at the SW corner Sec. 33, Township 4 North, Range 5 East, Willamette Meridian; bear south approximately 1,910 feet and east approximately 1,400 feet to the Location Monument of this Claim. The claim is located in the following protracted quarter sections: **NW ¼ & SW ¼ Protracted Block (PB) 38, T3N, R5E, Willamette Meridian.**

Claimant/Locator Name and Address:

**Stream Metals LLC.
PO Box 1928
Laramie, WY 82073**

By: 
Brian T. Brewer
Brewer Exploration Inc. (agent)
26 Hay Hook Dr., Salmon, Idaho 83467

STATE OF IDAHO)
)ss.
County of Lemhi)

I, Brian T. Brewer, do solemnly swear that I am a citizen of the United States of America and that I am acquainted with the mining ground described in this notice and certificate of location and herewith called the Queen 1 lode mining claim; that the ground and claim therein described, or any part thereof, has not to the best of my knowledge and belief been previously located according to the laws of the United States and of this State, or if so located, that the same has been abandoned or forfeited by reason of the failure of such former locators to comply in respect thereto with the requirements of said laws

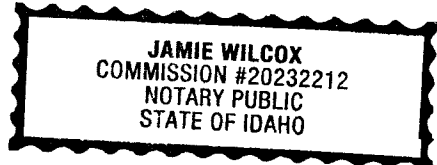

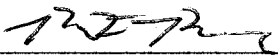
SIGNATURE: 
Brian T. Brewer (agent)

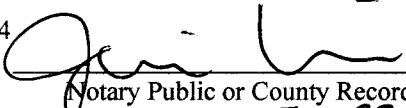
Subscribed and sworn to before me this 21st day of June 2024 
Notary Public or County Recorder
(my commission expires 5 / 22 / 29)

CLAIM MAP QUEEN LODGE CLAIMS

Part of Protracted Block (PB) 38, T3N, R5E, Willamette Meridian.,
Skamania County, Washington

The SW Cor. Sec. 33,
T4N, R5E to the NW
Cor. Queen 1 is 1,100'
east & 1,880' south

The SW Cor. Sec. 33,
T4N, R5E to the NW
Cor. Queen 4 is 3,520'
east & 640' south

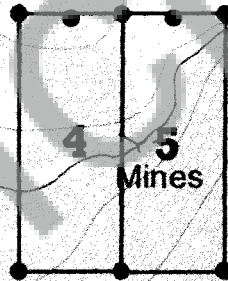
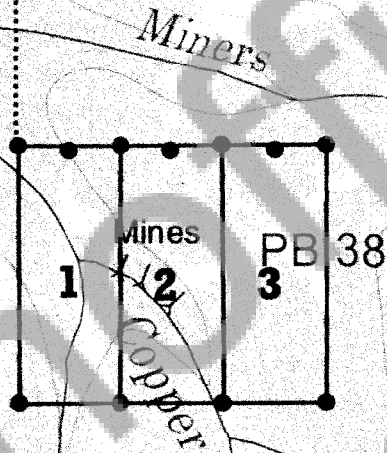

Located 15 June 2024

Stream Metals LLC
PO Box 1928
Laramie, WY 82073

Mercator Projection
WGS84
UTM Zone 10T
CALTPO

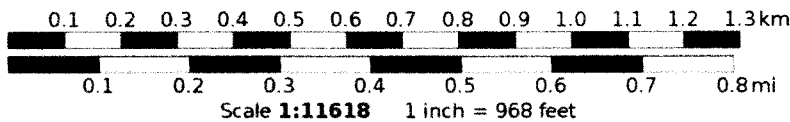

MN
14.7°