

Skamania County, WA
Total: \$340.50
BNDY
Pgs=38

2024-000561

05/13/2024 11:50 AM

Request of: RIVERBEND TIMBER LLC



Skamania County
Real Estate Excise Tax

37164

MAY 13 2024

AFTER RECORDING MAIL TO:

RIVERBEND TIMBER, LLC
22962 SR 14
Washougal, WA 98671

PAID exempt
Matthew Shaghen Skamania County Treasurer

Grantor: RIVERBEND TIMBER, LLC, a Washington limited liability company
Grantee: ANDREW R. BLOUNT, an unmarried man; RIVERBEND TIMBER, LLC, a Washington limited liability company
Assessor's Property Tax Parcel Account Number(s): 01050600010000, 01050610030000
01050610030006 (Lots 3, 4), 02053140150000 (Lot 5), 01050610030100 (Lot 6),
01050610090100 (Blount)
Abbreviated Legal: Ptn Sec 31, T2N, R5EWM, Ptn Sec 6, T1N, R5 EWM *LM 5/13/24*

BOUNDARY LINE ADJUSTMENT

WHEREAS, ANDREW R. BLOUNT, an unmarried man, is the owner of the following described real property:

SEE ATTACHED EXHIBIT "A" (the "BLOUNT parcel"); and

WHEREAS, RIVERBEND TIMBER, LLC, a Washington limited liability company, is the owner of the following described real property:

SEE ATTACHED EXHIBITS "B," "C," "D," and "E" (collectively, the "RIVERBEND parcels"); and

WHEREAS, the undersigned wish to adjust the boundary lines of the above-described parcels in settlement of a dispute and for owner convenience, and without creating any additional parcel;

NOW, THEREFORE, RIVERBEND TIMBER, LLC, a Washington limited liability company, for BOUNDARY LINE ADJUSTMENT PURPOSES AND FOR NO MONETARY CONSIDERATION, hereby conveys and quitclaims to ANDREW R. BLOUNT, an unmarried man, that real property described in the attached EXHIBIT "F" such that the legal description of the BLOUNT parcel, as adjusted hereby, shall be legally described as follows:

SEE ATTACHED EXHIBIT "G." A map of the adjusted parcel is attached hereto as EXHIBIT "M."

FURTHER, RIVERBEND TIMBER, LLC, a Washington limited liability company, for BOUNDARY LINE ADJUSTMENT PURPOSES AND FOR NO MONETARY CONSIDERATION, hereby conveys and quitclaims to RIVERBEND TIMBER, LLC, a Washington limited liability company, those portions of the real property described hereinabove such that the RIVERBEND parcels, as adjusted hereby, shall be legally described as follows:

SEE ATTACHED EXHIBITS "H," "I," "J," and "K." A map of the adjusted parcels is attached hereto as Exhibit "L."

Purpose of Deed

The purpose of this deed is to affect a boundary line adjustment between adjoining parcels of land owned by Grantor and Grantee; it is not intended to create a separate parcel, and is therefore exempt from the requirements of RCW 58.17 and the Skamania County Subdivision code. The property described in this deed cannot be segregated and sold without conforming to the State of Washington and Skamania County Subdivision laws.

DATED this 3 day of May, 2024.

RIVERBEND TIMBER, LLC

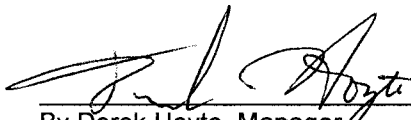

By Derek Hoyte, Manager

STATE OF WASHINGTON

COUNTY OF Clallam }

ss

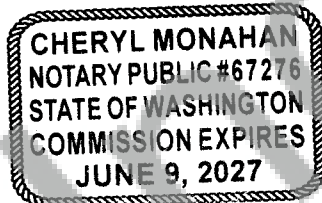
This record was acknowledged before me on May 3rd, 2024 by DEREK HOYTE on behalf of RIVERBEND TIMBER, LLC, a Washington limited liability company.

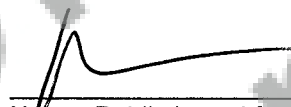

Notary Public in and for the State of Washington
My commission expires: 6/9/2027

Skamania County Community Development
- Boundary Line Adjustment

Approved by: Mandy Hartel 5/9/24

[Additional Signatures Next Page]

Skamania County Assessor RM

Date 5-13-24 Parcel# See parcels
Page # 2

////

////

////

////

DATED this 22 day of April, 2024.



ANDREW R. BLOUNT

STATE OF WASHINGTON

COUNTY OF Clark

} ss

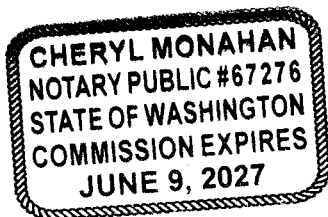
This record was acknowledged before me on April 22, 2024 by ANDREW R. BLOUNT.



Notary Public in and for the State of Washington
My commission expires: 6/9/2027

Unofficial Copy

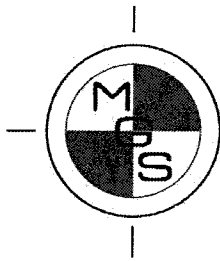

MINISTER-GLAESER SURVEYING INC.

*Vancouver Office – 2200 E. Evergreen Blvd., Vancouver, Washington 98661
(360) 694-3313 (360) 694-8410 FAX
Pasco Office – 6303 Burden Blvd. Suite E, Pasco, Washington 99301
(509) 544-7802 (509) 544-7862 FAX*



Signed: 05/03/24

EXHIBIT "A"

ANDREW BLOUNT PARCEL 01050610090100, DEED AFN 2014-001380

EXISTING PERIMETER DESCRIPTION:

A parcel of land located in the North half of the Northeast Quarter of Section 6, Township 1 North, Range 5 East of the Willamette Meridian, Skamania County, Washington, described as follows;

BEGINNING at the Southwest corner of a tract of land conveyed to Eldon D. Heller, et ux, by deed dated April 12, 1968, and recorded at Page 15 of Book 59, records of Skamania County, Washington and the **TRUE POINT OF BEGINNING**;

Thence South $87^{\circ} 26'$ East along the South line of said tract 180 feet to the Southwest corner of a tract of land conveyed to Eldon Heller, et ux, by deed recorded at Page 102 of Book 64, records of Skamania County, Washington;

Thence North 240 feet, more or less, to the center of Sportsman Road;

Thence Northwesterly along the center line of Sportsman Road to a point that is 279.38 feet North of the Point of Beginning;

Thence South $02^{\circ} 34'$ West 279.38 feet to the **TRUE POINT OF BEGINNING**.

EXCEPT any portion lying within Sportsman Road.

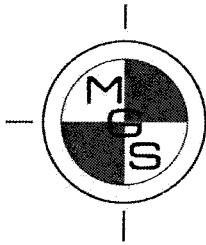

MINISTER-GLAESER SURVEYING INC.

Vancouver Office – 2200 E. Evergreen Blvd., Vancouver, Washington 98661
(360) 694-3313 (360) 694-8410 FAX
Pasco Office – 6303 Burden Blvd. Suite E, Pasco, Washington 99301
(509) 544-7802 (509) 544-7862 FAX



Signed: 05/03/24

EXHIBIT "B"

RIVERBEND TIMBER LLC EXISTING "LOT 3" DESCRIPTION:

A parcel of land located in the Northeast Quarter of the Northwest Quarter, and the Northwest Quarter and the Northeast Quarter, of the Northeast Quarter, of Section 6, Township 1 North, Range 5 East, of the Willamette Meridian, Skamania County, Washington, more particularly described as follows;

BEGINNING at the Southeast corner of the Northeast Quarter of the Northwest Quarter of said Section 6;

Thence North $88^{\circ}48'49''$ West, along the South line of said Northeast Quarter of the Northwest Quarter, for a distance of 449.93 feet;

Thence leaving said South line, North $33^{\circ}30'05''$ West, for a distance of 125.56 feet;

Thence along the arc of a tangent 65.00 foot radius curve to the right, the long chord of which bears North $05^{\circ}29'57''$ East, with a chord distance of 81.81 feet through a central angle of $78^{\circ}00'05''$, for an arc distance of 88.49 feet;

Thence North $44^{\circ}30'00''$ East, for a distance of 146.05 feet;

Thence along the arc of a tangent 81.00 foot radius curve to the left, the long chord of which bears North $34^{\circ}15'00''$ West, with a chord distance of 158.89 feet through a central angle of $157^{\circ}30'00''$, for an arc distance of 222.66 feet;

Thence South $67^{\circ}00'00''$ West, for a distance of 105.00 feet;

Thence along the arc of a tangent 55.00 foot radius curve to the right, the long chord of which bears North $74^{\circ}52'30''$ West, with a chord distance of 67.91 feet through a central angle of $76^{\circ}15'00''$, for an arc distance of 73.19 feet;

Thence North $36^{\circ}45'00''$ West, for a distance of 77.83 feet;

1 of 10

Thence along the arc of a tangent 180.00 foot radius curve to the left, the long chord of which bears North $60^{\circ}58'16''$ West, with a chord distance of 147.69 feet through a central angle of $48^{\circ}26'31''$, for an arc distance of 152.19 feet;

Thence North $85^{\circ}11'31''$ West, for a distance of 10.98 feet;

Thence along the arc of a tangent 280.00 foot radius curve to the left, the long chord of which bears South $78^{\circ}54'14''$ West, with a chord distance of 153.45 feet through a central angle of $31^{\circ}48'29''$, for an arc distance of 155.44 feet;

Thence South $63^{\circ}00'00''$ West, for a distance of 71.83 feet;

Thence along the arc of a tangent 20.00 foot radius curve to the right, the long chord of which bears North $40^{\circ}22'30''$ West, with a chord distance of 38.92 feet through a central angle of $153^{\circ}15'00''$, for an arc distance of 53.49 feet;

Thence North $36^{\circ}15'00''$ East, for a distance of 96.72 feet;

Thence North $41^{\circ}00'00''$ East, for a distance of 116.13 feet;

Thence along the arc of a tangent 370.00 foot radius curve to the right, the long chord of which bears North $45^{\circ}00'00''$ East, with a chord distance of 51.62 feet through a central angle of $08^{\circ}00'00''$, for an arc distance of 51.66 feet;

Thence North $49^{\circ}00'00''$ East, for a distance of 81.10 feet;

Thence along the arc of a tangent 430.00 foot radius curve to the left, the long chord of which bears North $39^{\circ}30'00''$ East, with a chord distance of 141.94 feet through a central angle of $19^{\circ}00'00''$, for an arc distance of 142.59 feet;

Thence North $30^{\circ}00'00''$ East, for a distance of 81.90 feet;

Thence along the arc of a tangent 120.00 foot radius curve to the right, the long chord of which bears North $47^{\circ}45'00''$ East, with a chord distance of 73.17 feet through a central angle of $35^{\circ}30'00''$, for an arc distance of 74.35 feet;

Thence North $65^{\circ}30'00''$ East, for a distance of 17.87 feet;

Thence along the arc of a tangent 170.00 foot radius curve to the right, the long chord of which bears North $87^{\circ}30'00''$ East, with a chord distance of 127.37 feet through a central angle of $44^{\circ}00'00''$, for an arc distance of 130.55 feet;

Thence South $70^{\circ}30'00''$ East, for a distance of 37.19 feet;

Thence along the arc of a tangent 530.00 foot radius curve to the left, the long chord of which bears South $80^{\circ}15'00''$ East, with a chord distance of 179.51 feet through a central angle of $19^{\circ}30'00''$, for an arc distance of 180.38 feet;

Thence North 90°00'00" East, for a distance of 30.00 feet;

Thence along the arc of a tangent 530.00 foot radius curve to the left, the long chord of which bears North 79°35'44" East, with a chord distance of 191.43 feet through a central angle of 20°48'33", for an arc distance of 192.49 feet;

Thence along a reverse 170.00 foot radius curve to the right, the long chord of which bears North 81°05'44" East, with a chord distance of 70.14 feet through a central angle of 23°48'33", for an arc distance of 70.64 feet;

Thence South 87°00'00" East, for a distance of 40.00 feet;

Thence along the arc of a tangent 220.00 foot radius curve to the left, the long chord of which bears North 66°18'07" East, with a chord distance of 197.69 feet through a central angle of 53°23'45", for an arc distance of 205.03 feet;

Thence South 87°00'00" East, for a distance of 141.34 feet;

Thence along the arc of a tangent 530.00 foot radius curve to the left, the long chord of which bears North 86°30'00" East, with a chord distance of 120.00 feet through a central angle of 13°00'00", for an arc distance of 120.25 feet;

Thence North 80°00'00" East, for a distance of 112.40 feet;

Thence along the arc of a tangent 180.00 foot radius curve to the right, the long chord of which bears South 73°45'00" East, with a chord distance of 159.22 feet through a central angle of 52°30'00", for an arc distance of 164.93 feet;

Thence South 47°30'00" East, for a distance of 73.77 feet;

Thence along the arc of a tangent 10.00 foot radius curve to the right, the long chord of which bears South 03°15'00" East, with a chord distance of 13.96 feet through a central angle of 88°30'00", for an arc distance of 15.45 feet;

Thence South 41°00'00" West, for a distance of 54.36 feet;

Thence along the arc of a tangent 70.00 foot radius curve to the left, the long chord of which bears South 28°15'00" West, with a chord distance of 30.90 feet through a central angle of 25°30'00", for an arc distance of 31.15 feet;

Thence South 15°30'00" West, for a distance of 63.91 feet;

Thence along the arc of a tangent 150.00 foot radius curve to the left, the long chord of which bears South 15°00'00" East, with a chord distance of 152.26 feet through a central angle of 61°00'00", for an arc distance of 159.70 feet;

Thence South 45°30'00" East, for a distance of 49.18 feet;

Thence along the arc of a tangent 230.00 foot radius curve to the left, the long chord of which bears South 52°15'00" East, with a chord distance of 54.07 feet through a central angle of 13°30'00", for an arc distance of 54.19 feet;

Thence South 59°00'00" East, for a distance of 92.23 feet;

Thence along the arc of a tangent 380.00 foot radius curve to the left, the long chord of which bears South 73°30'00" East, with a chord distance of 190.29 feet through a central angle of 29°00'00", for an arc distance of 192.34 feet;

Thence South 88°00'00" East, for a distance of 4.03 feet;

Thence South 34°00'00" West, for a distance of 229.09 feet;

Thence along the arc of a tangent 220.00 foot radius curve to the right, the long chord of which bears South 48°24'17" West, with a chord distance of 109.46 feet through a central angle of 28°48'35", for an arc distance of 110.62 feet;

Thence South 62°48'35" West, for a distance of 29.15 feet;

Thence along the arc of a tangent 45.00 foot radius curve to the right, the long chord of which bears South 79°54'17" West, with a chord distance of 26.46 feet through a central angle of 34°11'25", for an arc distance of 26.85 feet;

Thence North 83°00'00" West, for a distance of 48.39 feet;

Thence along the arc of a tangent 95.00 foot radius curve to the right, the long chord of which bears North 63°52'37" West, with a chord distance of 62.24 feet through a central angle of 38°14'45", for an arc distance of 63.41 feet;

Thence along a reverse 205.00 foot radius curve to the left, the long chord of which bears North 55°52'37" West, with a chord distance of 79.09 feet through a central angle of 22°14'45", for an arc distance of 79.59 feet;

Thence North 67°00'00" West, for a distance of 155.50 feet;

Thence along the arc of a tangent 570.00 foot radius curve to the right, the long chord of which bears North 62°00'00" West, with a chord distance of 99.36 feet through a central angle of 10°00'00", for an arc distance of 99.48 feet;

Thence North 57°00'00" West, for a distance of 156.04 feet;

Thence South 33°00'00" West, for a distance of 60.00 feet;

Thence South $57^{\circ}00'00''$ East, for a distance of 156.04 feet;

Thence along the arc of a tangent 630.00 foot radius curve to the left, the long chord of which bears South $62^{\circ}00'00''$ East, with a chord distance of 109.82 feet through a central angle of $10^{\circ}00'00''$, for an arc distance of 109.96 feet;

Thence South $67^{\circ}00'00''$ East, for a distance of 155.50 feet;

Thence along the arc of a tangent 145.00 foot radius curve to the right, the long chord of which bears South $55^{\circ}52'37''$ East, with a chord distance of 55.95 feet through a central angle of $22^{\circ}14'45''$, for an arc distance of 56.30 feet;

Thence along a reverse 155.00 foot radius curve to the left, the long chord of which bears South $63^{\circ}52'37''$ East, with a chord distance of 101.55 feet through a central angle of $38^{\circ}14'45''$, for an arc distance of 103.46 feet;

Thence South $83^{\circ}00'00''$ East, for a distance of 48.39 feet;

Thence along the arc of a tangent 105.00 foot radius curve to the left, the long chord of which bears North $79^{\circ}54'17''$ East, with a chord distance of 61.73 feet through a central angle of $34^{\circ}11'25''$, for an arc distance of 62.66 feet;

Thence North $62^{\circ}48'35''$ East, for a distance of 29.15 feet;

Thence along the arc of a tangent 280.00 foot radius curve to the left, the long chord of which bears North $48^{\circ}24'17''$ East, with a chord distance of 139.31 feet through a central angle of $28^{\circ}48'35''$, for an arc distance of 140.79 feet;

Thence North $34^{\circ}00'00''$ East, for a distance of 266.59 feet;

Thence South $88^{\circ}00'00''$ East, for a distance of 42.37 feet;

Thence South $81^{\circ}00'00''$ East, for a distance of 121.83 feet;

Thence along the arc of a tangent 70.00 foot radius curve to the right, the long chord of which bears South $72^{\circ}30'00''$ East, with a chord distance of 20.69 feet through a central angle of $17^{\circ}00'00''$, for an arc distance of 20.77 feet;

Thence South $64^{\circ}00'00''$ East, for a distance of 70.48 feet;

Thence along the arc of a tangent 530.00 foot radius curve to the left, the long chord of which bears South $75^{\circ}30'00''$ East, with a chord distance of 211.33 feet through a central angle of $23^{\circ}00'00''$, for an arc distance of 212.76 feet;

Thence South $87^{\circ}00'00''$ East, for a distance of 47.15 feet;

Thence along the arc of a tangent 230.00 foot radius curve to the left, the long chord of which bears North 84°45'00" East, with a chord distance of 66.01 feet through a central angle of 16°30'00", for an arc distance of 66.24 feet;

Thence North 76°30'00" East, for a distance of 132.46 feet;

Thence along the arc of a tangent 70.00 foot radius curve to the right, the long chord of which bears North 86°15'00" East, with a chord distance of 23.71 feet through a central angle of 19°30'00", for an arc distance of 23.82 feet;

Thence South 84°00'00" East, for a distance of 120.89 feet;

Thence along the arc of a tangent 130.00 foot radius curve to the left, the long chord of which bears North 69°30'00" East, with a chord distance of 116.01 feet through a central angle of 53°00'00", for an arc distance of 120.25 feet;

Thence North 43°00'00" East, for a distance of 47.73 feet;

Thence along the arc of a tangent 130.00 foot radius curve to the left, the long chord of which bears North 31°45'00" East, with a chord distance of 50.72 feet through a central angle of 22°30'00", for an arc distance of 51.05 feet;

Thence North 20°30'00" East, for a distance of 139.29 feet;

Thence North 43°56'40" West, being parallel with and 60.00 feet distant from the centerline of State Highway 140, also known as Canyon Creek Road, for a distance of 66.51 feet;

Thence South 20°30'00" West, for a distance of 167.98 feet;

Thence along the arc of a tangent 70.00 foot radius curve to the right, the long chord of which bears South 31°45'00" West, with a chord distance of 27.31 feet through a central angle of 22°30'00", for an arc distance of 27.49 feet;

Thence South 43°00'00" West, for a distance of 47.73 feet;

Thence along the arc of a tangent 70.00 foot radius curve to the right, the long chord of which bears South 69°30'00" West, with a chord distance of 62.47 feet through a central angle of 53°00'00", for an arc distance of 64.75 feet;

Thence North 84°00'00" West, for a distance of 120.89 feet;

Thence along the arc of a tangent 130.00 foot radius curve to the left, the long chord of which bears South 86°15'00" West, with a chord distance of 44.03 feet through a central angle of 19°30'00", for an arc distance of 44.24 feet;

Thence South $76^{\circ}30'00''$ West, for a distance of 132.46 feet;

Thence along the arc of a tangent 170.00 foot radius curve to the right, the long chord of which bears South $84^{\circ}45'00''$ West, with a chord distance of 48.79 feet through a central angle of $16^{\circ}30'00''$, for an arc distance of 48.96 feet;

Thence North $87^{\circ}00'00''$ West, for a distance of 47.15 feet;

Thence along the arc of a tangent 470.00 foot radius curve to the right, the long chord of which bears North $75^{\circ}30'00''$ West, with a chord distance of 187.41 feet through a central angle of $23^{\circ}00'00''$, for an arc distance of 188.67 feet;

Thence North $64^{\circ}00'00''$ West, for a distance of 70.48 feet;

Thence along the arc of a tangent 130.00 foot radius curve to the left, the long chord of which bears North $72^{\circ}30'00''$ West, with a chord distance of 38.43 feet through a central angle of $17^{\circ}00'00''$, for an arc distance of 38.57 feet;

Thence North $81^{\circ}00'00''$ West, for a distance of 123.67 feet;

Thence along the arc of a tangent 30.00 foot radius curve to the left, the long chord of which bears North $84^{\circ}30'00''$ West, with a chord distance of 3.66 feet through a central angle of $07^{\circ}00'00''$, for an arc distance of 3.67 feet;

Thence North $88^{\circ}00'00''$ West, for a distance of 118.99 feet;

Thence along the arc of a tangent 320.00 foot radius curve to the right, the long chord of which bears North $73^{\circ}30'00''$ West, with a chord distance of 160.24 feet through a central angle of $29^{\circ}00'00''$, for an arc distance of 161.97 feet;

Thence North $59^{\circ}00'00''$ West, for a distance of 92.23 feet;

Thence along the arc of a tangent 170.00 foot radius curve to the right, the long chord of which bears North $52^{\circ}15'00''$ West, with a chord distance of 39.96 feet through a central angle of $13^{\circ}30'00''$, for an arc distance of 40.06 feet;

Thence North $45^{\circ}30'00''$ West, for a distance of 49.18 feet;

Thence along the arc of a tangent 90.00 foot radius curve to the right, the long chord of which bears North $15^{\circ}00'00''$ West, with a chord distance of 91.36 feet through a central angle of $61^{\circ}00'00''$, for an arc distance of 95.82 feet;

Thence North $15^{\circ}30'00''$ East, for a distance of 63.91 feet;

Thence along the arc of a tangent 10.00 foot radius curve to the right, the long chord of which bears North 28°15'00" East, with a chord distance of 4.41 feet through a central angle of 25°30'00", for an arc distance of 4.45 feet;

Thence North 41°00'00" East, for a distance of 54.36 feet;

Thence along the arc of a tangent 70.00 foot radius curve to the left, the long chord of which bears North 03°15'00" West, with a chord distance of 97.69 feet through a central angle of 88°30'00", for an arc distance of 108.12 feet;

Thence North 47°30'00" West, for a distance of 73.77 feet;

Thence along the arc of a tangent 240.00 foot radius curve to the left, the long chord of which bears North 73°45'00" West, with a chord distance of 212.30 feet through a central angle of 52°30'00", for an arc distance of 219.91 feet;

Thence South 80°00'00" West, for a distance of 112.40 feet;

Thence along the arc of a tangent 470.00 foot radius curve to the right, the long chord of which bears South 86°30'00" West, with a chord distance of 106.41 feet through a central angle of 13°00'00", for an arc distance of 106.64 feet;

Thence North 87°00'00" West, for a distance of 165.60 feet;

Thence North 60°52'42" West, for a distance of 50.05 feet;

Thence North 28°30'00" West, for a distance of 53.64 feet;

Thence North 06°00'00" West, to the North Quarter Section corner of said Section 6, for a distance of 101.32 feet;

Thence South 89°00'15" East, along the North line of said Section 6, for a distance of 998.19 feet;

Thence leaving said North line, South 03°45'23" West, being parallel with and 110.00 feet distant from the West line of the "Parker" parcel as described and recorded on May 20, 1925 at Page 205 of Book "Y" deed records of Skamania County, for a distance of 476.61 feet;

Thence South 86°14'37" East, being parallel with and 73.75 feet distant from the South line of said "Parker" parcel, for a distance of 577.26 feet;

Thence North 03°45'23" East, for a distance of 73.75 feet, to a point on the South line of said "Parker" parcel;

Thence South 86°14'37" East, along said South line, for a distance of 287.35 feet, to an angle point;

8

Thence North 32°41'23" East, for a distance of 146.85 feet, to the West right-of-way line of said State Highway 140;

Thence South 43°56'40" East, along said West right-of-way line, for a distance of 320.43 feet;

Thence South 46°03'20" West, along said West right-of-way line, for a distance of 10.00 feet;

Thence South 43°56'40" East, along said West right-of-way line, for a distance of 274.03 feet, to a point on the centerline of Fleming Creek;

Thence the following courses and distances along said Fleming Creek;

Thence South 45°49'25" West, for a distance of 265.00 feet;

Thence South 35°49'25" West, for a distance of 59.00 feet;

Thence South 22°29'25" West, for a distance of 77.00 feet;

Thence South 45°39'25" West, for a distance of 92.00 feet;

Thence South 55°59'25" West, for a distance of 86.00 feet;

Thence South 36°39'25" West, for a distance of 68.00 feet;

Thence South 49°19'25" West, for a distance of 62.00 feet;

Thence South 22°09'25" West, for a distance of 64.00 feet;

Thence South 32°59'25" West, for a distance of 10.28 feet, to a point on the North line of the "Kennedy Davis, ET AL" parcel as described and recorded on September 25, 1990 at Page 726 of Book 120 deed records of Skamania County, and shown in Hagedorn Survey, Book 3, Page 73 Skamania County auditor's file records;

Thence North 88°47'09" West, along the North line of said "Kennedy Davis ET AL" parcel for a distance of 1903.60 feet to a point on the West line of the Northeast Quarter of Section 6 as shown in said Hagedorn Survey, Book 3, Page 73 Skamania County auditor's file records;

Thence North 01°24'30" East, along said West line for a distance of 4.45 feet to the **POINT OF BEGINNING**;

EXCEPTING THEREFROM the South Half of the Northwest Quarter of the Northwest Quarter of said Section 6.

TOGETHER with and subject to easements, reservations, covenants, and restrictions apparent or of record.

CONTAINING: 64.74 acres of land, more or less.

Unofficial
Copy

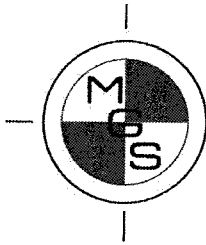

MINISTER-GLAESER SURVEYING INC.

*Vancouver Office – 2200 E. Evergreen Blvd., Vancouver, Washington 98661
(360) 694-3313 (360) 694-8410 FAX
Pasco Office – 6303 Burden Blvd. Suite E, Pasco, Washington 99301
(509) 544-7802 (509) 544-7862 FAX*

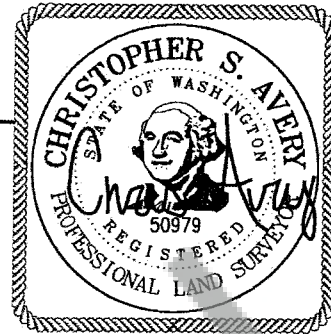

Signed: 05/03/24

EXHIBIT "C"

RIVERBEND TIMBER LLC EXISTING "LOT 4" DESCRIPTION:

A parcel of land located in the Northwest Quarter and the Northeast Quarter, of the Northeast Quarter, of Section 6, Township 1 North, Range 5 East, of the Willamette Meridian, Skamania County, Washington, more particularly described as follows;

COMMENCING at the North Quarter Section corner of said Section 6;

Thence South 89°00'15" East, along the North line of said Section 6, for a distance of 1058.19 feet, to the **TRUE POINT OF BEGINNING**;

Thence continuing South 89°00'15" East, along said North line, for a distance of 110.13 feet, to the Northwest corner of the "Parker" parcel as described and recorded on May 20, 1925 at Page 205 of Book "Y" deed records of Skamania County;

Thence South 03°45'23" West, along the West line of said "Parker" parcel, for a distance of 408.17 feet, to the Southwest corner thereof;

Thence South 86°14'37" East, along the South line of said "Parker" parcel, for a distance of 467.26 feet;

Thence leaving said "Parker" parcel, South 03°45'23" West, for a distance of 73.75 feet;

Thence North 86°14'37" West, for a distance of 577.26 feet;

Thence North 03°45'23" East, being parallel with and 110.00 feet distant from the West line of said "Parker" parcel, for a distance of 476.61 feet, to the **TRUE POINT OF BEGINNING**;

TOGETHER with and subject to easements, reservations, covenants, and restrictions apparent or of record.

CONTAINING: 2.00 acres of land, more or less.

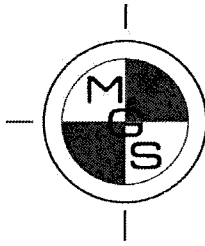

MINISTER-GLAESER SURVEYING INC.

*Vancouver Office – 2200 E. Evergreen Blvd., Vancouver, Washington 98661
(360) 694-3313 (360) 694-8410 FAX
Pasco Office – 6303 Burden Blvd. Suite E, Pasco, Washington 99301
(509) 544-7802 (509) 544-7862 FAX*

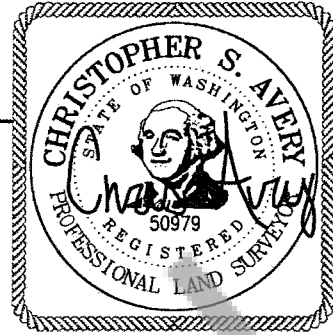

Signed: 05/03/24

EXHIBIT "D"

RIVERBEND TIMBER LLC EXISTING "LOT 5" DESCRIPTION:

A parcel of land located in the Southwest Quarter and the Southeast Quarter of the Southeast Quarter of Section 31, Township 2 North, Range 5 East, of the Willamette Meridian, Skamania County, Washington, more particularly described as follows;

The Southeast quarter of said Section 31, Township 2 North, Range 5 East lying Southerly of the center of the Washougal River, EXCEPTING THEREFROM the West 60.00 feet.

TOGETHER with and subject to easements, reservations, covenants, and restrictions apparent or of record.

CONTAINING: 10.0 acres of land, more or less.

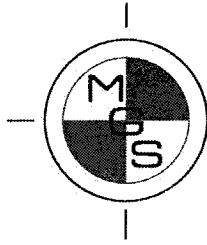

MINISTER-GLAESER SURVEYING INC.

*Vancouver Office – 2200 E. Evergreen Blvd., Vancouver, Washington 98661
(360) 694-3313 (360) 694-8410 FAX
Pasco Office – 6303 Burden Blvd. Suite E, Pasco, Washington 99301
(509) 544-7802 (509) 544-7862 FAX*

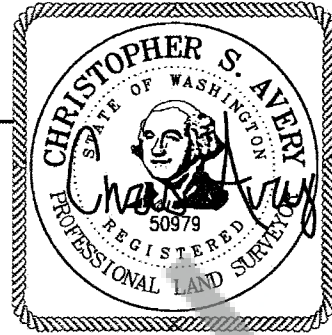

Signed: 05/03/24

EXHIBIT "E"

RIVERBEND TIMBER LLC "LOT 6" PARCEL 01050610030100, DEED 2022-000404 EXISTING PERIMETER DESCRIPTION:

A parcel of land located in the Northeast Quarter of the Northeast Quarter of Section 6, Township 1 North, Range 5 East, of the Willamette Meridian, Skamania County, Washington, more particularly described as follows:

BEGINNING at a point in the center of Secondary State Highway No.8-B, 137.5 feet North 46°04' West from the intersection of the center line of said Highway with the Easterly line of a tract of land conveyed to Ida B. Parker by Deed dated May 19, 1925 and recorded May 20, 1925 at Page 273 of Book "U" of Deeds, records of Skamania county, Washington;

Thence South 62° West, 333 feet;

Thence South 02°34' West, 90 feet to the Southerly line of the said tract conveyed to Ida B. Parker;

Thence South 87°26' East, to the intersection with the center line of said Secondary State Highway No. 8-B;

Thence following the center line of said Highway in a Northwesterly direction to the **POINT OF BEGINNING.**

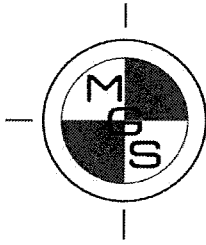

MINISTER-GLAESER SURVEYING INC.

*Vanconver Office – 2200 E. Evergreen Blvd., Vanconver, Washington 98661
(360) 694-3313 (360) 694-8410 FAX
Pasco Office – 6303 Burden Blvd. Suite E, Pasco, Washington 99301
(509) 544-7802 (509) 544-7862 FAX*

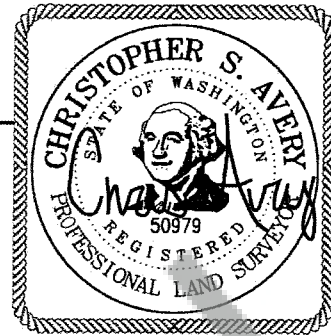

Signed: 05/03/24

EXHIBIT "F"

AREA CONVEYED FROM RIVERBEND TIMBER TO ANDREW BLOUNT:

A strip of land located in the Northwest Quarter of the Northeast Quarter, of Section 6, Township 1 North, Range 5 East, of the Willamette Meridian, Skamania County, Washington, more particularly described as follows;

COMMENCING at the Southwest corner of a tract of land conveyed to Eldon D. Heller, et ux, by deed dated April 12, 1968, and recorded at Page 15 of Book 59, records of Skamania County, Washington;

Thence South $86^{\circ}14'37''$ East, along the South line of said Heller Tract, for a distance of 23.54 feet, to the **TRUE POINT OF BEGINNING**;

Thence leaving said South line, South $59^{\circ}43'00''$ West, for a distance of 43.88 feet;

Thence North $30^{\circ}17'00''$ West, for a distance of 88.59 feet;

Thence North $59^{\circ}42'51''$ East, for a distance of 58.41 feet;

Thence North $01^{\circ}49'21''$ West, for a distance of 17.39 feet;

Thence along the arc of a tangent 5.50 foot radius curve to the right, the long chord of which bears North $26^{\circ}04'03''$ East, with a chord distance of 5.15 feet through a central angle of $55^{\circ}46'50''$, for an arc distance of 5.35 feet;

Thence North $53^{\circ}57'28''$ East, for a distance of 17.90 feet, to a point on the West line of said Heller Tract, per Deed recorded at Page 15 of Book 59;

Thence South $03^{\circ}45'23''$ West, along said East line, for a distance of 115.07 feet, to the **TRUE POINT OF BEGINNING**.

CONTAINING: 4,551 square feet of land, more or less.

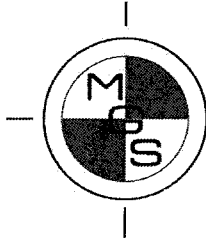

**MINISTER-GLAESER
SURVEYING INC.**

*Vancouver Office – 2200 E. Evergreen Blvd., Vancouver, Washington 98661
(360) 694-3313 (360) 694-8410 FAX
Pasco Office – 6303 Burden Blvd. Suite E, Pasco, Washington 99301
(509) 544-7802 (509) 544-7862 FAX*

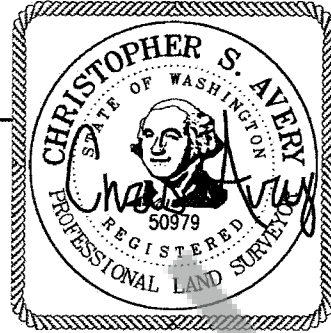

Signed: 05/03/24

EXHIBIT "G"

ANDREW BLOUNT ADJUSTED PARCEL PERIMETER DESCRIPTION:

A parcel of land located in the Northwest Quarter and the Northeast Quarter, of the Northeast Quarter, of Section 6, Township 1 North, Range 5 East, of the Willamette Meridian, Skamania County, Washington, more particularly described as follows;

A parcel of land located in the North half of the Northeast Quarter of Section 6, Township 1 North, Range 5 East of the Willamette Meridian, Skamania County, Washington, more particularly described as follows;

BEGINNING at the Southwest corner of a tract of land conveyed to Eldon D. Heller, et ux, by deed dated April 12, 1968, and recorded at Page 15 of Book 59, records of Skamania County, Washington, said Southwest corner **HEREINAFTER** referred to as **POINT "A"**;

Thence South 86°14'37" East along the South line of said tract 180 feet to the Southwest corner of a tract of land conveyed to Eldon Heller, et ux, by deed recorded at Page 102 of Book 64, records of Skamania County, Washington;

Thence North 240 feet, more or less, to the center of Sportsman Road;

Thence Northwesterly along the center line of Sportsman Road to a point that is 279.38 feet North of the Point of Beginning;

Thence South 03°45'23" West 279.38 feet to the **POINT OF BEGINNING**.

EXCEPT any portion lying within Sportsman Road.

TOGETHER WITH the following described strip of land;

BEGINNING at aforesaid **POINT "A"**;

Thence South 86°14'37" East, along the South line of said Heller Tract, for a distance of 23.54 feet;

Thence leaving said South line, South 59°43'00" West, for a distance of 43.88 feet;

Thence North 30°17'00" West, for a distance of 88.59 feet;

Thence North 59°42'51" East, for a distance of 58.41 feet;

Thence North 01°49'21" West, for a distance of 17.39 feet;

Thence along the arc of a tangent 5.50 foot radius curve to the right, the long chord of which bears North 26°04'03" East, with a chord distance of 5.15 feet through a central angle of 55°46'50", for an arc distance of 5.35 feet;

Thence North 53°57'28" East, for a distance of 17.90 feet, to a point on the West line of said Heller Tract, per Deed recorded at Page 15 of Book 59;

Thence South 03°45'23" West, along said East line, for a distance of 115.07 feet, to the **POINT OF BEGINNING** at aforesaid **POINT "A"**;

TOGETHER with and subject to easements, reservations, covenants, and restrictions apparent or of record.

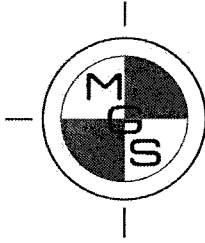

MINISTER-GLAESER SURVEYING INC.

*Vancouver Office – 2200 E. Evergreen Blvd., Vancouver, Washington 98661
(360) 694-3313 (360) 694-8410 FAX
Pasco Office – 6303 Burden Blvd. Suite E, Pasco, Washington 99301
(509) 544-7802 (509) 544-7862 FAX*

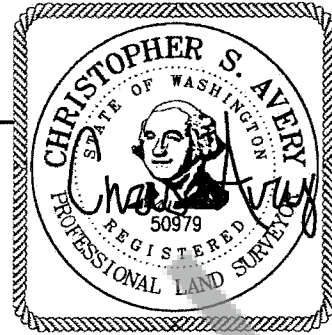

Signed: 05/03/24

EXHIBIT "H"

RIVERBEND TIMBER LLC ADJUSTED "LOT 3" DESCRIPTION:

A parcel of land located in the Northeast Quarter of the Northwest Quarter, and the Northwest Quarter and the Northeast Quarter, of the Northeast Quarter, of Section 6, Township 1 North, Range 5 East and in the Southwest Quarter of the Southeast Quarter of Section 31, Township 2 North, Range 5 East, of the Willamette Meridian, Skamania County, Washington, more particularly described as follows;

BEGINNING at the Southeast corner of the Northeast Quarter of the Northwest Quarter of said Section 6;

Thence North 88°48'49" West, along the South line of said Northeast Quarter of the Northwest Quarter, for a distance of 449.93 feet;

Thence leaving said South line, North 33°30'05" West, for a distance of 125.56 feet;

Thence along the arc of a tangent 65.00 foot radius curve to the right, the long chord of which bears North 05°29'57" East, with a chord distance of 81.81 feet through a central angle of 78°00'05", for an arc distance of 88.49 feet;

Thence North 44°30'00" East, for a distance of 146.05 feet;

Thence along the arc of a tangent 81.00 foot radius curve to the left, the long chord of which bears North 34°15'00" West, with a chord distance of 158.89 feet through a central angle of 157°30'00", for an arc distance of 222.66 feet;

Thence South 67°00'00" West, for a distance of 105.00 feet;

Thence along the arc of a tangent 55.00 foot radius curve to the right, the long chord of which bears North 74°52'30" West, with a chord distance of 67.91 feet through a central angle of 76°15'00", for an arc distance of 73.19 feet;

Thence North 36°45'00" West, for a distance of 77.83 feet;

Thence along the arc of a tangent 180.00 foot radius curve to the left, the long chord of which bears North 60°58'16" West, with a chord distance of 147.69 feet through a central angle of 48°26'31", for an arc distance of 152.19 feet;

Thence North 85°11'31" West, for a distance of 10.98 feet;

Thence along the arc of a tangent 280.00 foot radius curve to the left, the long chord of which bears South 78°54'14" West, with a chord distance of 153.45 feet through a central angle of 31°48'29", for an arc distance of 155.44 feet;

Thence South 63°00'00" West, for a distance of 71.83 feet;

Thence along the arc of a tangent 20.00 foot radius curve to the right, the long chord of which bears North 40°22'30" West, with a chord distance of 38.92 feet through a central angle of 153°15'00", for an arc distance of 53.49 feet;

Thence North 36°15'00" East, for a distance of 96.72 feet;

Thence North 41°00'00" East, for a distance of 116.13 feet;

Thence along the arc of a tangent 370.00 foot radius curve to the right, the long chord of which bears North 45°00'00" East, with a chord distance of 51.62 feet through a central angle of 08°00'00", for an arc distance of 51.66 feet;

Thence North 49°00'00" East, for a distance of 81.10 feet;

Thence along the arc of a tangent 430.00 foot radius curve to the left, the long chord of which bears North 39°30'00" East, with a chord distance of 141.94 feet through a central angle of 19°00'00", for an arc distance of 142.59 feet;

Thence North 30°00'00" East, for a distance of 81.90 feet;

Thence along the arc of a tangent 120.00 foot radius curve to the right, the long chord of which bears North 47°45'00" East, with a chord distance of 73.17 feet through a central angle of 35°30'00", for an arc distance of 74.35 feet;

Thence North 65°30'00" East, for a distance of 17.87 feet;

Thence along the arc of a tangent 170.00 foot radius curve to the right, the long chord of which bears North 87°30'00" East, with a chord distance of 127.37 feet through a central angle of 44°00'00", for an arc distance of 130.55 feet;

Thence South 70°30'00" East, for a distance of 37.19 feet;

Thence along the arc of a tangent 530.00 foot radius curve to the left, the long chord of which bears South 80°15'00" East, with a chord distance of 179.51 feet through a central angle of 19°30'00", for an arc distance of 180.38 feet;

Thence North $90^{\circ}00'00''$ East, for a distance of 30.00 feet;

Thence along the arc of a tangent 530.00 foot radius curve to the left, the long chord of which bears North $79^{\circ}35'44''$ East, with a chord distance of 191.43 feet through a central angle of $20^{\circ}48'33''$, for an arc distance of 192.49 feet;

Thence along a reverse 170.00 foot radius curve to the right, the long chord of which bears North $81^{\circ}05'44''$ East, with a chord distance of 70.14 feet through a central angle of $23^{\circ}48'33''$, for an arc distance of 70.64 feet;

Thence South $87^{\circ}00'00''$ East, for a distance of 40.00 feet;

Thence along the arc of a tangent 220.00 foot radius curve to the left, the long chord of which bears North $66^{\circ}18'07''$ East, with a chord distance of 197.69 feet through a central angle of $53^{\circ}23'45''$, for an arc distance of 205.03 feet;

Thence South $87^{\circ}00'00''$ East, for a distance of 141.34 feet;

Thence along the arc of a tangent 530.00 foot radius curve to the left, the long chord of which bears North $86^{\circ}30'00''$ East, with a chord distance of 120.00 feet through a central angle of $13^{\circ}00'00''$, for an arc distance of 120.25 feet;

Thence North $80^{\circ}00'00''$ East, for a distance of 112.40 feet;

Thence along the arc of a tangent 180.00 foot radius curve to the right, the long chord of which bears South $73^{\circ}45'00''$ East, with a chord distance of 159.22 feet through a central angle of $52^{\circ}30'00''$, for an arc distance of 164.93 feet;

Thence South $47^{\circ}30'00''$ East, for a distance of 73.77 feet;

Thence along the arc of a tangent 10.00 foot radius curve to the right, the long chord of which bears South $03^{\circ}15'00''$ East, with a chord distance of 13.96 feet through a central angle of $88^{\circ}30'00''$, for an arc distance of 15.45 feet;

Thence South $41^{\circ}00'00''$ West, for a distance of 54.36 feet;

Thence along the arc of a tangent 70.00 foot radius curve to the left, the long chord of which bears South $28^{\circ}15'00''$ West, with a chord distance of 30.90 feet through a central angle of $25^{\circ}30'00''$, for an arc distance of 31.15 feet;

Thence South $15^{\circ}30'00''$ West, for a distance of 63.91 feet;

Thence along the arc of a tangent 150.00 foot radius curve to the left, the long chord of which bears South $15^{\circ}00'00''$ East, with a chord distance of 152.26 feet through a central angle of $61^{\circ}00'00''$, for an arc distance of 159.70 feet;

Thence South $45^{\circ}30'00''$ East, for a distance of 49.18 feet;

Thence along the arc of a tangent 230.00 foot radius curve to the left, the long chord of which bears South $52^{\circ}15'00''$ East, with a chord distance of 54.07 feet through a central angle of $13^{\circ}30'00''$, for an arc distance of 54.19 feet;

Thence South $59^{\circ}00'00''$ East, for a distance of 92.23 feet;

Thence along the arc of a tangent 380.00 foot radius curve to the left, the long chord of which bears South $73^{\circ}30'00''$ East, with a chord distance of 190.29 feet through a central angle of $29^{\circ}00'00''$, for an arc distance of 192.34 feet;

Thence South $88^{\circ}00'00''$ East, for a distance of 4.03 feet;

Thence South $34^{\circ}00'00''$ West, for a distance of 229.09 feet;

Thence along the arc of a tangent 220.00 foot radius curve to the right, the long chord of which bears South $48^{\circ}24'17''$ West, with a chord distance of 109.46 feet through a central angle of $28^{\circ}48'35''$, for an arc distance of 110.62 feet;

Thence South $62^{\circ}48'35''$ West, for a distance of 29.15 feet;

Thence along the arc of a tangent 45.00 foot radius curve to the right, the long chord of which bears South $79^{\circ}54'17''$ West, with a chord distance of 26.46 feet through a central angle of $34^{\circ}11'25''$, for an arc distance of 26.85 feet;

Thence North $83^{\circ}00'00''$ West, for a distance of 48.39 feet;

Thence along the arc of a tangent 95.00 foot radius curve to the right, the long chord of which bears North $63^{\circ}52'37''$ West, with a chord distance of 62.24 feet through a central angle of $38^{\circ}14'45''$, for an arc distance of 63.41 feet;

Thence along a reverse 205.00 foot radius curve to the left, the long chord of which bears North $55^{\circ}52'37''$ West, with a chord distance of 79.09 feet through a central angle of $22^{\circ}14'45''$, for an arc distance of 79.59 feet;

Thence North $67^{\circ}00'00''$ West, for a distance of 155.50 feet;

Thence along the arc of a tangent 570.00 foot radius curve to the right, the long chord of which bears North $62^{\circ}00'00''$ West, with a chord distance of 99.36 feet through a central angle of $10^{\circ}00'00''$, for an arc distance of 99.48 feet;

Thence North $57^{\circ}00'00''$ West, for a distance of 156.04 feet;

Thence South $33^{\circ}00'00''$ West, for a distance of 60.00 feet;

Thence South $57^{\circ}00'00''$ East, for a distance of 156.04 feet;

Thence along the arc of a tangent 630.00 foot radius curve to the left, the long chord of which bears South $62^{\circ}00'00''$ East, with a chord distance of 109.82 feet through a central angle of $10^{\circ}00'00''$, for an arc distance of 109.96 feet;

Thence South $67^{\circ}00'00''$ East, for a distance of 155.50 feet;

Thence along the arc of a tangent 145.00 foot radius curve to the right, the long chord of which bears South $55^{\circ}52'37''$ East, with a chord distance of 55.95 feet through a central angle of $22^{\circ}14'45''$, for an arc distance of 56.30 feet;

Thence along a reverse 155.00 foot radius curve to the left, the long chord of which bears South $63^{\circ}52'37''$ East, with a chord distance of 101.55 feet through a central angle of $38^{\circ}14'45''$, for an arc distance of 103.46 feet;

Thence South $83^{\circ}00'00''$ East, for a distance of 48.39 feet;

Thence along the arc of a tangent 105.00 foot radius curve to the left, the long chord of which bears North $79^{\circ}54'17''$ East, with a chord distance of 61.73 feet through a central angle of $34^{\circ}11'25''$, for an arc distance of 62.66 feet;

Thence North $62^{\circ}48'35''$ East, for a distance of 29.15 feet;

Thence along the arc of a tangent 280.00 foot radius curve to the left, the long chord of which bears North $48^{\circ}24'17''$ East, with a chord distance of 139.31 feet through a central angle of $28^{\circ}48'35''$, for an arc distance of 140.79 feet;

Thence North $34^{\circ}00'00''$ East, for a distance of 266.59 feet;

Thence South $88^{\circ}00'00''$ East, for a distance of 42.37 feet;

Thence South $81^{\circ}00'00''$ East, for a distance of 121.83 feet;

Thence along the arc of a tangent 70.00 foot radius curve to the right, the long chord of which bears South $72^{\circ}30'00''$ East, with a chord distance of 20.69 feet through a central angle of $17^{\circ}00'00''$, for an arc distance of 20.77 feet;

Thence South $64^{\circ}00'00''$ East, for a distance of 70.48 feet;

Thence along the arc of a tangent 530.00 foot radius curve to the left, the long chord of which bears South $75^{\circ}30'00''$ East, with a chord distance of 211.33 feet through a central angle of $23^{\circ}00'00''$, for an arc distance of 212.76 feet;

Thence South $87^{\circ}00'00''$ East, for a distance of 47.15 feet;

Thence along the arc of a tangent 230.00 foot radius curve to the left, the long chord of which bears North $84^{\circ}45'00''$ East, with a chord distance of 66.01 feet through a central angle of $16^{\circ}30'00''$, for an arc distance of 66.24 feet;

Thence North $76^{\circ}30'00''$ East, for a distance of 132.46 feet;

Thence along the arc of a tangent 70.00 foot radius curve to the right, the long chord of which bears North $86^{\circ}15'00''$ East, with a chord distance of 23.71 feet through a central angle of $19^{\circ}30'00''$, for an arc distance of 23.82 feet;

Thence South $84^{\circ}00'00''$ East, for a distance of 120.89 feet;

Thence along the arc of a tangent 130.00 foot radius curve to the left, the long chord of which bears North $69^{\circ}30'00''$ East, with a chord distance of 116.01 feet through a central angle of $53^{\circ}00'00''$, for an arc distance of 120.25 feet;

Thence North $43^{\circ}00'00''$ East, for a distance of 47.73 feet;

Thence along the arc of a tangent 130.00 foot radius curve to the left, the long chord of which bears North $31^{\circ}45'00''$ East, with a chord distance of 50.72 feet through a central angle of $22^{\circ}30'00''$, for an arc distance of 51.05 feet;

Thence North $20^{\circ}30'00''$ East, for a distance of 139.29 feet;

Thence North $43^{\circ}56'40''$ West, being parallel with and 60.00 feet distant from the centerline of State Highway 140, also known as Canyon Creek Road, for a distance of 66.51 feet;

Thence South $20^{\circ}30'00''$ West, for a distance of 167.98 feet;

Thence along the arc of a tangent 70.00 foot radius curve to the right, the long chord of which bears South $31^{\circ}45'00''$ West, with a chord distance of 27.31 feet through a central angle of $22^{\circ}30'00''$, for an arc distance of 27.49 feet;

Thence South $43^{\circ}00'00''$ West, for a distance of 47.73 feet;

Thence along the arc of a tangent 70.00 foot radius curve to the right, the long chord of which bears South $69^{\circ}30'00''$ West, with a chord distance of 62.47 feet through a central angle of $53^{\circ}00'00''$, for an arc distance of 64.75 feet;

Thence North $84^{\circ}00'00''$ West, for a distance of 120.89 feet;

Thence along the arc of a tangent 130.00 foot radius curve to the left, the long chord of which bears South $86^{\circ}15'00''$ West, with a chord distance of 44.03 feet through a central angle of $19^{\circ}30'00''$, for an arc distance of 44.24 feet;

Thence South $76^{\circ}30'00''$ West, for a distance of 132.46 feet;

Thence along the arc of a tangent 170.00 foot radius curve to the right, the long chord of which bears South $84^{\circ}45'00''$ West, with a chord distance of 48.79 feet through a central angle of $16^{\circ}30'00''$, for an arc distance of 48.96 feet;

Thence North $87^{\circ}00'00''$ West, for a distance of 47.15 feet;

Thence along the arc of a tangent 470.00 foot radius curve to the right, the long chord of which bears North $75^{\circ}30'00''$ West, with a chord distance of 187.41 feet through a central angle of $23^{\circ}00'00''$, for an arc distance of 188.67 feet;

Thence North $64^{\circ}00'00''$ West, for a distance of 70.48 feet;

Thence along the arc of a tangent 130.00 foot radius curve to the left, the long chord of which bears North $72^{\circ}30'00''$ West, with a chord distance of 38.43 feet through a central angle of $17^{\circ}00'00''$, for an arc distance of 38.57 feet;

Thence North $81^{\circ}00'00''$ West, for a distance of 123.67 feet;

Thence along the arc of a tangent 30.00 foot radius curve to the left, the long chord of which bears North $84^{\circ}30'00''$ West, with a chord distance of 3.66 feet through a central angle of $07^{\circ}00'00''$, for an arc distance of 3.67 feet;

Thence North $88^{\circ}00'00''$ West, for a distance of 118.99 feet;

Thence along the arc of a tangent 320.00 foot radius curve to the right, the long chord of which bears North $73^{\circ}30'00''$ West, with a chord distance of 160.24 feet through a central angle of $29^{\circ}00'00''$, for an arc distance of 161.97 feet;

Thence North $59^{\circ}00'00''$ West, for a distance of 92.23 feet;

Thence along the arc of a tangent 170.00 foot radius curve to the right, the long chord of which bears North $52^{\circ}15'00''$ West, with a chord distance of 39.96 feet through a central angle of $13^{\circ}30'00''$, for an arc distance of 40.06 feet;

Thence North $45^{\circ}30'00''$ West, for a distance of 49.18 feet;

Thence along the arc of a tangent 90.00 foot radius curve to the right, the long chord of which bears North $15^{\circ}00'00''$ West, with a chord distance of 91.36 feet through a central angle of $61^{\circ}00'00''$, for an arc distance of 95.82 feet;

Thence North $15^{\circ}30'00''$ East, for a distance of 63.91 feet;

Thence along the arc of a tangent 10.00 foot radius curve to the right, the long chord of which bears North 28°15'00" East, with a chord distance of 4.41 feet through a central angle of 25°30'00", for an arc distance of 4.45 feet;

Thence North 41°00'00" East, for a distance of 54.36 feet;

Thence along the arc of a tangent 70.00 foot radius curve to the left, the long chord of which bears North 03°15'00" West, with a chord distance of 97.69 feet through a central angle of 88°30'00", for an arc distance of 108.12 feet;

Thence North 47°30'00" West, for a distance of 73.77 feet;

Thence along the arc of a tangent 240.00 foot radius curve to the left, the long chord of which bears North 73°45'00" West, with a chord distance of 212.30 feet through a central angle of 52°30'00", for an arc distance of 219.91 feet;

Thence South 80°00'00" West, for a distance of 112.40 feet;

Thence along the arc of a tangent 470.00 foot radius curve to the right, the long chord of which bears South 86°30'00" West, with a chord distance of 106.41 feet through a central angle of 13°00'00", for an arc distance of 106.64 feet;

Thence North 87°00'00" West, for a distance of 165.60 feet;

Thence North 60°52'42" West, for a distance of 50.05 feet;

Thence North 28°30'00" West, for a distance of 53.64 feet;

Thence North 06°00'00" West, for a distance of 101.32 feet, to a point on the North line of said Section 6;

Thence North 01°39'45" East, parallel with and 60.00 feet East of the West line of the Southeast Quarter of said Section 31, for a distance of 40.00 feet;

Thence South 89°00'15" East, parallel with and 40.00 feet North of the North line of said Section 6, for a distance of 778.00 feet;

Thence South 01°39'45" West, parallel with and 838.00 feet East of said Southeast Quarter, for a distance of 40.00 feet, to a point on the North line of said Section 6;

Thence South 03°45'23" West, for a distance of 453.04 feet;

Thence South 86°14'37" East, for a distance of 220.00 feet;

Thence South 03°45'23" West, for a distance of 20.00 feet;

Thence South $86^{\circ}14'37''$ East, for a distance of 133.54 feet;

Thence North $03^{\circ}45'23''$ East, for a distance of 80.78 feet to a point on the South line of the tract of land conveyed to Eldon D. Heller, et ux, by deed dated April 12, 1968, and recorded at Page 15 of Book 59;

Thence South $86^{\circ}14'37''$ East, along said South line, for a distance of 443.72 feet, to the Southwest corner of the tract of land conveyed to Ida B. Parker by Deed dated May 19, 1925 and recorded May 20, 1925 at Page 273 of Book "U" of Deeds;

Thence North $03^{\circ}45'23''$ East, along the North line of said Parker Tract, for a distance of 70.57 feet, to an angle point;

Thence North $63^{\circ}07'32''$ East, along the North line of said Parker Tract, for a distance of 297.16 feet, to the West right-of-way line of said State Highway 140;

Thence South $43^{\circ}56'40''$ East, along said West right-of-way line, for a distance of 459.28 feet;

Thence South $46^{\circ}03'20''$ West, along said West right-of-way line, for a distance of 10.00 feet;

Thence South $43^{\circ}56'40''$ East, along said West right-of-way line, for a distance of 274.03 feet, to a point on the centerline of Fleming Creek;

Thence leaving said West right-of-way line, the following courses and distances along said Fleming Creek;

Thence South $45^{\circ}49'25''$ West, for a distance of 265.00 feet;

Thence South $35^{\circ}49'25''$ West, for a distance of 59.00 feet;

Thence South $22^{\circ}29'25''$ West, for a distance of 77.00 feet;

Thence South $45^{\circ}39'25''$ West, for a distance of 92.00 feet;

Thence South $55^{\circ}59'25''$ West, for a distance of 86.00 feet;

Thence South $36^{\circ}39'25''$ West, for a distance of 68.00 feet;

Thence South $49^{\circ}19'25''$ West, for a distance of 62.00 feet;

Thence South $22^{\circ}09'25''$ West, for a distance of 64.00 feet;

Thence South $32^{\circ}59'25''$ West, for a distance of 10.28 feet, to a point on the North line of the "Kennedy Davis, ET AL" parcel as described and recorded on September 25, 1990 at Page 726 of Book 120 deed records of Skamania County, and shown in Hagedorn Survey, Book 3, Page 73 Skamania County auditor's file records;

Thence North 88°47'09" West, along the North line of said "Kennedy Davis ET AL" parcel for a distance of 1903.60 feet to a point on the West line of the Northeast Quarter of Section 6 as shown in said Hagedorn Survey, Book 3, Page 73 Skamania County auditor's file records;

Thence North 01°24'30" East, along said West line for a distance of 4.45 feet to the **POINT OF BEGINNING**;

EXCEPTING THEREFROM the South Half of the Northwest Quarter of the Northwest Quarter of said Section 6.

TOGETHER with and subject to easements, reservations, covenants, and restrictions apparent or of record.

CONTAINING: 60.03 acres of land, more or less.

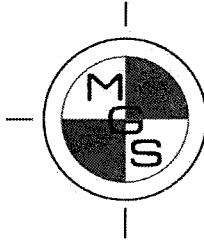

MINISTER-GLAESER SURVEYING INC.

*Vancouver Office – 2200 E. Evergreen Blvd., Vancouver, Washington 98661
(360) 694-3313 (360) 694-8410 FAX
Pasco Office – 6303 Burden Blvd. Suite E, Pasco, Washington 99301
(509) 544-7802 (509) 544-7862 FAX*

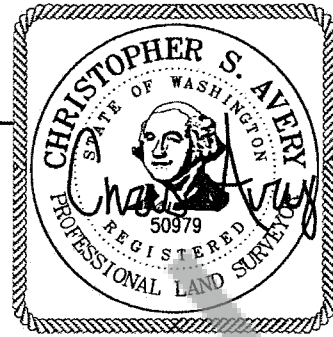

Signed: 05/03/24

EXHIBIT "I"

RIVERBEND TIMBER LLC ADJUSTED "LOT 4" DESCRIPTION:

A parcel of land located in the Northwest Quarter of the Northeast Quarter of Section 6, Township 1 North, Range 5 East, and in the Southwest Quarter and Southeast Quarter of the Southeast Quarter of Section 31, Township 2 North, Range 5 East of the Willamette Meridian, Skamania County, Washington, more particularly described as follows;

COMMENCING at the North Quarter Section corner of said Section 6;

South 89°00'15" East, for a distance of 838.00 feet to the **TRUE POINT OF BEGINNING**;

Thence North 01°39'45" East, parallel with the West line of the Southeast Quarter of said Section 31, for a distance of 119 feet, more or less, to the center of the Washougal River;

Thence Southeasterly along the center of the Washougal River, 750 feet, more or less, to a point on the North line of said Section 6;

Thence North 89°07'15" West, along said North line, for a distance of 406.40 feet to the Northwest corner of the "Parker" parcel as described and recorded on May 20, 1925 at Page 205 of Book "Y" deed records;

Thence North 89°00'15" West, continuing along said North line, for a distance of 110.13 feet;

Thence leaving said North line, South 03°45'23" West, for a distance of 427.42 feet;

Thence South 03°45'23" West, for a distance of 36.22 feet;

Thence North 86°14'37" West, for a distance of 220.00 feet;

Thence North 03°45'23" East, for a distance of 453.04 feet, to the **TRUE POINT OF BEGINNING**;

TOGETHER with and subject to easements, reservations, covenants, and restrictions apparent or of record.

CONTAINING: 3.11 acres of land, more or less.

Unofficial
Copy

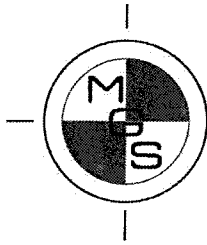

MINISTER-GLAESER SURVEYING INC.

*Vancouver Office – 2200 E. Evergreen Blvd., Vancouver, Washington 98661
(360) 694-3313 (360) 694-8410 FAX
Pasco Office – 6303 Burden Blvd. Suite E, Pasco, Washington 99301
(509) 544-7802 (509) 544-7862 FAX*

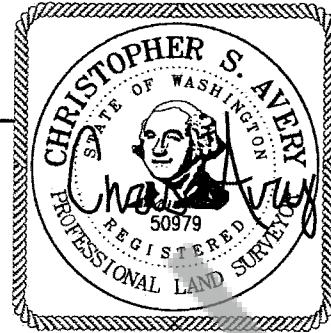

Signed: 05/03/24

EXHIBIT “J”

RIVERBEND TIMBER LLC ADJUSTED “LOT 5” DESCRIPTION:

A parcel of land located in the Southwest Quarter and the Southeast Quarter of the Southeast Quarter of Section 31, Township 2 North, Range 5 East, of the Willamette Meridian, Skamania County, Washington, more particularly described as follows;

The WEST 838 feet of the Southeast quarter of said Section 31, Township 2 North, Range 5 East lying Southerly of the center of the Washougal River, EXCEPTING THEREFROM the West 60.00 feet. ALSO EXCEPTING THEREFROM the South 40.00 feet.

TOGETHER with and subject to easements, reservations, covenants, and restrictions apparent or of record.

CONTAINING: 8.50 acres of land, more or less.

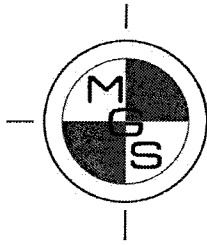

**MINISTER-GLAESER
SURVEYING INC.**

*Vancouver Office – 2200 E. Evergreen Blvd., Vancouver, Washington 98661
(360) 694-3313 (360) 694-8410 FAX
Pasco Office – 6303 Burden Blvd. Suite E, Pasco, Washington 99301
(509) 544-7802 (509) 544-7862 FAX*



Signed: 05/03/24

EXHIBIT “K”

RIVERBEND TIMBER LLC ADJUSTED “LOT 6” DESCRIPTION:

A parcel of land located in the Northwest Quarter of the Northeast Quarter of Section 6, Township 1 North, Range 5 East, of the Willamette Meridian, Skamania County, Washington, more particularly described as follows:

BEGINNING at the Southwest corner of a tract of land conveyed to Eldon D. Heller, et ux, by deed dated April 12, 1968, and recorded at Page 15 of Book 59, records of Skamania County, Washington,

Thence North $03^{\circ}45'23''$ East, along the West line of said Heller Tract, for a distance of 115.07 feet to the **TRUE POINT OF BEGINNING**;

Thence continuing North $03^{\circ}45'23''$ East, for a distance of 293.09 feet, to the Northwest corner of the “Parker” parcel as described and recorded on May 20, 1925 at Page 205 of Book “Y” deed records;

Thence North $89^{\circ}00'15''$ West, along the North line of said Section 6, for a distance of 110.13 feet;

Thence leaving said North line, South $03^{\circ}45'23''$ West, for a distance of 483.64 feet;

Thence South $86^{\circ}14'37''$ East, for a distance of 133.54 feet;

Thence North $03^{\circ}45'23''$ East, for a distance of 80.78 feet, to a point on the South line of the Parker tract per Deed 15-59;

Thence leaving said South line, South $59^{\circ}43'00''$ West, for a distance of 43.88 feet;

Thence North $30^{\circ}17'00''$ West, for a distance of 88.59 feet;

Thence North $59^{\circ}42'51''$ East, for a distance of 58.41 feet;

Thence North $01^{\circ}49'21''$ West, for a distance of 17.39 feet;

Thence along the arc of a tangent 5.50 foot radius curve to the right, the long chord of which bears North 26°04'03" East, with a chord distance of 5.15 feet through a central angle of 55°46'50", for an arc distance of 5.35 feet;

Thence North 53°57'28" East, for a distance of 17.90 feet; to the **TRUE POINT OF BEGINNING**;

TOGETHER with and subject to easements, reservations, covenants, and restrictions apparent or of record.

CONTAINING: 1.17 acres of land, more or less.

Approved by: Mandy Hertel 5/9/24

STATE HIGHWAY 140

PARKER
Y-205

LOT 3

LOT 3

LOT 6

PREVIOUS LOT
LINE (TYP.)

LOT 4

LOT 3

SOUTH 1/2,
NW 1/4, NW 1/4,
NE 1/4, SEC 6
(NOT INCLUDED
IN THIS BLA)

60.00

WASHOUGAL RIVER

00:00

ADJUSTED LINE (TYPE)

LOT 1

31

LOT 3

LOT 1
(NOT INCLUDED
IN THIS BLA)

LOT 2
(NOT INCLUDED
IN THIS BLA)

0' 250' 500'
SCALE: 1" = 500'

SHEET 2 OF 2

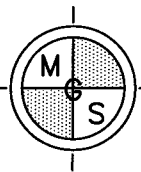

PREPARED BY:
MINISTER-GLAESER
SURVEYING INC.
2200 E. EVERGREEN BLVD.
VANCOUVER, WA 98661
(360) 694-3313

EXHIBIT "L"
ADJUSTED LOT LAYOUT
BLOUNT & RIVERBEND TIMBER
BOUNDARY LINE ADJUSTMENT

SCALE: 1"=500'
JOB NO. 22-114
DATE: 05-03-24
DWG FILE: 22114L4
DRAWN BY: CSA

Skamania County Community Development
- Boundary Line Adjustment

Approved by: *Mandy Hertel 5/9/24*

RIVERBEND TIMBER
LOT 6

ANDREW BLOUNT
PARCEL: 01050610090100

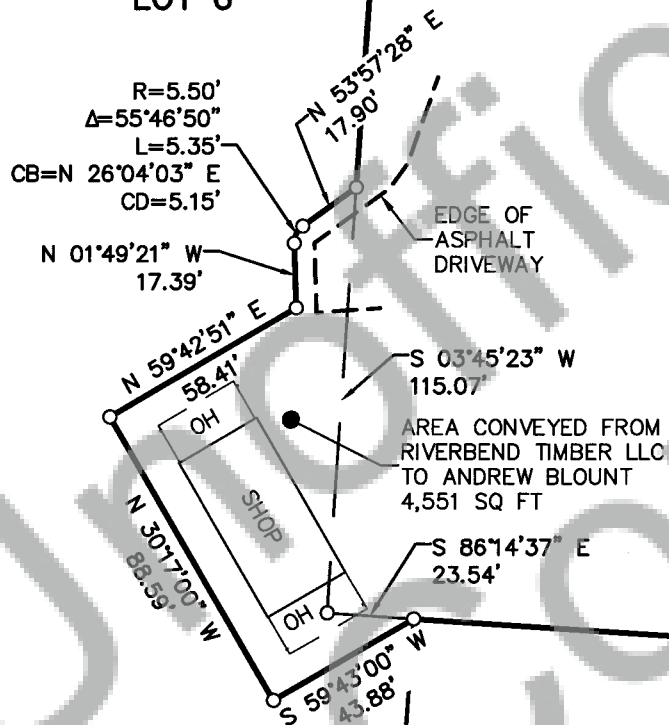

0' 25' 50'
SCALE: 1" = 50'

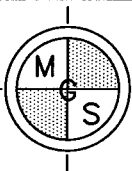

PREPARED BY:
MINISTER-GLAESER
SURVEYING INC.
2200 E. EVERGREEN BLVD.
VANCOUVER, WA 98661
(360) 694-3313

EXHIBIT "M"
RIVERBEND TIMBER LLC &
ANDREW BLOUNT
BOUNDARY LINE ADJUSTMENT

SCALE: 1"=50'
JOB NO. 22-143
DATE: 05-03-24
DWG FILE: 22143L3
DRAWN BY: CSA