

RECORD OF SURVEY
LOCATED IN THE GIFFORD PINCHOT NATIONAL FOREST
WITHIN THE SE1/4SE1/4 SECTION 31, SW1/4SW1/4, SE1/4SW1/4,
SW1/4SE1/4 & SE1/4SE1/4 SECTION 32, SW1/4SW1/4, SE1/4SW1/4,
SW1/4SE1/4 & SE1/4SE1/4 SECTION 33, T.4 N., R.9 E., W.M.
SKAMANIA COUNTY, STATE OF WASHINGTON
AUGUST 2023

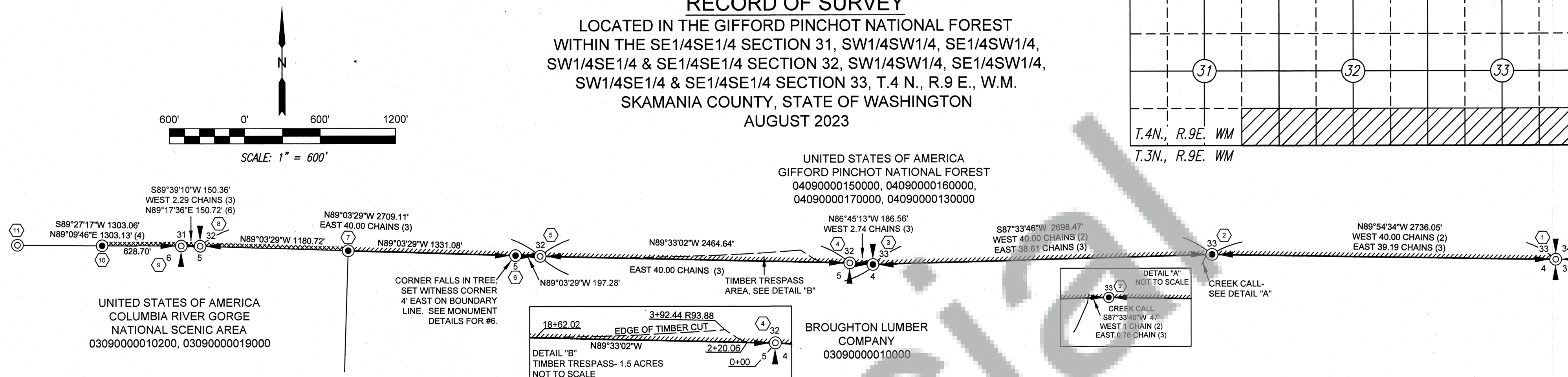

PURPOSE

THE PURPOSE OF THIS SURVEY IS TO POST AND MONUMENT A PORTION OF NATIONAL FOREST SYSTEM LANDS IN THE GIFFORD PINCHOT NATIONAL FOREST AND COLUMBIA RIVER GORGE NATIONAL SCENIC AREA. THE LANDS SURVEYED ARE PORTIONS OF SECTIONS 31, 32 & 33, T. 4 N., R. 9 E. AND PORTIONS OF SECTIONS 4, 5 & 6, T. 3 N., R. 9 E., W. M.

BASIS OF BEARING

BEARINGS SHOWN HEREON ARE BASED ON GEODETIC NORTH AT CONTROL POINT 1 USING A CONVERGENCE ANGLE OF -0°52'34".

DISTANCES SHOWN HEREON ARE GROUND DISTANCES, US SURVEY FEET USING A COMBINED FACTOR OF 0.99989493.

SURVEYOR'S REPORT

BOUNDARY RESOLUTION:

- THIS SURVEY UPHELD MONUMENTS SET BY THE 1880, 1892 & 1901 GLO SURVEYS, REMONUMENTED BY THE DEPARTMENT OF NATURAL RESOURCES AND LARRY BISHOP.
- LOCAL MONUMENTS IN SECTION 33 WERE ACCEPTED.
- THE AXLE MARKING THE SOUTH QUARTER CORNER OF SECTION 33 WAS CORROBORATED BY THE GLO CREEK CALL. THE 1901 GLO CALL WAS 0.76 CHAINS (50.16') WEST AND THIS SURVEY FOUND THE CREEK TO BE 47' WEST OF THE AXLE. THE CREEK SEEMS TO BE IN THE SAME LOCATION.
- THE IRON PIPE MARKING THE SECTION CORNER TO SECTIONS 32 & 33 IS CORROBORATED BY THE 1901 GLO CALL OF 2.74 CHAINS (180.84'). THE PIPE WAS FOUND BENT SEVERELY TO THE WEST BY A LARGE ROOT. I CHOPPED OUT THE ROOT AND SET A STANDARD FOREST SERVICE MONUMENT AT THE BASE OF THE PIPE AND RESET THE PIPE NORTH OF THE MONUMENT.
- TWO BROUGHTON LUMBER COMPANY TAGS AND BLAZES WERE RECOVERED ON TWO TREES APPROXIMATELY 1000' & 1500' WEST OF THE SOUTHEAST CORNER OF SECTION 33. THESE TAGS ARE WITHIN 3' OF THE 2023 POSTED BOUNDARY LINE.
- THE NORTH QUARTER CORNER OF SECTION 5 ONLY AND THE WEST 1/16 OF SECTION 5 ONLY WERE SET ACCORDING TO THE "2009 MANUAL OF SURVEYING INSTRUCTIONS" CHAPTERS 3-21, 3-26 & 7-23. SINCE THE 1901 GLO SURVEY SET THE CORNERS OF T. 3 & 4 N., R. 9 E. SIMULTANEOUSLY, I UPHELD THE INTENT TO SET MONUMENTS ON THE SAME RHUMB LINE BETWEEN THE SOUTH QUARTER CORNER OF SECTION 32 & THE SECTION CORNER COMMON TO SECTIONS 31 & 32 AND PROPORTIONED BETWEEN THE NORTHEAST AND NORTHWEST CORNERS OF SECTION 5.

A TRESPASS IN THE SOUTHEAST QUARTER OF SECTION 32 WAS DISCOVERED DURING THIS SURVEY. NO SURVEY OF RECORD WAS RECOVERED FOR THE TIMBER HARVEST ON BROUGHTON TIMBER LANDS AND NO SURVEY MARKERS WERE FOUND ALONG THE TIMBER HARVEST LINE. ONE OLD, CORRODED "NATIONAL FOREST BOUNDARY" SIGN WAS FOUND THAT FIT WITHIN A FEW FEET OF THE POSTED BOUNDARY LINE BUT NO OTHER SIGNS WERE RECOVERED. TREE RINGS OF THE NEW PLANTED TREES INDICATE THAT THEY ARE APPROXIMATELY 8 YEARS OLD.

METHOD AND PROCEDURE

CONTROL FOR THIS PROJECT WAS SET IN JUNE 2023 BY R. DIECKMANN, PLS AND ASSISTED BY D. LONDEN, R. ELLIS, S. DESHONG AND C. CLARK. PRIMARY CONTROL WAS SET USING STATIC SESSIONS AT POINTS 1, 2 & 5 AND POST-PROCESSED THROUGH THE ONLINE POSITIONING USER SERVICE (OPUS) AND TRIMBLE BUSINESS CENTER. ALL GPS WORK WAS PERFORMED WITH TRIMBLE R12 & R10 BASES (3MM+0.5PPM RMS). SECONDARY CONTROL WAS COLLECTED BY A CLOSED-LOOP TRAVERSE USING A 3-SECOND TRIMBLE S7 TOTAL STATION WITH EDM (1MM+2PPM). THE TRAVERSE WAS ADJUSTED BY LEAST SQUARES NETWORK ADJUSTMENT IN TRIMBLE BUSINESS CENTER. ALL WORK MET OR EXCEEDED THE MINIMUM STANDARDS SET FORTH IN WAC 332-130-085.

COORDINATES SHOWN ARE WASHINGTON STATE PLANE SOUTH NAD83(2011) (EPOCH 2010.0000). DISTANCES SHOWN HEREON ARE GROUND DISTANCES IN US SURVEY FEET, BEARINGS SHOWN HEREON ARE MEAN GEODETIC BEARINGS. COMBINED SCALE FACTOR IS 0.99989493 AND THE CONVERGENCE ANGLE AT POINT 1 IS -0°52'34". DATA OBTAINED FROM NGS OPUS DERIVED SOLUTIONS UTILIZING THE FOLLOWING CORS STATIONS:

PID	DESIGNATION
DG8349	PACKWOODF_WA2004
DH4131	MSH_SESLPEWA2004
DK4153	KELSO_AIR_WA2007

BEARINGS AND DISTANCES TO BEARING TREES WERE TAKEN WITH A HAND COMPASS (MAGNETIC DECLINATION 16°E) AND MEASURED TO A MAG NAIL AND WASHER SIDE-CENTER. MONUMENTS SET IN THIS SURVEY CONSIST OF A 3-1/4" ALUMINUM CAP ON A 2-1/2" (OUTSIDE DIAMETER) x 28" LONG ALUMINUM PIPE WITH A MAGNET INSIDE. ALL NEW BEARING TREES ARE MEASURED TO A 2" BRASS WASHER AND MAG NAILED SIDE-CENTER INSCRIBED "OR PLS 89906" "WA PLS 20100531". STANDARD 54-3 BEARING TREE SIGNS WERE ATTACHED TO THE FRONT AND 54-9 LAND SURVEY MONUMENT SIGNS ATTACHED TO THE BACK OF ALL BEARING TREES. STANDARD 54-2 PROPERTY BOUNDARY AND 54-9 LAND SURVEY MONUMENT SIGNS WERE PLACED ON ALUMINUM POSTS WITHIN 5' OF THE PROPERTY BOUNDARY LINE. MONUMENTS. BOUNDARY POSTS ARE SET AT APPROXIMATE 150' INTERVALS ALONG THE INDICATED LINE AND TREES WITHIN 2' EACH SIDE OF THE BOUNDARY WERE BLAZED. TREES ON THE GOVERNMENT SIDE ARE BLAZED WITH 2 QUARTER BLAZES, TREES ON PRIVATE SIDE ARE BLAZED WITH 1 QUARTER BLAZE. TREES THAT ARE ON THE BOUNDARY LINE HAVE 1 QUARTER BLAZE AND 2 AXE HACKS ON LINE.

CONTROL POINTS

PT #	NORTHING	EASTING	DESCRIPTION
1	165697.917	1332738.145	SET 5/8" REBAR AND CAP "USFS CONTROL" WITH TACK OFF-CENTER
2	167594.064	1349347.049	SET 5/8" REBAR AND CAP "USFS CONTROL"
5	160420.207	1329541.694	SET 5/8" REBAR AND CAP "USFS CONTROL"

SURVEYOR'S CERTIFICATE

THIS MAP CORRECTLY REPRESENTS A SURVEY MADE BY ME OR UNDER MY DIRECTION IN CONFORMANCE WITH THE REQUIREMENTS OF THE SURVEY RECORDING ACT AT THE REQUEST OF THE GIFFORD PINCHOT NATIONAL FOREST IN NOVEMBER 2022.

Erielle F. Lamb
ERIELLE F. LAMB, PLS #20100531
12/12/2023
DATE



AUDITOR'S CERTIFICATE

FILED FOR RECORD THIS 19 DAY OF December 2023 AT 5:08 P.M. IN BOOK 2 OF 2 AT PAGE 2 AT THE REQUEST OF ERIELLE F. LAMB, PLS.
COUNTY AUDITOR
2023-001875
AUDITOR'S FILE NUMBER

DRAWN BY: EFL
CALC BY: EFL
CHECK BY: RJL

SHEET 1 OF 3



UNITED STATES DEPARTMENT OF AGRICULTURE
FOREST SERVICE- REGION 6
COLUMBIA LANDS ZONE
987 McCLELLAN ROAD
VANCOUVER, WA 98661

RECORD OF SURVEY
LOCATED IN THE GIFFORD PINCHOT NATIONAL FOREST
WITHIN THE SE1/4SE1/4 SECTION 31, SW1/4SW1/4, SE1/4SW1/4,
SW1/4SE1/4 & SE1/4SE1/4 SECTION 32, SW1/4SW1/4, SE1/4SW1/4,
SW1/4SE1/4 & SE1/4SE1/4 SECTION 33, T.4 N., R.9 E., W.M.
SKAMANIA COUNTY, STATE OF WASHINGTON
AUGUST 2023

MONUMENT DETAILS CONTINUED

MONUMENT DETAILS

1. SECTION CORNER COMMON TO SECTIONS 3 & 4, T. 3 N., R. 9 E., AND SECTIONS 33 & 34, T. 4 N., R. 9 E.
1880- SHELTON SET A POST, 4" SQUARE, 24" ABOVE GROUND MARKED "T4NS34" ON NORTHEAST, "R9ES3" ON SOUTHEAST, "T3NS4" ON SOUTHWEST AND "S33" ON NORTHWEST FACES WITH 3 NOTCHES ON THE EAST AND WEST EDGES.
18" FIR BEARS N52°30'E 25 LINKS MARKED "T4NR9ES34BT"
24" FIR BEARS S56°E 70 LINKS MARKED "T3NR9ES3BT"
4" WILLOW BEARS S76°W 16 LINKS MARKED "T3NR9ES4BT"
15" FIR BEARS N45°W 25 LINKS MARKED "T4NR9ES33BT"
1895- RICHARDSON FOUND A POST, 4" SQUARE, 24" ABOVE GROUND MARKED "T4NS34" ON NORTHEAST, "R9ES3" ON SOUTHEAST, "T3NS4" ON SOUTHWEST AND "S33" ON NORTHWEST FACES WITH 3 NOTCHES ON THE EAST AND WEST EDGES.
18" FIR BEARS N52°30'E 25 LINKS MARKED "T4NR9ES34BT"
24" FIR BEARS S56°E 70 LINKS MARKED "T3NR9ES3BT"
4" WILLOW BEARS S76°W 16 LINKS MARKED "T3NR9ES4BT"
15" FIR BEARS N45°W 25 LINKS MARKED "T4NR9ES33BT"
1901- GESNER & GESNER FOUND A 3" SQUARE FIR POST 3' ABOVE GROUND MARKED "T4NS34" ON NORTHEAST, "T3NS3" ON THE SOUTHEAST, "R9ES4" ON SOUTHWEST AND "S33" ON NORTHWEST FACES WITH 3 NOTCHES ON THE EAST AND WEST EDGES
20" RED FIR BEARS N52°30'E 25 LINKS MARKED "T4NR9ES34BT"
30" RED FIR BEARS S56°E 70 LINKS MARKED "T3NR9ES3BT"
6" WILLOW BEARS S76°W 16 LINKS MARKED "T3NR9ES4BT"
18" RED FIR BEARS N45°W 25 LINKS MARKED "T4NR9ES33BT"
1970- C. WHITTEN (DEPARTMENT OF NATURAL RESOURCES) FOUND 2 BEARING TREES WITH SCRIBING AND AN IRON PIPE. SET A STANDARD DNR MONUMENT AT POSITION OF IRON PIPE.
36" FIR BEARS N60°E 15.41'
12" HEMLOCK BEARS S46°E 27.19'
6" FIR BEARS S62°W 21.26'
1988- TRANTOW (AFN 105269) FOUND A DNR STANDARD CONCRETE MONUMENT WITH BRASS CAP, ONE BEARING TREE AND TWO WITNESS TREES
36" DOUG FIR STUMP WITH 18"X18" FACE BEARS N62°E 17.05' TO CENTER OF STUMP WITH USFS WITNESS TAG
6" WESTERN HEMLOCK BEARS N18°E 14.50' TO NAIL AT CENTER OF TREE, NOT SCRIBED
3" WESTERN HEMLOCK BEARS S40°W 28.32' TO NAIL AT CENTER OF TREE, NOT SCRIBED
2023- FOUND 3" DNR BRASS CAP ON 3.5"X4" CONCRETE POST, 9.5" HIGH
FOUND BEARING TREES
38" DOUG FIR BEARS N52°E 17' WITH HEALED BLAZE
6" DOWN FIR SNAG BEARS S62°W 21.26'
16" HEMLOCK BEARS S34°E 23.4'
21" HEMLOCK BEARS S71°W 23.8'
NEW BEARING TREE
14" DOUG FIR BEARS N12°W 47.1' SCRIBED "BTT4NR9ES33" WITH MAG & WASHER 4" HIGH
SET GUARD POST ON PROPERTY BOUNDARY LINE WEST OF MONUMENT

2. QUARTER CORNER FOR SECTION 33 ONLY
1892- RICHARDSON SET A 4' LONG POST, 3" SQUARE, 24" IN THE GROUND MARKED "1/4S" ON THE NORTH FACE
4" HEMLOCK BEARS SOUTH 8 LINKS MARKED "1/4SBT"
4" HEMLOCK BEARS N40°E 8 LINKS MARKED "1/4SBT"
1901- GESNER & GESNER FOUND A 3" SQUARE HEMLOCK POST 2-1/2' ABOVE GROUND MARKED "1/4S" ON THE NORTH FACE
6" HEMLOCK BEARS S2°W 8 LINKS MARKED "1/4SBT"
7" HEMLOCK BEARS N45°W 9 LINKS MARKED "1/4SBT"
2023- FOUND 1-1/4" AXLE, 1' ABOVE GROUND. AXLE LOCATION FIT 1901 GLO CREEK CALL SO ACCEPTED POSITION AND REMONUMENTED WITH 3-1/4" ALUMINUM CAP ON 2-1/2"x28" ALUMINUM PIPE, 5" ABOVE GROUND IN ROCK MOUND. SET AXLE 0.8' NORTH.
FOUND BEARING TREES:
17" DOUG FIR BEARS N30°E 7.18' WITH HEALED QUARTER BLAZE 1.5' ABOVE GROUND. DISTANCE IS TO SET MAG & WASHER RIGHT SIDE-CENTER.
30" CEDAR BEARS S69°E 3.5' WITH AX HACK 4' ABOVE GROUND. FOUND UNREADABLE DNR LOCATION POSTER NEAR CEDAR. DISTANCE IS TO SET MAG & WASHER RIGHT SIDE-CENTER.
NEW BEARING TREE:
22" DOUG FIR BEARS N15°W 28.0' SCRIBED "T4NR9ES33BT" WITH MAG & WASHER RIGHT SIDE-CENTER
SET GUARD POSTS ON PROPERTY BOUNDARY LINE EAST AND WEST OF MONUMENT

3. SECTION CORNER COMMON TO SECTIONS 32 & 33 ONLY
1892- RICHARDSON SET A 4' LONG POST, 4" SQUARE, 24" IN THE GROUND FOR SECTION CORNER COMMON TO SECTIONS 4, 5, 32 & 33 MARKED "T4NS33" ON NORTHEAST, "R9ES4" ON SOUTHEAST, "T3NS5" ON SOUTHWEST AND "S32" ON NORTHWEST WITH 4 NOTCHES ON EAST AND 2 ON WEST EDGES.
15" HEMLOCK BEARS N8°E 53 LINKS MARKED "T4NR9ES33BT"
5" HEMLOCK BEARS S35°E 41 LINKS MARKED "T3NR9ES4BT"
8" HEMLOCK BEARS S3°30'W 19 LINKS MARKED "T3NR9ES5BT"
8" HEMLOCK BEARS N58°W 20 LINKS MARKED "T4NR9ES32BT"
1901- GESNER & GESNER FOUND A 3" SQUARE POST, 3' ABOVE GROUND MARKED "T4NS33" ON THE NORTHEAST, "R9ES32" ON THE NORTHWEST, "T3NS5" ON THE SOUTHWEST AND "S4" ON THE SOUTHEAST FACES WITH 4 NOTCHES ON THE EAST AND 2 NOTCHES ON THE WEST SIDE.
15" HEMLOCK BEARS N80°E 53 LINKS MARKED "T4NR9ES33BT"
3" HEMLOCK BEARS S45°E 41 LINKS MARKED "T3NR9ES4BT" (DESTROYED FOR CLOSING CORNER)
8" HEMLOCK BEARS S3°30'W 19 LINKS MARKED "T3NR9ES5BT" (DESTROYED FOR CLOSING CORNER)
8" HEMLOCK BEARS N58°W 20 LINKS MARKED "T4NR9ES32BT"
2023- FOUND 1-1/2" IRON PIPE, BENT SEVERELY WEST. HELD FOR CORNER LOCATION. SET 3-1/4" ALUMINUM CAP ON 2-1/2" ALUMINUM PIPE AT PIPE LOCATION, SET IRON PIPE 10" NORTHWEST OF MONUMENT.
NEW BEARING TREES:
30" DOUG FIR BEARS N45°W 18.05' WITH MAG & WASHER LEFT SIDE-CENTER MARKED "T4NR9ES32BT" WITH HEALED AX HACK 5' HIGH
26" DOUG FIR BEARS N25°E 27.05' TO MAG & WASHER LEFT SIDE-CENTER MARKED "T4NR9ES33BT"
SET GUARD POSTS ON PROPERTY BOUNDARY LINE EAST AND WEST OF MONUMENT

4. SECTION CORNER FOR SECTIONS 4 & 5 ONLY
1901- GESNER & GESNER SET AN 18"X12"X5" BASALT STONE, 10" IN GROUND MARKED "CC" ON THE SOUTH SIDE WITH 4 NOTCHES ON THE EAST AND 2 NOTCHES ON THE WEST SIDE
24" HEMLOCK BEARS S20°E 61 LINKS MARKED "CCT3NR9ES4BT"
42" RED FIR BEARS S52°W 27 LINKS MARKED "CCT3NR9ES5BT"
1978- BISHOP (AFN 87117) SET A 3" BRASS CAP ON A 2"X30" IRON PIPE FROM A FOUND GLO BEARING TREE (44" DOUG FIR STUMP WITH BLAZE AND SCRIBED S52°E 17.8'). THE STONE WAS UNABLE TO BE FOUND. A PIPE SET BY BROUGHTON LUMBER COMPANY ENGINEER WAS RECOVERED BUT NO MENTION OF ITS RELATION TO THE CORNER.
20" DOUG FIR BEARS S16°E 6.4' WITH GROWN OVER BLAZE
14" DOUG FIR BEARS SOUTH 1.2' WITH GROWN OVER OPEN BLAZE FACING EAST
18" DOUG FIR BEARS S35°30'W 26.9' SCRIBED "T3NR9ES5BT"
2023- FOUND 3" BRASS CAP ON 3" IRON PIPE, 1/2" ABOVE GROUND.
FOUND BEARING TREES
26" FIR SNAG BEARS S34°W 26.1' WITH OLD HEALED BLAZE
28" DOUG FIR SNAG BEARS S22°E 6.15' WITH OLD HEALED BLAZE
21" FIR STUMP BEARS S11°E 2' WITH OLD HEALED BLAZE FACING OLD CORNER LOCATION (EASTERLY)
NEW BEARING TREES
19" HEMLOCK BEARS S40°W 37.15' BLAZED "T3NR9ES5CCBT" WITH MAG & WASHER RIGHT SIDE-CENTER 1' HIGH
5" HEMLOCK BEARS S68°W 38.8' BLAZED "XBT" WITH MAG & WASHER RIGHT SIDE-CENTER 2' HIGH
34" DOUG FIR BEARS S52°E 41.17' BLAZED "T3NR9ES4CCBT" WITH MAG & WASHER LEFT SIDE-CENTER 1' HIGH
26" DOUG FIR BEARS S50°E 59.90' BLAZED "XBT" WITH MAG & WASHER LEFT SIDE-CENTER 1' HIGH
SET GUARD POSTS ON PROPERTY BOUNDARY LINE EAST AND WEST OF MONUMENT

5. SOUTH QUARTER CORNER TO SECTION 32 ONLY
1901- GESNER & GESNER SET A 4-1/2' LONG CEDAR POST, 4" SQUARE, 24" IN GROUND MARKED "1/4S32" ON THE NORTH FACE
12" HEMLOCK BEARS N73°E 4 LINKS MARKED "1/4S32BT"
8" RED FIR BEARS S58°W 24 LINKS MARKED "1/4SBT"
1978- BISHOP (AFN 87127) FOUND A 2" PIPE FILLED WITH CONCRETE SET BY AN UNKNOWN PARTY AND A 10" FELLEDOUG FIR SNAG WITH VISIBLE SCRIBING S58°W 15.85'. HE SET A 3" BRASS CAP ON A 2"X30" GALVANIZED IRON PIPE.
14" DOUG FIR BEARS N29°W 18.4' SCRIBED "1/4S32BT"
7" DOUG FIR BEARS S26°W 4.5' SCRIBED "1/4SBT"
2023- FOUND 3" BRASS CAP ON 3" GALVANIZED IRON POST 3" ABOVE DUFFY GROUND.
FOUND BEARING TREES:
7" ROTTED, DOWN FIR BEARS S26°W 4.5'
20" DOUG FIR BEARS N29°W 18.9' WITH HEALED BLAZE
12" DOUG FIR BEARS S74°E 7.21' WITH OLD 1963 BROUGHTON TAG AND HEALED BLAZE
NEW BEARING TREES:
11" HEMLOCK BEARS N72°W 27.68' SCRIBED "1/4S32BT" WITH MAG & WASHER SET RIGHT SIDE-CENTER 15" HIGH
6" CEDAR BEARS N42°E 8.33' SCRIBED "XBT" WITH MAG & WASHER RIGHT SIDE-CENTER 6" HIGH
SET GUARD POSTS ON PROPERTY BOUNDARY LINE EAST AND WEST OF MONUMENT

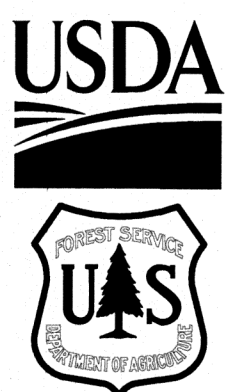
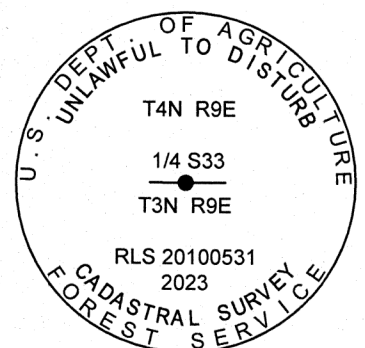
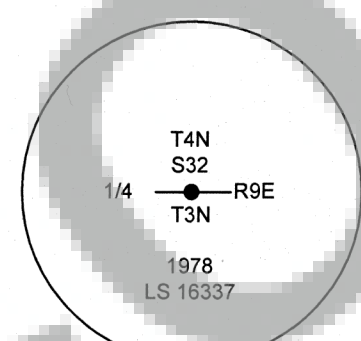
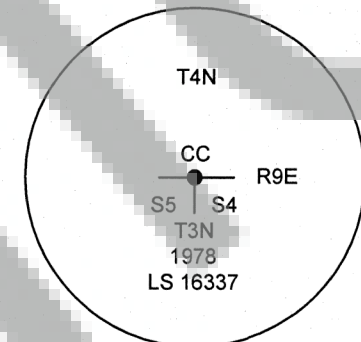
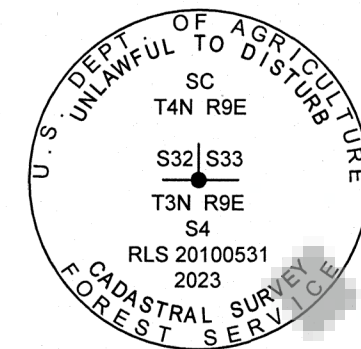
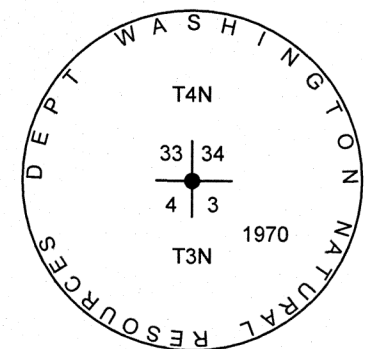

UNITED STATES DEPARTMENT OF AGRICULTURE
FOREST SERVICE- REGION 6
COLUMBIA LANDS ZONE
987 McCLELLAN ROAD
VANCOUVER, WA 98661



DRAWN BY: EFL
CALC BY: EFL
CHECK BY: RJJ

SHEET 2 OF 3

RECORD OF SURVEY
LOCATED IN THE GIFFORD PINCHOT NATIONAL FOREST
WITHIN THE SE1/4SE1/4 SECTION 31, SW1/4SW1/4, SE1/4SW1/4,
SW1/4SE1/4 & SE1/4SE1/4 SECTION 32, SW1/4SW1/4, SE1/4SW1/4,
SW1/4SE1/4 & SE1/4SE1/4 SECTION 33, T.4 N., R.9 E., W.M.
SKAMANIA COUNTY, STATE OF WASHINGTON
AUGUST 2023

MONUMENT DETAILS CONTINUED

6. NORTH QUARTER CORNER OF SECTION 5 ONLY

NOT PREVIOUSLY SET

2023- SET 3-1/4" ALUMINUM CAP ON 2-1/2"x28" ALUMINUM PIPE, 6" ABOVE GROUND.

NEW BEARING TREES:

9" HEMLOCK BEARS S69°E 21.48' SCRIBED "1/4S5BT" WITH MAG & WASHER LEFT SIDE-CENTER 6" HIGH
23" DOUG FIR BEARS S49°W 23.3' SCRIBED "1/4S5BT" WITH MAG & WASHER LEFT SIDE-CENTER 16" HIGH
SET GUARD POSTS ON PROPERTY BOUNDARY LINE EAST AND WEST OF MONUMENT

7. WEST 1/16 OF SECTION 5 ONLY

NOT PREVIOUSLY SET

2023- 13" DOUG FIR IS AT TRUE CORNER LOCATION, SET WITNESS CORNER 4' EAST ON PROPERTY BOUNDARY LINE. SET 3-1/4" ALUMINUM CAP ON 2-1/2"x28" ALUMINUM PIPE AS WITNESS CORNER, 6" ABOVE GROUND.

NEW BEARING TREES:

17" DOUG FIR BEARS S16°W 10.30' SCRIBED "X" "BT" WITH MAG & WASHER RIGHT SIDE-CENTER 2" HIGH
20" CEDAR BEARS S35°E 13.05' SCRIBED "X" "BT" WITH MAG & WASHER RIGHT SIDE-CENTER 9" HIGH
BOTH "X"'S WERE BARK SCRIBED AT BREAST HEIGHT
SET GUARD POSTS ON PROPERTY BOUNDARY LINE EAST AND ADMINISTRATIVE BOUNDARY WEST OF MONUMENT

8. SECTION CORNER COMMON TO SECTIONS 31 & 32 ONLY

1901- GESNER & GESNER SET A 5' LONG HEMLOCK POST, 4" SQUARE, 24" IN THE GROUND MARKED "T4NS32" ON THE NORTHEAST AND "R9ES31" ON THE NORTHWEST WITH 5 NOTCHES ON THE EAST AND 1 NOTCH ON THE WEST EDGES.

10" RED FIR BEARS N76°E 29 LINKS MARKED "T4NR9ES32BT"

24" RED FIR BEARS N50°W 31 LINKS MARKED "T4NR9ES31BT"

1978- BISHOP (AFN 87125) FOUND THE N50°W FIR SNAG AND A FIR STUMP HOLE. HE SET A 3" BRASS CAP ON A 2"x30" IRON PIPE.

19" HEMLOCK BEARS N86°W 31.6' SCRIBED "T4NR9ES31BT"

28" DOUG FIR BEARS N16°E 49.8' BARK SCRIBED "T4NR9ES32BT"

2023- FOUND 3" BRASS CAP ON 2-1/2" IRON PIPE, 5" ABOVE GROUND. DID NOT RECOVER ANY PREVIOUS BEARING TREES

NEW BEARING TREES:

13" DOUG FIR BEARS N32°E 21.1' SCRIBED "BT4N9ES32" WITH MAG & WASHER RIGHT SIDE-CENTER 6" HIGH

11" DOUG FIR BEARS N26°W 12.97' SCRIBED "T4NR9ES31BT" WITH MAG & WASHER RIGHT SIDE-CENTER 6" HIGH

11" HEMLOCK BEARS N70°W 36.69' SCRIBED "T4NR9ES31BT" WITH MAG & WASHER LEFT SIDE-CENTER 10" HIGH

12" HEMLOCK BEARS N60°E 37.15' SCRIBED "T4NR9ES32BT" WITH MAG & WASHER RIGHT SIDE-CENTER 6" HIGH

SET GUARD POSTS ON ADMINISTRATIVE BOUNDARY LINE EAST AND WEST OF MONUMENT

HISTORY OF SURVEYS

JUNE 1880- LEWIS D. W. SHELTON SURVEYED SUBDIVISIONS OF TOWNSHIP 3 NORTH, RANGE 9 EAST. IN THIS SURVEY, HE SET THE SECTION CORNER COMMON TO SECTIONS 33, 34, 3 & 4.

JUNE 1892- JACOB RICHARDSON, UNDER CONTRACT 383, SURVEYED THE SOUTH BOUNDARY OF TOWNSHIP 4 NORTH, RANGE 9 EAST. IN THIS SURVEY, HE SURVEYED THE SOUTH LINE OF SECTION 33.

NOVEMBER 1901- ALONZO AND FRANK X. GESNER, UNDER CONTRACT 571, RETRACED THE SOUTH BOUNDARY OF SECTION 33 AND SURVEYED THE REST OF THE SOUTH BOUNDARY OF TOWNSHIP 4 NORTH, RANGE 9 EAST. THE SURVEY COMMENCED AT THE CORNER COMMON TO SECTIONS 32, 33, 4 & 5 AND CLOSED AT THE TOWNSHIP CORNER AT 162.08 CHAINS.

1970- CHUCK WHITTEN OF THE DEPARTMENT OF NATURAL RESOURCES PERFORMED REMONUMENTATION OF THE SECTION CORNER COMMON TO SECTIONS 33, 34, 3 & 4.

1978- LARRY BISHOP PERFORMED REMONUMENTATION OF CORNERS IN SECTION 31, 32, 4 & 5 ALONG THE TOWNSHIP LINE.

2023- US FOREST SERVICE PERFORMED A SURVEY ALONG THE TOWNSHIP LINE TO SUPPORT LAND MANAGEMENT ACTIVITIES IN NATIONAL FOREST SYSTEM LANDS.

MONUMENT DETAILS CONTINUED

9. SECTION CORNER FOR SECTIONS 5 & 6 ONLY

1901- GESNER & GESNER SET A 4-1/2" LONG HEMLOCK POST, 4.5" SQUARE, 24" IN THE GROUND MARKED "CC" ON THE SOUTH, "T3NS5" ON THE EAST AND "R9ES6" ON THE WEST WITH 5 GROOVES ON THE EAST AND 1 GROOVE ON THE WEST SIDE

26" RED FIR BEARS S59°E 16 LINKS MARKED "CCT3NR9ES5BT"

10" HEMLOCK BEARS S58°30'W 33 LINKS MARKED "CCT3NR9ES6BT"

1978- BISHOP (AFN 87121) FOUND A 32" DOUG FIR S59°E 10.5' WITH OPEN FACE AND VISIBLE SCRIBING AND A 10" HEMLOCK S59°W 21.8' WITH VISIBLE SCRIBING. HE SET A 3" BRASS CAP ON A 2"x30" IRON PIPE FROM BOTH GLO BEARING TREES. NO NEW BEARING TREES WERE MARKED.

2023- FOUND 3" BRASS CAP ON 2-1/2" IRON PIPE, SLOPING NORTHEASTERLY.

FOUND BEARING TREES

ROTTED DOUG FIR STUMP, UPROOTED AND SLOPING NORTHEASTERLY WITH SCRIBING IN FACE OF ROOT BASE BEARS S59°E 10.5'

SOUTHWEST HEMLOCK (S59°E) IS GONE/DISINTEGRATED

NEW BEARING TREES

12" HEMLOCK BEARS S50°W 11.49' SCRIBED "T3NR9ES6CCBT" WITH MAG & WASHER LEFT SIDE-CENTER 1' HIGH

7" HEMLOCK BEARS S66°W 20.17' SCRIBED "XBT" WITH MAG & WASHER LEFT SIDE-CENTER 7" HIGH

11" HEMLOCK BEARS S44°E 26.15' SCRIBED "XBT" WITH MAG & WASHER RIGHT SIDE-CENTER 7" HIGH

13" DOUG FIR BEARS S74°E 50.22' SCRIBED "T3NR9ES5CCBT" WITH MAG & WASHER LEFT SIDE-CENTER 11" HIGH
SET GUARD POSTS ON ADMINISTRATIVE BOUNDARY EAST AND WEST OF MONUMENT

10. ANGLE POINT 107, COLUMBIA RIVER GORGE NATIONAL SCENIC AREA BOUNDARY

NOT PREVIOUSLY SET

2023- SET 3-1/4" ALUMINUM CAP ON 2-1/2"x28" ALUMINUM PIPE 6" ABOVE GROUND IN COLLAR OF STONES AT CALL "INTERSECTION WITH NORTH LINE OF SEC 06, T. 03 N., R. 09 E." AND "CREST OF RIDGE LINE"

NEW BEARING TREES:

10" DOUG FIR BEARS N76°W 6.35' SCRIBED "AP107BT" WITH MAG & WASHER RIGHT SIDE-CENTER 1" HIGH

12" HEMLOCK BEARS S33°W 21.75' SCRIBED "AP107BT" WITH MAG & WASHER RIGHT SIDE-CENTER 4" HIGH

SET GUARD POST ON ADMINISTRATIVE BOUNDARY NORTHWEST AND EAST OF MONUMENT

11. EAST 1/16 CORNER OF SECTION 6 ONLY

1978- BISHOP (AFN 87124) SET A 3" BRASS CAP ON A 2"x30" IRON PIPE.

20" DOUG FIR BEARS N67°E 9.5' SCRIBED "1/16BT"

26" DOUG FIR BEARS S23°E 17.2' SCRIBED "E1/16S6BT"

2023- FOUND 3" BRASS CAP ON 2" GALVANIZED IRON PIPE, LAYING SIDEWAYS ON THE GROUND. STRAIGHTENED AND RE-MOUNDED CORNER WITH COLLAR OF ROCKS.

FOUND BEARING TREE:

27" DOUG FIR BEARS N67°E 9.5 WITH HEALED BLAZE

NEW BEARING TREE:

29" DOUG FIR BEARS S53°W 39.9' WITH OLD HEALED BLAZE, DID NOT PLACE NEW WASHER.

SURVEY REFERENCES

- 1880 GLO SURVEY BY LEWIS D.W. SHELTON
- 1892 GLO SURVEY BY JACOB RICHARDSON, UNDER CONTRACT 383
- 1901 GLO SURVEY BY ALONZO AND FRANK X. GESNER, UNDER CONTRACT 571
- 1978 LARRY BISHOP SURVEY, BOOK 1 OF SURVEYS AT PAGE 164, SKAMANIA COUNTY AUDITOR RECORDS (AFN 87112)
- 1978 LARRY BISHOP LAND CORNER RECORD, BOOK 3/9 OF MONUMENTS AT PAGE 5, SKAMANIA COUNTY AUDITOR RECORDS (AFN 87117)
- 1978 LARRY BISHOP LAND CORNER RECORD, BOOK 3/9 OF MONUMENTS AT PAGE 9, SKAMANIA COUNTY AUDITOR RECORDS (AFN 87121)
- 1978 LARRY BISHOP LAND CORNER RECORD, BOOK 3/9 OF MONUMENTS AT PAGE 12, SKAMANIA COUNTY AUDITOR RECORDS (AFN 87124)
- 1978 LARRY BISHOP LAND CORNER RECORD, BOOK 4/9 OF MONUMENTS AT PAGE 11, SKAMANIA COUNTY AUDITOR RECORDS (AFN 87125)
- 1978 LARRY BISHOP LAND CORNER RECORD, BOOK 3/9 OF MONUMENTS AT PAGE 12, SKAMANIA COUNTY AUDITOR RECORDS (AFN 87126)
- 1978 LARRY BISHOP LAND CORNER RECORD, BOOK 4/9 OF MONUMENTS AT PAGE 13, SKAMANIA COUNTY AUDITOR RECORDS (AFN 87127)
- 1988 TRANTOW SURVEYING LAND CORNER RECORD, BOOK 3/9 OF MONUMENTS AT PAGE 37, SKAMANIA COUNTY AUDITOR RECORDS (AFN 105269)

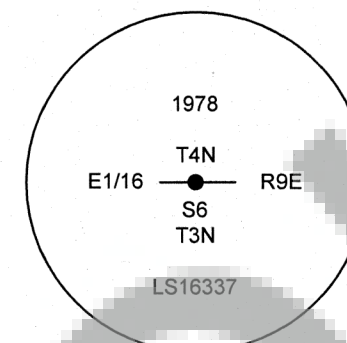
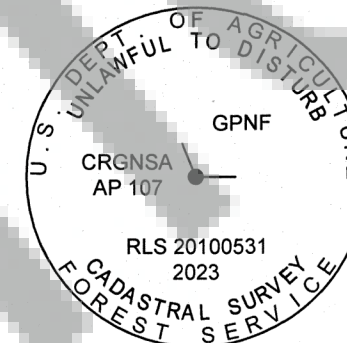
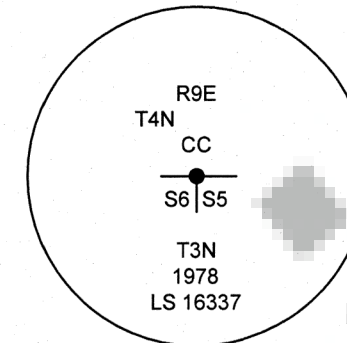
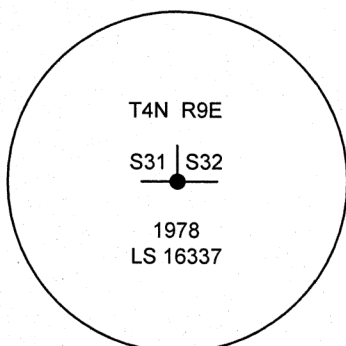
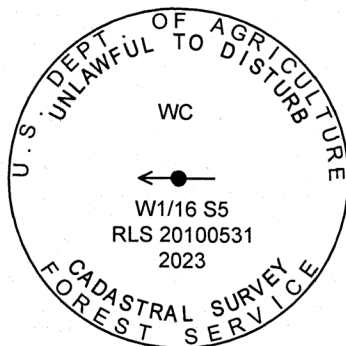
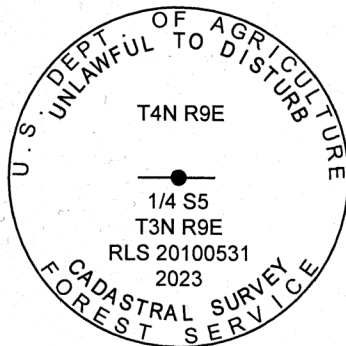

UNITED STATES DEPARTMENT OF AGRICULTURE
FOREST SERVICE- REGION 6
COLUMBIA LANDS ZONE
987 McCLELLAN ROAD
VANCOUVER, WA 98661



DRAWN BY: EFL
CALC BY: EFL
CHECK BY: RJD

SHEET 3 OF 3