



RETURN TO:
Erielle Lamb
987 McClellan Road
Vancouver, WA 98661

LAND CORNER RECORD

THIS FORM IS FOR RECORDING A PLSS CORNER MONUMENT AND ACCESSORY INFORMATION WHEN A RECORD OF SURVEY IS NOT REQUIRED, PER RCW 58.09.040(2). (UPDATED 8/01/2019. DO NOT REVISE THIS FORM)

CERTIFICATE: THIS LAND CORNER RECORD CORRECTLY REPRESENTS WORK PERFORMED BY ME OR UNDER MY DIRECTION IN CONFORMANCE WITH THE SURVEY RECORDING ACT.

GRANTOR: Erielle Lamb
NAME: _____

SIGNATURE: Erielle Lamb

CERTIFICATE NO.: 20100531

ADDRESS: 987 McClellan Road
Vancouver, WA 98661

GRANTEE: PUBLIC

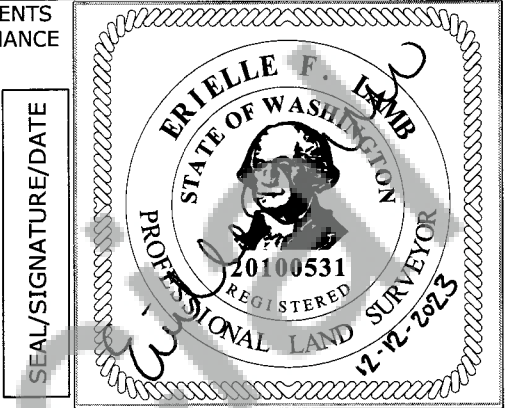

INDEXING INFORMATION: 1/4 1/4 SEC: 10 TWP: 4N RGE: 9E

CORNER CODE, SEE DIAGRAM BELOW: F 16-17

ADDITIONAL IDENTIFIER: (PLSS CORNER NAME) Witness Corner to the C-W-E-NE 1/256

WPCS: N: E:

ZONE: DATE OF OBSERVATION: 11/28/2023

BLM GCDB POINT IDENTIFIER (OPTIONAL): 465565

PROVIDE THE FOLLOWING INFORMATION ON ATTACHMENTS, AS REQUIRED BY RCW 58.09.060(2)

- (a) AN ACCURATE DESCRIPTION AND LOCATION, IN REFERENCE TO THE CORNER POSITION, OF ALL MONUMENTS AND ACCESSORIES FOUND AT THE CORNER;
- (b) AN ACCURATE DESCRIPTION AND LOCATION, IN REFERENCE TO THE CORNER POSITION, OF ALL MONUMENTS AND ACCESSORIES PLACED OR REPLACED AT THE CORNER;
- (c) BASIS OF BEARINGS USED TO DESCRIBE OR LOCATE SUCH MONUMENTS OR ACCESSORIES;
- (d) COROLLARY INFORMATION THAT MAY BE HELPFUL TO RELOCATE OR IDENTIFY THE CORNER POSITION.

	1	2	3	4	5	6	7	8	9	10	11	12	13	14	15	16	17	18	19	20	21	22	23	24	25	
A																										B
B																										C
C																										D
D																										E
E																										F
F																										G
G																										H
H																										I
J																										J
K																										K
L																										L
M																										M
N																										N
O																										O
P																										P
Q																										Q
R																										R
S																										S
T																										T
U																										U
V																										V
W																										W
X																										X
Y																										Y
Z																										Z
	1	2	3	4	5	6	7	8	9	10	11	12	13	14	15	16	17	18	19	20	21	22	23	24	25	

LAND CORNER RECORD ATTACHMENT

CORNER INFORMATION: DISCUSS THE HISTORY, EVIDENCE FOUND, AND PERPETUATION OF THE CORNER. SHOW THE REFERENCES; PROVIDE THE DATE OF THE FIELD WORK; IF APPLICABLE, MAKE REFERENCE TO A MAP OF RECORD AND/OR THE FIELD BOOK/PAGE NO. USE ADDITIONAL SHEETS AS NEEDED.

History:

(1987)- Roy Gaylord (WA PLS#16337) of Terra Surveying in July 1987, set standard 2-1/2"x30" Forest Service Aluminum Pipe and Cap, 24" in the ground with a mound of stone for the witness corner as corner falls in the Little White Salmon River. Recorded in Skamania County land corner record #104155, book 4 of 9, pg 112. The following bearing objects were described:

22" Western Red Cedar, N 85°30' E, 58.2' distance, scribed "S10 1/256BT".

28" Douglas Fir, S 1°45' W, 19.7' distance, scribed "S10 1/256BT".

Trees have bark scribed "X"s at breast Height, with red painted bands, tags and brass "PLS 18731" washers. Set carsonite guard post near monument.

(2023)- R. Ellis of USDA Forest Service, Columbia Lands Zone on 11/28/2023 recovered the witness to the C-W-E-NE 1/256 corner to section 10 as set in July 1987 by Roy Gaylord of Terra Surveying. 6" red bands were painted on all new and old bearing trees.

Today the the witness corner is north of the course of the Little White Salmon River. Carsonite posts lead out to the west from the true corner position that falls in the river. A wetland area exists to the north of the corner that is likely flooded during high water, but no evidence indicates that the main course of the Little White Salmon River has changed since 1987. This suggests that the 1987 Terra Survey bearing call from the true corner position to the witness corner is actually N 01°52'20" W 20' instead of being S 01°52'20" E 20', placing the witness on the north bank instead of the south bank of the river.

Evidence:

Found 2-1/2" Aluminum Cap on 2-1/2" Aluminum Pipe, 2" above the ground. The following bearing objects were recovered:

A 31" Douglas fir snag 20' tall, bears N 1°45' W, 19.7' distance with an "X" bark scribe and healed scribed below.

No trace of the Northeast Cedar.

Corner is on north bank of the Little White Salmon River.

Perpetuation:

New 50" Cedar, bears S 15° W, 9.2' distance, bark scribed with an "X" and scribed "BT" below with WA PLS#20100531 2" diameter brass washer set right side center from the monument 1.5' high.

New 27" Fir, bears S 45° W, 24.4' distance, bark scribed with an "X" and scribed "BT" below with WA PLS#20100531 2" diameter brass washer set right side center from the monument 1.2' high.

Set guard posts 5' North of monument with property boundary and LSM signs attached.

LAND CORNER RECORD ATTACHMENT

CORNER INFORMATION: DISCUSS THE HISTORY, EVIDENCE FOUND, AND PERPETUATION OF THE CORNER. SHOW THE REFERENCES; PROVIDE THE DATE OF THE FIELD WORK; IF APPLICABLE, MAKE REFERENCE TO A MAP OF RECORD AND/OR THE FIELD BOOK/PAGE NO. USE ADDITIONAL SHEETS AS NEEDED.

