



RETURN TO:
Erielle Lamb
987 McClellan Road
Vancouver, WA 98661

LAND CORNER RECORD

THIS FORM IS FOR RECORDING A PLSS CORNER MONUMENT AND ACCESSORY INFORMATION WHEN A RECORD OF SURVEY IS NOT REQUIRED, PER RCW 58.09.040(2). (UPDATED 8/01/2019. DO NOT REVISE THIS FORM)

CERTIFICATE: THIS LAND CORNER RECORD CORRECTLY REPRESENTS WORK PERFORMED BY ME OR UNDER MY DIRECTION IN CONFORMANCE WITH THE SURVEY RECORDING ACT.

GRANTOR: Erielle Lamb
NAME: _____

SIGNATURE: Erielle Lamb

CERTIFICATE NO.: 20100531

ADDRESS: 987 McClellan Road
Vancouver, WA 98661

GRANTEE: PUBLIC

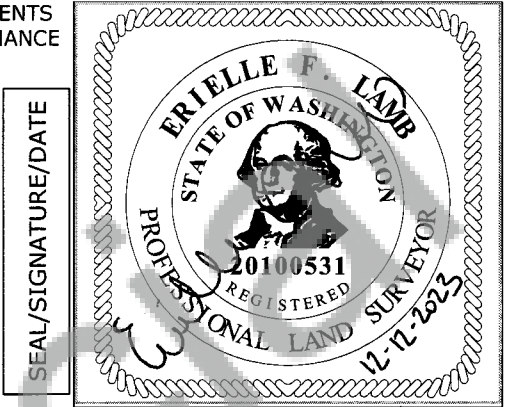

INDEXING INFORMATION: 1/4 1/4 SEC: 3 TWP: 4N RGE: 9E

CORNER CODE, SEE DIAGRAM BELOW: C-15

ADDITIONAL IDENTIFIER: (PLSS CORNER NAME) Center 1/4 of Section 3

WPCS: N: _____ E: _____

ZONE: _____ DATE OF OBSERVATION: 10/30/2023

BLM GCDB POINT IDENTIFIER (OPTIONAL): 440640

PROVIDE THE FOLLOWING INFORMATION ON ATTACHMENTS, AS REQUIRED BY RCW 58.09.060(2)

(a) AN ACCURATE DESCRIPTION AND LOCATION, IN REFERENCE TO THE CORNER POSITION, OF ALL MONUMENTS AND ACCESSORIES FOUND AT THE CORNER;

(b) AN ACCURATE DESCRIPTION AND LOCATION, IN REFERENCE TO THE CORNER POSITION, OF ALL MONUMENTS AND ACCESSORIES PLACED OR REPLACED AT THE CORNER;

(c) BASIS OF BEARINGS USED TO DESCRIBE OR LOCATE SUCH MONUMENTS OR ACCESSORIES;

(d) COROLLARY INFORMATION THAT MAY BE HELPFUL TO RELOCATE OR IDENTIFY THE CORNER POSITION.

| | 1 | 2 | 3 | 4 | 5 | 6 | 7 | 8 | 9 | 10 | 11 | 12 | 13 | 14 | 15 | 16 | 17 | 18 | 19 | 20 | 21 | 22 | 23 | 24 | 25 | |
|---|---|---|----|---|---|---|----|---|---|----|----|----|----|----|----|----|----|----|----|----|----|----|----|----|----|---|
| A | | | | | | | | | | | | | | | | | | | | | | | | | | A |
| B | | | | | | | | | | | | | | | | | | | | | | | | | | B |
| C | | | 6 | | | | 5 | | | | | | 4 | | | | | | 2 | | | | | | 1 | C |
| D | | | | | | | | | | | | | | | | | | | | | | | | | | D |
| E | | | | | | | | | | | | | | | | | | | | | | | | | | E |
| F | | | | | | | | | | | | | | | | | | | | | | | | | | F |
| G | | | 7 | | | | 8 | | | | | | 9 | | | 10 | | | 11 | | | | | 12 | | G |
| H | | | | | | | | | | | | | | | | | | | | | | | | | | H |
| J | | | | | | | | | | | | | | | | | | | | | | | | | | J |
| K | | | | | | | | | | | | | | | | | | | | | | | | | | K |
| L | | | 18 | | | | 17 | | | | | | 16 | | | 15 | | | 14 | | | | | 13 | | L |
| M | | | | | | | | | | | | | | | | | | | | | | | | | | M |
| N | | | | | | | | | | | | | | | | | | | | | | | | | | N |
| O | | | | | | | | | | | | | | | | | | | | | | | | | | O |
| P | | | 19 | | | | 20 | | | | | | 21 | | | 22 | | | 23 | | | | | 24 | | P |
| Q | | | | | | | | | | | | | | | | | | | | | | | | | | Q |
| R | | | | | | | | | | | | | | | | | | | | | | | | | | R |
| S | | | | | | | | | | | | | | | | | | | | | | | | | | S |
| T | | | 30 | | | | 29 | | | | | | 28 | | | 27 | | | 26 | | | | | 25 | | T |
| U | | | | | | | | | | | | | | | | | | | | | | | | | | U |
| V | | | | | | | | | | | | | | | | | | | | | | | | | | V |
| W | | | | | | | | | | | | | | | | | | | | | | | | | | W |
| X | | | 31 | | | | 32 | | | | | | 33 | | | 34 | | | 35 | | | | | 36 | | X |
| Y | | | | | | | | | | | | | | | | | | | | | | | | | | Y |
| Z | | | | | | | | | | | | | | | | | | | | | | | | | | Z |
| | 1 | 2 | 3 | 4 | 5 | 6 | 7 | 8 | 9 | 10 | 11 | 12 | 13 | 14 | 15 | 16 | 17 | 18 | 19 | 20 | 21 | 22 | 23 | 24 | 25 | |

LAND CORNER RECORD ATTACHMENT

CORNER INFORMATION: DISCUSS THE HISTORY, EVIDENCE FOUND, AND PERPETUATION OF THE CORNER. SHOW THE REFERENCES; PROVIDE THE DATE OF THE FIELD WORK; IF APPLICABLE, MAKE REFERENCE TO A MAP OF RECORD AND/OR THE FIELD BOOK/PAGE NO. USE ADDITIONAL SHEETS AS NEEDED.

History:

(1987)- Roy Gaylord (WA PLS#16337) of Terra Surveying in July 1987, set standard 2-1/2"x30" Forest Service Aluminum Pipe and Cap, 24" in the ground for the center 1/4 of section 3, recorded in Skamania Land Corner record #104122, book 4 of 9, pg 86, from which bears:

5/8"x30" Iron Rod, N 11°45' W, 10.65' distance.

5/8"x30" Iron Rod, S 84°15' W, 10.24' distance.

Iron Rod's have plastic "Terra PLS#18731" caps, set carsonite guard post near monument. This monument was set during the Salmon Cadastral Survey as recorded in Book 2 of Surveys, Pages 265-267, Skamania County Auditor's Office.

(2023)- R. Ellis of USDA Forest Service, Columbia Lands Zone on 10/30/2023 recovered the center 1/4 corner to section 3 as set in July 1987 by Roy Gaylord of Terra Surveying. 6" red bands were painted on all new and old bearing trees.

Evidence:

Found 2-1/2" Aluminum Cap on 2-1/2" Aluminum Pipe, 6" above the ground. The following bearing objects were recovered:

A 5/8" Iron Rod, bears N 11°45' W, 10.65' distance with Terra plastic cap.

A 5/8" Iron Rod, bears S 84°15' W, 10.24' distance with Terra plastic cap.

Fallen down snag, bears N 34° E, 13.42' distance with LSM and BT tags attached.

Perpetuation:

Unrecorded 18" Hemlock, bears S 54° E, 10.60' distance, with healed blaze and washer mark healed over right side center.

Set guard posts 5' East and South of monument with property boundary and LSM signs attached.

LAND CORNER RECORD ATTACHMENT

CORNER INFORMATION: DISCUSS THE HISTORY, EVIDENCE FOUND, AND PERPETUATION OF THE CORNER. SHOW THE REFERENCES; PROVIDE THE DATE OF THE FIELD WORK; IF APPLICABLE, MAKE REFERENCE TO A MAP OF RECORD AND/OR THE FIELD BOOK/PAGE NO. USE ADDITIONAL SHEETS AS NEEDED.

