



RETURN TO:  
Erielle Lamb  
987 McClellan Rd  
Vancouver, WA  
98661

LAND CORNER RECORD

THIS FORM IS FOR RECORDING A PLSS CORNER MONUMENT AND ACCESSORY INFORMATION WHEN A RECORD OF SURVEY IS NOT REQUIRED, PER RCW 58.09.040(2). (UPDATED 8/01/2019. DO NOT REVISE THIS FORM)

CERTIFICATE: THIS LAND CORNER RECORD CORRECTLY REPRESENTS WORK PERFORMED BY ME OR UNDER MY DIRECTION IN CONFORMANCE WITH THE SURVEY RECORDING ACT.

GRANTOR: Erielle Lamb  
NAME:

SIGNATURE: *Erielle Lamb*

CERTIFICATE NO.: 20100531

ADDRESS: 987 McClellan Rd  
Vancouver, WA 98661

GRANTEE: PUBLIC

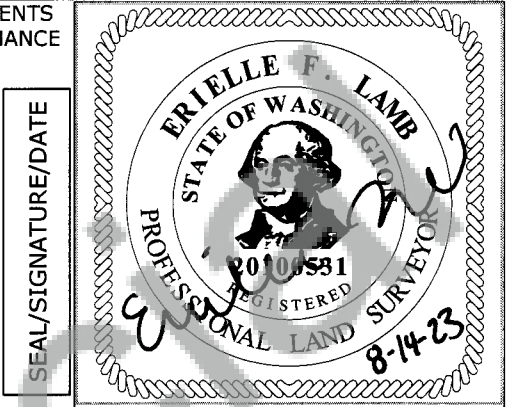

INDEXING INFORMATION: 1/4 1/4 SEC: S22, S23, S26, S27 TWP: 4N RGE: 9E

CORNER CODE, SEE DIAGRAM BELOW: R-17

ADDITIONAL IDENTIFIER: (PLSS CORNER NAME) Section Cor. to S22, S23, S26, S27

WPCS: N: E:

ZONE: DATE OF OBSERVATION: 5/17/2023

BLM GCDB POINT IDENTIFIER (OPTIONAL): 500300

PROVIDE THE FOLLOWING INFORMATION ON ATTACHMENTS, AS REQUIRED BY RCW 58.09.060(2)

- (a) AN ACCURATE DESCRIPTION AND LOCATION, IN REFERENCE TO THE CORNER POSITION, OF ALL MONUMENTS AND ACCESSORIES FOUND AT THE CORNER;
- (b) AN ACCURATE DESCRIPTION AND LOCATION, IN REFERENCE TO THE CORNER POSITION, OF ALL MONUMENTS AND ACCESSORIES PLACED OR REPLACED AT THE CORNER;
- (c) BASIS OF BEARINGS USED TO DESCRIBE OR LOCATE SUCH MONUMENTS OR ACCESSORIES;
- (d) COROLLARY INFORMATION THAT MAY BE HELPFUL TO RELOCATE OR IDENTIFY THE CORNER POSITION.

	1	2	3	4	5	6	7	8	9	10	11	12	13	14	15	16	17	18	19	20	21	22	23	24	25	
A																										A
B																										B
C																										C
D																										D
E																										E
F																										F
G																										G
H																										H
J																										J
K																										K
L																										L
M																										M
N																										N
O																										O
P																										P
Q																										Q
R																										R
S																										S
T																										T
U																										U
V																										V
W																										W
X																										X
Y																										Y
Z																										Z
	1	2	3	4	5	6	7	8	9	10	11	12	13	14	15	16	17	18	19	20	21	22	23	24	25	

# LAND CORNER RECORD ATTACHMENT

**CORNER INFORMATION:** DISCUSS THE HISTORY, EVIDENCE FOUND, AND PERPETUATION OF THE CORNER. SHOW THE REFERENCES; PROVIDE THE DATE OF THE FIELD WORK; IF APPLICABLE, MAKE REFERENCE TO A MAP OF RECORD AND/OR THE FIELD BOOK/PAGE NO. USE ADDITIONAL SHEETS AS NEEDED.

**History:**

(1892) The U.S. General Land Office Contracted with Jacob Richardson Deputy Surveyor under contract 383 on June 7th, 1892 and commenced fieldwork from October 12th through November 20th 1892. Set a Post 4' Long 4" square, 24" in the ground for the corner to sections 22, 23, 27, and 26 marked "T4NS23" on NE, "R9ES26" on SE, "S27" on the SW, and "S22" on the NW face with 2 notches on South and East edges from which:

A 48" Fir, bears N 42°30' E, 75 links distance, marked "T4NR9ES23BT"

A 60" Fir, bears S 79° E, 22 links distance, marked "T4NR9ES26BT"

A 36" Fir, bears S 38° W, 14 links distance, marked "T4NR9ES27BT"

A 42" Fir, bears N 40° W, 88 links distance, marked "T4NR9ES22BT"

(1946)- Corner restored by Broughton Lumber Company with a 1 1/4" iron rod. Note came from Frederick L. Martin's 1988 LCR#106519

(1971)- Visited by a USFS. employee by the last name of Dougherty in April 1970. Found no sign of original corner or bearing trees. Notes a BT shield on a small cedar but doesn't think that it is an original tree.

(1971)- Visited by Olson Engineering of Vancouver on August 12th, 1971. Noted a fir post and witness trees as described by USFS. Set 1/2" iron rod.

(1977)- Visited by Herbert Hemenway of the WA DNR on September 27, 1977. Noted a 1 1/4" iron pipe set by Broughton Lumber Company with two bearing trees. Replaced the Broughton pipe with a standard DNR Concrete Monument with stamped brass cap. Noted 2 B.T.s (1 with bark scribing). Recorded in book 4 of 9 of monuments at page 5 in Skamania County.

A 44" Fir Stump, bears N 4° E, 14.59' distance.

A 48" Fir Stump BT, bears N 42° E, 49.30' distance.

A 60" Fir Stump BT, bears S 79° E, 15.42' distance.

A 24" Fir Stump, bears S 58° W, 6.87' distance.

(1987)- Visited by Terry N. Trantow (WA PLS#15673) of T. N. Trantow Surveying in April 1987. Describes a DNR standard monument and that "no changes made to corner. Corner is in good condition, and is described from previous record. Clearcut area is very brushy". Recorded in book 4 of 9, page 72 in Skamania County. An LCR was also filed under Skamania County Auditor #103458. The following references were described:

A 24" Douglas Fir Stump, bears S 58° W, 6.87' distance.

A 60" Douglas Fir Stump, bears S 79° E, 15.42' distance.

A 48" Douglas Fir Stump, bears N 42° E, 49.30' distance.

A 44" Douglas Fir Stump, N 4° E, 14.59' distance.

Marked with DNR Witness tags.

(1988)- Corner was visited in September 1988 by Frederick L. Martin (WA PLS#10785) during the Lava Thin Cadastral Survey contract for the U.S. Forest Service filed in book 3 page 5 in Skamania County. The corner was recorded with the Skamania County Auditor in 1988 in Book 4 of 9 of monuments at pg 130. An LCR was also filed under Skamania County Auditor #106519. Found a DNR Concrete Monument 2" above the ground with a marked axle laying near the corner and a 6" orange plastic post with 54-4 sign 4' South of corner. He described the following references:

BT-48" Douglas Fir Stump, bears N 42° E, 49.30' distance, with DNR BT tag.

BT-60" Douglas Fir Snag, bears S 79° E, 15.42' distance, with DNR BT tag and no original marks.

RP-24" Douglas Fir Stump, bears S 58° W 6.87' distance, with DNR tag and Broughton Lumber Company tag.

RP-44" Douglas Fir Snag, bears N 4° W, 14.59' distance, with DNR tag.

**Evidence:**

(2023)- R. Ellis of USDA Forest Service, Columbia Lands Zone on 5/17/2023 recovered the Section corner monument to S22, S23, S27 and S26 as set in September of 1977. Found a 3" brass cap on 3" concrete Pipe 3 1/2" above the ground. All bearing trees are now stumps. 6" red bands were painted on all new trees with attached 54-9 LSM signs on the back and 54-3 BT tags attached on the trees above the blaze facing the corner. The following bearing objects were recovered:

A 24" Split Stump, bears S 58° W, 6.87' distance, with Forest Service bearing tree tag attached.

A 48" Douglas Fir Stump, bears N 42° E, 49.3' distance, with Forest Service bearing tree tag attached.

A 44" Douglas Fir Stump, bears N 4° E, 14.59' distance, with land survey monument sign attached to the back.

A 60" Stump, bears N 54° E, 25.7' distance, with bearing tree tag attached.

A 3"x3" long axle bears East, 1.75' distance laying sideways along the ground.

**Perpetuation:**

New 12" Douglas Fir, bears S 58° E, 39.65' distance, scribed "T4NR9ES26BT", and a 2.5" PK Nail with 2" diameter brass washer marked WA PLS#20100531 set right side center from monument 0.1' above ground.

New 12" Douglas Fir, bears N 28° W, 6.07' distance, scribed "T4NR9ES22BT", and a 2.5" PK Nail with 2" diameter brass washer marked WA PLS#20100531 set right side center from monument 1' above ground.

New 9" Douglas Fir, bears N 5° E, 26.16' distance, scribed "XBT", and a 2.5" PK Nail with 2" diameter brass washer marked WA PLS#20100531 set right side center from monument 1.8' above ground.

New 10" Douglas Fir, bears S 35 W, 26' distance, scribed with a large 1'x1' "X" by a chainsaw, and a 2.5" PK Nail with 2" diameter brass washer marked WA PLS#20100531 set right side center from monument 0.3' above ground.

Set Aluminum Guard Posts with 54-2 Property Boundary and 54-9 Land Survey Monument signs 5' West & 5' South of the monument.

# LAND CORNER RECORD ATTACHMENT

**CORNER INFORMATION:** DISCUSS THE HISTORY, EVIDENCE FOUND, AND PERPETUATION OF THE CORNER. SHOW THE REFERENCES; PROVIDE THE DATE OF THE FIELD WORK; IF APPLICABLE, MAKE REFERENCE TO A MAP OF RECORD AND/OR THE FIELD BOOK/PAGE NO. USE ADDITIONAL SHEETS AS NEEDED.

