

RETURN TO:
Erielle Lamb
987 McClellan Rd
Vancouver, WA
98661

LAND CORNER RECORD

THIS FORM IS FOR RECORDING A PLSS CORNER MONUMENT AND ACCESSORY INFORMATION WHEN A RECORD OF SURVEY IS NOT REQUIRED, PER RCW 58.09.040(2). (UPDATED 8/01/2019. DO NOT REVISE THIS FORM)

CERTIFICATE: THIS LAND CORNER RECORD CORRECTLY REPRESENTS WORK PERFORMED BY ME OR UNDER MY DIRECTION IN CONFORMANCE WITH THE SURVEY RECORDING ACT.

GRANTOR:
NAME: Erielle Lamb

SIGNATURE: 

CERTIFICATE NO.: 20100531

ADDRESS: 987 McClellan Rd
Vancouver, WA 98661

GRANTEE: PUBLIC

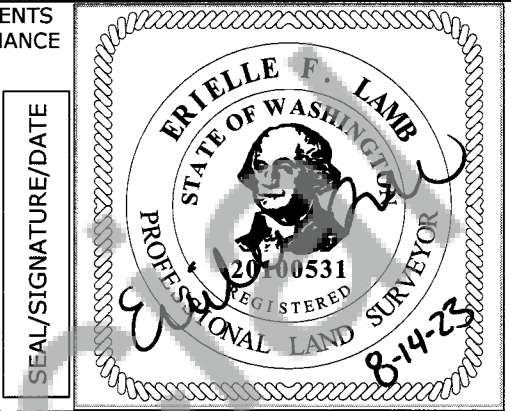

INDEXING INFORMATION: 1/4 1/4 SEC: S 1/4 S34 TWP: 3-4N RGE: 9E

CORNER CODE, SEE DIAGRAM BELOW: Z-15

ADDITIONAL IDENTIFIER: (PLSS CORNER NAME) 1/4 Cor. to S34, S3

WPCS: N: E:

ZONE: **DATE OF OBSERVATION:** 4/12/2023

BLM GCDB POINT IDENTIFIER (OPTIONAL): 440100

PROVIDE THE FOLLOWING INFORMATION ON ATTACHMENTS, AS REQUIRED BY RCW 58.09.060(2)

- (a) AN ACCURATE DESCRIPTION AND LOCATION, IN REFERENCE TO THE CORNER POSITION, OF ALL MONUMENTS AND ACCESSORIES FOUND AT THE CORNER;
- (b) AN ACCURATE DESCRIPTION AND LOCATION, IN REFERENCE TO THE CORNER POSITION, OF ALL MONUMENTS AND ACCESSORIES PLACED OR REPLACED AT THE CORNER;
- (c) BASIS OF BEARINGS USED TO DESCRIBE OR LOCATE SUCH MONUMENTS OR ACCESSORIES;
- (d) COROLLARY INFORMATION THAT MAY BE HELPFUL TO RELOCATE OR IDENTIFY THE CORNER POSITION.

	1	2	3	4	5	6	7	8	9	10	11	12	13	14	15	16	17	18	19	20	21	22	23	24	25
A																									
B																									
C		6				5				4				3				2						1	
D																									
E																									
F																									
G		7				8				9				10				11					12		
H																									
J																									
K																									
L		18				17				16				15				14					13		
M																									
N																									
O																									
P		19				20				21				22				23					24		
Q																									
R																									
S																									
T		30				29				28				27				26					25		
U																									
V																									
W																									
X		31				32				33				34				35					36		
Y																									
Z																									
	1	2	3	4	5	6	7	8	9	10	11	12	13	14	15	16	17	18	19	20	21	22	23	24	25

LAND CORNER RECORD ATTACHMENT

CORNER INFORMATION: DISCUSS THE HISTORY, EVIDENCE FOUND, AND PERPETUATION OF THE CORNER. SHOW THE REFERENCES; PROVIDE THE DATE OF THE FIELD WORK; IF APPLICABLE, MAKE REFERENCE TO A MAP OF RECORD AND/OR THE FIELD BOOK/PAGE NO. USE ADDITIONAL SHEETS AS NEEDED.

History:

(1880) The U.S. General Land Office Contracted with David Wilson Lewis Shelton Deputy Surveyor on May 17th, 1880 and commenced fieldwork from June 2nd through June 19th 1880. Marked a 6" diameter Fir for 1/4 Corner Monument. The following bearing trees were recorded:

A 12" Fir, bears N 64° E, 13 links distance.

A 14" Fir, bears S 48° W, 3 links distance.

(1970)- Field work performed June 29th 1970 by C.E. Whitten and Merl Lucas of the DNR. Set a standard DNR concrete monument. Found both B.T.s badly burned and rotted, but with visible scribing. Set monument at intersection of GLO distances from these B.T.s. Set three tag references:

A 6" Fir, bears S 84° W, 11.27' distance.

A 6" Fir, bears S 28° W, 14.99' distance.

A 6" Fir, bears N 57° E, 11.08' distance.

Notes: Distances to Aluminum Spikes in base of trees.

(1973)- Visited by Jim Massey and Greg Holtman of the U.S. Forest Service on July 19th 1973. Describes a 6" square DNR concrete post, 6" above the ground at the 1/4 corner monument for S34, and S3. Notes that the monument is in good quality. Photo ID #773-188, Line 27.

(1982)- Corner was visited in December 1982 by Roy Gaylord (WA PLS#18731) of Terra Surveying. Recorded with the Skamania County Auditor in 1983 in Book 4 of 9 of monuments at pg 43. An LCR was also filed under Skamania County Auditor #95303. He recorded the following references:

A 10" Douglas Fir, bears S 16° W, 14.99' distance.

A 9" Douglas Fir, bears N 54° E, 11.52' distance.

A 12" Douglas Fir, bears S 82° W, 11.75' distance.

Work Completed: Painted and tagged existing bearing trees.

Evidence:

(2023)- R. Ellis of USDA Forest Service, Columbia Lands Zone on 4/12/2023 recovered the 1/4 corner monument to S34, and S3 as set in June 1970 by C.E. Whitten of the DNR. Found a 3" 1970 DNR brass cap on 3.5" by 4.5" concrete pedestal, 5-1/2" above the ground. The S 28° W bearing tree is now a snag. 6" red bands were painted on all new and old bearing trees and new 54-9 and 54-3 signs were attached if necessary. The following bearing trees were recovered:

A 12" Douglas Fir Snag, bears S 28° W, recorded as S 16° W by Roy Gaylord in 1982. DNR tag reads S 28° W, 14.99' distance, with tag stuck into tree face

A 9" Douglas Fir, bears N 54° E, 11.52' distance, with a DNR and FS bearing tree tag attached

A 12" Douglas Fir, bears S 82° W, 11.95' distance, with healed blaze

A Unrecorded 18" Douglas Fir, Bears S 64° E, 38.1' distance with healed blaze and 54-9 LSM sign attached to the back. WA PLS #46900 washer was found on left side center of tree. The WA PLS number belongs to Mike Swanson and the tree was likely scribed during a 2014 unrecorded survey as other new 54-3 signs on other trees at this corner are from 2014.

A snag with a location tag bears N 13° E

Perpetuation:

New 18" Douglas Fir, Bears N 44° W, 8.70' distance, scribed "T4NR9E1/4S34BT" with attached 54-9 LSM and 54-3 BT tag, 2.5" PK Nail with 2" diameter brass washer marked WA PLS#20100531 set right side center from monument 1.7' above ground.

Set Aluminum Guard Posts with 54-2 Property Boundary and 54-9 Land Survey Monument signs 5' West & 5' South of the monument.

LAND CORNER RECORD ATTACHMENT

CORNER INFORMATION: DISCUSS THE HISTORY, EVIDENCE FOUND, AND PERPETUATION OF THE CORNER. SHOW THE REFERENCES; PROVIDE THE DATE OF THE FIELD WORK; IF APPLICABLE, MAKE REFERENCE TO A MAP OF RECORD AND/OR THE FIELD BOOK/PAGE NO. USE ADDITIONAL SHEETS AS NEEDED.

