

RETURN TO:
Erielle Lamb
987 McClellan Rd
Vancouver, WA
98661

LAND CORNER RECORD

THIS FORM IS FOR RECORDING A PLSS CORNER MONUMENT AND ACCESSORY INFORMATION WHEN A RECORD OF SURVEY IS NOT REQUIRED, PER RCW 58.09.040(2). (UPDATED 8/01/2019. DO NOT REVISE THIS FORM)

CERTIFICATE: THIS LAND CORNER RECORD CORRECTLY REPRESENTS WORK PERFORMED BY ME OR UNDER MY DIRECTION IN CONFORMANCE WITH THE SURVEY RECORDING ACT.

GRANTOR:
NAME: Erielle Lamb

SIGNATURE: 

CERTIFICATE NO.: 20100531

ADDRESS: 987 McClellan Rd
Vancouver, WA 98661

GRANTEE: PUBLIC

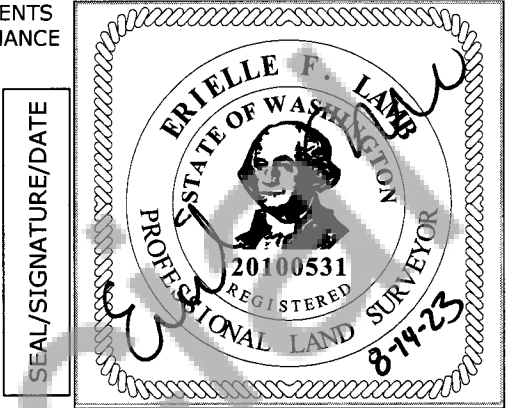

INDEXING INFORMATION: 1/4 1/4 SEC: S15 S22 TWP: 4N RGE: 9E

CORNER CODE, SEE DIAGRAM BELOW: N-13

ADDITIONAL IDENTIFIER: (PLSS CORNER NAME) Section Cor. to S15, S22 Only

WPCS: N: E:

ZONE: **DATE OF OBSERVATION:** 4/13/2023

BLM GCDB POINT IDENTIFIER (OPTIONAL): 400400

PROVIDE THE FOLLOWING INFORMATION ON ATTACHMENTS, AS REQUIRED BY RCW 58.09.060(2)

- (a) AN ACCURATE DESCRIPTION AND LOCATION, IN REFERENCE TO THE CORNER POSITION, OF ALL MONUMENTS AND ACCESSORIES FOUND AT THE CORNER;
- (b) AN ACCURATE DESCRIPTION AND LOCATION, IN REFERENCE TO THE CORNER POSITION, OF ALL MONUMENTS AND ACCESSORIES PLACED OR REPLACED AT THE CORNER;
- (c) BASIS OF BEARINGS USED TO DESCRIBE OR LOCATE SUCH MONUMENTS OR ACCESSORIES;
- (d) COROLLARY INFORMATION THAT MAY BE HELPFUL TO RELOCATE OR IDENTIFY THE CORNER POSITION.

	1	2	3	4	5	6	7	8	9	10	11	12	13	14	15	16	17	18	19	20	21	22	23	24	25	
A																										A
B																										B
C			6				5					4				3				2				1		C
D																										D
E																										E
F																										F
G			7				8					9				10				11				12		G
H																										H
J																										J
K																										K
L			18				17					16				15				14				13		L
M																										M
N																										N
O																										O
P			19				20					21				22				23				24		P
Q																										Q
R																										R
S																										S
T			30				29					28				27				26				25		T
U																										U
V																										V
W																										W
X			31				32					33				34				35				36		X
Y																										Y
Z																										Z
	1	2	3	4	5	6	7	8	9	10	11	12	13	14	15	16	17	18	19	20	21	22	23	24	25	

LAND CORNER RECORD ATTACHMENT

CORNER INFORMATION: DISCUSS THE HISTORY, EVIDENCE FOUND, AND PERPETUATION OF THE CORNER. SHOW THE REFERENCES; PROVIDE THE DATE OF THE FIELD WORK; IF APPLICABLE, MAKE REFERENCE TO A MAP OF RECORD AND/OR THE FIELD BOOK/PAGE NO. USE ADDITIONAL SHEETS AS NEEDED.

History:

(1892) The U.S. General Land Office Contracted with Jacob Richardson Deputy Surveyor under contract 383 on June 7th, 1892 and commenced fieldwork from October 12th through November 20th 1892. Set a Post 4' Long 4" square, 24" in the ground for the corner to sections 15, 16, 21, and 22 marked "T4NS15" on NE, "R9ES22" on SE, "S21" on the SW, and "S16" on the NW face with 3 notches on South and East edges from which:

- A 36" Cedar, bears N 54° E, 39 links distance, marked "T4NR9ES15BT"
- A 12" Fir, bears S 20° E, 57 links distance, marked "T4NR9ES22BT"
- A 8" Fir, bears S 42° W, 33 links distance, marked "T4NR9ES21BT"
- A 5" Cedar, bears N 70° W, 26 links distance, marked "T4NR9ES16BT"

(1970)- Visited by a Forest Service employee with last name of Dougherty in April 1970. They found the section monument at the northeast corner of an old clear cut. Pipe was just South of an old spur as it entered the unit. Found galvanized pipe size 1-1/2", 12" above the ground in good condition, with galvanized cap marked for sections 16, 15, 21, and 22.

Set location poster on 12" Hemlock facing spur and corner. Pipe bears approximately N 22° E, 8' in distance from location poster

(1976)- Visited by Gregory Holtman who was a Forestry Technician of the U.S. Forest Service on April 5th, 1976. Noted a Steel Pipe 3" diameter 2' above the ground in good condition and with good markings

(1983)- Visited by D. Tilton who was a Forester for the U.S. Forest Service on May 3, 1983. Noted a Steel Pipe 2" diameter 12" above the ground, painted orange and in good condition. The following references were recorded:

- A 12" Mistletoed Hemlock snag 8' North of Corner blown down Blazed with an "X"
- A 4 1/2' tall 2" post next to the bearing tree with a Forest Service Corner Location Poster attached

(1984)- Visited by Larry D. Bishop (WA PLS#16337) of Bishop Surveying in June 1984. Describes a 2" pipe with 2" cap Marked S16, S15, S21, S22. Set a new 2 1/2" x 30" Aluminum pipe with a 2 1/2" Aluminum cap marked S15 and S22. Recorded in book 4 of 9, page 55 in Skamania County. An LCR was also filed under Skamania County Auditor #97937. The following references were described:

- A Burned out Cedar Stump, bears N 54° E, 25.7' distance
- A Rotted White Fir Stump, bears S 20° E, 37.6' distance
- A Rotted White Fir Stump, bears S 42° W, 21.7' distance
- 13" Green Cedar N 70° W, 17.1' distance, no blaze visible
- New 8" Hemlock, bears N 42° E, 14.8' distance, scribed "S15T4NR9EBT" with 3/4" brass disk stamped PLS 16337
- New 22" Cedar, bears S 76° E, 33.7' distance, scribed "S22T4NR9EBT", with 3/4" brass disk stamped PLS 16337
- Painted bands and blazes red. Nailed 54-4 and 54-3 signs to BT's. Painted old stumps red and attached 54-4 and 54-3 signs. Set guard post 3' North with 54-2a and land survey decals facing East. Buried pipe in hole next to monument.

(1988)- Corner was visited in October 1988 by Frederick L. Martin (WA PLS#10785) during the Lava Thin Cadastral Survey contract for the U.S. Forest Service filed in book 3 page 5 in Skamania County. The corner was recorded with the Skamania County Auditor in 1988 in Book 4 of 9 of monuments at pg 124. An LCR was also filed under Skamania County Auditor #106513. Found 2 1/2" monument 6" above the ground. He described the following references:

- Original 36" Burnt Cedar Stump, bears N 54° E, 25.7' distance, with face tags
- Original Rotted Fir Stump, bears S 20° E, 37.6' distance, with tags
- Original Rotted Fir Stump, bears S 42° W 21.7' distance, with tags
- Original 13" Cedar, bears N 70° W, 17.1' distance, with tags
- New 8" Hemlock, bears N 42° E, 14.8' distance, scribed, painted, with tags
- New 22" Cedar, bears S 76° E, 33.7' distance, scribed, painted, with tags

Evidence:

(2023)- R. Ellis of USDA Forest Service, Columbia Lands Zone on 4/13/2023 recovered the Section corner monument to S15 and S22 as set in June 1984 by Larry Bishop of Bishop Surveying. Found a 2-1/2" Aluminum cap on 2-1/2" Aluminum Pipe 6-1/2" above the ground, found slightly loose. The NE bearing tree is now a snag and the SW bearing tree is now a rotted stump. 6" red bands were painted on all new and old bearing trees and new 54-9 LSM signs were attached to the back and 54-3 BT signs were attached to the front of the trees above the blaze. Replaced some old BT and LSM tags on existing bearing trees as well. The following bearing trees were recovered:

- A 23" Cedar, bears N 70° W, 17.1' distance, with healed blaze
- A 33" Cedar, bears S 76° E, 33.7' distance, with healed blaze
- A 11" Hemlock Snag, bears N 42° E, 14.8' distance, with healed blaze
- A 36" Cedar Stump, bears N 54° E, 25.7' distance, with bearing tree tag attached
- A Rotted Fir Stump, bears S 42° W, 21.7' distance, with bearing tree tag attached

The SE GLO stump is gone

Perpetuation:

- New 16" Grand Fir, bears S 74° W, 16.64' distance, scribed "T4NR9ES21BT", and a 2.5" PK Nail with 2" diameter brass washer marked WA PLS#20100531 set right side center from monument 1.3' above ground.
- New 12" Grand Fir, bears N 18° E, 20.9' distance, scribed "T4NR9ES15BT", and a 2.5" PK Nail with 2" diameter brass washer marked WA PLS#20100531 set left side center from monument 1.5' above ground.
- Set Aluminum Guard Posts with 54-2 Property Boundary and 54-9 Land Survey Monument signs 5' North & 5' South of the monument.

LAND CORNER RECORD ATTACHMENT

CORNER INFORMATION: DISCUSS THE HISTORY, EVIDENCE FOUND, AND PERPETUATION OF THE CORNER. SHOW THE REFERENCES; PROVIDE THE DATE OF THE FIELD WORK; IF APPLICABLE, MAKE REFERENCE TO A MAP OF RECORD AND/OR THE FIELD BOOK/PAGE NO. USE ADDITIONAL SHEETS AS NEEDED.

