

Survey For  
**PATRICK YOUNG**  
Section 35, T. 4 N, R. 7 E, W.M.  
Skamania County, Washington

**PSE** Pioneer Surveying & Engineering, Inc.  
Civil Engineering and Land Planning  
125 Simcoe Drive  
Goldendale, Washington 98620  
Phone (509) 773-4945, Fax (509) 773-5888, E-Mail pse@gorge.net

Date: 06 /2022  
Scale: 1"=200'  
Drawn By: GBF  
Surveyed By: DJ, DJ  
Checked By: JPG  
Sheet 1 Of 1  
Job Number: 2022-082

**Accuracy Statement (WAC 332-130)**  
This Survey was performed with a Topcon Hypert+ RTK surveying system with a relative accuracy greater than 1:5000. Mathematical analysis where required is by least squares.

**Note**  
No warranties are made as to matters of encroachment, adverse possession, unwritten title, riparian changes or flood zones, etc.

**Surveyor's Certificate**  
This Map correctly represents a Survey made by me or under my direction in conformance with the requirements of the Survey Recording Act at the request of  
Patrick Young in 08-22.  
Dustin D. Conroy, PLS 42272 Date 8/3/22

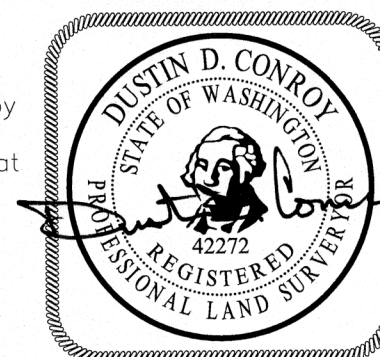

Index			
1/4	Sec.	T.	R.
1/4	35	4N	7E

**Auditor's Certificate**  
Filed For Record This 15th Day of August 2022  
At 4:41 P.M.  
In Book \_\_\_\_\_ Of Surveys At Page \_\_\_\_\_  
At The Request Of Pioneer Surveying and Engineering, Inc.  
Michele Delaur Deputy Auditor  
2022-001683 Auditor's Number