

# NARRATIVE

THE PURPOSE OF THIS SURVEY WAS TO MONUMENT AND POST THOSE PORTIONS OF LINE SHOWN AS MARKED FOR THE "WAUNA LAKE CLUB TRACT" CITED. FIELD WORK CONSISTED OF RECOVERING AND VERIFYING GPS POINTS ESTABLISHED IN ROS AFN 2022-000206 WHICH WERE BASED ON NAD 83/2011 BEARINGS AND WAS THE BASIS OF BEARING FOR THIS SURVEY. A SERIES OF CLOSED LOOP TRAVERSES BEGINNING AND ENDING ON SAID GPS POINTS WERE THEN RAN ALONG THE LINES SHOWN AS MARKED. OTHER CORNERS SHOWN AND NEW MONUMENTS ESTABLISHED WERE TIED AND SET RADially FROM THE ABOVE DESCRIBED TRAVERSES. DISTANCES SHOWN ARE GROUND DISTANCES.

## CORNER NOTE 1

SEARCHED FOR 2" STEEL PIPE AS NOTED IN 1933 SURVEY FOR WAUNA LAKE CLUB BY W.E. BLAIR, NOT FOUND

## CORNER NOTE 2

SEARCHED FOR 3/4" IRON PIPE WITH PLASTIC CAP AS NOTED IN ROS 1-18 FOR WAUNA LAKE CLUB BY OLSON ENGINEERING, NOT FOUND

## DEED REFERENCE

DEED  
EUGENE C. AMANN, TRUSTEE  
TO  
WAUNA LAKE CLUB  
DEED BOOK U, PAGE 361-362  
(08/06/1925)

## SURVEY REFERENCE

1) ROS 1-18  
2) ROS 2-257  
3) ROS 3-36  
4) ROS 3-442  
5) ROS 2022-000206

# RECORD OF SURVEY

IN THE NE 1/4 NW 1/4 OF  
SECTION 10, T2N, R7E, W.M.  
SKAMANIA COUNTY, WA.

FOUND BLM 2-1/2" BRASS CAP AS SHOWN IN ROS 2-257, N71°26'11"E, 5.01' FROM CALCULATED POSITION AS SHOWN IN ROS AFN 2022-000206, HELD CALC. SEE DETAIL "A" ON SHEET 2 FOR MODIFIED POSITION USED TO CALCULATE THE NORTHWEST QUARTER OF SECTION 10 (SEE LCR 2/7-39)

(S 88°55'21" E 2698.17')<sup>5</sup>  
(S 88°51'49" E 2698.17')<sup>2</sup>  
S 88°55'21" E 2698.17'

SEE CORNER  
NOTE 1

WAUNA LAKE CLUB  
BOOK U, PAGE 361-362

N 03°08'49" E 1283.39'

SEE CORNER  
NOTE 2

SEE CORNER  
NOTE 2

S 88°32'57" E 1366.60'

FOUND AND HELD 1-1/4" IRON PIPE WITH 2-3/4" BRASS CAP AS SHOWN IN ROS 2-257. ALSO FOUND AN IRON PIPE WITH YELLOW PLASTIC CAP STAMPED "OLSON 9025" AS SHOWN IN ROS 1-18, S25°35'49"W, 26.38'. ALSO SEE MY "SOUTH QUARTER SECTION 3 NOTE" ON ROS AFN 2022-000206 (SEE LCR 2/7-40)  
EXISTING REFERENCES:  
27" FIR WITH HEALED BLAZE, S11°E, 18.03' TO NAIL IN FACE  
33" FIR WITH HEALED BLAZE, S41°W, 17.58' TO NAIL IN FACE  
30" FIR WITH 4 NOTCHES, N44°E, 9.75' TO NAIL IN SC  
SET FIBERGLASS POST WEST, 1.0'

SECTION DIAGRAM  
NOT TO SCALE

400 200 0 400 600 800  
SCALE 1 INCH = 400 FEET

## LEGEND:

- INDICATES MONUMENT FOUND (UNLESS NOTED OTHERWISE)
- INDICATES CALCULATED POSITION
- ⊙ INDICATES 5/8" x 36" REBAR WITH ORANGE PLASTIC CAP INSCRIBED "BROWN 42425" SET (UNLESS NOTED OTHERWISE)
- ( ) INDICATES RECORD INFORMATION PER SURVEY REFERENCE NUMBER
- INDICATES LINE MARKED WITH 1/2" x 72" FIBER GLASS RODS WITH PINK RIBBON.
- ROS RECORD OF SURVEY
- AFN AUDITOR'S FILE NUMBER
- LCR LAND CORNER RECORD
- BLM BUREAU OF LAND MANAGEMENT
- SC SIDE CENTER

FOUND AND HELD BLM 2-1/2" BRASS CAP AS SHOWN IN ROS 1-18

9+10

S 88°22'32" E 2768.24'  
(S 88°23'50" E 2773.58')<sup>1</sup>  
(S 88°23'50" E 2767.73')<sup>4</sup>

CALCULATED POSITION OF THE EAST QUARTER CORNER OF SECTION 10 BY THE GRANT BOUNDARY METHOD USING RECORD DATA FROM ROS 3-442

S 88°22'32" E 2108.22'  
(S 88°23'50" E 2101.99')<sup>1</sup>  
(S 88°23'50" E 2107.84')<sup>4</sup>

S 01°59'23" W 83.11'  
(S 01°58'05" W)<sup>1</sup>  
(83.09')<sup>1</sup>

FOUND AND HELD UNITED STATES CORPS OF ENGINEERS 3-1/2" BRASS CAP AS SHOWN IN ROS AFN 2019000050

10+11

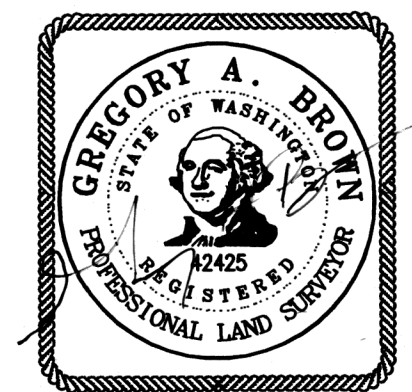

## BOUNDARY NOTE

KNOWING THAT SECTION MONUMENTS HAVE BEEN MOVING IN THIS AREA AS SHOWN IN MY PREVIOUS SURVEY RECORDED UNDER ROS AFN 2022-000206 IN SECTION 3 (SEE MY LANDSLIDE NOTE IN THAT SURVEY), I INITIALLY APPROACHED THIS PROJECT WITH THE SAME THOUGHT OF TRYING TO RESURRECT THE 1933 SURVEY BY W.E. BLAIR FOR THE WAUNA LAKE CLUB, BECAUSE IT PROVIDED THE BEST POSITIONS OF THE ORIGINAL MONUMENTS. DUE TO THE FACT THAT THIS SECTION HAS HAD MORE RECENT SURVEYS DONE BY MULTIPLE SURVEYORS AND THEY HAVE HELD THE EXISTING MONUMENTS IN THEIR RESPECTIVE POSITIONS. I DECIDED TO HOLD THE MONUMENTS AS FOUND WITH THE EXCEPTION OF THE NORTHWEST CORNER OF SECTION 10. I FELT THIS WAS THE BEST OPTION FOR CALCULATING THE NORTHWEST QUARTER OF SECTION 10, WHILE ALSO TRYING TO BE CONSISTENT WITH OTHER MONUMENTATION FROM THE OTHER SURVEYS PERFORMED IN THE AREA. ALL OF THE CONTROLLING CORNERS SHOWN ON THIS SURVEY HAVE CLEARLY MOVED SINCE THEIR ESTABLISHMENT. DUE TO THIS FACT, TRYING TO BE CONSISTENT WITH THE OTHER SURVEYS IS NOT REALLY PRACTICAL SINCE THE MONUMENTS ARE CONSISTENTLY MOVING IN DIFFERENT DIRECTIONS AND AT INCONSISTENT DISTANCES. MONUMENTS HELD OR ESTABLISHED WITHIN THE SLIDE AREA ARE TRULY ONLY AS GOOD AS WHEN THEY ARE TIED OR SET. PREPARING A COMPLETE SURVEY OF THE ENTIRE SLIDE AREA AND CORNERS LYING OUTSIDE OF IT TO ESTABLISH ORIGINAL POSITIONS OF ALL SECTION CORNERS LYING WITHIN THE SLIDE WOULD BE THE PROPER METHOD FOR THESE SECTIONS. COORDINATION OF ALL LAND OWNERS AND COST TO DO THIS WOULD BE A LARGE TASK FOR A PRIVATE SURVEYOR. THEREFORE, TRYING TO PROTECT THE ADJOINING LAND OWNERS AND OUR CLIENT I CHOSE THE METHOD SHOWN.

BROWN SURVEYING, PLLC MAKES NO WARRANTIES AS TO MATTERS OF UNWRITTEN TITLE SUCH AS ADVERSE POSSESSION, ACQUIESCENCE, ESTOPPLE, ETC.

A FIELD TRAVERSE WAS PERFORMED USING A NIKON NIVO 3.0C THREE SECOND TOTAL STATION WITH TDS DATA COLLECTION SYSTEM. THE FIELD TRAVERSE MET THE MINIMUM STANDARDS FOR SURVEYS AS DESIGNATED IN WAC 332-130-090. ALL CORNERS NOTED AS FOUND WERE VISITED ON 4/18 THRU 4/22/2022.

## AUDITOR'S CERTIFICATE

FILED FOR RECORD THIS 6th DAY OF June 2022 AT 10:41 A.M. IN BOOK OF SURVEYS AT PAGE 2022-001164  
AUDITOR'S FILE NUMBER

Deputy County Auditor

## SURVEYOR'S CERTIFICATE

THIS MAP CORRECTLY REPRESENTS A SURVEY MADE BY ME OR UNDER MY DIRECTION IN CONFORMANCE WITH THE REQUIREMENTS OF THE SURVEY RECORDING ACT AT THE REQUEST OF WAUNA LAKE CLUB IN APRIL, 2022.

Gregory A. Brown 5/31/2022  
GREGORY A. BROWN, PROFESSIONAL LAND SURVEYOR, LS# 42425

SCALE: 1"=400'  
JOB NO. 22-063  
DATE: 5-31-2022  
CALC BY: GAB  
DRAWN BY: GAB  
CHECKED BY: GAB  
SHEET 1 OF 2

**BROWN**  
SURVEYING PLLC  
PO BOX 414  
AMBOY, WA 98601  
360-600-0846  
ebrownsurveying@gmail.com



300' BPA RIGHT OF WAY (FEE) AS DESCRIBED UNDER DEED BOOK 27, PAGES 607-610 (SKAMANIA COUNTY RECORDS) AND SHOWN ON SHEET 3-C OF 24 OF THE "BONNEVILLE - COULEE LINE NO. 2" PLANS (10/18/1938). TIED CENTERLINE OF BPA TOWER LEGS ON THE BONNEVILLE-COULEE LINE NO. 2 FOR ALIGNMENT SHOWN.

VARIABLE WIDTH RIGHT OF WAY (EASEMENT) AS DESCRIBED UNDER DEED  
 BOOK 52, PAGES 75-77 AND DEED BOOK 63, PAGES 205-213  
 (SKAMANIA COUNTY RECORDS) AND AS SHOWN ON SHEET 150449  
 DTM-D OF THE "HANFORD-OSTRANDER NO. 1" PLANS (4/18/1969) AND  
 ON SHEET 3 OF 10 OF THE "STEVENSON TAP TO BONNEVILLE-ALCOA  
 NO. 1 & 2" PLANS (12/7/1962). TIED CENTERLINE OF BPA TOWER LEGS  
 FOR ALIGNMENT SHOWN, SHOWN FOR ORIENTATION ONLY.

S 88°55'21" E  
148.13'—

- 1) ROS 1-18
- 2) ROS 2-257
- 3) ROS 3-36
- 4) ROS 3-442
- 5) ROS 2022-000206

IN THE NE 1/4 NW 1/4 OF  
SECTION 10, T2N, R7E, W.M.  
SKAMANIA COUNTY, WA.



USA  
(PER SKAMANIA COUNTY GIS)

**WAUNA LAKE CLUB  
BOOK U, PAGE 361-362**

**WAUNA LAKE CLUB**  
**BOOK U, PAGE 361-362**

HEALTHY PLANET FARMS, LLC  
AFN 2014001772

S 88°35'36" E 681.11'

HEALTHY PLANET FARMS, LLC  
AFN 2014001772

**WAUNA LAKE CLUB**  
**BOOK U, PAGE 361-362**

FOUND AND HELD 1-1/4" IRON PIPE WITH 2-3/4" BRASS CAP AS SHOWN IN ROS 2-257. ALSO FOUND AN IRON PIPE WITH YELLOW PLASTIC CAP STAMPED "OLSON 9025" AS SHOWN IN ROS 1-18, S25°35'49"W, 26.38'. ALSO SEE MY "SOUTH QUARTER SECTION 3" NOTE ON ROS AFN 2022-000206 (SEE LCR 2/7-40).

EXISTING REFERENCES:

27' FIR WITH HEALED BLAZE, S11°E, 18.03' TO NAIL IN FACE

33' FIR WITH HEALED BLAZE, S41°W, 17.58' TO NAIL IN FACE

30' FIR WITH 4 NOTCHES, N44°E, 9.75' TO NAIL IN SC

FIBERGLASS POST WEST, 1.0'

HEALTHY PLANET FARMS, LLC  
AFN 2014001772

CORNER LANDS IN BLUE  
LAKE ROAD, 8' WEST OF  
EAST EDGE OF ROAD

HEALTHY PLANET FARMS, LLC  
AFN 2014001772

CALCULATED POSITION BY —  
DISTANCE—DISTANCE METHOD  
USED FOR CALCULATING THE  
NORTHWEST QUARTER OF  
SECTION 10 ONLY

— THIS LINE USED FOR  
CALCULATING THE NORTHWEST  
QUARTER OF SECTION 10

LINE	BEARING	DISTANCE
L1	S 88°32'57" E	0.22'

CALCULATED POSITION OF THE  
NORTHWEST CORNER OF THE  
NORTHWEST QUARTER OF SECTION  
10 AS SHOWN IN ROS AFN  
2022-000206. BLM 2-1/2"  
BRASS CAP BEARS N71°26'11"E,  
5.01' FROM CALCULATED POSITION  
(SEE LCR 2/7-39)

HELD THIS LINE AS THE NORTH  
LINE OF THE NORTHWEST  
QUARTER OF SECTION 10

FOUND AND HELD 1-1/4" IRON  
PIPE WITH 2-3/4" BRASS CAP  
AS SHOWN IN ROS 2-257  
(SEE LCR 2/7-40)

THIS LINE USED FOR \_\_\_\_\_  
CALCULATING THE NORTHWEST  
QUARTER OF SECTION 10

— FOUND AND HELD BLM  
2-1/2" BRASS CAP AS  
SHOWN IN ROS 1-18

DETAIL "A"  
NOT TO SCALE

- INDICATES MONUMENT FOUND (UNLESS NOTED OTHERWISE)
- INDICATES CALCULATED POSITION
- ⊙ INDICATES 5/8" x 36" REBAR WITH ORANGE PLASTIC CAP INSCRIBED "BROWN 42425" SET (UNLESS NOTED OTHERWISE)
- ( ) INDICATES RECORD INFORMATION PER SURVEY REFERENCE NUMBER
- INDICATES LINE MARKED WITH 1/2" x 72" FIBER GLASS RODS WITH PINK RIBBON.

ROS RECORD OF SURVEY

AFN AUDITOR'S FILE NUMBER

LCR LAND CORNER RECORD

BLM BUREAU OF LAND MANAGEMENT

SC SIDE CENTER

BPA BONNEVILLE POWER ADMINISTRATION



5/31/2022

SCALE: 1"=150'  
JOB NO. 22-063  
DATE: 5-31-2022  
CALC BY: GAB  
DRAWN BY: GAB  
CHECKED BY: GAB  
SHEET 2 OF 2

**BROWN**  
SURVEYING PLLC

PO BOX 414  
AMBOY, WA 98601  
360-600-0846  
ebrownsurveying@gmail.com