

Return Recorded to:
Patrick Rice and Karen Rutledge
189 Del Ray Avenue
Stevenson, WA 98648

Skamania County, WA
Total: \$206.50
EASE
Pgs=4
Request of: PATRICK RICE AND KAREN RUTLEDGE
2022-000656
03/31/2022 10:35 AM
00012622202200006560040047

SEWER EASEMENT

Skamania County
Real Estate Excise Tax

N/A
MAR 31 2022

Grantor: Patrick Rice and Karen Rutledge PAID
Grantee: Patrick Rice and Karen Rutledge
Abbreviated Legal: Lots 5, 6 and 7, Block 2, Rose Lawn Extension, Book A, Page 65
Tax Parcel Numbers: 03073634050000 (SW) KH
Skamania County Treasurer

RECITALS:

- A. Patrick Rice and Karen Rutledge are the owners of certain real property in Skamania County, Washington known as Lots 5, 6 and 7, Block 2, Rose Lawn Extension, a plat of record in Book A, Page 65, Skamania County Records.
- B. A private sanitary sewer line will be constructed from the existing manhole in vacated Avary Street to serve said Lots 5, 6 and 7.

EASEMENT:

Grantors, Patrick Rice and Karen Rutledge, grant and convey onto Grantees, Patrick Rice and Karen Rutledge, their successors and / or assigns, a Private Sewer Easement as described in Exhibit "A" and depicted in Exhibit "B" herein incorporated by reference.

The Grantor has executed this Easement to be effective upon recordation of this document.

IN WITNESS WHEREOF, this instrument was signed this 31 day of March, 2022.

GRANTOR/GRANTEE:

Patrick Rice

Patrick Rice

Karen Rutledge

Karen Rutledge

STATE OF WASHINGTON)

COUNTY OF ~~CLARK~~ Skamania)

I certify that I know or have satisfactory evidence that Patrick Rice and Karen Rutledge are the persons who appeared before me and said persons acknowledged that they are authorized to execute the instrument as owners and acknowledged it to be their free voluntary act for the purposes mentioned in the instrument.

DATED: 3/31/2022

SEAL:

BY: Leslie L Moore

Notary Public in and for the State of Washington

Residing at Skamania County

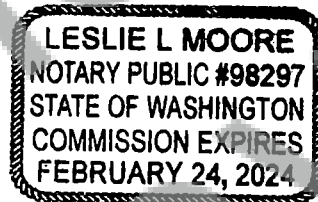



EXHIBIT "A"

PO Box 398
Camas, WA 98607
360.834.2519

www.kcdevelopment.net

PROVIDING SURVEYING AND PLANNING SERVICES WITH A PERSONAL COMMITMENT TO EXCELLENCE.

Sewer Easement Legal Description March 28, 2022

A 10.00 foot wide strip of land situated in the Southwest 1/4 of the Southeast 1/4 of Section 36, Township 3 North, Range 7 East, Willamette Meridian, Skamania County, Washington, being more particularly described as follows:

Beginning at the 1/2" rebar with plastic cap inscribed "WYEAST PLS 29288" marking the most northerly corner of Lot 7, Block 2, Rose Lawn Extension, a Plat of Record in Book A, Page 65, Skamania County Records; thence along the Northeasterly line of said Lot 7, S51°31'13"E, 101.11 feet; thence leaving said line, S00°34'13"W, 79.54 feet to the Southeast Corner of Lot 5 of said Block 2; thence along the South line thereof, N89°22'17"W, 10.00 feet; thence leaving said line, N00°34'13"E, 74.64 feet; thence N51°31'13"W, 99.26 feet to the Northwesterly line of Lot 7 of said Block 2; thence along said line, N55°24'09"E, 10.45 feet to the point of beginning.

Containing 1,773 Square Feet.

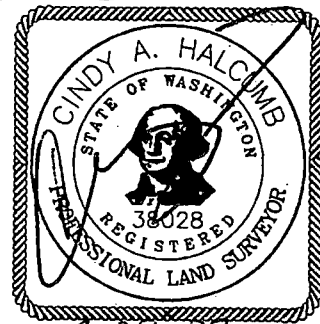

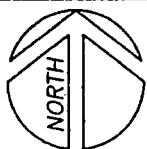

1"=30'

BASIS OF BEARINGS
SURVEY IN
AF#2020-003465

EXHIBIT "B"

A PORTION OF THE SOUTHWEST 1/4 OF THE
SOUTHEAST 1/4 OF SECTION 36,
TOWNSHIP 3 NORTH, RANGE 7 EAST, W.M.,
SKAMANIA COUNTY, WASHINGTON

MARCH 28, 2022

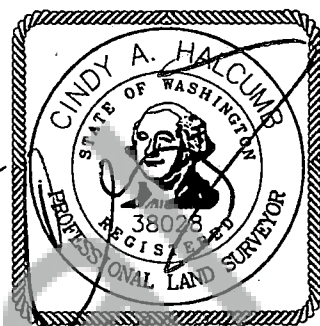

PREPARED BY
KC DEVELOPMENT
360.834.2519

