



AFTER RECORDING MAIL TO:

Name: GERALD SAUER
Address: 26300 NIE H6TH ST, CAMAS WA. 98607

5-ACRE EXEMPT LAND DIVISION PER SCC 17.64.080(H)

QUIT CLAIM DEED
BLIA

The Grantor(s) Three Rivers Recreational Area-Sauer LLC, for and in consideration of
None money, conveys and quit claims to the Grantee(s)
Three Rivers Recreational Area – Sauer LLC, any interest they may have in the following described
real estate in the County of Skamania, State of Washington, together with all after acquired title of
the grantor(s) therein:

SEE ATTACHMENT

ABBR LEGAL: Part of the

Assessor's TPN(s) 0706240003000 0 DA

Skamania County
Community Development

one-time 5-acre Exemption

Approved by:

APC 12/15/2021

Dated: 12/14/2021

[Signature]

Grantor:

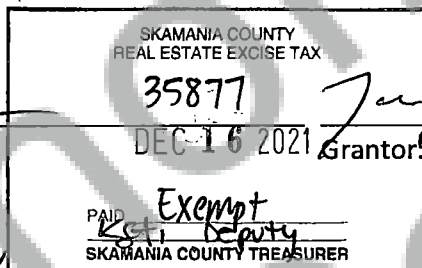

Grantor:

State of Washington

County of Clark

I certify that I know or have satisfactory evidence that Gerald + Mary Sauer
is/are the person(s) who appeared before me, and acknowledge that he/she/they signed this
instrument and acknowledged it to be his/her/their free and voluntary act for the purposes
mentioned in this instrument.

Dated: 12/15/2021

Whitney L Lodge

WHITNEY L LODGE

Notary Public in and for the State of Washington

Residing at: 1382 Wantland Rd Washougal WA

My appointment expires: 8/15/2023

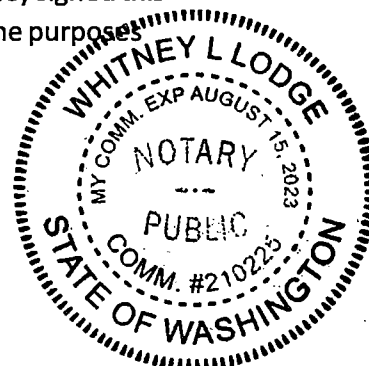

"Skamania County provides no warranty that the parcel has been reviewed for buildability, water availability, sewer or access. Buyers of
such lots shall perform their own due diligence regarding the ability to develop, obtain water, develop a septic system and access the
parcel."

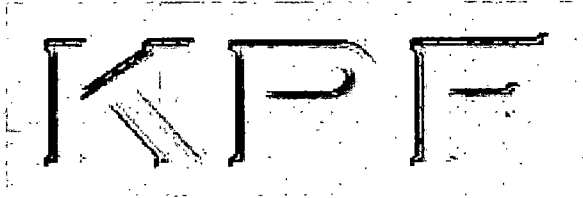

KPF Surveying Inc.
2208 E. Evergreen Blvd.
Vancouver, WA 98661
360-834-0174

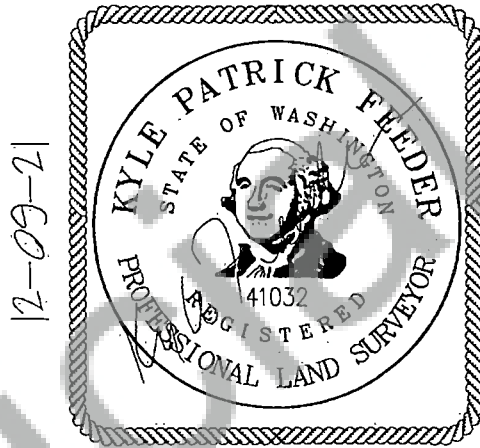

December 9, 2021

EXHIBIT " "

ROCK PIT SOUTH

A tract of land located in a portion of the Northwest quarter of the Southwest quarter of Section 24, Township 7 North, Range 6 East, Willamette Meridian, Skamania County, Washington, more particularly described as follows;

COMMENCING at the Southwest corner of said Northwest quarter of Section 24;

Thence South 88°45'25" East, for a distance of 109.85 feet;

Thence South 10°59'00" East, for a distance of 98.14 feet, to the TRUE POINT OF BEGINNING;

Thence North 90°00'00" East, for a distance of 433.07 feet;

Thence South 20°00'00" East, for a distance of 490.51 feet;

Thence South 20°00'00" West, for a distance of 300.00 feet;

Thence South 20°00'00" West, for a distance of 600.00 feet;

Thence South 01°00'00" West, for a distance of 323.00 feet;

Thence South $87^{\circ}55'03''$ West, for a distance of 180.05 feet;

Thence South $87^{\circ}55'03''$ West, for a distance of 270.90 feet;

Thence North $01^{\circ}08'28''$ East, for a distance of 289.00 feet;

Thence along the arc of a 881.47 foot radius non-tangent curve to the left, for an arc distance of 327.98 feet, the radius of which bears North $37^{\circ}28'34''$ West, through a central angle of $21^{\circ}19'07''$, the long chord of which bears North $41^{\circ}51'53''$ East, for a chord distance of 326.09 feet;

Thence North $31^{\circ}12'19''$ East, for a distance of 1.54 feet;

Thence along the arc of a 587.65 foot radius curve to the left, for an arc distance of 432.70 feet, the radius of which bears North $58^{\circ}47'41''$ West, through a central angle of $42^{\circ}11'19''$, the long chord of which bears North $10^{\circ}06'39''$ East, for a chord distance of 423.00 feet;

Thence North $10^{\circ}59'00''$ West, for a distance of 709.45 feet, to the TRUE POINT OF BEGINNING.

Containing 15.30 acres, more or less.

Together with and subject to easements, reservations, covenants, and restrictions apparent or of record.

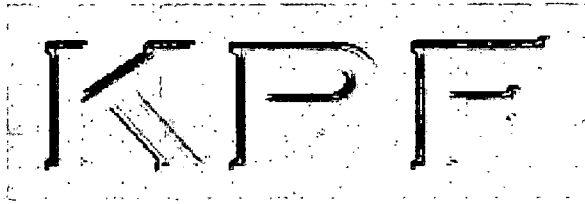

KPF Surveying Inc.
2208 E. Evergreen Blvd.
Vancouver, WA 98661
360-834-0174

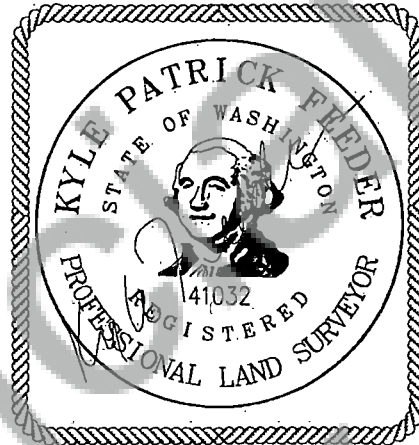

December 9, 2021

EXHIBIT " "

ROCK PIT NORTH

A tract of land located in a portion of the Northwest quarter of the Southwest quarter and the southwest quarter of the Northwest quarter of Section 24, Township 7 North, Range 6 East, Willamette Meridian, Skamania County, Washington, more particularly described as follows;

COMMENCING at the Southwest corner of said Northwest quarter of Section 24;

Thence South $88^{\circ}45'25''$ East, for a distance of 109.85 feet, to the TRUE POINT OF BEGINNING;

Thence North $10^{\circ}59'00''$ West, for a distance of 29.11 feet;

Thence along the arc of a 2220.00 foot radius curve to the right, for an arc distance of 395.00 feet, the radius of which bears North $79^{\circ}01'00''$ East, through a

central angle of $10^{\circ}11'40''$, the long chord of which bears North $05^{\circ}53'10''$ West, for a chord distance of 394.48 feet;

Thence North $75^{\circ}00'00''$ East, for a distance of 125.00 feet;

Thence along the arc of a 145.51 foot radius curve to the right, for an arc distance of 80.00 feet, the radius of which bears South $15^{\circ}00'00''$ East, through a central angle of $31^{\circ}30'00''$, the long chord of which bears South $89^{\circ}15'00''$ East, for a chord distance of 78.99 feet;

Thence South $73^{\circ}30'00''$ East, for a distance of 140.00 feet;

Thence along the arc of a 309.71 foot radius curve to the right, for an arc distance of 100.00 feet, the radius of which bears South $16^{\circ}30'00''$ West, through a central angle of $18^{\circ}30'00''$, the long chord of which bears South $64^{\circ}15'00''$ East, for a chord distance of 99.57 feet;

Thence South $01^{\circ}00'00''$ West, for a distance of 250.00 feet;

Thence South $20^{\circ}00'00''$ East, for a distance of 229.49 feet;

Thence North $90^{\circ}00'00''$ West, for a distance of 433.07 feet;

Thence North $10^{\circ}59'00''$ West, for a distance of 98.14 feet, to the TRUE POINT OF BEGINNING.

Containing 5.00 acres, more or less.

Together with and subject to easements, reservations, covenants, and restrictions apparent or of record.

Skamania County Assessor

Date 12/16/21 Parcel# 7-6-24-300
Portion of

EXHIBIT "C"

JOB NO: 20-026

DATE: 12-09-21

