

RECORD OF SURVEY

LOCATED IN THE NE 1/4 OF THE NE 1/4,
SECTION 29, T. 3N., R. 8E., W.M.
SKAMANIA COUNTY, STATE OF WASHINGTON.

LEGEND

- SET 5/8" X 30" REBAR WITH 1 1/4" ORANGE PLASTIC CAP (KA WA51797)
- FOUND MONUMENT OF RECORD SEE MONUMENT INFORMATION
- COMPUTED ANGLE POINT, NOT MONUMENTED
- D DEED DISTANCE
- C CALCULATED DISTANCE
- R.O.S. RECORD OF SURVEY
- A.F.N. AUDITOR'S FILE NUMBER
- R1 RECORD DATA PER RECORD OF SURVEY NO.
- FD FOUND DATA

REFERENCED SURVEYS

1. SURVEY PERFORMED BY OLSON ENGINEERING, FOR FERMIN OBIAS, RECORDED JULY 21, 1981 IN BOOK 2, PAGE 20
2. CARSON MEADOWS SHORT PLAT II, PERFORMED BY KLEIN AND ASSOCIATES, INC. FOR JOHN AND RAYMOND BLOOMQUIST, IN A.F.N. 2018000639
3. SURVEY PERFORMED BY MACKAY & SPOSITO, FOR THE BONNEVILLE POWER ADMINISTRATION, RECORDED OCTOBER 1, 2018 IN A.F.N. 2018001992
4. AMENDED RECORD OF SURVEY, PERFORMED BY AKS ENGINEERING AND FORESTRY, LLC. FOR WASHINGTON STATE DEPARTMENT OF TRANSPORTATION. RECORDED JULY 17, 2017. A.F.N. 2017001432
5. RECORD INFORMATION PER SKAMANIA COUNTY'S ENGINEERS DRAWING CRP NO. 68-20 WIND RIVER ROAD, COUNTY ROAD NO. 2135.
6. RECORD INFORMATION PER THE 1935 STATE PLAN SECONDARY STATE HIGHWAY NO. 8-C CONTRACT 2122.

REFERENCED DEEDS

- D1-DEED RECORDED IN BOOK 85, PAGE 260
- D2-STATUTORY WARRANTY DEED, BOOK 115, PAGE 545
- D3- WARRANTY FULFILLMENT DEED, BOOK 110, PAGE 824

MONUMENT INFORMATION

- (250) FOUND 5/8" IRON ROD W/ R.P.C. MARKED "TRANTOW LS15673", NOT RECORDED. HELD.
- (251) FOUND 3" BRASS CAP PER TRANTOW SURVEYING. HELD.
- (252) FOUND 1" IRON PIPE. HELD.
- (253) FOUND 5/8" IRON ROD W/ R.P.C. MARKED "TRANTOW LS15673", NOT RECORDED. HELD.
- (254) FOUND 1-1/2" IRON PIPE, MISSING BRASS CAP, FROM UNRECORDED SURVEY. HELD FOR CORNER.
- (255) FOUND 3" BRASS CAP PER TRANTOW SURVEYING, FROM UNRECORDED SURVEY. HELD.
- (256) FOUND 5/8" IRON ROD W/ O.P.C. (KA WA 51797), PER KLEIN & ASSOCIATES, A.F.N. 2018000639. HELD.
- (258) FOUND US ARMY BRASS CAP AS QUARTER NORTH CORNER OF SECTION 29. HELD.
- (259) FOUND SKAMANIA COUNTY BRASS CAP STAMPED SECTION CORNER. HELD.

CURVE TABLE

CURVE	LENGTH	RADIUS	DELTA	CHORD BEARING	CHORD LENGTH
C2	29.08'	542.96'	3'04'07"	S20°18'18"E	29.08'
C3	12.83'	316.48'	2'19'25"	S20°40'40"E	12.83'

AUDITOR'S CERTIFICATE:

FILED FOR RECORD THIS 14th DAY OF October, 2021
AT THE REQUEST OF CRAIG MCCONNELL, REGISTERED LAND SURVEYOR,
NO. 51797.
AUDITOR'S FILE NUMBER 2021-003469

COUNTY AUDITOR - Deputy



Klein & Associates, Inc.
ENGINEERING • SURVEYING • PLANNING
1411 13th Street • Hood River, OR 97031
TEL: 541-386-3322 • FAX: 541-386-2515

SHEET 1 OF 1
WILLAMETTE MERIDIAN
SKAMANIA COUNTY, WASHINGTON

1/4 SEC	T.	R.
29	3N.	8E.

BASIS OF BEARINGS

WASHINGTON STATE PLANE COORDINATES SYSTEM
SOUTH ZONE, GRID NORTH, GROUND DISTANCE,
ESTABLISHED BY G.P.S. OBSERVATION

NARRATIVE

THE PURPOSE OF THIS SURVEY IS TO MONUMENT THE EXTERIOR CORNERS OF TWO SEPARATE PROPERTIES AS SHOWN ON THE FACE OF THIS MAP. THE WESTERN BOUNDARY OF BOTH PROPERTIES ARE BOUND BY THE EAST RIGHT OF WAY OF WIND RIVER HIGHWAY AND CARSON DEPOT ROAD. THE EASTERN RIGHT OF WAY OF BOTH ROADS WAS CALCULATED FROM AKS SURVEY FOR WASHINGTON STATE OF TRANSPORTATION (SEE REFERENCE 4). THE EAST 1/16TH OF SECTION 29, 20 AND THE NORTHEAST CORNER OF SECTION 29 WAS TIED AND ROTATED ON TO ESTABLISH THE CENTER LINE ALIGNMENT PER AKS SURVEY. WR(1) ALIGNMENT PER AKS SURVEY WAS HELD FOR THIS SURVEY.

FOR THE NORTHERN PROPERTY DEED DISTANCES FROM THE 1/16 CORNER WERE HELD TO ESTABLISH THE NORTH AND SOUTH PROPERTY LINES. THE EAST PROPERTY LINE WAS PREVIOUSLY ESTABLISHED BY CARSON MEADOWS SHORT PLAT II. EXISTING MONUMENTS FROM SAID SHORT PLAT WERE FOUND AND HELD FOR THE EAST LINE.

FOR THE SOUTHERN PROPERTY, MONUMENTS FROM CARSON MEADOWS SHORT PLAT II WERE FOUND AND RECOVERED TO ESTABLISH THE NORTHERN AND EASTERN LINES. THE SOUTHERN LINE WAS ESTABLISHED BY HOLDING THE POSITION OF THE NORTH RIGHT OF WAY OF BONNEVILLE POWER ADMINISTRATION'S TRANSMISSION LINE AND THEN EXCEPTING OUT THE SOUTH 40 FEET OF THE LAND DESCRIBED IN THE DEED THAT DESCRIBES THE LAND BEING SURVEYED. (B.85, P.260)

PROCEDURES

A CLOSED LOOP TRAVERSE WAS PERFORMED USING A TOPCON 835 TOTAL STATION AND A RANGER DATA COLLECTOR. NO ADJUSTMENT MADE, MEETS MINIMUM STANDARDS AS DESIGNATED IN WAC 332-130-090

SURVEYOR'S CERTIFICATE:

THIS MAP CORRECTLY REPRESENTS A SURVEY MADE BY ME OR UNDER MY DIRECTION IN CONFORMANCE WITH THE REQUIREMENTS OF THE SURVEY RECORDING ACT AT THE REQUEST OF THOMAS A. GLASKI, JUNE 2021.

CRAIG MCCONNELL
REGISTERED PROFESSIONAL LAND SURVEYOR #51797

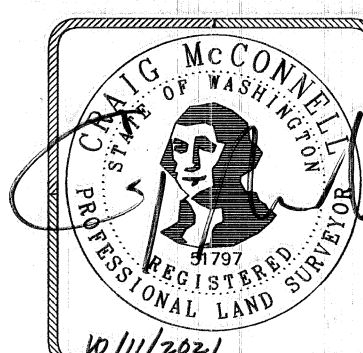

OWNER

THOMAS GLASKI

KLEIN & ASSOCIATES, MAKES NO WARRANTY AS TO MATTERS OF UNWRITTEN TITLE, ADVERSE POSSESSION, ESTOPPEL, ACQUIESCENCE.

SURVEY PERFORMED FOR:
THOMAS GLASKI
DATE OF MONUMENT: OCTOBER 04, 2021
PROJECT: 21-06-35 DRAFT: GD
FILE: 210635ROS.DWG LAYOUT TAB: WA SURVEY