

REFERENCES:

- 1) JOHN BASTROM SHORT PLAT No. 2 RECORDED AT BOOK 2, PG. 140A OF SHORT PLATS.
- 2) RE-RECORDED PLAT OF STACEY ACRES SUBDIVISION FOR CASCADE EQUIPMENT AND DEVELOPMENT BY TENNESON ENGR. CORP. WO.#10480 RECORDED JULY 15, 2004 AFN 2004153725

AUDITOR'S CERTIFICATE:

FILED FOR RECORD THIS 8th DAY OF July, 2021, AT 3:07 P.M. IN BOOK OF SURVEYS AT PAGE (AUDITOR'S FILE No. 2021-2398) AT THE REQUEST OF BENJAMIN B. BESEDA, REGISTERED LAND SURVEYOR #35092.

Benjamin B. Beseda
COUNTY AUDITOR - Deputy

ABBREVIATIONS:

REF.#	SURVEY REFERENCE NUMBER
FND.	FOUND
CALC.	CALCULATED
MON.	MONUMENT
S/W	SIDEWALK
RR.	RAILROAD
BLDG	BUILDING
R/W	RIGHT OF WAY
DOC.	DOCUMENT
ALUM.	ALUMINUM
APPROX.	APPROXIMATE
SP	SHORT PLAT
SHT.	SHEET
A.F.N.	AUDITOR'S FILE NUMBER
INX.	INTERSECTION
ST.	STREET
(E)	EXISTING
COR.	CORNER
DIST.	DISTANCE
CLR.	CLEAR
ENCR.	ENCROACHMENT
C.L.	CENTERLINE

LEGEND:

- SET 5/8" X 30" REBAR WITH YELLOW PLASTIC CAP, "B BESEDA PLS 35092"
- FOUND MONUMENTS, AS NOTED.
- CALCULATED CORNERS, NOT SET.
- EXISTING FENCE LINE.
- ADJUSTED PROPERTY LINE
- OWNERSHIP LINE
- ORIGINAL PROPERTY LINE

NARRATIVE:

THE PURPOSE OF THIS SURVEY WAS TO ADJUST THE COMMON PROPERTY LINE BETWEEN TAX PARCELS 03-08-20-2-1-0406-00, BEING LOT 1 OF THE JOHN BASTROM SHORT PLAT NO. 2, AND 03-08-20-2-1-0411-00, BEING LOT 4 OF THE STACEY ACRES SUBDIVISION. THE SUBJECT PROPERTIES LIE IN THE NORTHEAST 1/4 OF SECTION 20, TOWNSHIP 3 NORTH, RANGE 8 EAST, W.M., SKAMANIA COUNTY, WASHINGTON. PRIOR TO COMPLETING THE FIELD WORK AND MAPPING NECESSARY FOR THIS SURVEY, RESEARCH WAS MADE TO OBTAIN A COPY OF THE CURRENT DEED FOR THE SUBJECT PROPERTIES AND TO OBTAIN COPIES OF PRIOR SURVEYS OR PLATS COMPLETED ON OR IN THE VICINITY OF THE SUBJECT PROPERTIES. PRIOR SURVEYS USED AS A PART OF THE RESOLUTION SHOWN HEREON ARE LISTED AS REFERENCES.

IN THE FIELD FOR THIS SURVEY, MONUMENTS WERE FOUND PER REFERENCES #1 AND #2 AS SHOWN ON THE SURVEY AND AT THE NORTH 1/4 CORNER OF SECTION 20. THESE MONUMENTS WERE ALL FOUND TO CLOSELY MATCH RECORD DIMENSION AND WERE HELD AS FOUND FOR THE EXTERIOR BOUNDARY OF THE SUBJECT PROPERTIES. THE COMMON LINE BETWEEN THESE TAX PARCELS WAS THEN ADJUSTED PER LANDOWNER'S DIRECTION AS SHOWN ON THE SURVEY. THE PROPERTY LINE ADJUSTMENT ACTION DOES NOT CHANGE THE UNDERLYING PLAT LINES OF STACEY ACRES OR THE JOHN BASTROM SHORT PLAT NO. 2.

TIES TO THE FOUND MONUMENTS WERE MADE BY RANDOM TRAVERSE THROUGH THE PROPERTY UTILIZING A TRIMBLE S5 ROBOTIC TOTAL STATION INSTRUMENT OPERATED WITH A TSC3 TRIMBLE ELECTRONIC DATA COLLECTION UNIT. TRAVERSE IN THIS FASHION MEETS THE REQUIREMENTS OF WAC 332-130-090.

MONUMENTS WERE SET AS SHOWN ON THE SURVEY ON THE ADJUSTED PROPERTY LINE. SET MONUMENTS ARE 5/8" X 30" REBAR WITH YELLOW PLASTIC CAP INSCRIBED "B BESEDA PLS 35092".

NOTES:

1. BEARINGS ARE BASED FROM THE FOUND BRASS CAP AT THE N1/4 CORNER OF SECTION 20 TO THE NORTHEAST LOT CORNER OF LOT 4, STACEY ACRES SUBDIVISION AS SHOWN.
2. FIELD WORK FOR THIS SURVEY WAS COMPLETED JUNE OF 2021 WITH MONUMENTS SET ON JUNE 7, 2021.

SURVEYOR'S CERTIFICATE:

THIS MAP CORRECTLY REPRESENTS A SURVEY MADE BY ME OR UNDER MY DIRECTION IN CONFORMANCE WITH THE REQUIREMENTS OF THE SURVEY RECORDING ACT AT THE REQUEST OF LEROY AND DARLENE GOODRICH IN JUNE 2021.

BENJAMIN B. BESEDA,
REGISTERED LAND SURVEYOR, #35092

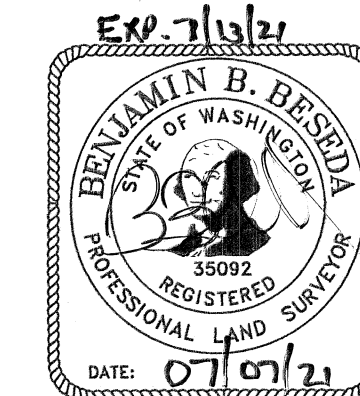

OWNER	TAX PARCEL	ORIGINAL	ADJUSTED
L. & D. GOODRICH	03-08-20-2-1-0406-00	3.07 AC.	5.27 AC.
CASCADE EQUIP. & DEV. LLC.	03-08-20-2-1-0411-00	3.24 AC.	1.04 AC.
TOTAL =		6.31 AC.	6.31 AC.
ADJUSTMENT AREA =		2.20 AC.	

CURVE	DELTA ANGLE	RADIUS	ARC LENGTH	TANGENT	CHORD BEARING	CHORD LENGTH
C1	123°52'50"	55.00'	118.92'	103.18'	N 29°19'01" E	97.07'
C2	122°13'24"	55.00'	117.33'	99.68'	S 27°37'52" E	96.31'
C3	38°40'24"	55.00'	37.12'	19.30'	S 52°49'02" W	36.42'
C4	37°00'58"	55.00'	35.53'	18.41'	N 51°07'53" W	34.92'

Date	No.	Revisions	By	App.
SURVEY OF PROPERTY LINE ADJUSTMENT TAX PARCELS 03-08-20-2-1-0406-00 AND 03-08-20-2-1-0411-00 LOT 1, JOHN BASTROM SHORT PLAT No. 2 AND LOT 4, STACEY ACRES SUBDIVISION IN THE NE1/4, SECTION 20, TWP.3 N., RANGE 8 E. W.M. CARSON, SKAMANIA COUNTY, WASHINGTON				
TENNESON ENGINEERING CORP. CONSULTING ENGINEERS 3775 CRATES WAY THE DALLES, OREGON 97058 PH. 541-296-9177 FAX 541-296-6657				
Survey	Calculation	Design	Date	Scale
B.R.H.	B.B.B.		7/07/2021	1"=50'
Drawn	Drawing Number	Work Order No.	Sheet	
S.D.H.	16000\16073\DRAWINGS\16073.BB.dwg	16073	1 of 1	