

NARRATIVE

THE PURPOSE OF THIS SURVEY WAS TO:

- 1) RECOVER THE NE, NW AND SW CORNERS OF THE "HINCHLIFF" PARCEL
- 2) SET THE SE CORNER OF SAID "HINCHLIFF" PARCEL
- 3) MARK AND POST THE NORTH, WEST AND SOUTH LINES OF SAID "HINCHLIFF" PARCEL

THE CONTROL FOR THIS PROJECT WAS ESTABLISHED BY OCCUPYING A BASE CONTROL POINT FOR 8 PLUS HOURS AND PROCESSING THE DATA USING THE NGS-OPUS SOFTWARE. ONCE THE BASE CONTROL POINT WAS ESTABLISHED THEN A TRIMBLE R8S GNSS BASE RECEIVER OPERATING IN A RTK MODE WAS SET ON THE BASE POINT. A TRIMBLE R12 GNSS ROVER OPERATING IN A RTK MODE WAS USED TO SET CONTROL, TIE MONUMENTS, TIE USE LINES AND SET MONUMENTS. A 3 SECOND TRIMBLE S8 ROBOTIC TOTAL STATION WAS USED IN AREAS WHERE THE GPS WOULD NOT WORK (TREE COVER).

BOUNDARY RESOLUTION:

I CREATED A MATHEMATICAL MODEL OF SURVEY REFERENCE NO. 3 AND PLACE IT ON THE FOUND AND HELD SW CORNER (SET IN SURVEY REFERENCE NO. 3) OF SAID "HINCHLIFF" PARCEL AND THE FOUND AND HELD NE CORNER (SET IN SURVEY REFERENCE NO. 1) OF SAID "HINCHLIFF" PARCEL. THE NW CORNER (SET IN SURVEY REFERENCE NO. 2) APPEARED TO HAVE BEEN MOVED, SO I RESET IT IN THE LOCATION BASED ON MY MATHEMATICAL MODEL.

SHORT PLAT REFERENCES (SP#):

- 1) KETCHMARK SHORT PLAT, BOOK 2, PAGE 16

SURVEY REFERENCES (S#):

- 1) OLSON SURVEY, BOOK 1, PAGE 82
- 2) KLIEN SURVEY, AFN: 2006161708
- 3) NIN J. BESEDA SURVEY, AFN: 2013001938

DEED REFERENCES:

- 1) STATUTORY WARRANTY DEED
GRANTOR: JERRY AND LISA VAN LOO
GRANTEE: KELMSCOTT GUILD, LLC
AFN: BOOK 242, PAGE 949
DATE: MAY 14, 2003

RECORD OF SURVEY

LOT 1 OF
THE "KETCHMARK SHORT PLAT"
BOOK 2, PAGE 16
IN A PORTION OF
THE NW 1/4 AND THE NE 1/4
OF THE SW 1/4
OF SECTION 27,
T. 2 N., R. 6 E., W.M.
SKAMANIA COUNTY, WASHINGTON

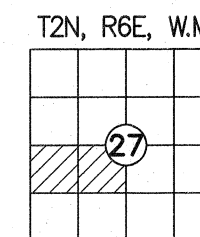

MELTON
PIN: 02062730010100
AFN: BOOK 85, PAGE 126

FOUND AND HELD A 1/2" REBAR ROD WITH
YELLOW PLASTIC CAP STAMPED "OLSON LS 9025"
SEE SURVEY REFERENCE NO. 1&3

S 89°08'55" E
(511.10' HELD S1,S3&SP1)

FOUND AND HELD A 5/8" REBAR ROD
WITH YELLOW PLASTIC CAP STAMPED
"PLS OR 832, PLS WA 22098"
SEE SURVEY REFERENCE NO. 2&3

S 01°04'57" W
(220.00' HELD S3&SP1)

WAINWRIGHT
PIN: 02062730010400
AFN: 2013002457

HINCHLIFF
LOT 1
KETCHMARK SHORT PLAT
BOOK 2, PAGE 16
PIN: 02062730010500
AFN: BOOK 242, PAGE 949
2.69 ACRES

S 101°17'31" E
(168.72' HELD S1,S3&SP1)
TUCKER ROAD NORTH
(ROAD "B")
SEE SURVEY REFERENCE NO. 1

(R=100.00' HELD S3)
(L=37°42'38" HELD S3)
(L=55.35' HELD S3)
CB=N 05°33'49" E
CD=54.64'

FOUND AND HELD A 5/8" REBAR ROD WITH BLUE
PLASTIC CAP STAMPED "BESEDA LS 32448"
SEE SURVEY REFERENCE NO. 3

SWEET
PIN: 02062730011400
AFN: 2013002457

N 89°08'55" W
(540.11' HELD S3&SP1)

LEGEND:

- INDICATES FOUND AND HELD MONUMENT AS NOTED
- ⊙ INDICATES 1/2" x 24" REBAR WITH YELLOW PLASTIC CAP
INSCRIBED "RENTON 37535", SET ON 05/09/2021
- INDICATES CALCULATED POSITION, NOTHING SET
- AFN INDICATES AUDITORS FILE NUMBER
- (S#) INDICATES RECORD DISTANCE PER SURVEY REFERENCE NO. #
- (SP#) INDICATES RECORD DISTANCE PER SHORT PLAT REFERENCE NO. #
- PIN INDICATES PARCEL IDENTIFICATION NUMBER
- X- INDICATES FENCE

SURVEYOR'S CERTIFICATE

THIS MAP CORRECTLY REPRESENTS A SURVEY MADE BY ME OR UNDER MY DIRECTION
IN CONFORMANCE WITH THE REQUIREMENTS OF THE SURVEY RECORDING ACT AT THE
REQUEST OF MARK AND KRISTINA HINCHLIFF, IN APRIL 2021.

Daniel A. Renton
DANIEL ADOLPH RENTON, PROFESSIONAL LAND SURVEYOR, LS# 37535

AUDITOR'S CERTIFICATE

FILED FOR RECORD THIS 7th DAY OF June, 2021
AT 2:00 O'CLOCK AM/PM IN BOOK 2 OF SURVEYS,
AT PAGE 1995
AT THE REQUEST OF MINISTER AND GLAESER SURVEYING INC.

Michael Nicklaus
DEPUTY COUNTY AUDITOR

AUDITORS FILE NUMBER

2021-001995

06-04-2021

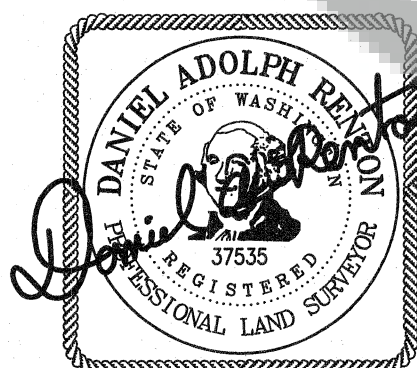

SCALE 1 INCH = 30 FEET
THE DISTANCES SHOWN HEREON ARE GRID
TO OBTAIN GROUND DISTANCES,
DIVIDE THE GRID DISTANCES BY THE
COMBINED SCALE FACTOR OF 1.0000365052
(0.19' PER MILE/0.004 PER 100')

BASIS OF BEARING:
NAD83(2011) (EPOCH: 2010.0000) WASHINGTON STATE
PLANE COORDINATE, SOUTH ZONE, US- FEET.
N 01°05'04" E, BETWEEN FOUND AND HELD MONUMENTS
ALONG THE WEST LINE OF LOT 1, "KETCHMARK" SHORT PLAT
BOOK 2, PAGE 16
CONVERGENCE ANGLE: -01°08'00"

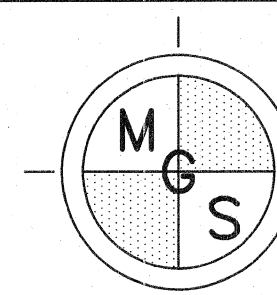

MINISTER-GLAESER
SURVEYING INC.
2200 E. EVERGREEN BLVD.
VANCOUVER, WA 98661
(360) 694-3313

SCALE: 1"=30'
JOB NO. HINCHLIFF
DATE: 06-04-2021
CALC BY: DAR
DRAWN BY: RDH
CHECKED BY: DLS
SHEET 1 OF 1