

NARRATIVE:

--THE PURPOSE OF THIS SURVEY WAS TO MARK AND MONUMENT THE PROPERTY LINES AS SHOWN PER THE REQUEST OF SKEELE AND SONS AND KEN JOHNSTON.

--FOR CONTROL I HELD THE MONUMENTS AS SHOWN IN THE MONUMENT NOTES.

--THE BEARINGS ARE NAD 83 (CORS) EPOCH 2010, WASHINGTON SOUTH ZONE BASED ON GPS OBSERVATIONS CONSTRAINED TO NGS CORS STATION P429 (PID DR5455) LATITUDE 45°40'34.04468", LONGITUDE 121°52'38.43679. DISTANCES SHOWN ARE GROUND.

SECTION 20:

--THE W 1/4 CORNER AS ESTABLISHED IN SURVEY BOOK 1, PAGE 56 IS MISSING. I REESTABLISHED IT AT THE RECORD BEARING AND DISTANCE FROM MONUMENT NO. 1 PER SURVEY BOOK 1, PAGE 56. I THEN SUBDIVIDED THE SW 1/4 ACCORDING TO THE 2009 MANUAL OF SURVEYING INSTRUCTIONS.

TAYLOR TRACT:

--THIS TRACT IS THE WEST 1/2 OF THE SW 1/4 OF THE SW 1/4 LYING SOUTH OF CARSON CREEK.

STIG TRACT:

--THIS TRACT IS THE EAST 1/2 OF THE SW 1/4 OF THE SW 1/4.

JOHNSTON

--I ESTABLISHED THE SOUTHEAST CORNER ON THE SOUTH LINE OF THE NW 1/4 OF THE SW 1/4 AT THE DEEDED DISTANCE [330.00'] FROM THE SOUTH 1/6 CORNER COMMON TO SECTIONS 19 & 20. I ESTABLISHED THE NORTHEAST CORNER AT THE DEEDED DISTANCE [990.00'] FROM THE WEST 1/4 CORNER ALONG THE NORTH LINE OF THE SW 1/4.

SKEELE AND SONS

--FOR THE WEST LINE I HELD THE EAST LINE OF THE JOHNSTON TRACT. FOR THE SOUTHERLY SOUTHEAST CORNER I SET A POINT ON LINE NORTH OF CARSON CREEK.

--THE LINES SHOWN AS HATCHED ARE MARKED WITH RED & WHITE FLAGGING ON TRUE LINE AND THE TREES WITHIN 10' OF LINE WERE MARKED WITH BLUE TREE MARKING PAINT AT CHEST HEIGHT.

MONUMENT NOTES:

[1]
AUGUST 6, 2020
1/4 CORNER COMMON TO SECTIONS 19 & 20
FOUND A 3" BRASS CAP AS NOTED IN SURVEY BOOK 1, PAGE 56
MONUMENT LIES S 00°12'33" E 32.95' FROM THE RESET 1/4 CORNER

[15]
AUGUST 10, 2020
CENTER OF SECTION 20
FOUND A 5/8" IRON ROD WITH A RED PLASTIC CAP MARKED "KLEIN & ASSOC WA 42690 LS" PER AF 2007166723 (HELD).
A 2" IRON ROD LIES S 01°23'25" E 50.90', ORIGIN UNKNOWN.

[18]
AUGUST 10, 2020
1/4 CORNER COMMON TO SECTIONS 20 & 29
FOUND A 3 1/2" U.S. ARMY CORPS OF ENGINEERS BRASS CAP AS NOTED IN SURVEY BOOK 1, PAGE 56 (HELD).

[592]
AUGUST 6, 2020
SECTION CORNER COMMON TO SECTIONS 19, 20, 29 & 30
FOUND A 3" SKAMANIA COUNTY BRASS CAP AS NOTED IN SURVEY BOOK 1, PAGE 56 (HELD).

LEGEND

- FOUND MONUMENT AS NOTED
- SET A 5/8" X 30" IRON ROD WITH A 1 1/12" ALUMINUM CAP MARKED "WALLACE PLS 42699"
- () RECORD SURVEY DATA
- [X] MONUMENT NO.
- //// MARKED LINE
- AFN AUDITORS FILE NUMBER

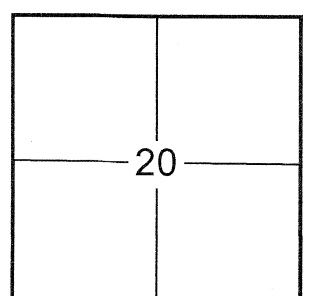

AUDITOR'S CERTIFICATE

FILED FOR RECORD THIS 20 DAY OF April, 2021
AT 9:24 A.M. IN VOLUME --- OF SURVEYS, PAGE ---
AT THE REQUEST OF K.L.S. SURVEYING INC.
Robert Naumire COUNTY AUDITOR BY Donald D. Wallace Jr. DEPUTY
AFN: 2021-001360

SURVEYOR'S CERTIFICATE

THIS MAP CORRECTLY REPRESENTS A SURVEY MADE BY ME OR UNDER MY DIRECT SUPERVISION IN CONFORMANCE WITH THE REQUIREMENTS OF THE SURVEY RECORDING ACT AT THE REQUEST OF SKEELE AND SONS RESOURCES LTD IN AUGUST 2020.

Donald D. Wallace Jr., PLS # 42699
DONALD D. WALLACE JR.

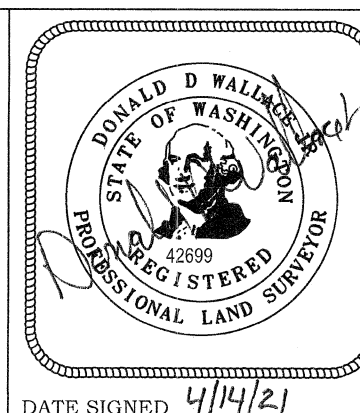

PROJECT NO: 20-259
DRAWING NO: ROS
DRAWN BY: DDW/SND
FIELD CREW: JDM/ DJL
EQUIPMENT: NIKON NEVO /IG8
REVISED: 4-14-2021

RECORD OF SURVEY FOR
SKEELE AND SONS RESOURCES, LTD & KEN JOHNSTON
IN THE SW 1/4 OF SECTION 20,
T3N, R8E, W.M.,
SKAMANIA COUNTY, WASHINGTON
AUGUST 28, 2020
SCALE 1" = 400'

