

# TRAVERSE & ACCURACY STATEMENT

TIES TO CONTROLLING MONUMENTS WERE MADE BY A TRIMBLE R8 GNSS RECEIVER WITH RTK CORRECTION FROM THE WASHINGTON STATE REFERENCE NETWORK. TRAVERSING WAS PERFORMED WITH A FIVE SECOND TOTAL STATION AND RELATED MEASURING EQUIPMENT, OF WHICH MEET STATE STANDARDS (WAC 332-130-090-100) AT THE TIME OF THIS SURVEY.

## LEGEND

- CALCULATED CORNER; NOT SET OR FOUND
- CORNER OF RECORD FOUND AS NOTED
- SET RED PLASTIC CAP (R.P.C.) ON 5/8" REBAR
- ( ) PLAT OR DEED CALL
- FND FOUND
- RPC RED PLASTIC CAP

## NOTES

- HILL DRIVE VACATED AS PER AFN 146560. SKAMANIA COUNTY VACATED 0.02 MILES OF HILL DRIVE. THIS SURVEY HELD 113.3' FROM STEWART ROAD CL. THIS EQUATED 0.021 MILES. AS PER STATE LAW 1/2 OF ROAD WAS GIVEN TO LOT 3.
- THIS SURVEY HOLDS THIS LINE AS THE BOUNDARY OF LOT 4. REF. 1 PLAT DOES NOT HAVE SOLID LINE FOR LOT 4.

## REFERENCES

- 1964 MAPLE HILL TRACTS NO. 1, VOL. A, PAGE 124
- 1991 TRANTOW R.O.S., AFN 111213
- CRP 97-17, DRAWER 4-5-AC 2.25

CURVE	RADIUS	ARC	CHORD BEARING	CHORD	TANGENT	DELTA
C1	216.00'	118.99'	S87°29'21"W	117.49'	61.04'	31°33'43"
C2	216.00'	31.00'	S67°35'50"W	30.97'	15.52'	8°13'19"
C3	1462.59'	87.64'	N75°27'44"E	87.62'	43.83'	3°25'59"

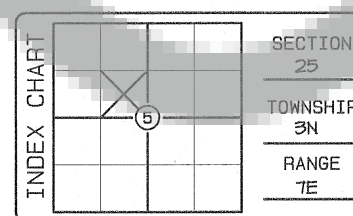
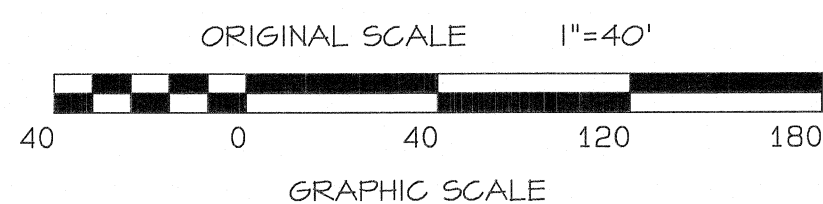

DATE	DESCRIPTION	BY
10/20	DRAFT	JR
10/20	CHECK	ARB

## RECORD OF SURVEY FOR WILLIAM & MARYANN TOWNSEND SKAMANIA COUNTY, WA

SHEET: 1 OF 1  
PROJECT: 20B210  
DATE: Jan 2021

Bell Design Co. makes no warranty as to matters of unwritten title such as adverse possession, prescriptive rights, easements, estoppel, acquiescence, etc. or to environmental concerns such as hazardous waste, pollution, wet land delineation, riparian changes, flood zones, etc.

0:\2020\B210\20b210.prc

# RECORD OF SURVEY

LOTS 3 & 4 OF MAPLE HILL TRACTS NO. 1  
IN THE SE1/4 OF THE NW1/4 OF SEC. 25  
TOWNSHIP 3 NORTH, RANGE 7 EAST, W.M.  
SKAMANIA COUNTY, WASHINGTON

## SURVEY NARRATIVE

THE PURPOSE OF THIS SURVEY WAS TO SET THE CORNER MONUMENTS FOR THE LOTS 3 AND 4 OF MAPLE HILL SUBDIVISION NUMBER 1. THE REFERENCE 1 AND 2 SURVEY MONUMENTS FOUND AS NOTED ON THE PLAT WERE USED FOR BOUNDARY CONTROL. A ROAD VACATION IN 1994 (AFN 146560/B.232.P.141) VACATED A PORTION OF HILL DRIVE. THIS SURVEY SET MONUMENTS AT HALF THE WIDTH FOR TOWNSEND AS VACATIONS OF ROADS CREATED BY PLATS ARE ACQUIRED BY THE ADJACENT LOTS AT HALF THE ROAD WIDTH. THE NORTH ROW OF LOOP ROAD WAS POSITIONED BY TIES TO MONUMENTS ON THE SOUTH SIDE OF LOOP THAT WERE IN RELATION TO CRP 97-17.

## LEGAL DESCRIPTION

TOWNSEND  
DEED B.123, P.554  
LOT 3 MAPLE HILL TRACTS NO. 1  
PARCEL#03072520130100  
PLUS 50% OF VACATION  
AFN 146560

TOWNSEND  
DEED B. 78, P. 405  
LOT 4 MAPLE HILL TRACTS NO. 1  
PARCEL#03072520130000

## AUDITOR'S CERTIFICATE

Filed for record this 21st day of January, 2021  
at 9:17 AM at the request of Bell Design Co.

*Monica Nicklaus*  
County Auditor-Deputy  
Date 01-12-2021

2021-000128  
Auditor File Number

THIS MAP CORRECTLY REPRESENTS A SURVEY MADE BY ME OR UNDER MY DIRECTION IN CONFORMANCE WITH THE CURRENT REQUIREMENTS OF THE SURVEY RECORDING ACT AT THE REQUEST OF WILLIAM TOWNSEND.

*Austin R. Bell*  
Austin R. Bell PLS 41954  
Date 1-8-21

