

Skamania County, WA
Total: \$155.50
MINE
Pgs=3

2020-003473

12/10/2020 01:00 PM

Request of: JAMES SHARPLES



WHEN RECORDED RETURN TO:

JAMES SHARPLES
643 CISPUS Rd.
RANDLE, WA. 98377

DOCUMENT TITLE(S)

NOTICE OF MINING LOCATION

REFERENCE NUMBER(S) of Documents assigned or released:

2 DOCUMENTS

☐ Additional numbers on page _____ of document.

GRANTOR(S):

JAMES SHARPLES & TYTAN SHARPLES &
JERRY TINNEY

☐ Additional names on page _____ of document.

GRANTEE(S):

RAELL MINE

☐ Additional names on page _____ of document.

LEGAL DESCRIPTION (Abbreviated: i.e. Lot, Block, Plat or Section, Township, Range, Quarter):

NE QUARTER SEC. / SEC. 15 SOUTH / TOWNSHIP 10 NORTH
RANGE 8 EAST

☐ Complete legal on page _____ of document.

TAX PARCEL NUMBER(S):

☐ Additional parcel numbers on page _____ of document.

The Auditor/Recorder will rely on the information provided on this form. The staff will not read the document to verify the accuracy or completeness of the indexing information.

I am requesting an emergency nonstandard recording for an additional fee as provided in RCW 36.18.010. I understand that the recorded processing requirements may cover up or otherwise obscure some part of the text of the original document.

Company Name:

Signature/Title: James Sharples GRANTOR

After recording, return to (Name, Address, Zip):

JAMES J. SHARPLES
643 CISPUS RD.
RANDLE, WA. 98377

NOTICE OF MINING LOCATION (Vein or Lode Claim)

Grantor (Locator/Individual): JAMES SHARPLES & TYTAN SHARPLES & JERRY
Grantee (Name of Mine): RAELL MINE TINNEY
Abbreviated Legal Description:
Assessor's Property Tax Parcel or Account No:
Reference No(s) of Documents Assigned or Released:

STATE OF WASHINGTON, County of SKAMANIA, YELLOW JACKET
Mining District.

NOTICE HEREBY IS GIVEN that the undersigned locators, each a citizen of the United States or one who has declared an intention to become such, have discovered on NOVEMBER 15th, 2020, a vein or lode of locatable mineral-bearing rock in place upon the public domain of the United States which is open to mineral entry and location within the above state, county and mining district; and in accordance with the laws of the United States and of the State of Washington, have located and do hereby locate a claim upon such vein or lode by posting this notice of such discovery and location on a substantial post or monument at the point of discovery. The name of the claim is: RAELL MINE Claim, further described* as follows:

Commencing at a post marked No. 1;
then 1,500 feet in a EASTERLY direction to a corner post marked No. 2,
then 600 feet in a NORTHERN direction to a corner post marked No. 3,
then 1,500 feet in a WESTERLY direction to a corner post marked No. 4,
then 600 feet in a SOUTHERN direction to that corner post marked No. 1.
The locators claim 1,500 FT feet in a EASTERLY direction from the point of discovery to the 660 FT end line and 300 FT feet on each side of the middle of the vein or lode, further claiming all the surface rights, privileges and minerals, with all dips, spurs, angles and variations, and other rights granted by existing laws and customs. This claim is further described as being 660 FT E feet from the following natural object or permanent monument in the vicinity: F.S. Rd 29

* This diagram explains method of description of claim.

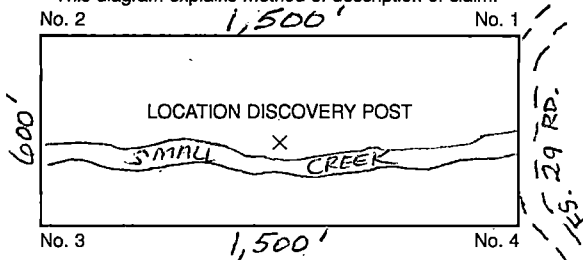

(OVER)



Form No. 284D - Notice of Mining Location (Vein or Lode Claim) ET
© 2007 Washington Legal Blank, Portland, OR www.wlbforms.com

NO PART OF ANY WASHINGTON LEGAL BLANK FORM MAY BE REPRODUCED IN ANY FORM OR BY ANY ELECTRONIC OR MECHANICAL MEANS.

The general course or strike of the vein or lode as nearly as may be determined is EASTERLY

_____ with reference to the natural object or permanent monument described above.
This claim is situated in the NE (quarter section) of Section 15 South, Township
10 North, Range 8 East of the WILLAMETTE Meridian, as surveyed by the U.S. Govern-
ment or protracted if the land is unsurveyed _____

The end lines of the claim are parallel to each other. The adjoining claims are NONE

This notice is placed conspicuously at the discovery post, and posts are placed at each corner of the claim. The location of this claim is distinctly marked on the ground so that the boundaries of the claim may be readily traced.

Located NOVEMBER 15th, 2020

JAMES SHARPLES

TYTAN SHARPLES

JERRY TINNEY

Locator(s)

STATE OF WASHINGTON,

County of Lewis

} ss.

I certify that I know or have satisfactory evidence that James Sharples
_____ is/are the individual(s) who appeared before me, and who
acknowledged that he/she/they signed this instrument and acknowledged it to be his/her/their free and voluntary act
for the uses and purposes mentioned in the instrument.

DATED December 7, 2020

Angela Bowen

Notary Public for Washington

My appointment expires May 2, 2024

