



After recording, return to (Name, Address, Zip):

Andrew Guntle  
8105 - 52nd St E.  
Fife WA 98424

**NOTICE OF LOCATION OF PLACER CLAIM**

Grantor (Locator/Individual): Andrew Guntle - Jim Wilcox  
Grantee (Name of Mine): Broken Shore  
Abbreviated Legal Description: T10N R8E Sec 4  
Assessor's Property Tax Parcel or Account No:  
Reference No(s) of Documents Assigned or Released:

STATE OF WASHINGTON, County of Skamania,  
Mining District.

NOTICE HEREBY IS GIVEN that the undersigned locators, each a citizen of the United States or one who has declared an intention to become such, have discovered on 6-1-2019, 20\_\_\_\_, a placer deposit of locatable minerals upon the public domain of the United States which is open to mineral entry and location within the above state, county and mining district; and in accordance with the laws of the United States and of the State of Washington, have located and do hereby locate a placer claim of 20 acres by posting this notice of location on a substantial post or monument in a conspicuous place at the point of discovery inside the boundaries of the claim.

The claim is named the Broken Shore  
Claim, which is described as follows (fill out one of the two sections below):

(1) If location is made in conformity with public surveys: This claim comprises the N/2 OF the NE 1/4 OF the SE 1/4 of Section 14, Township 10N, Range 8E, of the 33 Meridian,

(2) If location is on unsurveyed land; or if on surveyed land and it is not practicable to describe by legal subdivisions: One substantial post or stone monument appears at each corner of the claim. Starting at Discovery Post #1 (Center of the west half of claim, NW of Kidd Creek) then in a N/W direction 400 feet, more or less, to the beginning point of the description of the placer claim hereby located, to-wit: a substantial post or stone monument ("post") set in the ground, marked Post No. 1;

The number of posts may vary depending on the size of the claim.  
then 1320 feet in a E direction to a post marked No. 2;  
then 660 feet in a S direction to a post marked No. 3;  
then 1320 feet in a W direction to a post marked No. 4;

(OVER)



then \_\_\_\_\_ feet in a \_\_\_\_\_ direction to a post marked No. 5;  
then \_\_\_\_\_ feet in a \_\_\_\_\_ direction to a post marked No. 6;  
then \_\_\_\_\_ feet in a \_\_\_\_\_ direction to a post marked No. 7;  
then \_\_\_\_\_ feet in a \_\_\_\_\_ direction to a post marked No. 8;  
then 660 feet in a N direction to the post marked No. 1.  
This claim is situated in the NE/SE (quarter section) of Section 4,  
Township 10 N, Range 8 E, of the 33  
Meridian, either as surveyed by the U.S. Government or protracted if the land is unsurveyed,

The locators intend to hold and work the above-described claim as provided by the laws of the United States and the State of Washington and claim all of the rights and privileges granted by existing laws and customs.

The adjoining claims are \_\_\_\_\_

Located \_\_\_\_\_, 20\_\_\_\_.

Locator(s)\*

STATE OF WASHINGTON,

County of Skamania / Pierce } ss.

I certify that I know or have satisfactory evidence that James G. Wilcox  
Andrew L. Guntree is/are the individual(s) who appeared before me, and who  
acknowledged that he/she/they signed this instrument and acknowledged it to be his/her/their free and voluntary act  
for the uses and purposes mentioned in the instrument.

DATED 06/10/2019

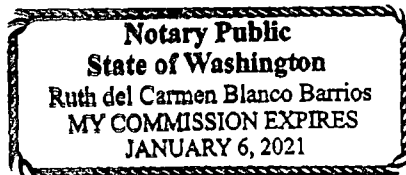

Ruth del Carmen Blanco Barrios  
Notary Public for Washington

My appointment expires 01/06/2021

# MAP of Mining Claim(s)

Township 10N Range 9E Section 4 State of IND.

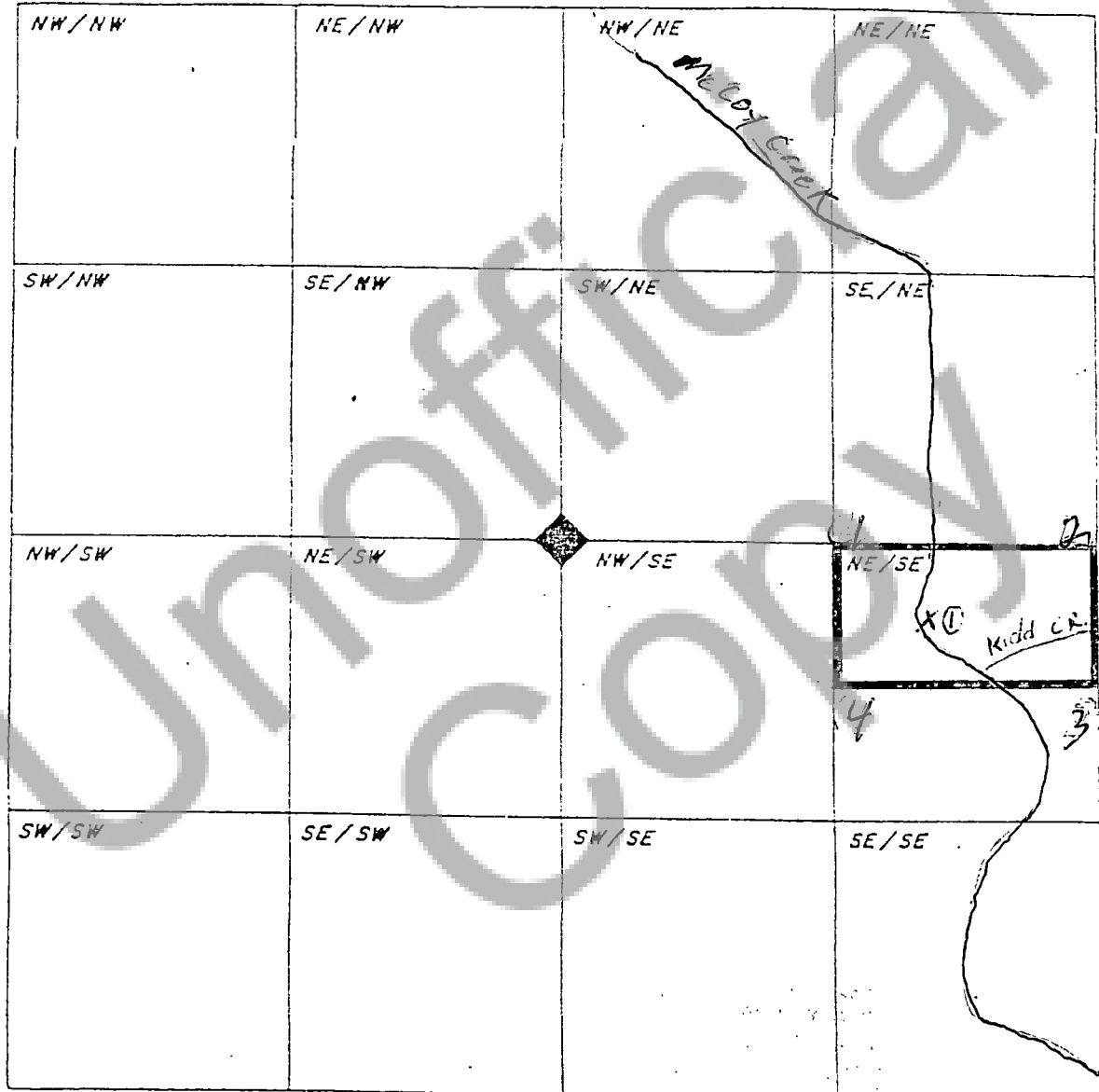

When drawing your claim(s) use an ordinary ruler. 1/8th of an inch would be 100 feet so a full size lode (600' x 1500') would be 3/4" by 1 7/8". A full size placer (1320' x 660') would be 1 5/8" by 13/16".