

# RECORD OF SURVEY

SURVEY LOCATED IN THE  
SE 1/4 OF NW 1/4 THE SECTION 6, T.1N. R.6E., W.M.  
SKAMANIA COUNTY, STATE OF WASHINGTON

## AUDITOR'S CERTIFICATE:

FILED FOR RECORD THIS 28th DAY OF January, 2019  
AT 3:38 P.M. IN BOOK \_\_\_\_\_ OF SURVEYS PAGE \_\_\_\_\_ AT THE

REQUEST OF LEONIDES J. SANDOVAL, REGISTERED LAND SURVEYOR,  
NO. 44349. AFN # 2019000134

Debra A. Sampson  
COUNTY AUDITOR - Deputy

## LEGEND

- SET 5/8" X 24" REBAR WITH 1 1/4" RED PLASTIC CAP  
(KA OR58608 WA44349)
- FOUND MONUMENT AS NOTED IN DESCRIPTIONS
- COMPUTED ANGLE POINT, NOT MONUMENTED
- RM REFERENCE MONUMENT
- R.O.S. RECORD OF SURVEY
- A.F.N. AUDITOR'S FILE NUMBER
- R1 RECORD DATA PER RECORD OF SURVEY NO.
- FD FOUND DATA

## FOUND MONUMENT INFORMATION

- (250) 1/2" IRON ROD WITH Y.P.C. STAMPED "GLAESER 15024"; PER BOOK 2, PAGE 247; HELD FOR NORTH LINE.
- (251) 5/8" IRON ROD WITH O.P.C. STAMPED "BESEDA 34127"; PER A.F.N. 2013000797; HELD FOR NORTHWEST CORNER.
- (252) 5/8" IRON ROD WITH R.P.C. STAMPED "LS 44349"; PER A.F.N. 2012181984; HELD FOR LINE.
- (253) 1/2" IRON ROD; PER A.F.N. 2012181984; HELD FOR NORTHEAST CORNER.
- (254) 5/8" IRON ROD; BENT; PER BOOK 3, PAGE 13; HELD FOR EAST LINE.
- (255) 5/8" IRON ROD; PER BOOK 3, PAGE 55; HELD FOR SOUTHEAST CORNER.
- (256) 5/8" IRON ROD; PER BOOK 3, PAGE 55; HELD FOR SOUTHWEST CORNER.

## REFERENCED SURVEYS

- R1. SURVEY PERFORMED BY KLEIN & ASSOCIATES, INC. FOR MARC MEDLINE, FILED NOVEMBER 6, 2012, A.F.N. 2012181984
- R2. SURVEY PERFORMED BY HAGERDORN, INC. FOR ANTHONY CLARKE, FILED APRIL 18, 2013, A.F.N. 2013000797.
- R3. LOCKWOOD SHORT PLAT NUMBER 1, PERFORMED BY ROBERT GLAESER FOR JIM LOCKWOOD, FILED AUGUST 5, 1981 IN BOOK 3, PAGE 13.
- R4. F. BROWN SHORT PLAT NUMBER 1, PERFORMED BY ROBERT GLAESER FOR FRIEDA BROWN, FILED MAY, 1981 IN BOOK 3, PAGE 55.
- R5. SURVEY PERFORMED BY HAGERDORN, INC. FOR ANTHONY CLARKE, FILED APRIL 18, 2013, A.F.N. 2013000797.

## REFERENCED DEEDS

STATUTORY WARRANTY DEED, A.F.N. 2015002743

## SURVEYOR'S CERTIFICATE:

THIS MAP CORRECTLY REPRESENTS A SURVEY MADE BY ME OR UNDER MY DIRECTION IN CONFORMANCE WITH THE REQUIREMENTS OF THE SURVEY RECORDING ACT AT THE REQUEST OF ANTHONY SAMPSON, DECEMBER 2018.

Leonides J. Sandoval 1-24-2019  
LEONIDES J. SANDOVAL DATE  
REGISTERED PROFESSIONAL LAND SURVEYOR #44349



Klein & Associates, Inc.

ENGINEERING • SURVEYING • PLANNING  
1411 13th Street • Hood River, OR 97031  
TEL: 541-386-3322 • FAX: 541-386-2515

SHEET 1 OF 1  
WILLAMETTE MERIDIAN  
SKAMANIA COUNTY, WASHINGTON

1/4	SEC	T.	R.
<input checked="" type="checkbox"/>	6	1N.	6E.
<input type="checkbox"/>			
<input type="checkbox"/>			

## NARRATIVE

THE PURPOSE OF THIS SURVEY IS TO SURVEY AND STAKE THE NORTH, EAST AND SOUTH LINE OF THAT CERTAIN TRACT OF LAND DESCRIBED IN STATUTORY WARRANTY DEED, A.F.N. 2015002743, ALSO DESCRIBED AS SKAMANIA COUNTY TAX PARCEL 01060600030700, LOCATED IN THE SOUTHWEST QUARTER OF NORTHWEST QUARTER OF SECTION 6, TOWNSHIP 1 NORTH, RANGE 6 EAST OF THE WILLAMETTE MERIDIAN.

THE BASIS OF BEARING FOR THIS SURVEY ARE FOUND MONUMENTS AT THE NORTHEAST CORNER OF THE SOUTHWEST QUARTER OF THE SOUTHWEST QUARTER OF SECTION 6, AND ON THE INTERSECTION OF THE NORTH LINE OF THE SOUTHWEST QUARTER OF SECTION 6 AND THE EASTERLY RIGHT-OF-WAY OF SMITH-CRIPE ROAD.

THE EAST LINE WAS ESTABLISHED BY FINDING AND HOLDING EXISTING MONUMENTS, AS WAS THE SOUTH LINE. THE WEST LINE FOLLOWS THE CENTERLINE OF SMITH-CRIPE ROAD.

NO MONUMENTS WERE SET DURING THIS SURVEY.

## PROCEDURES

A CLOSED LOOP TRAVERSE WAS PERFORMED USING A TRIMBLE S6 TOTAL STATION AND A TSC3 DATA COLLECTOR. NO ADJUSTMENT MADE, MEETS MINIMUM STANDARDS AS DESIGNATED IN WAC 332-130-090

## OWNER

ANTHONY T. & DEBRA A. SAMPSON

SURVEY PERFORMED FOR:  
TONY SAMPSON  
DATE OF SURVEY: DECEMBER 2018  
PROJECT: 18-12-03 DRAFT: BTB  
FILE: 181203.DWG LAYOUT TAB: WA SURVEY

KLEIN & ASSOCIATES, MAKES NO WARRANTY AS TO MATTERS OF UNWRITTEN TITLE, ADVERSE POSSESSION, ESTOPPEL, ACQUIESCENCE.

## BASIS OF BEARING

588°46'55"E 546.19'  
516.30'FD 516.29'R2

SW 1/4  
OF  
SE 1/4  
OF  
NW 1/4

STATUTORY WARRANTY DEED  
A.F.N. 2015002743

APPROXIMATE  
LOCATION OF  
SMITH-CRIPE ROAD  
(NOT SURVEYED)

APPROXIMATE  
LOCATION OF  
SNOWBERRY LANE  
(NOT SURVEYED)

293.51'FD 294.01'R4  
589°39'15"E 326.33'

SNOWBERRY LANE

60 0 60 120  
SCALE - FEET  
1" = 60'

## BASIS OF BEARINGS

FOUND MONUMENTS AT THE NORTHEAST AND NORTHWEST CORNERS OF TAX PARCEL 01060600030700 (POINTS 250 AND 253) PER A.F.N. 2012181984.

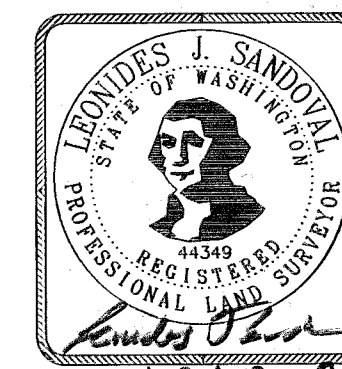

1-24-2019