

NARRATIVE:

THE PURPOSE OF THIS SURVEY WAS TO CREATE A 20.00 FOOT WIDE CORRIDOR ACROSS USFWS OWNERSHIP CENTERED ON AN EXISTING DOMESTIC WATER LINE AND TO MARK THE COMMON BOUNDARY BETWEEN THE USFWS AND SAID LOT 1. WE LOCATED AND VERIFIED THE EXISTING CORNER MONUMENTS SET IN SAID SHORT PLAT AS WELL AS THE LOCATION OF COOK-UNDERWOOD ROAD. SURVEY EQUIPMENT USED CONSISTED OF A GPS BASE AND ROVER AND A 3-SECOND TOTAL STATION INSTRUMENT WITH AN ELECTRONIC DATA COLLECTOR. SURVEY FIELD WORK MET THOSE STANDARDS CONTAINED IN W.A.C. 332-130-090.

LEGEND (CONTINUED):

OPUS INDICATES ONLINE POSITIONING USER SERVICE  
PID INDICATES PERMANENT IDENTIFIER

CALCULATED POSITION  
SHOWN FOR  
ORIENTATION ONLY

USFWS  
(TR 11c)

USFWS  
(TR 11)

USFWS  
LOT 3  
(TR 12a)

USFWS

"JOHN JESSUP  
SHORT PLAT"  
(BOOK 3, PAGE 84)

USFWS  
LOT 2  
(TR 12a)

PRIVATE

PRIVATE  
LOT 1

FOUND MONUMENT TABLE

- FOUND 5/8" IR SET IN 6" DIAMETER CONCRETE BLOCK; T-POST SET IN CONCRETE AS WELL; ROD STICKS OUT OF CONCRETE 0.9' +/- AND TOP OF CONCRETE IS 0.4' +/- ABOVE GROUND; HELD
- FOUND MAG NAIL LOCATED 0.25' NW OF FENCE CORNER; DRILLED DIAGONALLY IN ROCK, GOOD CONDITION; N 88°57'28" W, 0.19' FROM CALCULATED POSITION; HELD CALCULATED POSITION.
- FOUND 1/2" IR WITH Y.P.C. "GLAESER 15024" 0.2' +/- BELOW GROUND, FAIR CONDITION, CAP SLIGHTLY DAMAGED, 0.3' NORTH OF FENCE POST; HELD
- FOUND 1/2" IR NO CAP FLUSH; GOOD CONDITION; HELD
- FOUND 3"x3" CONCRETE MONUMENT 2.1' ABOVE GROUND; FAIR CONDITION; LEANING SLIGHTLY SOUTH; SHOT AT CENTER WHEN LEVELED.
- FOUND 1/2" IR WITH Y.P.C. "GLAESER 15024" FLUSH WITH GROUND; FAIR CONDITION; SLIGHTLY BROKEN CAP; N 09°22'48" W, 1.12' FROM CALCULATED POSITION; HELD CALCULATED POSITION.
- FOUND 3"x3" CONCRETE POST 1.5' ABOVE GROUND; GOOD CONDITION; STANDING STRAIGHT; SHOT AT TOP CENTER.
- FOUND 3"x3" CONCRETE POST 1.9' ABOVE GROUND; GOOD CONDITION; STANDING STRAIGHT; SHOT AT TOP CENTER.
- FOUND 3"x3" CONCRETE POST 2.0' ABOVE GROUND; GOOD CONDITION; STANDING STRAIGHT; SHOT AT TOP CENTER.
- FOUND 3"x3" CONCRETE POST 1.8' ABOVE GROUND; GOOD CONDITION, SLIGHT LEAN TO NW; SHOT AT TOP CENTER WHEN LEVELED.
- FOUND 3"x3" CONCRETE POST 1.2' ABOVE GROUND; POOR CONDITION; TOP BROKEN OFF TIED AT APPROXIMATE CENTER.
- FOUND 3"x3" CONCRETE POST 1.5' ABOVE GROUND; GOOD CONDITION STANDING STRAIGHT; SHOT AT TOP CENTER.
- FOUND 1/2" IR WITH Y.P.C. "GLAESER 15024" 0.1' +/- ABOVE GROUND; CAP CRACKED ROD GOOD CONDITION;
- FOUND 1/2" IR WITH Y.P.C. "GLAESER 15024" FLUSH WITH GROUND; CAP CRACKED GOOD CONDITION; HELD
- FOUND 1/2" NO CAP (BROKEN CAP IN DIRT); 0.1' +/- ABOVE GROUND; GOOD CONDITION; HELD

LINE TABLE

LINE	BEARING	DISTANCE
L1	S 08°00'00" E	26.00'
L2	S 08°00'00" E	29.54'
L3	S 20°00'00" W	41.84'
L4	S 20°00'00" W	40.00'
L5	S 56°06'49" W	46.61'
L6	N 84°43'56" W	30.31'
L7	N 83°49'37" W	29.90'
L8	S 18°51'42" W	37.29'

CURVE TABLE

CURVE	RADIUS	DELTA	ARC DIST.	CHORD BEARING	CHORD DIST.
C1	925.00'	12°17'21"	198.40'	N 00°17'24" W	198.02'
C2	925.00'	10°17'39"	166.19'	N 11°34'54" W	165.97'
C3	955.00'	22°35'00"	376.42'	N 05°26'13" W	373.98'
C4	746.30'	6°32'27"	85.20'	S 13°27'30" E	85.15'
C5	746.30'	0°53'53"	11.70'	S 09°44'20" E	11.70'

LEGEND:

- INDICATES MONUMENT FOUND AS NOTED (TIED SEPTEMBER, 2018)
- INDICATES CALCULATED POSITION
- INDICATES 1/2" x 24" REBAR WITH YELLOW PLASTIC CAP "RENTON 37535" SET
- USFWS INDICATES UNITED STATES FISH AND WILDLIFE SERVICE
- INDICATES STEEL "T" POST SET
- Y.P.C. INDICATES YELLOW PLASTIC CAP
- IR INDICATES STEEL REBAR
- TR INDICATES TRACT
- +/- INDICATES MORE OR LESS
- ( ) INDICATES RECORD DATA
- INDICATES CONTROL POINT
- N INDICATES NORTHING
- E INDICATES EASTING
- PT INDICATES POINT OF TANGENT
- PC INDICATES POINT OF CURVE

DEED REFERENCE:

- (D1) GRANTOR: THE TRUST FOR PUBLIC LAND  
GRANTEE: UNITED STATES OF AMERICA  
WARRANTY DEED: DEED BOOK 102, PAGE 38  
DATE: (7-29-1986)
- (D2) GRANTOR: THE TRUST FOR PUBLIC LAND  
GRANTEE: UNITED STATES OF AMERICA  
WARRANTY DEED: DEED BOOK 118, PAGE 19  
DATE: (3-2-1993)

SURVEY REFERENCES:

- (S1) "JOHN JESSUP SHORT PLAT"  
BOOK 3, PAGE 84
- (S2) SKAMANIA COUNTY  
CRP 65-23  
"COOK-UNDERWOOD ROAD"
- (S3) "JESSUP TRACT ADDITION"  
BY M. RICHEY (7-9-87)

AUDITOR'S CERTIFICATE

FILED FOR RECORD THIS 18th DAY OF December, 2018  
AT 12:23 PM O'CLOCK AM (PM) IN BOOK OF SURVEYS,  
AT PAGE AFN 2018002472  
AT THE REQUEST OF MINISTER AND GLAESER SURVEYING INC.

DEPUTY COUNTY AUDITOR

SURVEYOR'S CERTIFICATE

THIS MAP CORRECTLY REPRESENTS A SURVEY MADE BY ME OR UNDER MY DIRECTION IN CONFORMANCE WITH THE REQUIREMENTS OF THE SURVEY RECORDING ACT AT THE REQUEST OF USFWS IN OCTOBER 2018.

DANIEL ADOLPH RENTON, PROFESSIONAL LAND SURVEYOR, LS# 37535

MINISTER AND GLAESER SURVEYING, INC. MAKES NO WARRANTIES AS TO MATTERS OF UNWRITTEN TITLE SUCH AS ADVERSE POSSESSION, ACQUIESCENCE, ESTOPPEL, ETC.

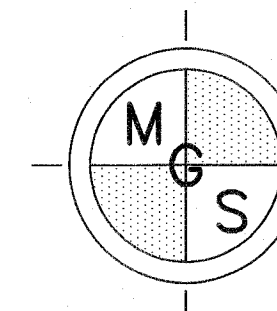

MINISTER-GLAESER  
SURVEYING INC.  
2200 E. EVERGREEN BLVD.  
VANCOUVER, WA 98661  
(360) 694-3313

SCALE: 1"=60'  
JOB NO. 18-311  
DATE: 12-14-18  
CALC BY: DLS  
DRAWN BY: AAD  
CHECKED BY: DAR  
SHEET 1 OF 1

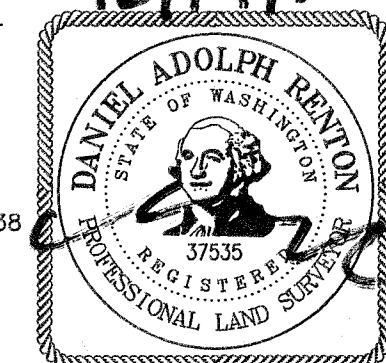

BASIS OF BEARING:  
NAD83(2011) (EPOCH: 2010.0000) WASHINGTON STATE PLANE  
COORDINATE SOUTH ZONE US-FEET  
N 01°02'32" E BETWEEN THE FOUND AND HELD CORNER #1 AND  
THE FOUND AND HELD CORNER #2 AS SHOWN ON THIS SURVEY  
CONVERGENCE ANGLE: 0°50'08"  
COMBINED SCALE FACTOR: 1.0000178983

SCALE 1 INCH = 60 FEET  
THE DISTANCES SHOWN HEREON ARE GRID  
TO OBTAIN GROUND DISTANCES, DIVIDE THE  
GRID DISTANCE BY THE  
COMBINED SCALE FACTOR OF 1.0000178983  
(0.09' PER MILE/0.002 PER 100')