

After recording, return to:

JEFF LINDBERG
Landerholm, P.S.
P.O. Box 1086
Vancouver, WA 98666-1086

SKAMANIA COUNTY
REAL ESTATE EXCISE TAX

33128
MAR - 8 2018

PAID

106.40 15800
C
SKAMANIA COUNTY TREASURER

Grantor Property:	Parcel No. 03080800021200	Space Above for Recording Information Only
	Lot 3, HEGEWALD SP #2 BK 2/PG 188 9/1980	
Grantee Properties:	Parcel No. 03080800010000	
	Parcel No. 03080800030000	2m 3/8/18

EASEMENT GRANT

Grantor, DONNA BARLOW and ALYSSA ALEXANDRIA JANE BARLOW, Co-Trustees of the Thomas D. Barlow, Jr. and Donna M. Barlow Trust dated April 24, 1992, as amended and restated on December 5, 2017, own real property located in Skamania County, Washington legally described in Exhibit "A" attached hereto and incorporated herein ("Barlow Property").

Grantee, BIRKENFELD HERITAGE, LLC, a Washington limited liability company, owns real property located in Skamania County, Washington legally described in Exhibit "B" attached hereto and incorporated herein ("Birkenfeld Property").

Grantee, WEYERHAEUSER COMPANY, a Washington corporation, owns real property located in Skamania County, Washington legally described in Exhibit "C" attached hereto and incorporated herein ("Weyerhaeuser Property").

Grantor hereby grants to Grantees and Grantees' permittees, a permanent and non-exclusive easement forty (40) feet in width over, under and across the northerly forty (40) feet of Grantor's Property (the "Easement Area") for the purpose of ingress, egress and utilities for the benefit of Grantees' Properties. The Easement Area is depicted on the attached Exhibit "D". In exercising the rights granted herein, Grantees, their successors, and assigns, may conduct such maintenance and improvement activities which, in the opinion of Grantees or either of them, may be reasonably necessary for the use of the Easement Area. These activities may include, but are not limited to, improving, paving, widening, and otherwise modifying the existing road within the Easement Area. Grantees shall be exclusively responsible for any costs incurred in improving, paving, widening, or any other modification or improvements within the Easement Area.

EASEMENT GRANT - 1
BIRH02-000002 - 3431099_1.doc

 **LANDERHOLM**
805 Broadway Street, Suite 1000
PO Box 1086
Vancouver, WA 98666
T: 360-696-3312 • F: 360-696-2122

Grantees shall contribute, along with all other property owners using the Easement Area, to the reasonable maintenance of the Easement Area to the extent required by the common law or by any separate written agreement.

This Easement Grant and the maintenance obligations herein shall run with the land and shall be binding on Grantor, Grantees, and their respective heirs, successors and assigns.

Grantors:

2/21/18
Date

Donna M. Barlow
DONNA BARLOW, as Co-Trustee of the Thomas D. Barlow, Jr. and Donna M. Barlow Trust dated April 24, 1992, as amended and restated on December 5, 2017

2/21/18
Date

[Signature]
ALYSSA ALEXANDRIA JANE BARLOW, as Co-Trustee of the Thomas D. Barlow, Jr. and Donna M. Barlow Trust dated April 24, 1992, as amended and restated on December 5, 2017

Grantees:

WEYERHAEUSER COMPANY,
a Washington corporation

Date

By: _____
Its: _____

DocuSign Envelope ID: 5C8F98F9-8490-4936-8840-9347F90042AC

Grantees shall contribute, along with all other property owners using the Easement Area, to the reasonable maintenance of the Easement Area to the extent required by the common law or by any separate written agreement.

This Easement Grant and the maintenance obligations herein shall run with the land and shall be binding on Grantor, Grantees, and their respective heirs, successors and assigns.

Grantors:

Date

DONNA BARLOW, as Co-Trustee of the Thomas D. Barlow, Jr. and Donna M. Barlow Trust dated April 24, 1992, as amended and restated on December 5, 2017

Date

ALYSSA ALEXANDRIA JANE BARLOW, as Co-Trustee of the Thomas D. Barlow, Jr. and Donna M. Barlow Trust dated April 24, 1992, as amended and restated on December 5, 2017

Grantees:

WEYERHAEUSER COMPANY,
a Washington corporation

Date

2/26/18

By: Devin W. Stockfish
Its: SUP, Timberlands

EASEMENT GRANT - 2
BIRH02-000002 - 3431099_1.doc



LANDERHOLM

805 Broadway Street, Suite 1000
PO Box 1086
Vancouver, WA 98666
T: 360-696-3312 • F: 360-696-2122

BIRKENFELD HERITAGE, LLC,
a Washington limited liability company

2-14-2018

Date

Heidi B. Penner

By: Heidi B. Penner

Its: authorized agent

*** NOTARY BLOCKS ON FOLLOWING THREE PAGES ***

EASEMENT GRANT - 3
BIRH02-000002 - 3431099_1.doc



LANDERHOLM

805 Broadway Street, Suite 1000
PO Box 1086
Vancouver, WA 98666
T: 360-696-3312 • F: 360-696-2122

STATE OF WASHINGTON)
) ss.
 County of ~~Clark~~ Klickitat)

I certify that I know or have satisfactory evidence that DONNA BARLOW is the person who appeared before me, and said person acknowledged that she signed this instrument, on oath stated that she was authorized to execute the instrument and acknowledged it as Co-Trustee of the Thomas D. Barlow, Jr. and Donna M. Barlow Trust dated April 24, 1992, as amended and restated on December 5, 2017, to be the free and voluntary act of such party for the uses and purposes mentioned in the instrument.

Dated: February 21, 2018.

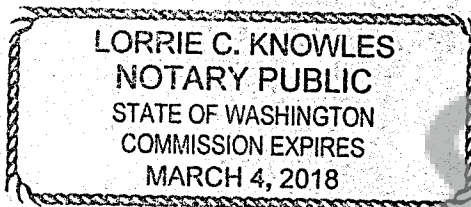

Lorrie C. Knowles
 NOTARY PUBLIC in and for the State of
 Washington, residing at White Salmon.
 My appointment expires: 3/4/18.

STATE OF WASHINGTON)
) ss.
 County of ~~Clark~~ Klickitat)

I certify that I know or have satisfactory evidence that ALYSSA ALEXANDRIA JANE BARLOW is the person who appeared before me, and said person acknowledged that she signed this instrument, on oath stated that she was authorized to execute the instrument and acknowledged it as Co-Trustee of the Thomas D. Barlow, Jr. and Donna M. Barlow Trust dated April 24, 1992, as amended and restated on December 5, 2017, to be the free and voluntary act of such party for the uses and purposes mentioned in the instrument.

Dated: February 21, 2018.

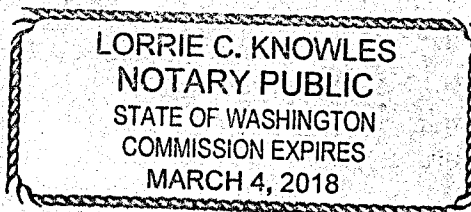

Lorrie C. Knowles
 NOTARY PUBLIC in and for the State of
 Washington, residing at White Salmon.
 My appointment expires: 3/4/18.

STATE OF WASHINGTON)

County of Clark King

I certify that I know or have satisfactory evidence that Devin W. Stockfish is the person who appeared before me, and said person acknowledged that he/she signed this instrument, on oath stated that he/she was authorized to execute the instrument and acknowledged it as SVP, Tim berlands of WEYERHAEUSER COMPANY, a Washington corporation, to be the free and voluntary act of such party for the uses and purposes mentioned in the instrument.

Dated: February 26, 2018.

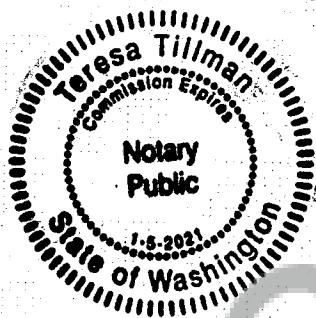

Doreen Sullivan
NOTARY PUBLIC in and for the State of
Washington, residing at Federal Way
My appointment expires: Jan 05, 2021

EASEMENT GRANT - 5
BIRH02-000002 - 3431099_1.doc



LANDERHOLM

805 Broadway Street, Suite 1000
PO Box 1086
Vancouver, WA 98666
T: 360-696-3312 • F: 360-696-2122

STATE OF WASHINGTON)

) ss.

County of Clark)

I certify that I know or have satisfactory evidence that Heidi B. Penner is the person who appeared before me, and said person acknowledged that he/she signed this instrument, on oath stated that he/she was authorized to execute the instrument and acknowledged it as authorized agent of BIRKENFELD HERITAGE, LLC, a Washington limited liability company, to be the free and voluntary act of such party for the uses and purposes mentioned in the instrument.

Dated: 2-14, 2018.

NOTARY PUBLIC in and for the State of
Washington, residing at Vancouver
My appointment expires: June 18, 2019

JEFF LINDBERG
Notary Public
State of Washington
My Commission Expires
June 18, 2019

EASEMENT GRANT - 6
BIRH02-000002 - 3431099_1.doc

 **LANDERHOLM**
805 Broadway Street, Suite 1000
PO Box 1086
Vancouver, WA 98666
T: 360-696-3312 • F: 360-696-2122

EXHIBIT A
Barlow Property Legal Description

Lot 3 of the Gary Hegewald Short Plat, recorded in Book "2" of Short Plats, Page 188, Records of Skamania County, Washington.

EASEMENT GRANT - 7
BIRH02-000002 - 3431099_1.doc

 **LANDERHOLM**
805 Broadway Street, Suite 1000
PO Box 1086
Vancouver, WA 98666
T: 360-696-3312 • F: 360-696-2122

EXHIBIT B
Birkenfeld Property Legal Description

PARCEL 13: (03-08-08-0-0-0100-00)

The Northeast quarter of the Northeast quarter; The South half of the Northeast quarter; The North half of the Southeast quarter; Government Lots 1, 2 and 3; all in Section 8, Township 3 North, Range 8 East, in the Willamette Meridian, County of Skamania and State of Washington.

EXCEPTING THEREFROM that portion as set forth in Boundary Line Adjustment recorded in Quit Clam Deed, recorded June 7, 2012 as Auditor File No. 2012180816, more particularly described as follows:

All of the above described property lying Westerly and Southerly of the center of the Wind River,

EASEMENT GRANT - 8
BIRH02-000002 - 3431099_1.doc



LANDERHOLM

805 Broadway Street, Suite 1000
PO Box 1086
Vancouver, WA 98666
T: 360-696-3312 • F: 360-696-2122

EXHIBIT C
Weyerhaeuser Property Legal Description

The Northeast Quarter of the Southwest Quarter and that portion of the Southeast Quarter of the Northwest Quarter which lies on the Southeasterly side of the center of Bear Creek, Section 8, Township 3 North, Range 8 East of the Willamette Meridian, in the County of Skamania, State of Washington.

EASEMENT GRANT - 9
BIRH02-000002 - 3431099_1.doc

 **LANDERHOLM**
805 Broadway Street, Suite 1000
PO Box 1086
Vancouver, WA 98666
T: 360-696-3312 • F: 360-696-2122

EXHIBIT "D"

JOB NO: 18-010

DATE: 2-09-18

SCALE 1" = 150'

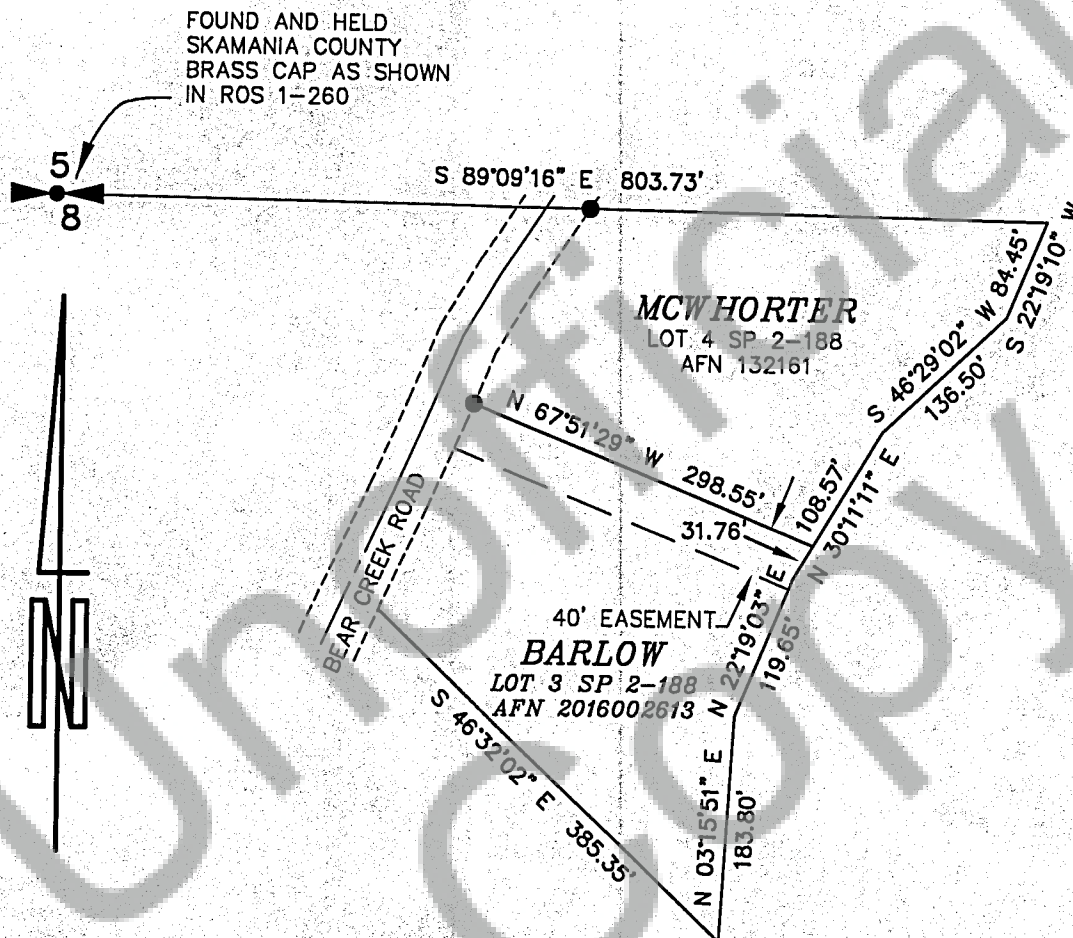
**LEGEND:**

- INDICATES FOUND 1/2" IRON REBAR WITH YELLOW PLASTIC CAP STAMPED "OLSON 9025" AS SHOWN IN RECORD OF SURVEY BOOK 1 PAGE 260

SP SHORT PLAT

AFN AUDITOR'S FILE NUMBER

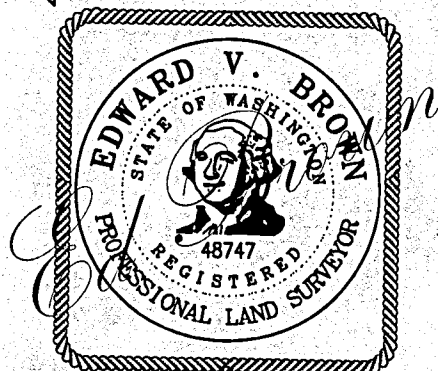

2-9-2018