

SKAMANIA COUNTY
AFTER RECORDING MAIL TO: **REAL ESTATE EXCISE TAX**

Name: Sorn Nymark, VII
ANE Forest of Lewis River, Inc.
Embarcadero, Suite 152
1000 SE Bay Blvd
Newport, Oregon 97365

23070
FEB - 5 2018

PAID [Signature]
SKAMANIA COUNTY TREASURER

QUIT CLAIM DEED

The purpose of this deed is to create a 20 acre +/- parcel of land owned by the Grantor and Grantee; is therefore exempt from the requirements of R.C.W. 58.17 and the Skamania County Short Plat Ordinance. The property described in this deed cannot be segregated and sold without conforming to the State of Washington Subdivision laws.

GRANTOR, ANE FORESTS OF LEWIS RIVER, INC., a Washington Corporation

GRANTEE, ANE FORESTS OF LEWIS RIVER, INC., a Washington Corporation

For no consideration, GRANTOR hereby conveys and quit claims to GRANTEE, the following described real estate, situate in the County of Skamania, State of Washington, as described on attached Exhibit "A", and shown on attached Exhibit "B".

Together with all after acquired title of the grantor therein:

Abbreviated legal description: 2m 2-5-18
A portion of Assessor's Property Tax Parcel / Account Number: 07050000180000, located in the South half of the Southwest quarter of Section 14, Township 7 North, Range 5 East, Willamette Meridian, Skamania County, Washington.
(See attached exhibits)

IN WITNESS WHEREOF, the Grantor has executed this Quit Claim Deed this 5 day of February 2018.

GRANTOR: ANE FORESTS OF LEWIS RIVER, INC.

By: [Signature]
Sorn Nymark, President

STATE OF WASHINGTON)
)-ss
COUNTY OF CLARK)

Planning Department - Exemption over
20 acres approved by: A. Gabriel
2/5/18

I certify that I know or have satisfactory evidence that SORN NYMARK, to me known to be the President of ANE FORESTS OF LEWIS RIVER, INC. a Washington Corporation, the corporation that executed the within and foregoing instrument, who appeared before me, and said person acknowledge that he signed this instrument and acknowledged it to be his free and voluntary act for the uses and purposes mentioned in this instrument.

IN WITNESS WHEREOF, I have hereunto set my hand and affixed my official seal the day and year first above written.

Signature: [Signature]

Name: Gaylyn Feeder
Notary Public in and for the State of Washington
Residing in Camas, Washington
My appointment expires April 01, 2019



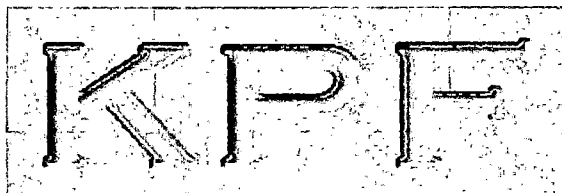

KPF Surveying Inc.
1514 N.E. 267th Ave.
Camas, WA 98607
360-834-0174

December 19, 2017

EXHIBIT "A"

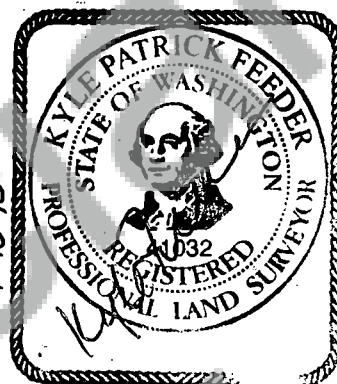

LOT 24

A tract of land located in the South half of the Southwest quarter of Section 14, Township 7 North, Range 5 East, Willamette Meridian, Skamania County, Washington, more particularly described as follows;

Beginning at the southwest corner of said Southwest quarter of Section 14;
Thence North 89°59'36" East, for a distance of 2232.29 feet to the TRUE POINT OF BEGINNING;

Thence North 00°00'00" East, for a distance of 538.24 feet;
Thence North 90°00'00" West, for a distance of 314.77 feet;
Thence North 00°00'00" West, for a distance of 560.75 feet;
Thence North 21°01'42" East, for a distance of 202.34 feet;
Thence North 01°20'37" West, for a distance of 143.51 feet;
Thence North 89°49'54" East, for a distance of 673.08 feet;
Thence North 77°23'51" East, for a distance of 107.74 feet;
Thence South 00°00'00" East, for a distance of 578.50 feet;
Thence North 90°00'00" West, for a distance of 135.74 feet;
Thence South 01°47'24" West, for a distance of 421.69 feet;
Thence South 08°47'07" West, for a distance of 260.24 feet;
Thence South 34°38'27" West, for a distance of 165.16 feet;
Thence South 63°18'45" West, for a distance of 141.90 feet to as point on the south line of said Southwest quarter;
Thence South 89°59'36" West along said south line, for a distance of 123.36 feet to the TRUE POINT OF BEGINNING.

Containing 20 acres, more or less.

Planning Department - Exemption over
20 acres approved by: *A. Lumbert*
2/5/18

Skamania County Assessor
Date 2-5-18 Parcel# 07050000180000
ym Portion of

EXHIBIT "B"

JOB NO: 06-017

DATE: 12-19-17

