

KPF Surveying Inc.
1514 N.E. 267th Ave.
Camas, WA 98607
360-834-0174

December 19, 2017

EXHIBIT "A"

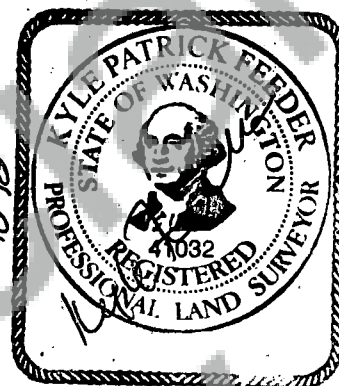

LOT 23

A tract of land located in the South half of the Southwest quarter of Section 14, Township 7 North, Range 5 East, Willamette Meridian, Skamania County, Washington, more particularly described as follows;

Beginning at the southwest corner of said Southwest quarter of Section 14;
Thence North 89°59'36" East, for a distance of 611.35 feet to the TRUE POINT OF BEGINNING;

Thence North 00°21'25" East, for a distance of 505.99 feet;

Thence North 58°34'14" East, for a distance of 62.23 feet;

Thence North 90°00'00" East, for a distance of 1564.69 feet;

Thence South 90°00'00" East, for a distance of 538.24 feet to a point on the South line of said Southwest quarter;

Thence South 89°59'36" West, along said south line, for a distance of 1620.94 feet to the TRUE POINT OF BEGINNING.

Containing 20 acres, more or less.

Skamania County Assessor
Date 2-5-18 Parcel# 07050000180000
JM *Perkins of*

Planning Department - Exemption over
20 acres approved by: *Alexis*
2/5/18

EXHIBIT "B"

JOB NO: 06-017

DATE: 12-19-17

