

KPF Surveying Inc.
1514 N.E. 267th Ave.
Camas, WA 98607
360-834-0174

December 19, 2017

EXHIBIT "A"

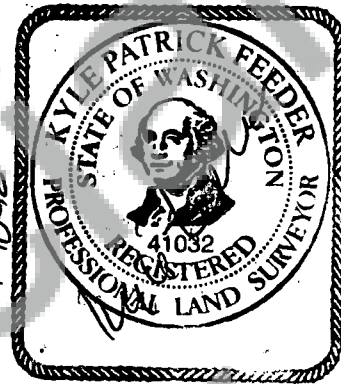

LOT 18

A tract of land located in the North half of the Southwest quarter of Section 14, Township 7 North, Range 5 East, Willamette Meridian, Skamania County, Washington, more particularly described as follows;

Beginning at the northeast corner of said Southwest quarter of Section 14;
Thence South 00°47'35" West, along the east line of said Southwest quarter, for a distance of 659.68 feet;
Thence South 89°48'47" West, for a distance of 1417.62 feet to a point on the centerline of said existing road;
Thence along said centerline the following courses;
 North 50°53'43" East, for a distance of 82.50 feet;
 Thence North 44°17'51" East, for a distance of 149.60 feet;
 Thence North 04°53'19" East, for a distance of 231.67 feet;
 Thence North 43°20'16" West, for a distance of 231.67 feet;
 Thence North 62°34'53" West, for a distance of 218.51 feet;
Thence North 89°48'47" East, for a distance of 1591.41 feet to the POINT OF BEGINNING.

Containing 20 acres, more or less.

Skamania County Assessor
Date 2/5/18 Parcel# 7-5-1800
C.C.

Planning Department - Exemption over
20 acres approved by: A. Lenbrich
2/5/18

EXHIBIT "B"

JOB NO: 06-017

DATE: 12-19-17

