

KPF Surveying Inc.  
1514 N.E. 267<sup>th</sup> Ave.  
Camas, WA 98607  
360-834-0174

December 19, 2017

EXHIBIT "A"

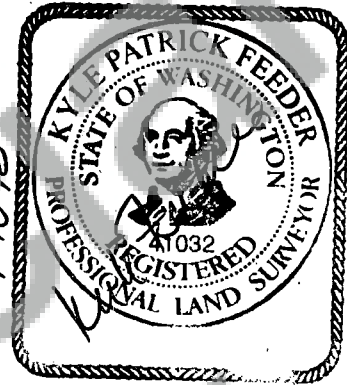

LOT 16

A tract of land being the East half of the Southeast quarter of the Northeast quarter of Section 14,  
Township 7 North, Range 5 East, Willamette Meridian, Skamania County, Washington.

Containing 20 acres, more or less.

Planning Department - Exemption over  
20 acres approved by: Alex Lub

2/5/18

BTNLF  
Skamania County Assessor  
Date 2/5/18 Parcel# 7-5-1800  
65

UNOFFICIAL COPY

# EXHIBIT "B"

JOB NO: 06-017

DATE: 12-19-17

