

**AFTER RECORDING MAIL TO:**

**Name: Sorn Nymark, VII**  
**ANE Forest of Lewis River, Inc.**  
**Embarcadero, Suite 152**  
**1000 SE Bay Blvd**  
**Newport, Oregon 97365**

**SKAMANIA COUNTY**  
**REAL ESTATE EXCISE TAX**  
*33092*  
**FEB -5 2018**  
**PAID** *exempt*  
*by deputy*  
**SKAMANIA COUNTY TREASURER**  
**QUIT CLAIM DEED**

The purpose of this deed is to create a 20 acre +/- parcel of land owned by the Grantor and Grantee; is therefore exempt from the requirements of R.C.W. 58.17 and the Skamania County Short Plat Ordinance. The property described in this deed cannot be segregated and sold without conforming to the State of Washington Subdivision laws.

**GRANTOR, ANE FORESTS OF LEWIS RIVER, INC., a Washington Corporation**

**GRANTEE, ANE FORESTS OF LEWIS RIVER, INC., a Washington Corporation**

For no consideration, GRANTOR hereby conveys and quit claims to GRANTEE, the following described real estate, situate in the County of Skamania, State of Washington, as described on attached Exhibit "A", and shown on attached Exhibit "B".

Together with all after acquired title of the grantor therein:

Abbreviated legal description: *B.S.*  
A portion of Assessor's Property Tax Parcel / Account Number: 07050000180000, being the East half of the Northwest quarter of the Northeast quarter of Section 14, Township 7 North, Range 5 East, Willamette Meridian, Skamania County, Washington.  
(See Attached Exhibits)

IN WITNESS WHEREOF, the Grantor has executed this Quit Claim Deed this 5 day of February 2018.

**GRANTOR: ANE FORESTS OF LEWIS RIVER, INC.**

By: *[Signature]*  
Sorn Nymark, President

STATE OF WASHINGTON )  
 )-ss  
COUNTY OF CLARK )

Planning Department - Exemption over  
20 acres approved by: *A Lembrich*  
*2/5/18*

I certify that I know or have satisfactory evidence that SORN NYMARK, to me known to be the President of ANE FORESTS OF LEWIS RIVER, INC. a Washington Corporation, the corporation that executed the within and foregoing instrument, who appeared before me, and said person acknowledge that he signed this instrument and acknowledged it to be his free and voluntary act for the uses and purposes mentioned in this instrument.

IN WITNESS WHEREOF, I have hereunto set my hand and affixed my official seal the day and year first above written.

Signature: *[Signature]*

Name: Gaylyn Feeder

Notary Public in and for the State of Washington

Residing in Camas, Washington

My appointment expires April 01, 2019



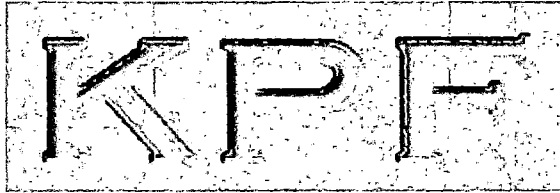

KPF Surveying Inc.  
1514 N.E. 267<sup>th</sup> Ave.  
Camas, WA 98607  
360-834-0174

December 19, 2017

EXHIBIT "A"

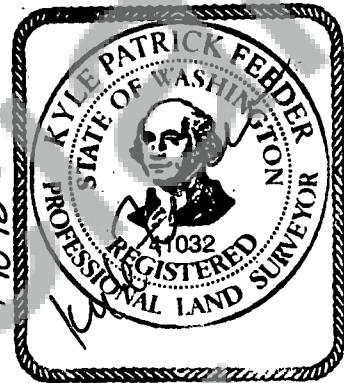

LOT 6

A tract of land being the East half of the Northwest quarter of the Northeast quarter of Section 14, Township 7 North, Range 5 East, Willamette Meridian, Skamania County, Washington.

Containing 20 acres, more or less.

Skamania County Assessor  
Date 2/5/18 Parcel# 7-5-1800  
G.S.  
PTN 1.6

Planning Department - Exemption over  
20 acres approved by: A. L. Smith  
2/5/18

# EXHIBIT "B"

JOB NO: 06-017

DATE: 12-19-17

