

RECORD OF SURVEY

SURVEY LOCATED IN THE SW 1/4 OF THE SW 1/4 SECTION 11, T.3N., R.9E., W.M. SKAMANIA COUNTY, STATE OF WASHINGTON

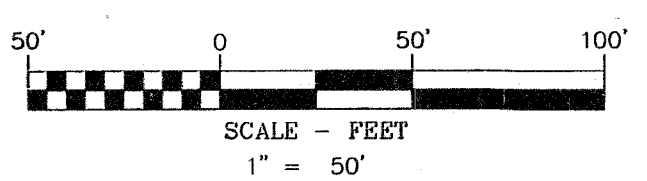

BASIS OF BEARINGS

GRID NORTH, WASHINGTON STATE PLANE COORDINATE SYSTEM, SOUTH ZONE (4602) NAD 83 BASED ON GNSS OBSERVATIONS HOLDING THE WEST LINE OF SECTION 11. BETWEEN FOUND IRON PIPES FOR THE SOUTHWEST CORNER OF SECTION 11 AND THE SOUTH 1/16 CORNER SECTION 11. WITH A MEDIAN CONVERGENCE ANGLE OF -00°50'10"

LEGEND

- SET 5/8" X 24" REBAR WITH 1 1/4" ORANGE PLASTIC CAP (KA WA 51797)
- FOUND MONUMENT AS NOTED IN FOUND MONUMENT INFORMATION
- COMPUTED ANGLE POINT, NOT MONUMENTED
- A.F.N. AUDITOR'S FILE NUMBER
- R1 RECORD DATA PER RECORD OF SURVEY NO.
- FD FOUND DATA
- (100') DEED CALL
- Y.P.C. YELLOW PLASTIC CAP

FOUND MONUMENT INFORMATION

- (252) 5/8" IRON ROD WITH Y.P.C. STAMPED "TERRA LS 18731"; PER BOOK 3 OF SURVEYS PAGE 32. A.F.N. 109330; HELD FOR PROPERTY CORNER.
- (253) 5/8" IRON ROD WITH Y.P.C. STAMPED "TERRA LS 18731"; PER BOOK 3 OF SURVEYS PAGE 32. A.F.N. 109330; HELD FOR PROPERTY CORNER.
- (254) 5/8" IRON ROD WITH Y.P.C. STAMPED "TERRA LS 18731"; PER BOOK 3 OF SURVEYS PAGE 32. A.F.N. 109330; HELD FOR NORTHEAST PROPERTY CORNER.
- (255) 5/8" IRON ROD WITH Y.P.C. STAMPED "TERRA LS 18731"; PER BOOK 3 OF SURVEYS PAGE 32. A.F.N. 109330; HELD FOR SOUTHEAST CORNER TAX LOT 1100.
- (256) 1" IRON PIPE; HELD FOR THE SOUTHWEST CORNER OF SECTION 11.
- (257) 1-1/4" ANGLE IRON; FOUND 2.45 FEET SOUTH OF THE SOUTH LINE OF SECTION 11. NOT ACCEPTED
- (258) 3/4" IRON PIPE; HELD FOR THE SOUTH 1/16th OF SECTION 11/10
- (259) 5/8" IRON ROD WITH Y.P.C. STAMPED "TERRA LS 18731"; PER BOOK 3 OF SURVEYS PAGE 32. A.F.N. 109330; FOUND S76°18'15"W 0.12 FEET FROM 1/64 CORNER. NOT ACCEPTED
- (260) 3/4" IRON PIPE; PER BOOK 1 OF SURVEYS, PAGE 240. HELD FOR SOUTHEAST CORNER OF THE SW 1/4 OF THE SW 1/4 OF THE SW 1/4.
- (261) 5/8" IRON ROD WITH Y.P.C. STAMPED "TERRA LS 18731"; PER BOOK 3 OF SURVEYS PAGE 32. A.F.N. 109330
- (262) 5/8" IRON ROD WITH Y.P.C. STAMPED "LS 36619"; PER A.F.N. 2008170322.

REFERENCED SURVEYS

- R1. SURVEY PERFORMED BY TERRA SURVEYING, FOR SHARI JOHNSON, RECORDED IN BOOK 3 OF SURVEYS, PAGE 32. A.F.N. 109330
- R2. SURVEY PERFORMED BY TANGLEWOOD SURVEYING, FOR ADRIANNE ZUCKERMAN, A.F.N. 2008170322.
- R3. SURVEY PERFORMED BY TRANTOW SURVEYING, FOR WILLIAM BENEDICT, ELEANOR MCCLAIN, CURTIS PRESLEY & FREDRICK RACZYKOWSKI, RECORDED IN BOOK 1 OF SURVEYS, PAGE 240. A.F.N. 90885.

SURVEYOR'S CERTIFICATE:

THIS MAP CORRECTLY REPRESENTS A SURVEY MADE BY ME OR UNDER MY DIRECTION IN CONFORMANCE WITH THE REQUIREMENTS OF THE SURVEY RECORDING ACT AT THE REQUEST OF THEODORE CARLSON, NOVEMBER, 2017.

Craig McConnell 11/13/17
REGISTERED PROFESSIONAL LAND SURVEYOR #51797

AUDITOR'S CERTIFICATE:

FILED FOR RECORD THIS 20th DAY OF November, 2017 AT 8:20 AM IN BOOK 1 OF SURVEYS PAGE 32, AT THE REQUEST OF CRAIG MCCONNELL, REGISTERED LAND SURVEYOR, NO. 51797. AFN #2017002431

Robert J. Waymire
COUNTY AUDITOR - Deputy

FOUND 3/4" IRON PIPE AS SET IN BOOK 1 OF SURVEYS PAGE 240, HELD FOR THE SOUTHEAST CORNER SW 1/4, SW 1/4, SW 1/4

REFERENCED DEEDS

QUIT CLAIM DEED, DOC # 2006163243
STATUTORY WARRANTY DEED, BOOK 119, PAGE 218
STATUTORY WARRANTY DEED, DOC # 2007168605

OWNER

THEODORE CARLSON

KLEIN & ASSOCIATES, MAKES NO WARRANTY AS TO MATTERS OF UNWRITTEN TITLE, ADVERSE POSSESSION, ESTOPPEL, ACQUIESCENCE.

SURVEY PERFORMED FOR: THEODORE CARLSON
DATE OF MONUMENTATION: OCTOBER 8, 2017
PROJECT: 17-10-17 DRAFT: ADS
FILE: 171017RS.DWG LAYOUT TAB: WA SURVEY

Klein & Associates, Inc.
ENGINEERING • SURVEYING • PLANNING
1411 13th Street • Hood River, OR 97031
TEL: 541-386-3322 • FAX: 541-386-2515

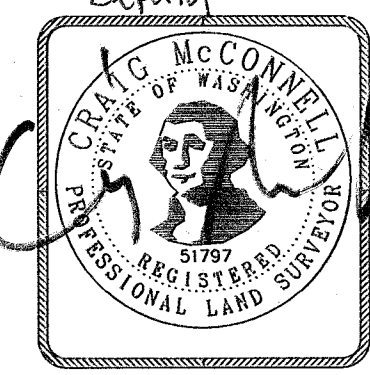

SHEET 1 OF 1
WILLAMETTE MERIDIAN
SKAMANIA COUNTY, WASHINGTON

1/4	SEC	T.	R.
11	3N.	9E.	