

SURVEY
OF THE S.E. 1/4
OF SECTION 3
T. 3 N., R. 7 E., W.M.,
SKAMANIA COUNTY
WASHINGTON

STATE OF
WASHINGTON

N 89°16'19" W 2610.75' (2610.70' St)

N: 163941.239
E: 1277955.173

N: 163974.410
E: 1275344.630

FOUND AND HELD A D.N.R. ALUMINUM
MONUMENT WITH STAMPED ALUMINUM CAP.
ALL ACCESSORIES FOUND
SEE SURVEY REFERENCE NO. 1
NO L.C.R.

FOUND AND HELD A D.N.R. ALUMINUM
MONUMENT WITH STAMPED ALUMINUM CAP.
ALL ACCESSORIES FOUND
SEE SURVEY REFERENCE NO. 1
NO L.C.R.

CARRAL INC
TAX PARCEL
03070000040000
DEED BOOK
BOOK 148, PAGE 147
SE 1/4 OF SECTION 3
T. 3 N., R. 7 E., W.M.
±156.72 ACRES

NARRATIVE:

THE PURPOSE OF THIS SURVEY WAS TO RECOVER AND SURVEY THE 4 CONTROLLING CORNERS OF THE SOUTHEAST QUARTER OF SECTION 3 AS SHOWN ON THIS SURVEY AND TO MARK AND POST THE PERIMETER OF SAID SOUTHEAST QUARTER. THE FOLLOWING PROCEDURES WERE USED TO COMPLETE THIS SURVEY.

1) ESTABLISH CONTROL AND SURVEY CONTROLLING CORNERS

FOUR SETS OF AZIMUTH POINT WERE SET NEAR EACH CONTROLLING CORNER USING STATIC GPS METHODS AND PROCESSED WITH THE NGS OPUS SOFTWARE. ONCE THE AZIMUTH WERE SET THEN SEPARATE TRAVERSES WERE RAN TO TIE EACH OF THE 4 CONTROLLING CORNERS TO ESTABLISH COORDINATE POSITIONS ON THEM. THE COORDINATES SHOWN ON THIS SURVEY ARE NAD83(2011)(EPOCH: 2010.0000) WASHINGTON STATE PLANE COORDINATE, SOUTH ZONE, US- FEET, GRID.

2) MARK AND POST LINE.

THE WEST LINE OF SAID SOUTHEAST QUARTER WAS SURVEYED IN AUGUST OF 2016. THE LINE HAD PREVIOUSLY BEEN BLAZED BY THE DEPARTMENT OF NATURAL RESOURCES WHICH HELPED WITH THE NEW MARKINGS AND POSTINGS.

THE EAST LINE OF SAID SOUTHEAST QUARTER WAS SURVEYED IN JULY OF 2017. WE WERE ABLE TO RECOVER DEPARTMENT OF NATURAL RESOURCES CARSONITE POST ALONG THE SOUTH 1300 FEET OF SAID EAST LINE AND PLACE ADDITIONAL MARKERS. ALONG THE REMAINING NORTH 1300 FEET OF SAID EAST LINE WE FOUND OLD PINK FLAGGING THAT THE DEPARTMENT OF NATURAL RESOURCES HAD PLACE OVER 30 YEARS AGO. THE NORTH 1300 FEET IS VERY STEEP AND REQUIRED THE USE OF ROPES TO LOWER GEAR OVER A CLIFF.

THE NORTH LINE WAS SURVEYED IN AUGUST OF 2017. WE FOUND OLD PINK FLAGGING THAT THE DEPARTMENT OF NATURAL RESOURCES HAD PLACED OVER 30 YEARS AGO AND THE REMAINS OF THE OLD TRAVERSE LINE. THE NORTH LINE WAS THE STEEPEST AND MOST DIFFICULT OF THE 4 LINES WE SURVEYED. THERE IS A VERY STEEP CANYON APPROXIMATELY 600 FEET WEST OF THE QUARTER CORNER THAT IS IMPASSABLE. A PERSON HAS TO WALK SOUTH ALONG THE CANYON WALL FOR APPROXIMATELY 300 FEET TO CROSS OVER AND THEN HEAD BACK NORTH TO GET BACK ONLINE.

THE SOUTH LINE WAS SURVEYED IN SEPTEMBER OF 2017 AND WAS THE LEAST DIFFICULT OF THE 4 LINES WE SURVEYED SINCE THE DEPARTMENT OF NATURAL RESOURCES HAD LOGGED ALONG THIS LINE 30 YEARS AGO, PLUS ACCESS TO THE ROAD WAS MUCH BETTER THAN THE OTHER 3 LINES.

FOUND AND HELD A D.N.R. 4"x4" CONCRETE
MONUMENT WITH STAMPED BRASS CAP
ALL ACCESSORIES FOUND
SEE SURVEY REFERENCE NO. 1
L.C.R. ON FILE WITH THE D.N.R.

N: 161375.970
E: 1275283.044

N 88°36'39" W 2612.27' (2612.38' St)

N: 161312.644
E: 1277894.551

STATE OF
WASHINGTON

200 100 0 200 300 400
SCALE 1 INCH = 200 FEET

THE DISTANCES SHOWN HEREON ARE GRID
TO OBTAIN GROUND DISTANCES,
DIVIDE THE GRID DISTANCES BY THE
COMBINED SCALE FACTOR OF 0.9998746630
(0.66' PER MILE/0.013 PER 100')

LEGEND:

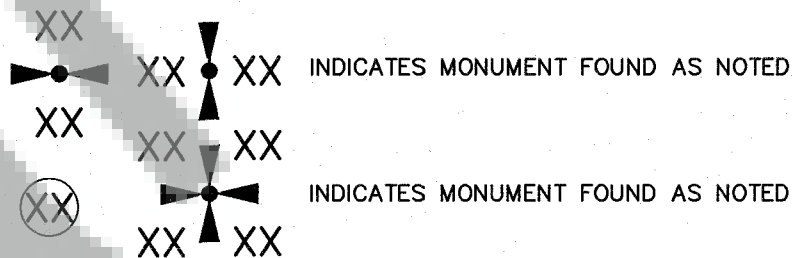

(S#) INDICATES RECORD DISTANCE PER SURVEY
REFERENCE NUMBER #

D.N.R. INDICATES DEPARTMENT OF NATURAL RESOURCES

L.C.R. INDICATES LAND CORNER RECORD

W.M. INDICATES WILLAMETTE MERIDIAN

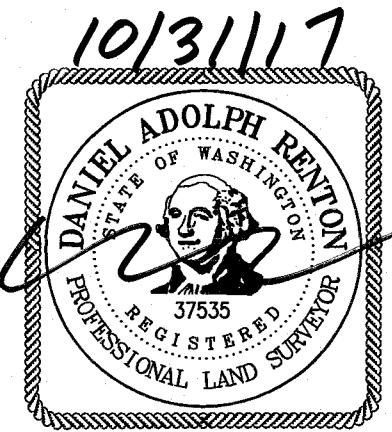

SURVEY REFERENCES:

1) H. THOMAS LAIRD JR. SURVEY, BOOK 2, PAGE 278

DEED REFERENCE:

STATUTORY WARRANTY DEED
GRANTOR: RALPH REID, JR AND CAROL REID
GRANTEE: CARRAL, INC
DEED BOOK: BOOK 148, PAGE 147
DATE: FEBRUARY 3, 1995

AUDITOR'S CERTIFICATE

FILED FOR RECORD THIS 1ST DAY OF November 2017
AT 3:45 O'CLOCK AM/PM IN BOOK 1 OF SURVEYS,
AT PAGE 1
AT THE REQUEST OF MINISTER AND GLAESER SURVEYING INC.
AFN #2017002297
Nishas Wicklaus / Robert Waymire
DEPUTY/COUNTY AUDITOR

SURVEYOR'S CERTIFICATE

THIS MAP CORRECTLY REPRESENTS A SURVEY MADE BY ME OR UNDER MY DIRECTION IN CONFORMANCE WITH THE REQUIREMENTS OF THE SURVEY RECORDING ACT AT THE REQUEST OF CARRAL INC., IN SEPTEMBER 2015.

Daniel Adolph Renton 10/31/17
DANIEL ADOLPH RENTON, PROFESSIONAL LAND SURVEYOR, LS# 37535

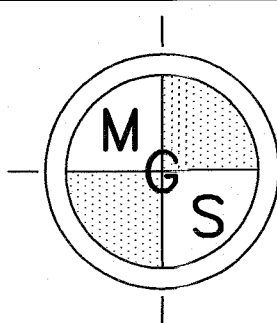

MINISTER-GLAESER
SURVEYING INC.
2200 E. EVERGREEN BLVD.
VANCOUVER, WA 98661
(360) 694-3313

SCALE: 1"=200'
JOB NO. 16-262
DATE: 10-31-17
CALC BY: DAR
DRAWN BY: DAR
CHECKED BY: DLS
SHEET 1 OF 1

BASIS OF BEARING:
NAD83(2011)(EPOCH: 2010.0000) WASHINGTON STATE
PLANE COORDINATE, SOUTH ZONE, US- FEET.
N01°21'28"E, BETWEEN THE FOUND AND HELD S 1/4 CORNER OF
SECTION 03, AS SHOWN ON THIS SURVEY
CONVERGENCE ANGLE: -01°02'21"
COMBINED SCALE FACTOR: 0.9998746630