

**WHEN RECORDED RETURN TO:**

Lynette & Gary Blackard  
417 SE 98th Ave  
Vancouver, WA 98664

**DOCUMENT TITLE(S)**

Notice of Intent to locate a (lode or) Placer mine  
in Skamania Co., WA

**REFERENCE NUMBER(S)** of Documents assigned or released:

OMRC # 44355

☒ Additional numbers on page 3 of document.

**GRANTOR(S):**

Lynette and Gary Blackard

☐ Additional names on page \_\_\_\_ of document.

**GRANTEE(S):**

Lynette & Gary Blackard

☐ Additional names on page \_\_\_\_ of document.

**LEGAL DESCRIPTION** (Abbreviated: i.e. Lot, Block, Plat or Section, Township, Range, Quarter):

T4N, R8 E, Sec. 32

☐ Complete legal on page 3 and 4 of document.

**TAX PARCEL NUMBER(S):**

T4N, R8 E Section 32 S.E., S.E., S.E.,

☐ Additional parcel numbers on page \_\_\_\_ of document.

The Auditor/Recorder will rely on the information provided on this form. The staff will not read the document to verify the accuracy or completeness of the indexing information.

Form 3830-3  
(January 2017)UNITED STATES  
DEPARTMENT OF THE INTERIOR  
BUREAU OF LAND MANAGEMENTFORM APPROVED  
OMB NO. 1004-0114  
Expires: January 31, 2020NOTICE OF INTENT TO LOCATE A LODE OR PLACER MINING CLAIM(S)  
AND/OR A TUNNEL SITE(S)  
ON LANDS PATENTED UNDER THE STOCK RAISING HOMESTEAD ACT OF 1916,  
AS AMENDED BY THE ACT OF APRIL 16, 1993

Homestead Patent Number

## TO ALL WHOM IT MAY CONCERN:

This notice is filed under Public Law No. 103-23 of April 16, 1993 (107 Stat. 60), entitled "An Act to amend the Stock Raising Homestead Act to resolve certain problems regarding subsurface estates, and for other purposes." The undersigned place(s) all interested parties on notice that, within 90 days of filing this notice with the Bureau of Land Management (BLM) and after 30 days from the date of receipt of a copy of this notice by the surface owner(s) of a record, the undersigned intend(s) to enter the lands described below to explore for a valuable mineral deposit(s) and to locate a mining claim(s), and/or tunnel site(s), as provided under the mining laws of the United States (30 U.S.C. 22, et seq.). The area covered by this notice and all other notices filed by the undersigned and any affiliate(s) of the undersigned, and which continue to be in effect on the date of this filing does not exceed 6,400 acres of such land in any one State and 1,280 acres of such land for a single entity. This notice, for a single State and surface of ownership, covers the following lands:

1/4	SECTION	TOWNSHIP	RANGE	MERIDIAN
8.E, S.E, SE	32	T4	5E	willamette

in Skamania County, State of Washington  
Total acres under this notice Copper Cr NE 1/4, 87 between Summit  
Road & Miner's Creek

Name(s), telephone number(s), and mailing address(es) of affected surface owner(s):  
Lynette Blackard Husband Gary Blackard  
217 SE 98 Ave Wife 217 SE 98 Ave  
Vancouver WA 98664 Vancouver WA

Name(s), telephone number(s), and mailing address(es) of person(s) filing this notice:  
Lynette Blackard Husband Gary Blackard  
217 SE 98 Ave Wife 217 SE 98 Ave  
Vancouver WA 98664 Vancouver WA

Brief description of the proposed casual use exploration activities (i.e., activities that cause no more than a minimal disturbance to the surface resources and do not involve the use of mechanized earth-moving equipment, explosives, the construction of access roads, drill pads, or the use of toxic or hazardous materials):

Placer mine within Washington Mining District of  
The Gifford Pinchot National Forest on Copper  
from Summit Creek to Miner's Creek  
TN 4, R5E, Sec. 32, OMRC# 47355

Year found for panning activities  
Date(s) on which such activities will take place: On a seasonal use as  
defined for this locality Aug 1 to Feb 28th  
yearly

(Continued on page 2)

Attached is a map showing the existing access routes proposed to be used for casual use exploration purposes, primary areas of interest, and types of activities to be conducted.

The above described activities will be managed by:

Name

Mailing Address

Phone Number (include area code)

Dated this

day of

20

Signature of:

(Person)

(Affiliate)

18 U.S.C. 1001 and 43 U.S.C. 1212 make it a crime for any person knowingly and willfully to make to any department or agency of the United States any false, fictitious or fraudulent statements or representations as to any matter within its jurisdiction.

RECORDER'S STAMP

#### NOTICES

The Privacy Act and 43 CFR 2.223(d) require that you be furnished with the following information in connection with the information requested by this form.

AUTHORITY: 43 U.S.C. 299(b) and 43 CFR subpart 3814 and part 3838 permit collection of the information requested by this form.

PRINCIPAL PURPOSE: The BLM will use the information you provide to verify that you have complied with the pre-location requirements at 43 U.S.C. 299(b) and 43 CFR subpart 3814 and part 3838, and are therefore qualified to locate and record mining claims on land patented under the Stock Raising Homestead Act.

ROUTINE USES: The BLM will only disclose this information in accordance with the provisions at 43 CFR 2.231(b) and (c).

EFFECT OF NOT PROVIDING INFORMATION: Disclosure of the requested information is required by 43 U.S.C. 299(b) and 43 CFR subpart 3814 and part 3838 for mining claimants who desire to locate a mining claim or tunnel site on land previously patented under the Stock Raising Homestead Act. Failure to comply and submit all the requested information or to complete this form will delay the BLM's processing of the form or may preclude the BLM's acceptance of your notice of intent to locate (NOITL) a mining claim or site on lands patented under the Stock Raising Homestead Act. Failure to comply with the requirements of 43 U.S.C. 299(b) and 43 CFR subpart 3814 and part 3838 will void your NOITL. Mining claims or sites located under a void NOITL are null and void from the beginning and will be cancelled by the BLM.

The Paperwork Reduction Act requires us to tell you that:

The BLM collects this information to determine whether or not you are qualified to locate a lode or placer mining claim and/or tunnel site on lands patented under the Stock Raising Homestead Act.

Submission of the requested information is necessary to obtain or retain a benefit.

You do not have to respond to this or any other Federal agency-sponsored information collection unless it displays a currently valid OMB control number.

BURDEN HOURS STATEMENT: Public reporting burden for this form is estimated to average 25 minutes per response, including the time for reviewing instructions, gathering and maintaining data, and completing and reviewing the form. You may submit comments regarding the burden estimate or any other aspect of this form to: U.S. Department of the Interior, Bureau of Land Management (1004-0114), Bureau Information Collection Clearance Officer (WO-630), 1849 C St., N.W., Mail Stop 401 LS, Washington, D.C. 20240.

Sunset Falls campground  
NF 211 to 4109 into NF 4107  
restricted road use ending in  
termination of NF 4107 previously  
name the "Star Case Trail Head" 2

Willamette Moudian

45, 7854N, -122.2125380

GRMC 47355  
County record ref.

Skamania Co. WA

-93295; N; 931-2\*

from Sunset falls

Campground follow  
NF 4109 to 4107 and then  
to NF 4107 (termination)

Signature of Claimant

Gyneth Blackard

date 8/16/201

MAP of Mining Claim(s)

Township

N4

Range

5E

Section

32

State of

Washington

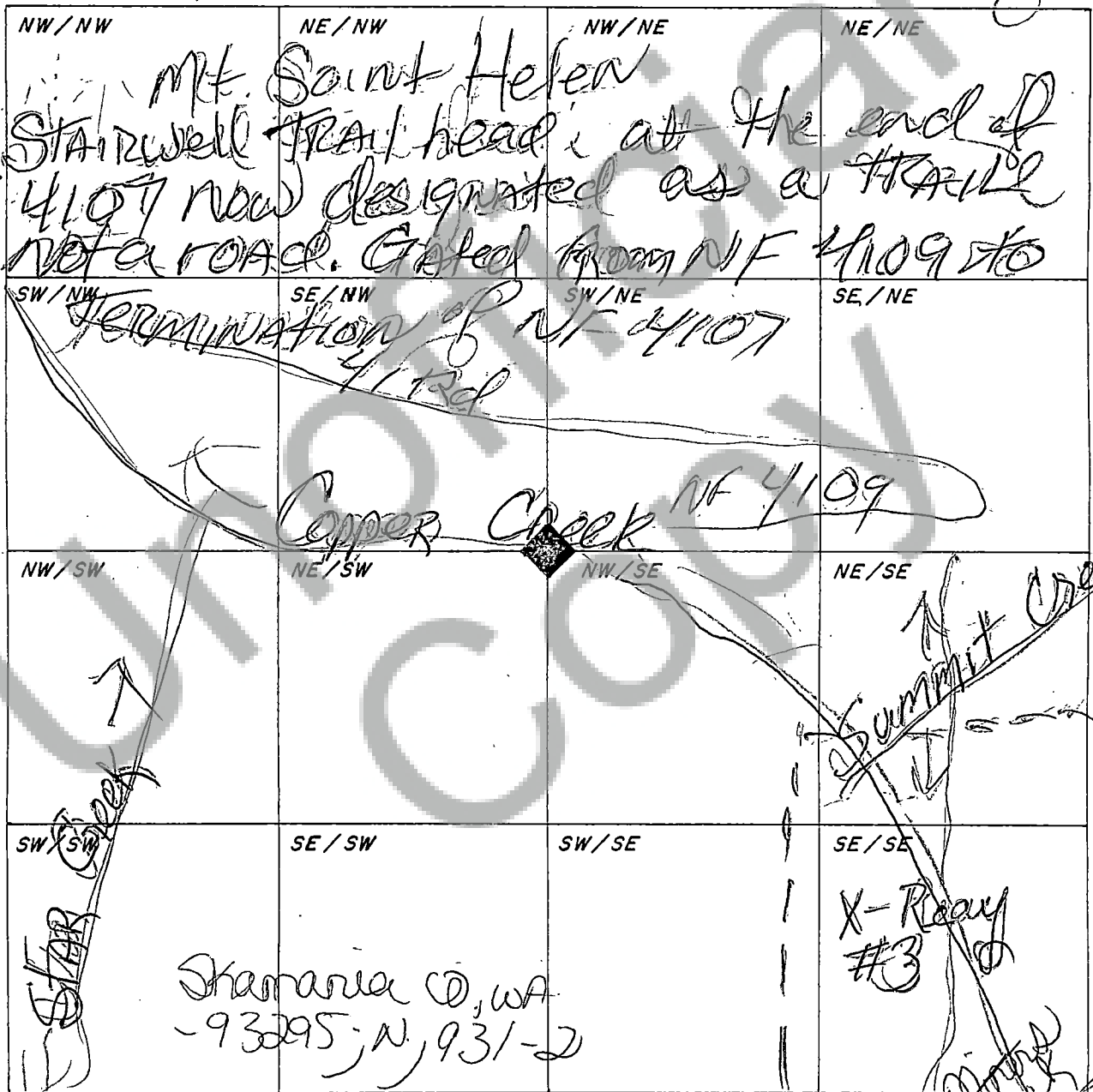

When drawing your claim(s) use an ordinary ruler. 1/8th of an inch would be 100 feet so a full size lode (600' x 1500') would be 3/4" by 1 7/8". A full size placer (1320' x 660') would be 1 5/8" by 13/16".

MINERS  
Creek