

After recording, return to:

Bradley W. Andersen
Landerholm P.S.
P.O. Box 1086
Vancouver, WA 98666

SKAMANIA COUNTY
REAL ESTATE EXCISE TAX
32736
AUG 15 2017

Tax Lot 02062320011900, 02062320010500
Section 23, T 2N, R6E
PAID 119.75
SKAMANIA COUNTY TREASURER
Space Above for Recording Information Only

BOUNDARY LINE ADJUSTMENT DEED

PARTIES:

Sandy C. Jordan, also known as Sandra Hardy, an individual, hereinafter referenced as "Jordan";

Douglas M. Haight, an individual, hereinafter referenced as "Haight".

RECITALS:

A. Haight is the owner of a certain parcel of real property located in Skamania County, Washington, Assessor's Tax Parcel No. 02062320011900 (the "Haight Property").

B. Jordan is the owner of a certain parcel of real property located in Skamania County, Washington: Assessor's Tax Parcel No. 02062320010500 (the "Jordan Property").

C. The Jordan Property shares a common boundary with the Haight Property.

D. Pursuant to a settlement agreement to resolve a boundary line dispute and to secure quiet title, the parties desire to adjust their common boundary line and accordingly enter into this Agreement.

E. It is the intention of the parties that these Recitals be and are a part of this Agreement.

F. The parties do not intend for this Deed to create any additional parcels and are only entering into this agreement to resolve a quiet title and boundary line dispute.

///

Planning Department - BLA Approved By: [Signature]

8/15/17

BOUNDARY LINE AGREEMENT - 1
1986651.doc

 **LANDERHOLM**
805 Broadway Street, Suite 1000
PO Box 1086
Vancouver, WA 98666
T: 360-696-3312 • F: 360-696-2122

AGREEMENT:

1. Haight, an individual, hereby conveys and quitclaims to Jordan the real property described in the attached **Exhibit A** and depicted in the attached **Exhibit B**.

2. The new legal description of the Haight Property, after the conveyance set forth in Paragraph 1 above, is contained and set out in the attached **Exhibit C**.

3. The new legal description of the Jordan Property, after the conveyance set forth in Paragraph 1 above, is contained and set out in the attached **Exhibit D**.

6/7/2017
Date

Sandy C. Jordan
Sandy C. Jordan

5-25-17
Date

Douglas M. Haight
Douglas M. Haight

NARRATIVE IN SUPPORT OF EXEMPTION TO PAYMENT OF REAL ESTATE EXCISE TAXES

The parties herein are requesting a partial Exemption on a transfer of real property interest for the sole purpose of resolving an adverse possession/boundary line dispute for nominal consideration under WAC 458-61A-109 wherein full payment of real estate excise taxes are usually required to record the attached Boundary Line Adjustment Deed.

Douglas M. Haight is the owner of a certain parcel of real property located in Skamania County, Washington, Assessor's Tax Parcel No. 02062320011900 (the "Haight Property"). Sandy C. Jordan, also known as Sandra Hardy, is the owner of a certain parcel of real property located in Skamania County, Washington, Assessor's Tax Parcel No. 02062320010500 (the "Jordan Property"). The Jordan Property shares a common boundary with the Haight Property. Pursuant to a Settlement Agreement to resolve a boundary line dispute and to secure quiet title, the parties desire to adjust their common boundary line. The parties do not intend to create any additional parcels and are only entering into the Settlement Agreement to resolve a quiet title and boundary line dispute. Haight, an individual, hereby conveys and quitclaims to Jordan the real property described in the attached **Exhibit A**, and depicted in the attached **Exhibit B**, (the "Disputed Property"). The new legal description of the Haight Property, after the conveyance, is contained and set out in the attached **Exhibit C**. The new legal description of the Jordan Property, after the conveyance, is contained and set out in the attached **Exhibit D**.

The parties wish to resolve the ownership issue by Haight conveying the Disputed Property to Jordan. WAC 458-61A-109 provides that the real estate excise tax does not apply to boundary line adjustments made solely to settle a boundary line dispute if no consideration passes otherwise. Pursuant to the terms of the Settlement Agreement, and in consideration of his cooperation in quieting title to the Disputed Property, Haight, the Grantor herein, was paid \$7,500.00, the amount on which the real estate taxes must be paid.

Signature of Grantor or Grantor's Agent:

Douglas M. Haight

Name (print):

DOUGLAS M. HAIGAT

Date & City of signing:

5-25-17

Signature of Grantee or Grantee's Agent:

Bradley Anderson

Name (print):

Bradley Anderson

Date & City of signing:

6/6/17 Vancouver, Washington



Minister & Glaeser Surveying, Inc.

Phone: 360-694-3313 Fax: 360-694-8410

05/02/17

May 1, 2017

EXHIBIT "A"

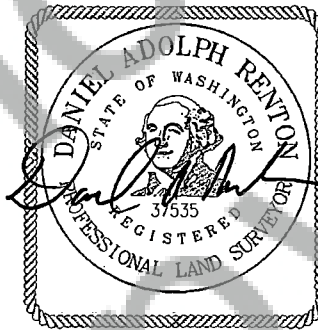

PARCEL TO ACQUIRE FROM HAIGHT

A portion of the West half of the Northwest quarter of Section 23, Township 2 North, Range 6 East, Willamette Meridian, Skamania County Washington, described as follows:

Commencing at a 1/2" iron rod marking the West Quarter corner of said Section 23, as shown on the Plat of "Columbia River Estates" as recorded in Book. "J", page 364 (J-364), miscellaneous records of Skamania County;

Thence North 00°35'28" East, along the West line of the Northwest quarter of Section 23, for a distance of 1595.43 feet;

Thence South 89°24'32" East, at right angles to said West line, for a distance of 659.33 feet to the Northwest corner of Parcel 10 (J-364) and the centerline of road "A" as shown in said Plat (J-364);

Thence Southerly following said centerline along the Westerly line of said Parcel 10, South 33°09'33" East, for a distance of 13.04 feet;

Thence along the arc of a 180.60-foot radius curve to the left, through a central angle of 18°51'47", for an arc distance of 59.46 feet;

Thence South 52°01'20" East, for a distance of 78.23 feet;

Thence along the arc of a 202.11 radius curve to the right, through a central angle of 14°06'10", for an arc distance of 49.75 feet;

Thence South 37°55'10" East, for a distance of 315.99 feet;

Thence along the arc of a 50.37-foot radius curve to the right, through a central angle of 24°57'24", for an arc distance of 21.94 feet to the Northwest corner of the "Hardy Parcel" as recorded in Deed Book 228, Page 33 Skamania County Auditor's Records;

Thence continuing along said 50.37-foot radius curve to the right, through a central angle of 101°36'57", for an arc distance of 89.33 feet to a point of reverse curvature;

Thence along the arc of a 112.85-foot radius curve to the left, through a central angle of 121°08'04", for an arc distance of 238.59 feet;

Thence South 32°28'53" East, for a distance of 146.78 feet to the Southwest corner of said "Hardy Parcel";

Thence leaving said centerline South 88°54'41" East, along the South line of said "Hardy Parcel", for a distance of 96.87 feet to the **TRUE POINT OF BEGINNING**;

Thence leaving said South line, South 35°38'15" East, for a distance of 153.74 feet;

Thence South 88°54'41" East, for a distance of 160 feet, more or less, to the East line of said West half of the Northwest quarter of Section 23;

Thence North along said East line, for a distance of 123 feet, more or less, to a point which bears South 88°54'41" East from the **TRUE POINT OF BEGINNING**;

Thence North 88°54'41" West, for a distance of 251 feet, more or less, to the **TRUE POINT OF BEGINNING**.

Contains 25,336 square feet of land, more or less.

Planning Department - BIA Approved By: 8/15/17
@

Skamania County Assessor
Date 8-15-17 Parcel# 02062320011900
02062320010500
ym

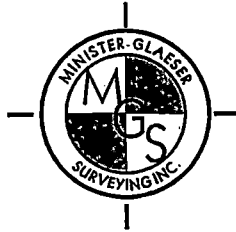

Minister & Glaeser Surveying, Inc.
Phone: 360-694-3313 Fax: 360-694-8410

05/02/17

May 1, 2017

EXHIBIT "A"

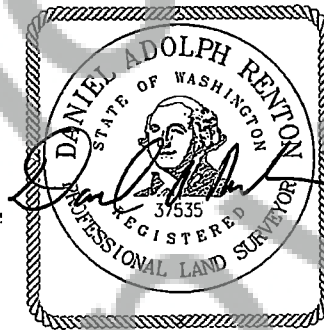

PARCEL TO ACQUIRE FROM HAIGHT

A portion of the West half of the Northwest quarter of Section 23, Township 2 North, Range 6 East, Willamette Meridian, Skamania County Washington, described as follows:

Commencing at a 1/2" iron rod marking the West Quarter corner of said Section 23, as shown on the Plat of "Columbia River Estates" as recorded in Book. "J", page 364 (J-364), miscellaneous records of Skamania County;

Thence North 00°35'28" East, along the West line of the Northwest quarter of Section 23, for a distance of 1595.43 feet;

Thence South 89°24'32" East, at right angles to said West line, for a distance of 659.33 feet to the Northwest corner of Parcel 10 (J-364) and the centerline of road "A" as shown in said Plat (J-364);

Thence Southerly following said centerline along the Westerly line of said Parcel 10, South 33°09'33" East, for a distance of 13.04 feet;

Thence along the arc of a 180.60-foot radius curve to the left, through a central angle of 18°51'47", for an arc distance of 59.46 feet;

Thence South $52^{\circ}01'20''$ East, for a distance of 78.23 feet;

Thence along the arc of a 202.11 radius curve to the right, through a central angle of $14^{\circ}06'10''$, for an arc distance of 49.75 feet;

Thence South $37^{\circ}55'10''$ East, for a distance of 315.99 feet;

Thence along the arc of a 50.37-foot radius curve to the right, through a central angle of $24^{\circ}57'24''$, for an arc distance of 21.94 feet to the Northwest corner of the "Hardy Parcel" as recorded in Deed Book 228, Page 33 Skamania County Auditor's Records;

Thence continuing along said 50.37-foot radius curve to the right, through a central angle of $101^{\circ}36'57''$, for an arc distance of 89.33 feet to a point of reverse curvature;

Thence along the arc of a 112.85-foot radius curve to the left, through a central angle of $121^{\circ}08'04''$, for an arc distance of 238.59 feet;

Thence South $32^{\circ}28'53''$ East, for a distance of 146.78 feet to the Southwest corner of said "Hardy Parcel";

Thence leaving said centerline South $88^{\circ}54'41''$ East, along the South line of said "Hardy Parcel", for a distance of 96.87 feet to the **TRUE POINT OF BEGINNING**;

Thence leaving said South line, South $35^{\circ}38'15''$ East, for a distance of 153.74 feet;



Thence South $88^{\circ}54'41''$ East, for a distance of 160 feet, more or less, to the East line of said West half of the Northwest quarter of Section 23;

Thence North along said East line, for a distance of 123 feet, more or less, to a point which bears South $88^{\circ}54'41''$ East from the **TRUE POINT OF BEGINNING**;

Thence North $88^{\circ}54'41''$ West, for a distance of 251 feet, more or less, to the **TRUE POINT OF BEGINNING**.

Contains 25,336 square feet of land, more or less.

SHEET 1 OF 2

	INDICATES RIGHT OF WAY CENTERLINE
C#	INDICATES CURVE TABLE LABEL
L#	INDICATES LINE TABLE LABEL
+/-	INDICATES MORE OR LESS
	INDICATES BOUNDARY

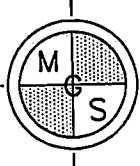
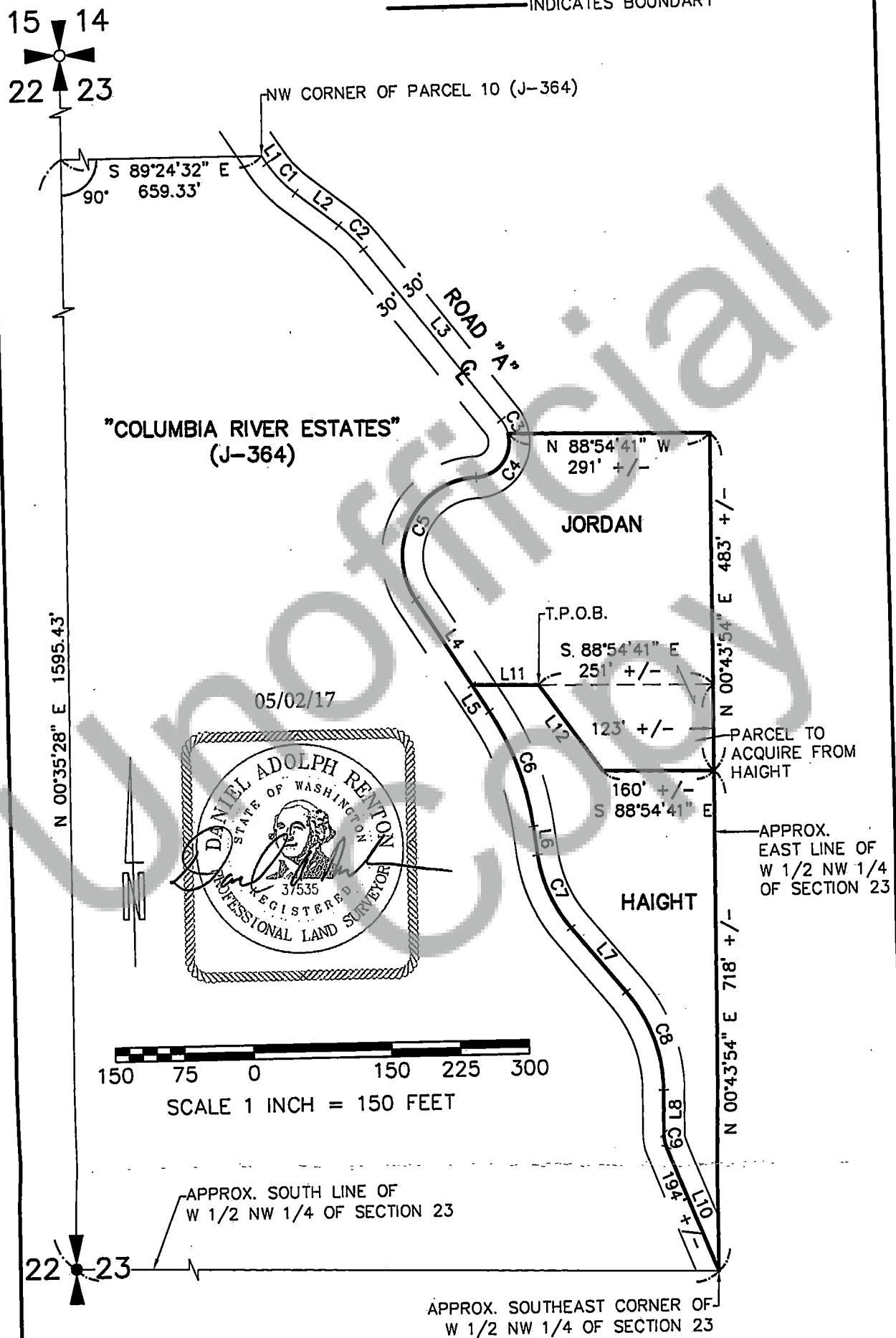

PREPARED BY:
MINISTER-GLAESER
SURVEYING INC.
2200 E. EVERGREEN BLVD.
VANCOUVER, WA 98661
(360) 694-3313

EXHIBIT "B"
TO ACCOMPANY
LEGAL DESCRIPTIONS

SCALE: 1"=200'
JOB NO. 16-295
DATE: 5-1-2017
DWG FILE: 16295EX
DRAWN BY: PWR

SHEET 2 OF 2

05/02/17

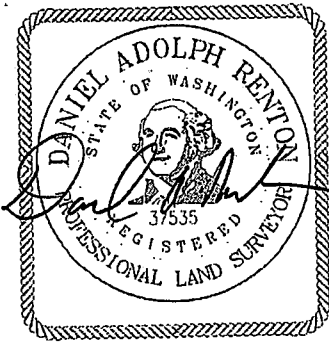

LINE TABLE		
LINE	BEARING	DISTANCE
L1	S 33°09'33" E	13.04'
L2	S 52°01'20" E	78.23'
L3	S 37°55'10" E	315.99'
L4	S 32°28'53" E	146.78'
L5	S 32°28'53" E	45.64'
L6	S 07°12'34" E	41.51'
L7	S 39°38'45" E	121.56'
L8	S 00°33'41" W	62.98'
L10	S 21°35'52" E	193.72'
L11	S 88°54'41" E	96.87'
L12	S 35°38'15" E	153.74'

CURVE TABLE			
CURVE	RADIUS	DELTA	ARC DIST.
C1	180.60'	18°51'47"	59.46'
C2	202.11'	14°06'10"	49.75'
C3	50.37'	24°57'24"	21.94'
C4	50.37'	101°36'57"	89.33'
C5	112.85'	121°08'04"	238.59'
C6	401.45'	25°16'19"	177.07'
C7	206.28'	32°26'11"	116.78'
C8	218.57'	40°12'26"	153.38'
C9	50.00'	22°26'08"	19.58'

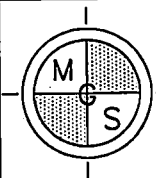

PREPARED BY:
MINISTER-GLAESER
SURVEYING INC.
2200 E. EVERGREEN BLVD.
VANCOUVER, WA 98661
(360) 694-3313

EXHIBIT "B"
LINE AND CURVE
TABLE

SCALE: 1"=200'
JOB NO. 16-295
DATE: 5-1-2017
DWG FILE: 16295EX
DRAWN BY: PWR

SHEET 2 OF 2

05/02/17

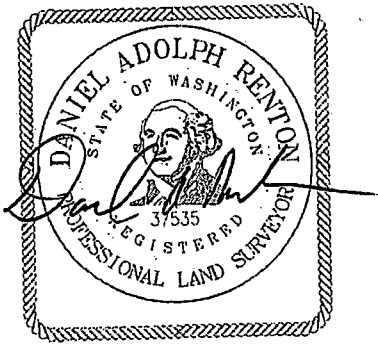

LINE TABLE		
LINE	BEARING	DISTANCE
L1	S 33°09'33" E	13.04'
L2	S 52°01'20" E	78.23'
L3	S 37°55'10" E	315.99'
L4	S 32°28'53" E	146.78'
L5	S 32°28'53" E	45.64'
L6	S 07°12'34" E	41.51'
L7	S 39°38'45" E	121.56'
L8	S 00°33'41" W	62.98'
L10	S 21°35'52" E	193.72'
L11	S 88°54'41" E	96.87'
L12	S 35°38'15" E	153.74'

CURVE TABLE			
CURVE	RADIUS	DELTA	ARC DIST.
C1	180.60'	18°51'47"	59.46'
C2	202.11'	14°06'10"	49.75'
C3	50.37'	24°57'24"	21.94'
C4	50.37'	101°36'57"	89.33'
C5	112.85'	121°08'04"	238.59'
C6	401.45'	25°16'19"	177.07'
C7	206.28'	32°26'11"	116.78'
C8	218.57'	40°12'26"	153.38'
C9	50.00'	22°26'08"	19.58'

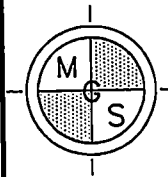

PREPARED BY:
MINISTER-GLAESER
SURVEYING INC.
2200 E. EVERGREEN BLVD.
VANCOUVER, WA 98661
(360) 694-3313

EXHIBIT "B"
LINE AND CURVE
TABLE

SCALE: 1"=200'
JOB NO. 16-295
DATE: 5-1-2017
DWG FILE: 16295EX
DRAWN BY: PWR

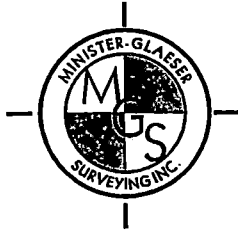

Minister & Glaeser Surveying, Inc.
Phone: 360-694-3313 • Fax: 360-694-8410

05/02/17

May 1, 2017

EXHIBIT "C"

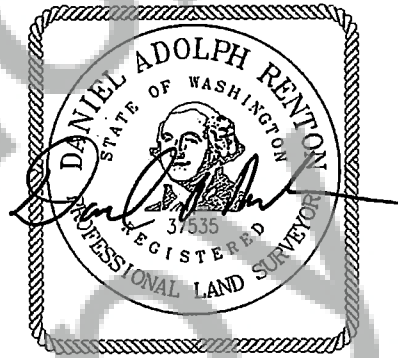

HAIGHT PARCEL AFTER ADJUSTMENT

A portion of the West half of the Northwest quarter of Section 23, Township 2 North, Range 6 East, Willamette Meridian, Skamania County Washington, described as follows:

Commencing at a 1/2" iron rod marking the West Quarter corner of said Section 23, as shown on the Plat of "Columbia River Estates" as recorded in Book. "J", page 364 (J-364), miscellaneous records of Skamania County;

Thence North 00°35'28" East, along the West line of the Northwest quarter of Section 23, for a distance of 1595.43 feet;

Thence South 89°24'32" East, at right angles to said West line, for a distance of 659.33 feet to the Northwest corner of Parcel 10 (J-364) and the centerline of road "A" as shown in said Plat (J-364);

Thence Southerly following said centerline along the Westerly line of said Parcel 10, South 33°09'33" East, for a distance of 13.04 feet;

Thence along the arc of a 180.60-foot radius curve to the left, through a central angle of 18°51'47", for an arc distance of 59.46 feet;

Thence South $52^{\circ}01'20''$ East, for a distance of 78.23 feet;

Thence along the arc of a 202.11 radius curve to the right, through a central angle of $14^{\circ}06'10''$, for an arc distance of 49.75 feet;

Thence South $37^{\circ}55'10''$ East, for a distance of 315.99 feet;

Thence along the arc of a 50.37-foot radius curve to the right, through a central angle of $24^{\circ}57'24''$, for an arc distance of 21.94 feet to the Northwest corner of the "Hardy Parcel" as recorded in Deed Book 228, Page 33 Skamania County Auditor's Records;

Thence continuing along said 50.37-foot radius curve to the right, through a central angle of $101^{\circ}36'57''$, for an arc distance of 89.33 feet to a point of reverse curvature;

Thence along the arc of a 112.85-foot radius curve to the left, through a central angle of $121^{\circ}08'04''$, for an arc distance of 238.59 feet;

Thence South $32^{\circ}28'53''$ East, for a distance of 146.78 feet to the Southwest corner of said "Hardy Parcel";

Thence leaving said centerline South $88^{\circ}54'41''$ East, along the South line of said "Hardy Parcel", for a distance of 96.87 feet;

Thence leaving said South line, South $35^{\circ}38'15''$ East, for a distance of 153.74 feet to the **TRUE POINT OF BEGINNING**;

Thence North $35^{\circ}38'15''$ West, for a distance of 153.74 feet;

Thence North $88^{\circ}54'41''$ West, for a distance of 96.87 feet to the Southwest corner of said "Hardy Parcel" and said centerline of Road "A";

Thence Southerly along said centerline South $32^{\circ}28'53''$ East, for a distance of 45.64 feet;

Thence along the arc of a 401.45-foot radius curve to the right, through a central angle of $25^{\circ}16'19''$, for an arc distance of 177.07 feet;

Thence South $07^{\circ}12'34''$ East, for a distance of 41.51 feet;

Thence along the arc of a 206.28-foot radius curve to the left, through a central angle of $32^{\circ}26'11''$, for an arc distance of 116.78 feet;

Thence South $39^{\circ}38'45''$ East, for a distance of 121.56 feet;

Thence along the arc of a 218.57-foot radius curve to the right, through a central angle of $40^{\circ}12'26''$, for an arc distance of 153.38 feet;

Thence South $00^{\circ}33'41''$ West, for a distance of 62.98 feet;

Thence along the arc of a 50.00-foot radius curve to the left, through a central angle of $22^{\circ}26'08''$, for an arc distance of 19.58 feet to the intersection of roads "A", "B", and "C" as shown on said Plat (J-364);

Thence South $21^{\circ}35'52''$ East, for a distance of 194 feet, more or less, to the Southeast corner of said West half of the Northwest quarter of Section 23;

Thence North along the East line of said West half, for a distance of 718 feet, more or less, to a point which bears South $88^{\circ}54'41''$ East from the **TRUE POINT OF BEGINNING**;

Thence North $88^{\circ}54'41''$ West, for a distance of 160 feet, more or less, to the **TRUE POINT OF BEGINNING**.



Minister & Glaeser Surveying, Inc.
Phone: 360-694-3313 • Fax: 360-694-8410

05/02/17

May 1, 2017

EXHIBIT "D"

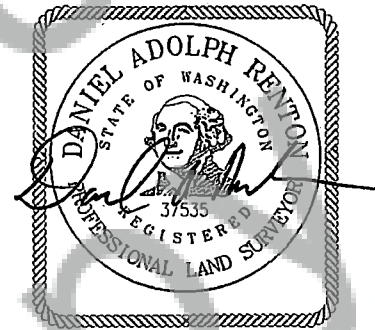

JORDAN PARCEL AFTER ADJUSTMENT

A portion of the West half of the Northwest quarter of Section 23, Township 2 North, Range 6 East, Willamette Meridian, Skamania County Washington, described as follows:

Commencing at a 1/2" iron rod marking the West Quarter corner of said Section 23, as shown on the Plat of "Columbia River Estates" as recorded in Book. "J", page 364 (J-364), miscellaneous records of Skamania County;

Thence North 00°35'28" East, along the West line of the Northwest quarter of Section 23, for a distance of 1595.43 feet;

Thence South 89°24'32" East, at right angles to said West line, for a distance of 659.33 feet to the Northwest corner of Parcel 10 (J-364) and the centerline of road "A" as shown in said Plat (J-364);

Thence Southerly following said centerline along the Westerly line of said Parcel 10, South 33°09'33" East, for a distance of 13.04 feet;

Thence along the arc of a 180.60-foot radius curve to the left, through a central angle of 18°51'47", for an arc distance of 59.46 feet;

Thence South $52^{\circ}01'20''$ East, for a distance of 78.23 feet;

Thence along the arc of a 202.11 radius curve to the right, through a central angle of $14^{\circ}06'10''$, for an arc distance of 49.75 feet;

Thence South $37^{\circ}55'10''$ East, for a distance of 315.99 feet;

Thence along the arc of a 50.37-foot radius curve to the right, through a central angle of $24^{\circ}57'24''$, for an arc distance of 21.94 feet to the Northwest corner of the "Hardy Parcel" as recorded in Deed Book 228, Page 33 Skamania County Auditor's Records and the **TRUE POINT OF BEGINNING**;

Thence continuing along said 50.37-foot radius curve to the right, through a central angle of $101^{\circ}36'57''$, for an arc distance of 89.33 feet to a point of reverse curvature;

Thence along the arc of a 112.85-foot radius curve to the left, through a central angle of $121^{\circ}08'04''$, for an arc distance of 238.59 feet;

Thence South $32^{\circ}28'53''$ East, for a distance of 146.78 feet to the Southwest corner of said "Hardy Parcel";

Thence leaving said centerline South $88^{\circ}54'41''$ East, along the South line of said "Hardy Parcel", for a distance of 96.87 feet;



Thence leaving said South line, South $35^{\circ}38'15''$ East, for a distance of 153.74 feet;

Thence South $88^{\circ}54'41''$ East, for a distance of 160 feet, more or less, to the East line of said West half of the Northwest quarter of Section 23;

Thence North along said East line, for a distance of 483 feet, more or less, to a point which bears South $88^{\circ}54'41''$ East from the **TRUE POINT OF BEGINNING**;

Thence North $88^{\circ}54'41''$ West, for a distance of 291 feet, more or less, to the **TRUE POINT OF BEGINNING**.

SHEET 1 OF 2

-  INDICATES RIGHT OF WAY CENTERLINE
- C# INDICATES CURVE TABLE LABEL
- L# INDICATES LINE TABLE LABEL
- +/- INDICATES MORE OR LESS
-  INDICATES BOUNDARY

15 14
22 23

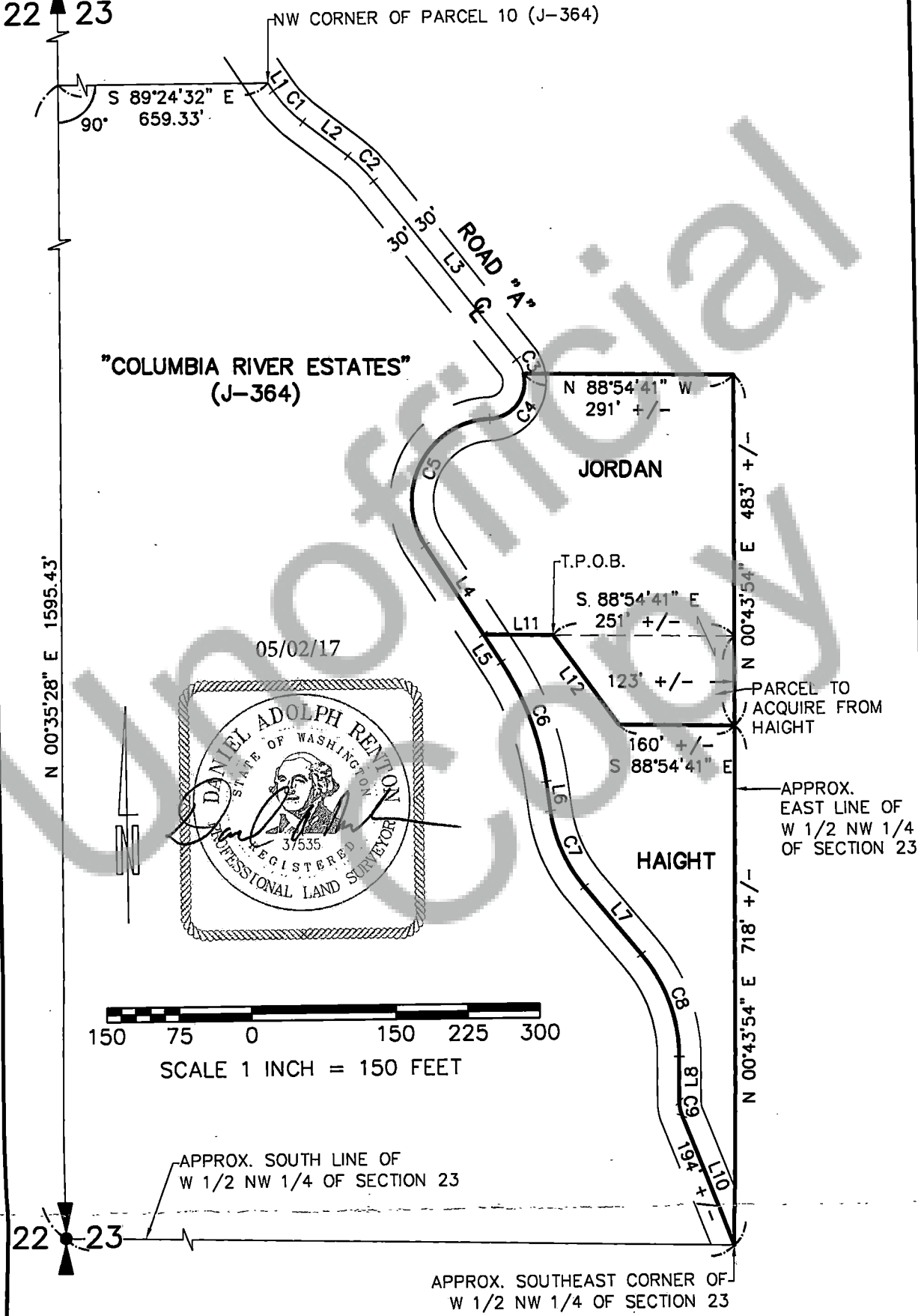

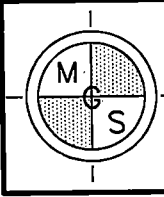

PREPARED BY:
MINISTER-GLAESER
SURVEYING INC.
2200 E. EVERGREEN BLVD.
VANCOUVER, WA 98661
(360) 694-3313

EXHIBIT "B"
TO ACCOMPANY
LEGAL DESCRIPTIONS

SCALE:	1"=200'
JOB NO.	16-295
DATE:	5-1-2017
DWG FILE:	16295EX
DRAWN BY:	PWR

SHEET 2 OF 2

05/02/17

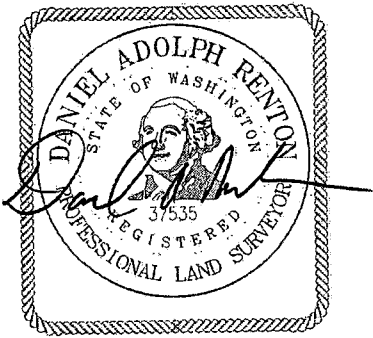

LINE TABLE		
LINE	BEARING	DISTANCE
L1	S 33°09'33" E	13.04'
L2	S 52°01'20" E	78.23'
L3	S 37°55'10" E	315.99'
L4	S 32°28'53" E	146.78'
L5	S 32°28'53" E	45.64'
L6	S 07°12'34" E	41.51'
L7	S 39°38'45" E	121.56'
L8	S 00°33'41" W	62.98'
L10	S 21°35'52" E	193.72'
L11	S 88°54'41" E	96.87'
L12	S 35°38'15" E	153.74'

CURVE TABLE			
CURVE	RADIUS	DELTA	ARC DIST.
C1	180.60'	18°51'47"	59.46'
C2	202.11'	14°06'10"	49.75'
C3	50.37'	24°57'24"	21.94'
C4	50.37'	101°36'57"	89.33'
C5	112.85'	121°08'04"	238.59'
C6	401.45'	25°16'19"	177.07'
C7	206.28'	32°26'11"	116.78'
C8	218.57'	40°12'26"	153.38'
C9	50.00'	22°26'08"	19.58'

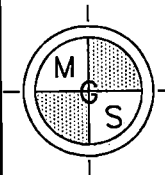

PREPARED BY:
MINISTER-GLAESER
SURVEYING INC.
2200 E. EVERGREEN BLVD.
VANCOUVER, WA 98661
(360) 694-3313

EXHIBIT "B"
LINE AND CURVE
TABLE

SCALE: 1"=200'
JOB NO. 16-295
DATE: 5-1-2017
DWG FILE: 16295EX
DRAWN BY: PWR

SHEET 2 OF 2

05/02/17

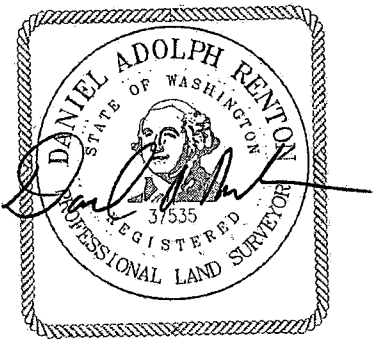

LINE TABLE		
LINE	BEARING	DISTANCE
L1	S 33°09'33" E	13.04'
L2	S 52°01'20" E	78.23'
L3	S 37°55'10" E	315.99'
L4	S 32°28'53" E	146.78'
L5	S 32°28'53" E	45.64'
L6	S 07°12'34" E	41.51'
L7	S 39°38'45" E	121.56'
L8	S 00°33'41" W	62.98'
L10	S 21°35'52" E	193.72'
L11	S 88°54'41" E	96.87'
L12	S 35°38'15" E	153.74'

CURVE TABLE			
CURVE	RADIUS	DELTA	ARC DIST.
C1	180.60'	18°51'47"	59.46'
C2	202.11'	14°06'10"	49.75'
C3	50.37'	24°57'24"	21.94'
C4	50.37'	101°36'57"	89.33'
C5	112.85'	121°08'04"	238.59'
C6	401.45'	25°16'19"	177.07'
C7	206.28'	32°26'11"	116.78'
C8	218.57'	40°12'26"	153.38'
C9	50.00'	22°26'08"	19.58'

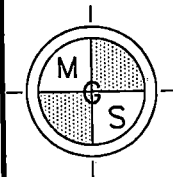

PREPARED BY:
MINISTER-GLAESER
SURVEYING INC.
2200 E. EVERGREEN BLVD.
VANCOUVER, WA 98661
(360) 694-3313

EXHIBIT "B"
LINE AND CURVE
TABLE

SCALE: 1"=200'
JOB NO. 16-295
DATE: 5-1-2017
DWG FILE: 16295EX
DRAWN BY: PWR



Minister & Glaeser Surveying, Inc.
Phone: 360-694-3313 Fax: 360-694-8410

05/02/17

May 1, 2017

EXHIBIT "C"

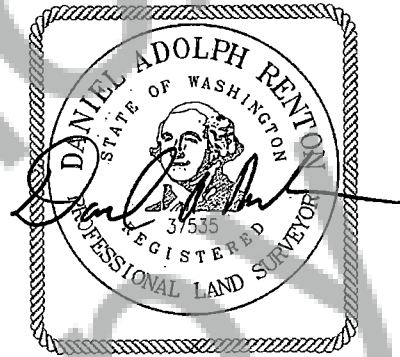

HAIGHT PARCEL AFTER ADJUSTMENT

A portion of the West half of the Northwest quarter of Section 23, Township 2 North, Range 6 East, Willamette Meridian, Skamania County Washington, described as follows:

Commencing at a 1/2" iron rod marking the West Quarter corner of said Section 23, as shown on the Plat of "Columbia River Estates" as recorded in Book. "J", page 364 (J-364), miscellaneous records of Skamania County;

Thence North $00^{\circ}35'28''$ East, along the West line of the Northwest quarter of Section 23, for a distance of 1595.43 feet;

Thence South $89^{\circ}24'32''$ East, at right angles to said West line, for a distance of 659.33 feet to the Northwest corner of Parcel 10 (J-364) and the centerline of road "A" as shown in said Plat (J-364);

Thence Southerly following said centerline along the Westerly line of said Parcel 10, South $33^{\circ}09'33''$ East, for a distance of 13.04 feet;

Thence along the arc of a 180.60-foot radius curve to the left, through a central angle of $18^{\circ}51'47''$, for an arc distance of 59.46 feet;

Thence South $52^{\circ}01'20''$ East, for a distance of 78.23 feet;

Thence along the arc of a 202.11 radius curve to the right, through a central angle of $14^{\circ}06'10''$, for an arc distance of 49.75 feet;

Thence South $37^{\circ}55'10''$ East, for a distance of 315.99 feet;

Thence along the arc of a 50.37-foot radius curve to the right, through a central angle of $24^{\circ}57'24''$, for an arc distance of 21.94 feet to the Northwest corner of the "Hardy Parcel" as recorded in Deed Book 228, Page 33 Skamania County Auditor's Records;

Thence continuing along said 50.37-foot radius curve to the right, through a central angle of $101^{\circ}36'57''$, for an arc distance of 89.33 feet to a point of reverse curvature;

Thence along the arc of a 112.85-foot radius curve to the left, through a central angle of $121^{\circ}08'04''$, for an arc distance of 238.59 feet;

Thence South $32^{\circ}28'53''$ East, for a distance of 146.78 feet to the Southwest corner of said "Hardy Parcel";

Thence leaving said centerline South $88^{\circ}54'41''$ East, along the South line of said "Hardy Parcel", for a distance of 96.87 feet;

Thence leaving said South line, South $35^{\circ}38'15''$ East, for a distance of 153.74 feet to the **TRUE POINT OF BEGINNING**;

Thence North $35^{\circ}38'15''$ West, for a distance of 153.74 feet;

Thence North $88^{\circ}54'41''$ West, for a distance of 96.87 feet to the Southwest corner of said "Hardy Parcel" and said centerline of Road "A";

Thence Southerly along said centerline South $32^{\circ}28'53''$ East, for a distance of 45.64 feet;

Thence along the arc of a 401.45-foot radius curve to the right, through a central angle of $25^{\circ}16'19''$, for an arc distance of 177.07 feet;

Thence South $07^{\circ}12'34''$ East, for a distance of 41.51 feet;

Thence along the arc of a 206.28-foot radius curve to the left, through a central angle of $32^{\circ}26'11''$, for an arc distance of 116.78 feet;

Thence South $39^{\circ}38'45''$ East, for a distance of 121.56 feet;

Thence along the arc of a 218.57-foot radius curve to the right, through a central angle of $40^{\circ}12'26''$, for an arc distance of 153.38 feet;

Thence South $00^{\circ}33'41''$ West, for a distance of 62.98 feet;

Thence along the arc of a 50.00-foot radius curve to the left, through a central angle of $22^{\circ}26'08''$, for an arc distance of 19.58 feet to the intersection of roads "A", "B", and "C" as shown on said Plat (J-364);

Thence South $21^{\circ}35'52''$ East, for a distance of 194 feet, more or less, to the Southeast corner of said West half of the Northwest quarter of Section 23;

Thence North along the East line of said West half, for a distance of 718 feet, more or less, to a point which bears South $88^{\circ}54'41''$ East from the **TRUE POINT OF BEGINNING**;

Thence North $88^{\circ}54'41''$ West, for a distance of 160 feet, more or less, to the **TRUE POINT OF BEGINNING**.



Minister & Glaeser Surveying, Inc.

Phone: 360-694-3313 Fax: 360-694-8410

05/02/17

May 1, 2017

EXHIBIT "D"

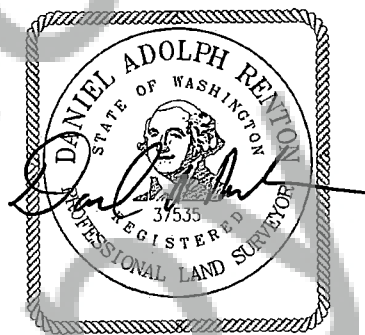

JORDAN PARCEL AFTER ADJUSTMENT

A portion of the West half of the Northwest quarter of Section 23, Township 2 North, Range 6 East, Willamette Meridian, Skamania County Washington, described as follows:

Commencing at a 1/2" iron rod marking the West Quarter corner of said Section 23, as shown on the Plat of "Columbia River Estates" as recorded in Book. "J", page 364 (J-364), miscellaneous records of Skamania County;

Thence North $00^{\circ}35'28''$ East, along the West line of the Northwest quarter of Section 23, for a distance of 1595.43 feet;

Thence South $89^{\circ}24'32''$ East, at right angles to said West line, for a distance of 659.33 feet to the Northwest corner of Parcel 10 (J-364) and the centerline of road "A" as shown in said Plat (J-364);

Thence Southerly following said centerline along the Westerly line of said Parcel 10, South $33^{\circ}09'33''$ East, for a distance of 13.04 feet;

Thence along the arc of a 180.60-foot radius curve to the left, through a central angle of $18^{\circ}51'47''$, for an arc distance of 59.46 feet;

Thence South $52^{\circ}01'20''$ East, for a distance of 78.23 feet;

Thence along the arc of a 202.11 radius curve to the right, through a central angle of $14^{\circ}06'10''$, for an arc distance of 49.75 feet;

Thence South $37^{\circ}55'10''$ East, for a distance of 315.99 feet;

Thence along the arc of a 50.37-foot radius curve to the right, through a central angle of $24^{\circ}57'24''$, for an arc distance of 21.94 feet to the Northwest corner of the "Hardy Parcel" as recorded in Deed Book 228, Page 33 Skamania County Auditor's Records and the **TRUE POINT OF BEGINNING**;

Thence continuing along said 50.37-foot radius curve to the right, through a central angle of $101^{\circ}36'57''$, for an arc distance of 89.33 feet to a point of reverse curvature;

Thence along the arc of a 112.85-foot radius curve to the left, through a central angle of $121^{\circ}08'04''$, for an arc distance of 238.59 feet;

Thence South $32^{\circ}28'53''$ East, for a distance of 146.78 feet to the Southwest corner of said "Hardy Parcel";

Thence leaving said centerline South $88^{\circ}54'41''$ East, along the South line of said "Hardy Parcel", for a distance of 96.87 feet;

Thence leaving said South line, South $35^{\circ}38'15''$ East, for a distance of 153.74 feet;

Thence South $88^{\circ}54'41''$ East, for a distance of 160 feet, more or less, to the East line of said West half of the Northwest quarter of Section 23;

Thence North along said East line, for a distance of 483 feet, more or less, to a point which bears South $88^{\circ}54'41''$ East from the **TRUE POINT OF BEGINNING**;

Thence North $88^{\circ}54'41''$ West, for a distance of 291 feet, more or less, to the **TRUE POINT OF BEGINNING**.

National Scenic Area – Land Use Application

(Please complete application in ink)

APPLICANT: <u>Sandy Jordan</u>		E-mail: <u>sandyj9633@gmail.com</u>	
Address: <u>2002 Kueffler Rd</u>		Phone: <u>360-903-9633</u>	
<u>Stevenson, WA 98648</u>		Mailing address: <u>7620 NE 142 Ave, Vancouver WA 98682</u>	
PROPERTY OWNER: <u>Douglas Haight</u>		E-mail: <u>douglashaight@gmail.com</u>	
Address: <u>02062320011900</u>		Phone: <u>none</u>	
<u>Kueffler Rd 98648</u>		<u>P.O. Box 236 Stevenson, WA 98648</u>	
PROJECT SITE ADDRESS:			
Tax Lot/Parcel # <u>(A) 02062320010500 - (B) 02062320011900</u>		Total acres: <u>(A) 3.28 - (B) 3.26</u>	
Section:	Township:	Range:	Milepost (if known):
<input type="checkbox"/> GMA <input type="checkbox"/> SMA Land Use Designation (zone):			
Please attach the Legal Description of the tax lot/parcel of this application. (If you do not already know the Legal Description you may obtain it from the County Auditor).			
PROJECT NARRATIVE: (Attach additional sheets if necessary)			
<u>Jordan owns real property (A). Haight owns real property (B)</u> <u>Jordan contends she has a valid adverse possession claim</u> <u>to a portion of the Haight property. Jordan and Haight wish</u> <u>to resolve the boundary line issue and clear title to their</u> <u>respective properties by virtue of a Boundary line Adjustment</u> <u>Deed.</u>			
APPLICANT SIGNATURE(S): <u>Sandy Jordan</u>		Date: <u>3/27/2017</u>	
<u>(AKA Sandra Hardy)</u>			
OWNER SIGNATURE(S)*: <u>Douglas M. Haight</u>		Date: <u>5.25.17</u>	
<small>*A site visit is conducted as part of the NSA review process. Signature of the property owner(s) authorizes the Community Development Department and other Agency personnel reasonable access to the site in order to evaluate the application.</small>			
FOR DEPARTMENT USE ONLY			
Date received:			
Date complete:			
File #:			
Notes:			

75653

BOOK J PAGE 358

PHONE 206 694-9391

**OLSON ENGINEERING**

JERRY C. OLSON
112 E. 13TH STREET
VANCOUVER, WASHINGTON 98660

LEGAL DESCRIPTION FOR COLUMBIA RIVER ESTATES

Description of the centerlines of 60 foot wide road easements in Sections 22 and 23 of Township 2 North, Range 6 East of the Willamette Meridian. The East line of the Northeast Quarter of Section 22, Township 2 North, Range 6 East of the Willamette Meridian is used as basis for bearings and for purposes of this description will be North $0^{\circ} 36' 09''$ East. The roads will be referred to as A, B, C, D, E, F, and G.

ROAD "A"

BEGINNING at a point 1225.92 feet South $89^{\circ} 23' 51''$ East and 167.73 feet North $0^{\circ} 36' 09''$ East of the Southeast corner of said Northeast Quarter of Section 22, Township 2 North, Range 6 East of the Willamette Meridian, which is the beginning of a 50 foot radius curve to the right, the tangent of which bears North $21^{\circ} 51' 47''$ West at this point;

thence along said 50 foot radius curve 19.58 feet;

thence North $0^{\circ} 34' 22''$ East 62.98 feet to a 218.57 foot radius curve to the left;

thence along said 218.57 foot radius curve 153.38 feet;

thence North $39^{\circ} 38' 04''$ West 121.56 feet to a 206.28 foot radius curve to the right;

thence along said 206.28 foot radius curve 116.78 feet;

thence North $7^{\circ} 11' 57''$ West 41.51 feet to a 401.45 foot radius curve to the left;

thence along said 401.45 foot radius curve 177.07 feet;

thence North $32^{\circ} 28' 16''$ West 192.42 feet to a 112.85 foot radius curve to the right;

thence along said 112.85 foot radius curve 238.58 feet to a 50.37 foot radius curve to the left;

thence along said 50.37 foot radius curve 111.26 feet;

REGISTERED PROFESSIONAL ENGINEER

REGISTERED LAND SURVEYOR

BOOK J PAGE 357

thence North $37^{\circ} 54' 33''$ West 315.99 feet to a 202.11 foot radius
 curve to the left;
 thence along said 202.11 foot radius curve 49.75 feet;
 thence North $52^{\circ} 00' 43''$ West 78.23 feet to a 180.60 foot radius
 curve to the right;
 thence along said 180.60 foot radius curve 59.45 feet;
 thence North $33^{\circ} 08' 56''$ West 364.28 feet to a 50.00 foot radius
 curve to the right;
 thence along said 50.00 foot radius curve 21.12 feet;
 thence North $8^{\circ} 56' 43''$ West 125.65 feet to a 50.00 foot radius
 curve to the right;
 thence along said 50.00 foot radius curve 27.05 feet;
 thence North $22^{\circ} 04' 04''$ East 30.62 feet to a 50.00 foot radius
 curve to the left;
 thence along said 50.00 foot radius curve 10.33 feet to the point
 of BEGINNING of Road "G", said point being 2142.42 feet North 0°
 $36' 09''$ East and 470.65 feet South $89^{\circ} 23' 51''$ East of the said
 Southeast corner of the Northeast Quarter of Section 22;
 thence continuing along said 50.00 foot radius curve to the left
 33.62 feet;
 thence North $28^{\circ} 17' 37''$ West 156.76 feet to a 50.00 foot radius
 curve to the left;
 thence along said 50.00 foot radius curve 21.07 feet;
 thence North $52^{\circ} 25' 53''$ West 52.75 feet to a 50.00 foot radius curve
 to the right;
 thence along said 50.00 foot radius curve 35.56 feet;
 thence North $11^{\circ} 41' 22''$ West 225.53 feet to the North line of the
 West Half of the Northwest Quarter of Section 23.

ROAD "B"

BEGINNING at a point 1225.92 feet South $89^{\circ} 23' 51''$ East and
 167.73 feet North $0^{\circ} 36' 09''$ East of the Southeast corner of said
 Northeast Quarter of Section 22;
 thence North $89^{\circ} 06' 54''$ West 106.05 feet to a 125.00 foot radius
 curve to the left.

BOOK 5 PAGE 36

thence along said 125.00 foot radius curve 57.96 feet to the point of BEGINNING of Road "D", said point being 155.33 feet North $0^{\circ} 36' 09''$ East and 1063.90 feet South $89^{\circ} 23' 51''$ East of said Southeast corner of the Northeast Quarter of Section 22;

thence continuing along said 125.00 foot radius curve to the left 129.74 feet to a 65.43 foot radius curve to the right;

thence along said 65.43 foot radius curve 98.49 feet;

thence North $88^{\circ} 54' 00''$ West 928.82 feet to said Southeast corner of the Northeast Quarter of Section 22.

ROAD "E"

BEGINNING at a point 1225.92 feet South $89^{\circ} 23' 51''$ East and 167.73 feet North $0^{\circ} 36' 09''$ East of said Southeast corner of Northeast Quarter of Section 22;

thence South $21^{\circ} 51' 47''$ East 193.72 feet to the South line of the West Half of the Northwest Quarter of Section 23.

ROAD "D"

BEGINNING at a point which is 155.33 feet North $0^{\circ} 36' 09''$ East and 1063.90 feet South $89^{\circ} 23' 51''$ East of said Southeast corner of the Northeast Quarter of Section 22;

thence North $25^{\circ} 40' 56''$ West 167.79 feet to a 50.00 foot radius curve to the left;

thence along said 50.00 foot radius curve 12.09 feet;

thence North $39^{\circ} 32' 26''$ West 202.42 feet to a 50.00 foot radius curve to the left;

thence along said 50.00 foot radius curve 53.31 feet;

thence South $79^{\circ} 22' 14''$ West 243.73 feet to a 125.46 foot radius curve to the right;

thence along said 125.46 foot radius curve 156.14 feet;

thence North $29^{\circ} 19' 14''$ West 382.35 feet to a 162.78 foot radius curve to the right;

thence along said 162.78 foot radius curve 59.34 feet;

thence North $8^{\circ} 26' 11''$ West 274.22 feet;

BOOK J PAGE 361

thence North $11^{\circ} 33' 12''$ West 260.50 feet to the point of BEGINNING of Road "E", said point being 1412.90 feet North $0^{\circ} 36' 09''$ East and 123.95 feet South $89^{\circ} 23' 51''$ East of said Southeast corner of the Northeast Quarter of Section 22;

thence continuing North $11^{\circ} 33' 12''$ West 2.00 feet to a 50.00 foot radius curve to the right;

thence along said 50.00 foot radius curve 121.78 feet;

thence South $52^{\circ} 00' 05''$ East 49.69 feet to a 123.72 foot radius curve to the left;

thence along said 123.72 foot radius curve 11.73 feet;

thence North $76^{\circ} 15' 12''$ East 89.87 feet to a 66.40 foot radius curve to the left;

thence along said 66.40 foot radius curve 124.19 feet;

thence North $30^{\circ} 54' 42''$ West 242.64 feet to a 124.32 foot radius curve to the left;

thence along said 124.32 foot radius curve 86.35 feet;

thence North $70^{\circ} 42' 35''$ West 115.71 feet to a 134.73 foot radius curve to the right;

thence along said 134.73 foot radius curve 59.04 feet;

thence North $45^{\circ} 36' 11''$ West 109.05 feet to a point on the East line of said Section 22 being 1979.29 feet North $0^{\circ} 36' 09''$ East of said Southeast corner of the Northeast Quarter of Section 22, which is the beginning of a 331.67 foot radius curve to the right;

thence along said 331.67 foot radius curve 258.21 feet;

thence North $0^{\circ} 55' 47''$ West 68.90 feet to a 174.73 foot radius curve to the left;

thence along said 174.73 foot radius curve 49.66 feet to the end of Road "D" which is 2327.19 feet North $0^{\circ} 36' 09''$ East and 112.30 feet North $89^{\circ} 23' 51''$ West of said Southeast corner of the Northeast Quarter of Section 22.

ROAD "E"

BEGINNING at a point 1412.90 feet North $0^{\circ} 36' 09''$ East and 123.95 feet South $89^{\circ} 23' 51''$ East of said Southeast corner of the Northeast Quarter of Section 22, which is the beginning of a 50.00 foot radius

at this point;
 curve to the left, the tangent of which bears North 11° 33' 12" West
 to the point of BEGINNING of Road "F", said point being 1451.01 feet
 North 0° 36' 09" East and 63.54 feet South 09° 23' 51" East of said
 Southeast corner of the Northeast Quarter of Section 22;
 thence continuing along said 50.00 foot radius curve to the left
 14.46 feet;
 thence South 80° 42' 44" West, 57.32 feet to a point on the East
 line of said Section 22 being 1416.51 feet North 0° 36' 09" East of
 said Southeast corner of the Northeast Quarter of Section 22, which
 is the beginning of a 147.95 foot radius curve to the left;
 thence along said 147.95 foot radius curve 85.35 feet to a 300.19
 foot radius curve to the left;
 thence along said 300.19 foot radius curve 96.54 feet;
 thence South 9° 14' 45" West 110.76 feet to a 50.45 foot radius
 curve to the right;
 thence along said 50.45 foot radius curve 28.82 feet;
 thence South 41° 58' 22" West 256.65 feet to a 50.00 foot radius
 curve to the left;
 thence along said 50.00 foot radius curve 43.28 feet;
 thence South 7° 37' 41" East 146.60 feet to the end of Road "C",
 which is 751.10 feet North 0° 36' 09" East and 276.75 feet North
 89° 23' 51" West of said Southeast corner of the Northeast Quarter
 of Section 22.
 ROAD "F"
 BEGINNING at a point 1451.01 feet North 0° 36' 09" East and
 63.54 feet South 89° 23' 51" East of said Southeast corner of the
 Northeast Quarter of Section 22;
 thence North 77° 17' 54" East 100.06 feet to the end of Road "F",
 which is 1476.04 feet North 0° 36' 09" East and 160.92 feet South
 89° 23' 51" East of said Southeast corner of the Northeast Quarter
 of Section 22.

BOOK J PAGE 363

ROAD "G"

BEGINNING at a point 2142.42 feet North $0^{\circ} 36' 09''$ East and 470.65 feet South $89^{\circ} 23' 51''$ East of said Southeast corner of the Northeast Quarter of Section 22;

thence South $81^{\circ} 09' 57''$ East 424.73 feet to a 50.00 foot radius curve to the right;

thence along said 50.00 foot radius curve 79.74 feet;

thence South $10^{\circ} 20' 20''$ West 49.09 feet to a 75.80 foot radius curve to the left;

thence along said 75.80 foot radius curve 88.40 feet to a 159.91 foot radius curve to the right;

thence along said 159.91 foot radius curve 82.81 feet;

thence South $26^{\circ} 48' 38''$ East 145.66 feet to a 100.00 foot radius curve to the right;

thence along said 100.00 foot radius curve 40.22 feet;

thence South $3^{\circ} 46' 10''$ East 58.62 feet to the end of Road "G" which is 1611.95 feet North $0^{\circ} 36' 09''$ East and 1095.93 feet South $89^{\circ} 23' 51''$ East of said Southeast corner of the Northeast Quarter of Section 22.



