

WHEN RECORDED RETURN TO:

David L Gray, Barbara J Gray
28102 State Rd 14
Washougal Wa, 98671

DOCUMENT TITLE(S)

Quit Claim Deed

SKAMANIA COUNTY
REAL ESTATE EXCISE TAX
32396

REFERENCE NUMBER(S) of Documents assigned or released:

Re Record 2014000165

FEB - 6 2017

Re Record EX 30505 01-30-2014
AFN 2014000165

☐ Additional numbers on page ____ of document.

GRANTOR(S):

NANCY YOTT

PAID
W. J. Mettland, Treasurer
SKAMANIA COUNTY TREASURER
Re Record EX 28474 03-30-2010
AFN 2010175193

☐ Additional names on page ____ of document.

GRANTEE(S):

David L Gray and Barbara J Gray

☐ Additional names on page ____ of document.

LEGAL DESCRIPTION (Abbreviated: i.e. Lot, Block, Plat or Section, Township, Range, Quarter):

Page 5

☐ Complete legal on page ____ of document.

TAX PARCEL NUMBER(S):

01051116090000

☐ Additional parcel numbers on page ____ of document.

The Auditor/Recorder will rely on the information provided on this form. The staff will not read the document to verify the accuracy or completeness of the indexing information.

AFN #2014000165 Recorded 01/29/2014 at 04:32 PM DocType: DEED Filed by: David L. Gray Page: 1 of 4 Auditor Timothy O. Todd Skamania County, WA

When recorded return to:

David L Gray, Barbara J Gray
28102 State Rd 14
Washougal WA. 98671

REAL ESTATE EXCISE TAX

30505

JAN 30 2014

PAID *skema*
Vicente Chelland, Deputy
SKAMANIA COUNTY TREASURER

QUIT CLAIM DEED

THE GRANTOR(S)

Nancy A. Yott

for and in consideration of *Love e affection*

in hand paid, conveys and quit claims to

David L Gray, Barbara J Gray

the following described real estate, situated in the County of Skamania, State of Washington
together with all after acquired title of the grantor(s) herein:

0105110090000 *SW*

Abbreviated Legal: (Required if full legal not inserted above.) See Attached

EXHIBIT A

LPB 12-05(i)rev 12/2006
Page 1 of 2

not for use to state

County of Skamania

I, Robert J. Wynn, Auditor of Skamania County, do hereby certify

that the foregoing instrument is a true and correct copy of the

document now on file and recorded in my office.

In witness whereof, I have set my hand and official seal

at _____ day of _____ 2014

Robert J. Wynn, Auditor

By _____ Deputy

Unofficial
Copy

State of Washington

County of Skamania

I, Robert J. Waymire, Skamania County Auditor, do hereby certify
that the foregoing instrument is a true and correct copy of the
document now on file or recorded in my office.

In witness whereof, I hereunto set my hand and official seal

this 30 day of January 2017

Robert J. Waymire, County Auditor

By Jayme Bauman Deputy

Tax Parcel Number(s): 01051110090000

Dated: 1-29-14

Nancy A. Yott

STATE OF Washington
COUNTY OF Skamania

ss.

I certify that I know or have satisfactory evidence that she (is/are) the person(s) who appeared before me, and said person(s) acknowledged that her signed this instrument and acknowledged it to be free and voluntary act for the uses and purposes mentioned in this instrument.

Dated: 1-29-14

Leslie L Moore
Notary name printed or typed: Leslie L Moore
Notary Public in and for the State of Washington
Residing at Cason
My appointment expires: 1-9-2016

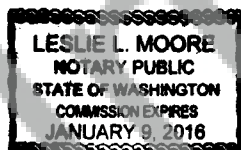

EXHIBIT A

Commencing at a point on the East line of Section 11, Township 1 North, Range 5 East of the Willamette Meridian, Skamania County, Washington at it's intersection with the South Right-of-way line of State Highway 14; thence Westerly along the South Right-of-way line of said Highway 14 to it's intersection with the extension of the East line of the Townsite of Prindle as recorded in Book A, Page 28, and the Point of Beginning;

Thence, proceed in a southerly direction along the East line of the Townsite of Prindle to the Northeast corner of Lot 11, Block A of the Townsite of Prindle;
 thence in a Westerly direction approximately 200' to the Northwest corner of Lot 10 of Block A of the Townsite of Prindle;
 thence continue in a Southerly direction to the Southwest corner of Lot 9 of Block A of the Townsite of Prindle;
 thence continue in an Easterly direction until intersecting with the Northeast corner of Lot 13 of the Townsite of Prindle;
 thence continue Southerly along the East line of the Townsite of Prindle 65.46' to a point on the East line of Lot 14, Block A of the Townsite of Prindle as per Record of Survey recorded in Auditor's File Number 2005160073;
 thence N58°49'37"E, approximately 30' to the Northwest corner of Tax Lot 1100,
 thence continuing N53°54'37"E along the northerly boundary of said Tax Lot 1100 to the intersection of said boundary and the centerline of a creek that flows south from SR-14;
 thence Northerly along the centerline of said creek to the intersection of the creek centerline and the Southerly Right-of-way of State Highway 14;
 thence Westerly along the Southerly Right-of-way of State Highway 14 to the extension of the East line of the Townsite of Prindle and the Point of Beginning.

AND, the Southerly ½ of the vacated First Street between Block A and C of the original Townsite of Prindle.

Skamania County Assessor
 Date: 1-29-11 1-511-1-900

MSM 6.5. 2/22/10
 BTR + 01051110090000
 +
 01051110090200
 3/30/2010

N.Y. 138 28

N.Y. BFG Q8

PARCEL 1

COMMENCING AT A POINT ON THE EAST LINE OF SECTION 11, TOWNSHIP 1 NORTH, RANGE 5 EAST OF THE WILLAMETTE MERIDIAN, SKAMANIA COUNTY, WASHINGTON AT ITS INTERSECTION WITH THE SOUTH LINE OF STATE HIGHWAY 14; AND RUNNING THENCE WESTERLY ALONG THE SOUTH LINE OF SAID HIGHWAY TO ITS INTERSECTION WITH THE EAST LINE OF THE TOWNSITE OF PRINDLE AS RECORDED IN BOOK "A" OF PLATS ON PAGE 28; THENCE SOUTH $32^{\circ} 36'$ EAST ALONG SAID EASTERLY LINE TO A POINT WHICH BEARS SOUTH $52^{\circ} 29'$ WEST 30 FEET FROM THE NORTHWEST CORNER OF THAT TRACT OF LAND DEEDED TO E.W. LEE RECORDED ON PAGE 30 OF BOOK "X" OF DEEDS, RECORDS OF SKAMANIA COUNTY, WASHINGTON; THENCE NORTH $52^{\circ} 29'$ EAST ALONG THE NORTH LINE OF SAID PROPERTY 237.2 FEET TO THE NORTH-EAST CORNER OF SAID TRACT AND THE NORTHWEST CORNER OF THAT TRACT CONVEYED TO TIMOTHY YOTT AND NICOLE OLSEN-YOTT BY AUDITOR'S FILE NO. 2013002455; THENCE EASTERLY ALONG THE NORTH LINE OF SAID YOTT TRACT TO THE NORTHEAST CORNER THEREOF AND THE SOUTHERLY RIGHT OF WAY LINE OF STATE ROAD NO. 14; THENCE WESTERLY ALONG SAID SOUTH LINE TO THE POINT OF BEGINNING.

EXCEPT

Commencing at a point on the East line of Section 11, Township 1 North, Range 5 East of the Willamette Meridian, Skamania County, Washington at it's intersection with the South Right-of-way line of State Highway 14; thence Westerly along the South Right-of-way line of said Highway 14 to it's intersection with the extension of the East line of the Townsite of Prindle as recorded in Book A, Page 28, and the Point of Beginning;

Thence, proceed in a southerly direction along the East line of the Townsite of Prindle to the Northeast corner of Lot 11, Block A of the Townsite of Prindle;
 thence in a Westerly direction approximately 200' to the Northwest corner of Lot 10 of Block A of the Townsite of Prindle;
 thence continue in a Southerly direction to the Southwest corner of Lot 9 of Block A of the Townsite of Prindle;
 thence continue in an Easterly direction until intersecting with the Northeast corner of Lot 13 of the Townsite of Prindle;
 thence continue Southerly along the East line of the Townsite of Prindle 65.46' to a point on the East line of Lot 14, Block A of the Townsite of Prindle as per Record of Survey recorded in Auditor's File Number 2005160073,
 thence $N58^{\circ}49'37''E$, approximately 30' to the Northwest corner of tract conveyed to Earl Lee in Book X of Deeds, page 30, records of Skamania County;
 thence continuing $N53^{\circ}54'37''E$ along the northerly boundary of said Lee tract to the intersection of said boundary and the centerline of a creek that flows south from SR-14;
 thence Northerly along the centerline of said creek to the intersection of the creek centerline and the Southerly Right-of-way of State Highway 14;
 thence Westerly along the Southerly Right-of-way of State Highway 14 to the extension of the East line of the Townsite of Prindle and the Point of Beginning.

Skamania County Assessor
 Date 2-6-17 Parcel# 1-5-11-1-900

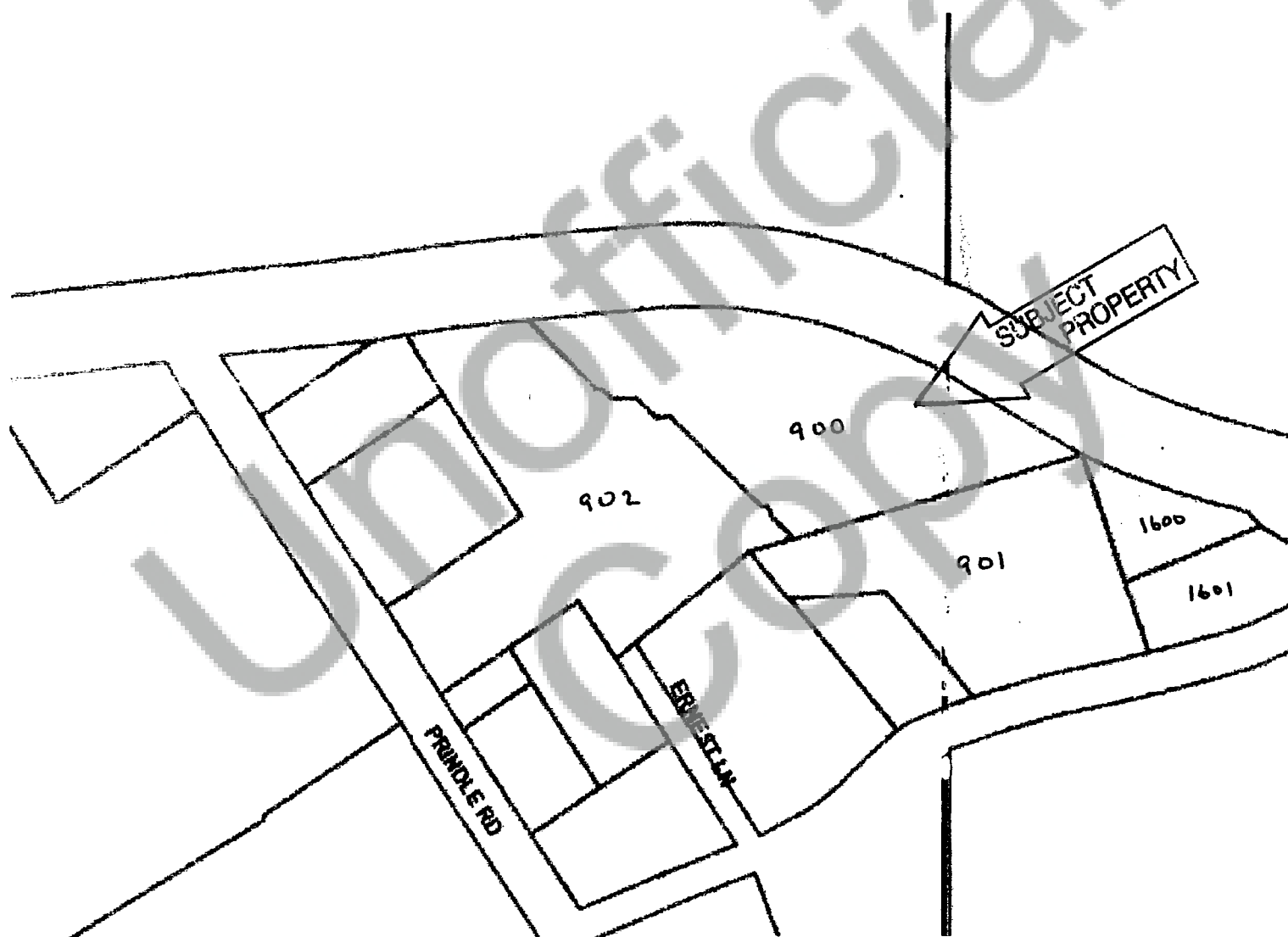

AFN #2010175193 Recorded 03/30/10 at 02:50 PM DocType: MULTI Filed by: NANCY YOTT Page: 1 of 2 Auditor Timothy O. Todd Skamania County, WA

AFTER RECORDING MAIL TO:

Name: Nancy A. Yott
 Address: M.P. 0.27L Prindle Road **REAL ESTATE EXCISE TAX**
 City/State: Washougal, WA 98671

28474
 MAR 30 2010

PAID

EXEMPT

Betty M. Whitney
 SKAMANIA COUNTY TREASURER

QUIT CLAIM DEED
 (BOUNDARY LINE ADJUSTMENT)

FOR THE PURPOSE OF ADJUSTING BOUNDARY LINES ONLY: NANCY A. YOTT, ("Grantor") hereby convey, release and quit claim to herself, NANCY A. YOTT, ("Grantee") all of Grantor's right, title and interest in that certain real property located in Skamania County, State of Washington, described in Exhibit A attached hereto and incorporated herein by this reference.

This Boundary Line Adjustment was approved in the Skamania County Department of Planning and Community Development Administrative Decision for File Number NSA-07-60 and is recorded in Auditor's File Number 2008169281.

The purpose of this deed is to effect a boundary line adjustment between parcels of land owned by Grantors; it is not intended to create a separate parcel, and is therefore exempt for the requirements of RCW 58.17 and Skamania County Short Plat Ordinance. The property described in this deed cannot be segregated and sold without conforming to the State of Washington and Skamania County Subdivision laws.

Dated this 22 day of February, 2010

Nancy A. Yott
 Nancy A. Yott

Assessor's Property Tax / Account Numbers: 01-05-X-10-0900/00, 01-05-Y-10-0901/00,

Planning Department - BLA Approved by: MSM
2-22-2010

STATE OF WA.

County of Skamania

On this 22 day of February, 2010, before me, personally appeared

Nancy Yott to me known to be (or proved to me on the basis of satisfactory evidence) to be the persons whose names are subscribed to this instrument, and acknowledged that they executed it as their free and voluntary act for the uses and purposes therein mentioned.

BETTY M. WHITNEY
 NOTARY PUBLIC
 STATE OF WASHINGTON
 COMMISSION EXPIRES
 FEBRUARY 1, 2013

Betty M. Whitney
 Notary Public in and for the State of Washington,
 Residing at

My appointment expires: 2-1-2013

Yott Quit Claim BLA.doc