

AUDITOR'S CERTIFICATE:

FILED FOR RECORD THIS 11th DAY OF October, 2016,
AT 1:22 P.M. IN BOOK OF SURVEYS AT PAGE
(AUDITOR'S FILE NO. 2016-002430) AT THE REQUEST OF
BENJAMIN B. BESEDA,
REGISTERED LAND SURVEYOR #35092.

Jaime Borders
COUNTY AUDITOR

COUNTY AUDITOR

NOTES:

1. BEARING BASED ON WASHINGTON COORDINATE SYSTEM SOUTH ZONE GRID, NAD 83(2011) EPOCH 2010.0 ESTABLISHED BY GPS OBSERVATION BETWEEN POINTS ON NORTH LINE OF THE NORTHEAST 1/4 OF THE NORTHWEST CORNER OF SECTION 20 AS SHOWN.
2. MONUMENTS SHOWN HEREON WERE RECOVERED OR SET ON SEPTEMBER 16, 2016.

REFERENCES:

- 1) U.S.D.A. FOREST SERVICE SURVEY--BALDY CADASTRAL BY TERRA SURVEYING
RECORDED JANUARY 19, 1993
BOOK 2 OF SURVEYS, PG. 108 & 109
- 2) SURVEY IN S1/2, NW1/4, SECTION 26
BY OLSON ENGINEERING
RECORDED JULY 27, 1976
BOOK 1 OF SURVEYS, PG. 104
- 3) BOUNDARY SURVEY OF BIG CEDAR COUNTY PARK
BY OLSON ENGINEERING
DATED AUGUST 12, 1971 AND REFERENCED IN REF.#24
ABOVE (NOT RECORDED WITH SKAMANIA COUNTY)
- 4) SURVEY IN SECTION 23 BY
DEPARTMENT OF NATURAL RESOURCES
SURVEY #285, NOVEMBER 1977
(NOT RECORDED WITH SKAMANIA COUNTY)
- 5) PERM. HIGHWAY No. 19, WILLARD ROAD
BT CLARK LABARRE, COUNTY ENGR.
MAY 5, 1931

NARRATIVE:

THE PURPOSE OF THIS SURVEY WAS TO ESTABLISH AND MONUMENT THE NORTH 1/2 AND SOUTH 1/2 OF THE NORTHEAST 1/4 OF SECTION 26, TOWNSHIP 4 NORTH, RANGE 9 EAST, W.M. PRIOR TO COMPLETING THE FIELD WORK AND MAPPING FOR THIS SURVEY, RESEARCH WAS MADE TO OBTAIN A COPY OF THE CURRENT DEEDS FOR THE SUBJECT PROPERTIES AND TO OBTAIN COPIES OF PREVIOUSLY COMPLETED SURVEYS ON OR IN THE VICINITY OF THE SUBJECT PROPERTIES. PRIOR SURVEYS UTILIZED AS A PART OF THE RESOLUTION SHOWN HEREON ARE LISTED AS REFERENCES.

IN THE FIELD, MONUMENTS O'NECORRE WERE FOUND AT THE NORTHWEST, NORTHEAST AND SOUTHEAST CORNERS OF THE NORTHWEST 1/4 OF THE NORTHWEST 1/4. THE MONUMENTS ON THE NORTH LINE WERE FROM THE DNR SURVEY LISTED AS REFERENCE #4. THE MONUMENT AT THE SOUTHEAST CORNER WAS PER OLSON ENGINEERING, IN REFERENCE #2. A MONUMENT WAS ALSO LOCATED AT THE SOUTHWEST CORNER OF THE NORTHWEST 1/4 OF THE NORTHWEST 1/4. THIS MONUMENT WAS SET BY D2AB, INC., BEING DENNIS PEOPLES, WASHINGTON PLS. 25552. NO SURVEY OF RECORD WAS FOUND WITHIN THE DNR DATABASE FOR THIS MONUMENT. BASED ON PREVIOUS SURVEYS OF RECORD, TENNESSEE ENGINEERING CALCULATED A POSITION FOR THE SOUTHWEST CORNER. THIS POSITION WAS WITHIN 1 FOOT OF THE FOUND MONUMENT. THEREFORE, THE FOUND MONUMENT WAS HELD FOR THE SOUTHWEST CORNER OF THE PROPERTY. THE CORNERS BETWEEN THE NORTH 1/2 AND SOUTH 1/2 OF THE NORTHWEST 1/4 OF THE NORTHWEST 1/4 WERE CALCULATED AT MIDPOINTS BETWEEN THE FOUND MONUMENTS. THIS COMPLETED THE ESTABLISHMENT OF THE BOUNDARY OF THE SUBJECT PROPERTY.

THE RIGHT-OF-WAY FOR WILLARD ROAD WAS CALCULATED BY BEST FIT OF THE EXISTING CENTERLINE STRIPE TO THE ALIGNMENT PROVIDED IN REFERENCE #5. THE PAINTED CENTER STRIPE WAS THEN SET AS SHOWN ON THE SURVEY AT THE RIGHT-OF-WAY POINTS AND PROPERTY CORNERS. WANDERS CONSIDERABLY FROM THE RECORD ALIGNMENT. MONUMENTS WERE THEN SET AS SHOWN ON THE SURVEY AT THE RIGHT-OF-WAY POINTS AND PROPERTY CORNERS.

FIELD WORK FOR THIS PROJECT WAS COMPLETED UTILIZING TRIMBLE R8 RTK GPS RECEIVERS OPERATED WITH TRIMBLE TSC3 HANDHELD ELECTRONIC DATA COLLECTORS. FIELD WORK INCLUDED THE COLLECTION OF MONUMENT TIES TO THE FOUND MONUMENTS AND EXTENDED POINT OCCUPATION TIMES. DATA COLLECTION IN THIS FASHION MEETS OR EXCEEDS THE REQUIREMENTS OF WAC-332-013-.090.

SET MONUMENTS ARE 5/8" X 30" REBAR WITH YELLOW PLASTIC CAP INSCRIBED "B BESEDA PLS 35092".

LEGEND:

- SET 5/8"ø X 30" REAR WITH YELLOW PLASTIC CAP, "B BESIDA PLS 35092"
 - FOUND MONUMENTS, AS NOTED.
 - CALCULATED CORNERS, NOT SET.
 - SET HUB & TACK.
 - SET P.K. NAIL OR AS NOTED.
 - SET BRASS SCREW AND WASHER, "PLS #35092"
- ✦——EXISTING FENCE LINE.

AUDITOR'S CERTIFICATE:

FILED FOR RECORD THIS 14th DAY OF October, 2016,
AT 1:22 P.M. IN BOOK 1 OF SURVEYS AT PAGE 1
(AUDITOR'S FILE No. 2016002130) AT THE REQUEST OF
BENJAMIN B. BESEDA,
REGISTERED LAND SURVEYOR #35092.

COUNTY AUDITOR

COUNTY AUDITOR

SURVEYOR'S CERTIFICATE:

THIS MAP CORRECTLY REPRESENTS A SURVEY MADE BY ME OR UNDER MY DIRECTION IN CONFORMANCE WITH THE REQUIREMENTS OF THE SURVEY RECORING ACT AT THE REQUEST OF SHERRY LETHCO IN SEPTEMBER 2016.

LETHCO IN SEPTEMBER 2016.

BENJAMIN B. BESEDA,

REGISTERED LAND SURVEYOR, #35092

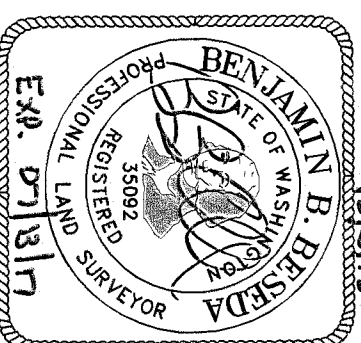

Date	No.	Revision	By	App
<p align="center">SURVEY OF TAX PARCELS 04-09-2600-0-2-0000 AND 04-09-2600-0-2-0100 FOR SHERRY LETHCO</p>				
<p align="center">IN THE NW1/4, NW1/4, SECTION 26, TWP.4 N., R.9 E. W.M. SKAMANIA COUNTY, WASHINGTON</p>				
<p align="center">TENNESSEE ENGINEERING CORP.</p>				
<p align="center">CONSULTING ENGINEERS</p>				
<p align="center">3775 CRATES WAY THE DALLES, OREGON 97058</p>				
<p align="center">PH. 541-296-9177 FAX 541-296-6657</p>				
Survey B.R.H.	Calculation B.B.B.	Design	Date	Scale
Drawn D.W.G.	No. 04-09-2600-0-2-0000	Checked & App. D.W.G.	10/05/2016	1"=200'
			Work Order No.	Sheet