

RECORD OF SURVEY
IN THE SW 1/4 SW 1/4 &
THE SE 1/4 SW 1/4 OF
SECTION 14, T3N, R7E, W.M.
SKAMANIA COUNTY, WA.

DEED REFERENCE
QUIT CLAIM DEED
LONGVIEW FIBRE COMPANY
TO
LONGVIEW TIMBERLANDS, LLC
AFN 2007166332 (6/1/2007)

NARRATIVE
THE PURPOSE OF THIS SURVEY WAS TO LOCATE AND MARK THE WEST
AND SOUTH LINE OF THE "WEYERHAEUSER COLUMBIA TIMBERLANDS,
LLC TRACT" CITED IN SECTION 14 FOR FUTURE LOGGING PURPOSES. A
RANDOM CONTROL TRAVERSE WAS RAN FROM THE SOUTH 1/4 CORNER,
NORTH TO THE CENTER SOUTH 1/16 AND THEN WEST TO THE SOUTH
1/16 CORNER OF SECTION 14. THIS TRAVERSE WAS ORIENTED TO THE
BEARING OF N 00°01'17" W, BETWEEN THE SOUTH 1/4 CORNER AND
THE CENTER SOUTH 1/16 CORNER AS SHOWN IN A UNRECORDED
SURVEY BY ALFRED OPDAHL (1969), ON FILE WITH THE DEPARTMENT
OF NATURAL RESOURCES.

WEYERHAEUSER COLUMBIA TIMBERLANDS, LLC
(FORMERLY LONGVIEW TIMBERLANDS, LLC)

AFN 2007166332

(S 89°48'39" W 2634.774')²
S 89°48'41" W 2638.01'

15
14

S 00°06'58" E 1297.41'
(1297.95')¹ & 2

CALCULATED POSITION OF A DNR
CONCRETE MONUMENT WITH BRASS
CAP AS SHOWN IN U.R.S. BY
ALFRED OPDAHL (1969).
(SEE BOOK J, PAGE 149 FOR
REFERENCES)

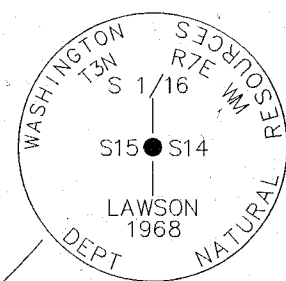

BOOK J, PAGE 148-154

FOUND AND HELD 3" DNR BRASS
CAP (SEE NOTE) AS SHOWN IN U.R.S.
BY ALFRED OPDAHL (1969), STAMPED
AS SHOWN AND REFERENCED AS
FOLLOWS:
40" FIR WITH HEALED BLAZE,
N48°E, 64.6' TO NAIL IN SIDE CENTER
30" FIR WITH HEALED BLAZE,
N42°W, 22.0' TO NAIL IN SIDE CENTER
METAL "T" POST S42°E, 4.8'
(SEE BOOK J, PAGE 153 FOR
REFERENCES)

NOTE
THE DNR MONUMENT FOR THE SOUTH 1/16TH WAS
FOUND LAYING BENT OVER AND LEANING AT A 90°
ANGLE POINTING DOWN THE CREEK, MOST LIKELY
FROM A WASHOUT. THE CREEK HAS A 3' DEEP
CHANNEL AND THE CORNER LIES ON THE EDGE OF
THE SOUTH BANK OF THE CHANNEL. I STRAIGHTENED
THE IRON ROD THE CONCRETE MONUMENT WITH BRASS
CAP WAS ATTACHED TO AND PULLED RECORD
DISTANCES OFF OF BOTH EXISTING BEARING TREES TO
RESTORE THIS CORNER. WE ALSO DUG A BENCH IN
THE DIRT AND RIVER ROCK ON THE NORTH SIDE OF
THE MONUMENT SO WE COULD BUILD UP A ROCK
MOUND TO PROTECT THE MONUMENT FROM FUTURE
WASH OUTS COMING DOWN THE CREEK.

DEPARTMENT OF NATURAL RESOURCES
BOOK 51, PAGE 183

FOUND AND HELD 2-1/2" BRASS CAP
AS SHOWN IN U.R.S. BY ALFRED
OPDAHL (1969), STAMPED AS SHOWN
AND REFERENCED AS FOLLOWS:
55" FIR SNAG WITH HEALED BLAZE,
S01°W, 44.2' TO NAIL IN SIDE CENTER
68" FIR WITH HEALED BLAZE,
S61°W, 44.4' TO NAIL IN SIDE CENTER
METAL "T" POST NORTH, 2.0'
(SEE LCR BY ALFRED OPDAHL ON FILE
WITH DNR)

200 100 0 200 300 400
SCALE 1 INCH = 200 FEET

LEGEND:

- INDICATES MONUMENT FOUND (UNLESS NOTED OTHERWISE)
- () INDICATES RECORD INFORMATION PER SURVEY REFERENCE NUMBER
- DNR DEPARTMENT OF NATURAL RESOURCES
- ROS RECORD OF SURVEY
- URS UNRECORDED RECORD OF SURVEY
- AFN AUDITOR'S FILE NUMBER

INDICATES LINE MARKED WITH 1/2" x 72" FIBER
GLASS RODS WITH RED AND WHITE RIBBON.
TREES ALONG LINE PAINTED AND BLAZED WITH
BLUE PAINT.

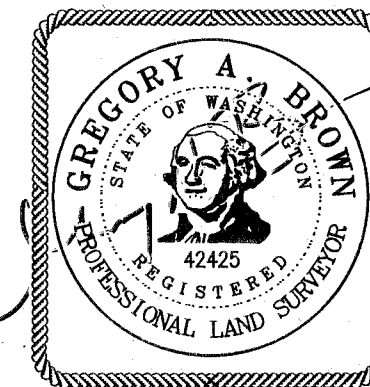

SURVEYOR'S CERTIFICATE

THIS MAP CORRECTLY REPRESENTS A SURVEY MADE BY ME OR UNDER MY DIRECTION
IN CONFORMANCE WITH THE REQUIREMENTS OF THE SURVEY RECORDING ACT AT THE
REQUEST OF WEYERHAEUSER COLUMBIA TIMBERLANDS, LLC IN JUNE, 2016.

GREGORY A. BROWN, PROFESSIONAL LAND SURVEYOR, LS# 42425

SCALE: 1"=200'
JOB NO. 16-019
DATE: 8/24/2016
CALC BY: GAB
DRAWN BY: GAB
CHECKED BY: EVB
SHEET 1 OF 1

BROWN
SURVEYING PLLC

PO BOX 414
AMBOY, WA 98601
360-600-0846
ebrownsurveying@gmail.com

AUDITOR'S CERTIFICATE

FILED FOR RECORD THIS 15th DAY OF September 20 16 AT
1:44 P.M. IN BOOK 1 OF SURVEYS AT PAGE 1
AT THE REQUEST OF BROWN SURVEYING PLLC.

AF # 2016 001915

Robert J. Waymire
DEPUTY COUNTY AUDITOR

BROWN SURVEYING PLLC MAKES NO WARRANTIES AS TO MATTERS OF UNWRITTEN
TITLE SUCH AS ADVERSE POSSESSION, ACQUIESCENCE, ESTOPPLE, ETC.

A FIELD TRAVERSE WAS PERFORMED USING A NIKON NIVO 3.0C THREE SECOND
TOTAL STATION WITH TDS DATA COLLECTION SYSTEM. THE FIELD TRAVERSE MET THE
MINIMUM STANDARDS FOR SURVEYS AS DESIGNATED IN WAC 332-130-090. ALL
CORNERS NOTED AS FOUND WERE VISITED ON 7/5 AND 7/6/2016.