

WHEN RECORDED RETURN TO:

_ SKAMANIA COUNTY PUD _____

_ PO BOX 500 _____

_ CARSON, WA 98610 _____

DOCUMENT TITLE(S)

RIGHT OF WAY EASEMENT

REFERENCE NUMBER(S) of Documents assigned or released:

☐ Additional numbers on page _____ of document.

GRANTOR(S):

JOHN F. VOLGAMORE & MARY E. VOLGAMORE

☐ Additional names on page _____ of document.

GRANTEE(S):

SKAMANIA COUNTY PUD

☐ Additional names on page _____ of document.

LEGAL DESCRIPTION (Abbreviated: i.e. Lot, Block, Plat or Section, Township, Range, Quarter):

9 1/5

☐ Complete legal on page _____ of document.

TAX PARCEL NUMBER(S):

☐ Additional parcel numbers on page _____ of document.

The Auditor/Recorder will rely on the information provided on this form. The staff will not read the document to verify the accuracy or completeness of the indexing information.

1-5-9.6

Any merchantable timber, talus will be backed up
K.H. Parker
1941.

John F. Volgamore
Mary E. Volgamore

STATE OF WASHINGTON)
COUNTY OF SKAMANIA) ss.

I, the undersigned, a Notary Public in and for the State of Washington, do hereby certify that on this day there personally appeared before me

John F. Volgamare and Mary E. Volgamore

a single person-husband and wife, to me known to be the person described in and who executed the foregoing instrument, and acknowledged to me that he signed the same as his free and voluntary act and deed, for the uses and purposes therein mentioned.

IN WITNESS WHEREOF I have hereunto set my hand and official seal this 21 day of March, 1942.

R. R. Elder

A Notary Public in and for the
State of Washington, residing
at Stevenson.

1-5 Section 9

SCALE FOR SECTION, { Each side large blue squares = 20 chains, 20 rods, 1320 feet; area of square = 40 acres.
 660 Ft. = 1 inch. { Each side small red squares = 5 chains, 20 rods, 330 feet; area of square $2\frac{1}{2}$ acres.

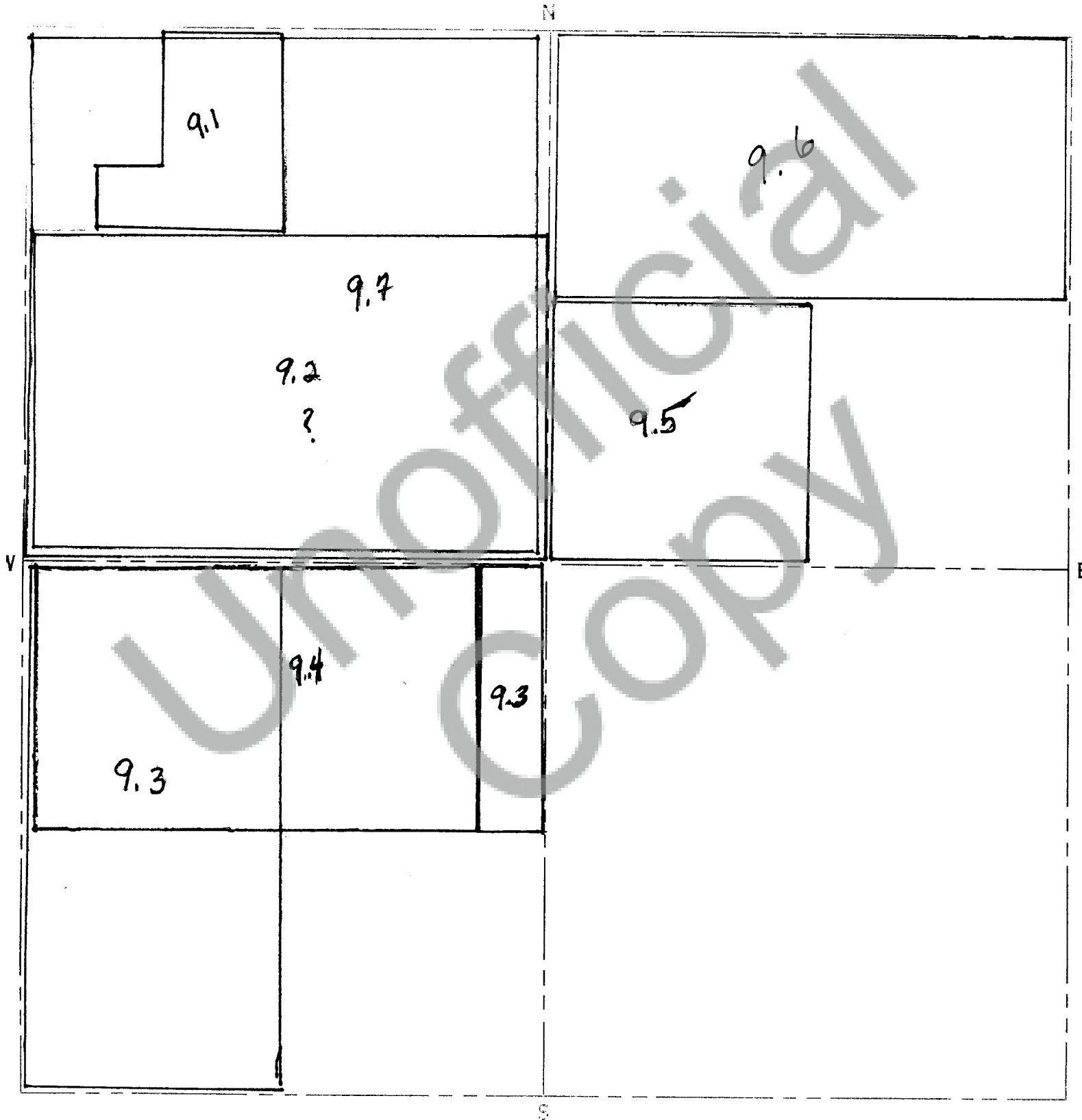

SCALE FOR QUARTER SECTION, { Each side large blue squares = 10 chains, 40 rods, 660 feet; area of square = 10 acres.
 1320 Feet = 1 inch. { Each side small red squares = $2\frac{1}{2}$ chains, 10 rods, 330 feet; area of square $.625$ of 1 acre.

FRONTS LAND MEASURE 660-660 MAP SHEET

FRONTS LAND MEASURE

Copyright 1980, James Hamilton, A John A. Hamilton Company