

WHEN RECORDED RETURN TO:

_ SKAMANIA COUNTY PUD _

_ PO BOX 500 _

_ CARSON, WA 98610 _

DOCUMENT TITLE(S)

RIGHT OF WAY EASEMENT

REFERENCE NUMBER(S) of Documents assigned or released:

☐ Additional numbers on page ____ of document.

GRANTOR(S):

MINNIE MILLESON

☐ Additional names on page ____ of document.

GRANTEE(S):

SKAMANIA COUNTY PUD

☐ Additional names on page ____ of document.

LEGAL DESCRIPTION (Abbreviated: i.e. Lot, Block, Plat or Section, Township, Range, Quarter):

1 3/7.5

☐ Complete legal on page ____ of document.

TAX PARCEL NUMBER(S):

☐ Additional parcel numbers on page ____ of document.

The Auditor/Recorder will rely on the information provided on this form. The staff will not read the document to verify the accuracy or completeness of the indexing information.

RIGHT-OF-WAY EASEMENT

3-7 1/2-1.1

KNOW ALL MEN BY THESE PRESENTS, that the undersigned

a single person ~~husband and wife~~, for a good and valuable consideration, the receipt whereof is hereby acknowledged, does hereby grant unto Public Utility District No. 1 of Skamania County, Washington, a municipal corporation of the State of Washington, and to its successors or assigns, the right to enter upon the lands of the undersigned, situated in the County of Skamania, State of Washington, and more particularly described as follows:

S - 1 T - 3N R - 7 1/2 E Acres 40

S W - N E

and 10 acres in N. E. 1/4 of N. E. 1/4

the same being a tract of land approximately 40 acres in area, located 6 miles N-S-E-W from the Town of Parsons Wash, and bound by land owned by

Bartha Farmer Richard Farmer and Char Farmer and F E Garrett
and to place, construct, operate, repair, maintain, relocate and replace thereon and in or upon all streets, roads or highways abutting said lands and electric transmission or distribution line or system, and to cut and trim trees, shrubbery and grasses to the extent necessary to keep them clear of said electric line or system and to cut down from time to time all dead, weak, leaning or dangerous trees or shrubberies that are tall enough to strike the wires in falling, or that might be or become a fire hazard, and to remove all shrubbery, brush and grasses near the poles that might become a fire hazard.

In granting this easement it is understood that at pole locations only a single pole and appurtenances will be used, and that the location of the poles will be such as to form the least possible interference to farm operations, so long as it does not materially increase the cost of construction.

The undersigned covenants that he is the owner of the above described lands and that the said lands are free and clear of encumbrances and liens of whatsoever character except those held by the following persons:

It is further understood that, whenever necessary, words used in this instrument in the singular shall be construed to read in the plural and that words used in the masculine gender shall be construed to read in the feminine.

IN WITNESS WHEREOF the undersigned has set his hand and seal this

17 day of October, 1940.

*Minnie Milleson

STATE OF WASHINGTON)
COUNTY OF SKAMANIA) ss.

I, the undersigned, a Notary Public in and for the State of Washington, do hereby certify that on this day there personally appeared before me

Minnie Milleson

a single person ~~husband and wife~~, to me known to be the person described in and who executed the foregoing instrument, and acknowledged to me that he signed the same as his free and voluntary act and deed, for the uses and purposes therein mentioned.

IN WITNESS WHEREOF I have hereunto set my hand and official seal this 17 day of October, 1940.

Millen F. Huelsand

A Notary Public in and for the
State of ~~Oregon~~ *Oregon*, residing
at ~~Stevenson~~ *Portland*

My com exps 9-18-43

3-7 $\frac{1}{2}$

Section 1

SCALE FOR SECTION, { Each side large blue squares = 20 chains, 80 rods, 1320 feet; area of square 40 acres.
660 Ft. = 1 Inch. { Each side small red squares = 5 chains, 20 rods, 330 feet; area of square 2 $\frac{1}{2}$ acres.

N

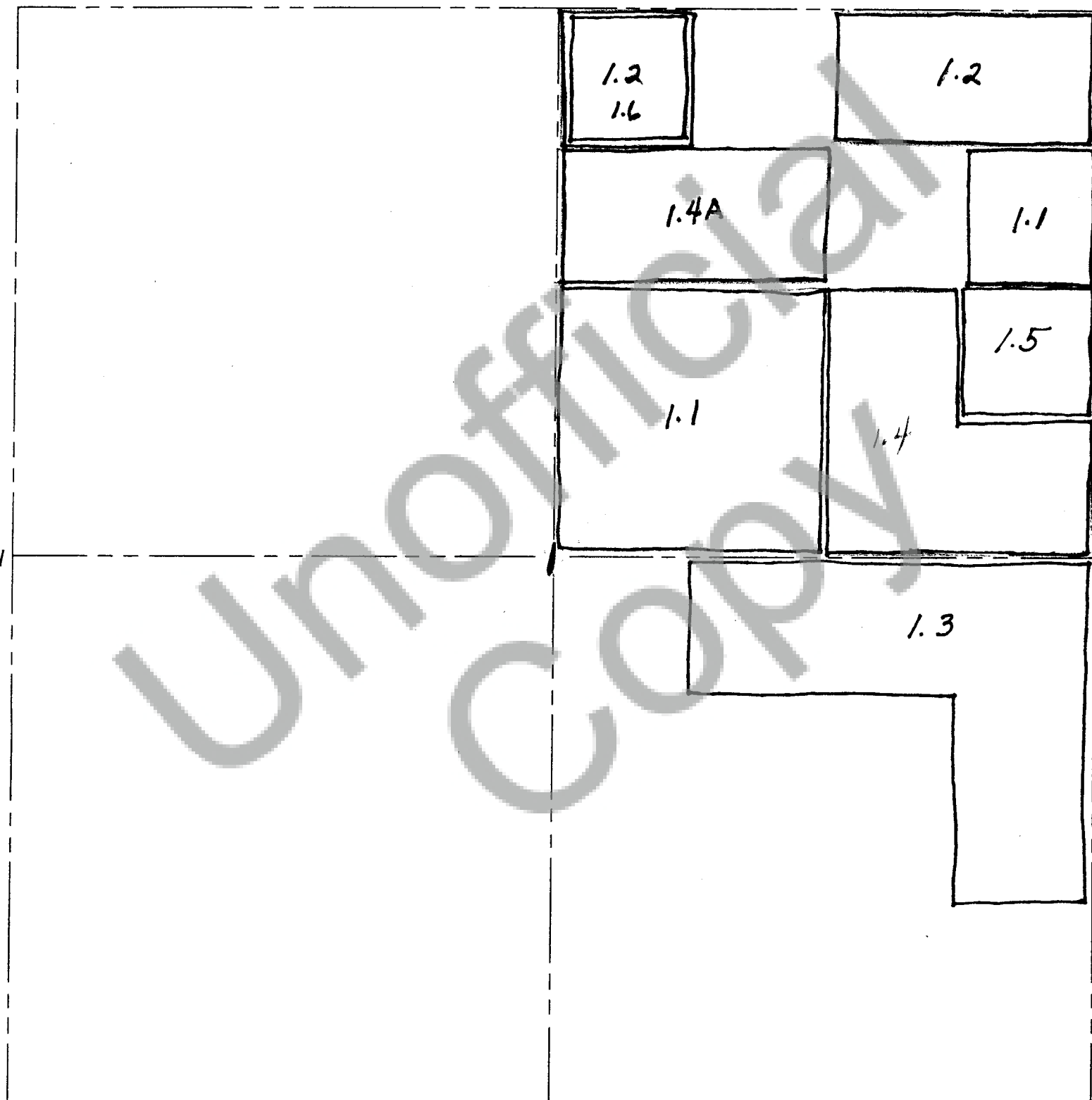

S

SCALE FOR QUARTER SECTION, { Each side large blue squares = 10 chains, 40 rods, 660 feet; area of square 10 acres.
330 Ft. = 1 Inch. { Each side small red squares = 2 $\frac{1}{2}$ chains, 10 rods, 165 feet; area of square .625 of 1 acre.

PRONTO LAND MEASURE 660 - 330 MAP SHEET

PRONTO LAND MEASURE

Copyright, 1950, James Hamilton Adair, Flint, Michigan