

WHEN RECORDED RETURN TO: SKAMANIA COUNTY PUD PO BOX 500 CARSON, WA 98610
--

DOCUMENT TITLE(S) RIGHT OF WAY EASEMENT
REFERENCE NUMBER(S) of Documents assigned or released: <input type="checkbox"/> Additional numbers on page _____ of document.
GRANTOR(S): G. DUANE GAHIMER & ICHEL GAHIMER
<input type="checkbox"/> Additional names on page _____ of document.
GRANTEE(S): SKAMANIA COUNTY PUD
<input type="checkbox"/> Additional names on page _____ of document.
LEGAL DESCRIPTION (Abbreviated: i.e. Lot, Block, Plat or Section, Township, Range, Quarter): <input type="checkbox"/> Complete legal on page _____ of document.
TAX PARCEL NUMBER(S): SECTION 23 T3N R9E
<input type="checkbox"/> Additional parcel numbers on page _____ of document.
The Auditor/Recorder will rely on the information provided on this form. The staff will not read the document to verify the accuracy or completeness of the indexing information.

3-9-23.1

Duane Gahimer

Right-of-Way Easement

KNOW ALL MEN BY THESE PRESENTS, that the undersigned ~~single person~~ husband and wife, for a good and valuable consideration, the receipt whereof is hereby acknowledged, does hereby grant unto Public Utility District No. 1 of Skamania County, Washington, a municipal corporation of the State of Washington, and to its successors or assigns, the right to enter upon the lands of the undersigned, situated in the County of Skamania, State of Washington, and more particularly described as follows:

Tax Title No. 3629, 78 acres Sec. 23, Township 3, Range 9 EWM

and to place, construct, operate, repair, maintain, and replace thereon and in or upon all streets, roads or highways abutting said lands an electric transmission or distribution line or system, it being understood and agreed that said transmission and-or distribution line shall be located approximately as the same is now surveyed and staked upon said ground, and to consist of approximately 2 pole locations and 2 anchor locations, and to cut and trim trees, brush and grasses to the extent necessary to keep them clear of said electric line or system and to cut down from time to time all dead, weak, leaning or dangerous trees or brush that are tall enough to strike the wires in falling, or that might be or become a fire hazard, and to remove all brush and grasses near the poles that might become a fire hazard.

In granting this easement it is understood that at pole locations only a single pole and appurtenances will be used, and that the location of the poles will be such as to form the least possible interference to farm operations, so long as it does not materially increase the cost of construction.

The undersigned covenants that ~~they~~ ~~he~~ are the owner of the above described lands and that the said lands are free and clear of encumbrances and liens of whatsoever character except those held by the following persons:

IN WITNESS WHEREOF the undersigned has set his hand and seal this 13th day of June, 1962.

Duane Gahimer
Icel Gahimer

STATE OF WASHINGTON }
COUNTY OF SKAMANIA } ss.

I, the undersigned, a Notary Public in and for the State of Washington, do hereby certify that on this day there personally appeared before me

G. Duane Gahimer and Icel Gahimer

~~single person~~ husband and wife, to me known to be the person described in and who executed the foregoing instrument, and acknowledged to me that he signed the same as his free and voluntary act and deed, for the uses and purposes therein mentioned.

IN WITNESS WHEREOF I have hereunto set my hand and official seal this 13th day of June,

Chas. Brown

A Notary Public in and for the State of Washington, residing at Stevenson, ~~Stevenson~~ North Bonneville, Wn.

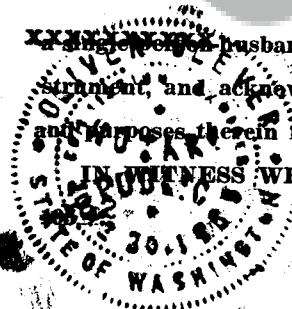

S. F. No. 1854-A-3-57-10M. 48539.

SECTION PLAT

Sec. 23 Twp. 3 N.R. 9 EWM

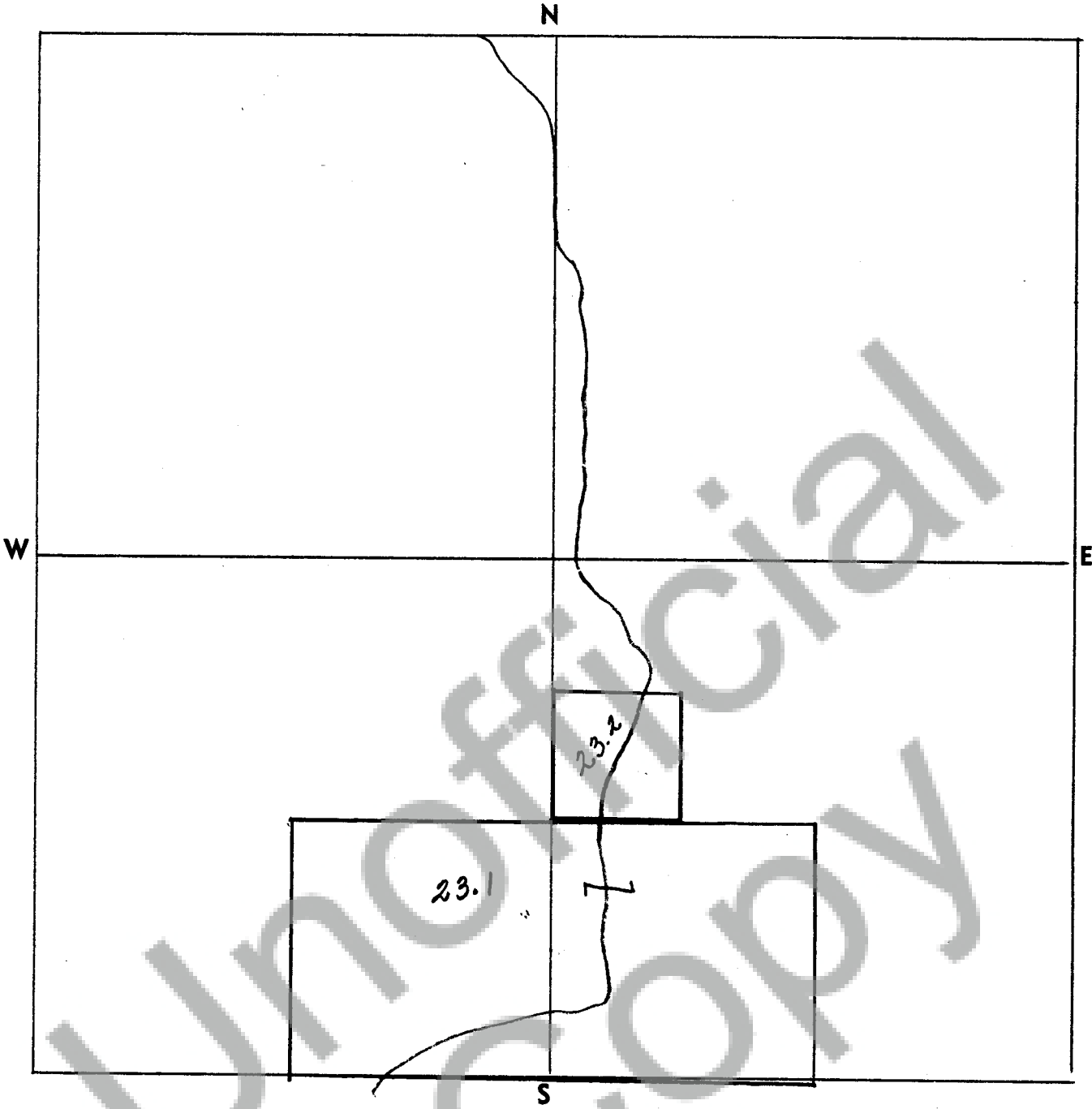

Be sure to show distance and bearing of point of diversion from nearest 40-acre corner. Also traveling directions from nearest town on main highway.

Scale: 1 inch = 800 feet.