

formerly O.D. Miller

3-10-20.1

Right-of-Way Easement

KNOW ALL MEN BY THESE PRESENTS, that the undersigned a single person—husband and wife, for a good and valuable consideration, the receipt whereof is hereby acknowledged, does hereby grant unto Public Utility District No. 1 of Skamania County, Washington, a municipal corporation of the State of Washington, and to its successors or assigns, the right to enter upon the lands of the undersigned, situated in the County of Skamania, State of Washington, and more particularly described as follows: That part of SW $\frac{1}{4}$ NW $\frac{1}{4}$ Sec. 20 T3 N R10 as follows: Beg. at inters. Co. Rd known as Kollock Rd. & Co. Rd known as Collins & Knapp near $\frac{1}{4}$ cor. on W side of Sec. 20; thence in an Easterly direction following center line of said C&K rd a distance of 86 rods more or less to inters. with east line of SW $\frac{1}{4}$ NW $\frac{1}{4}$ of said Sec. 20, thence South along 16th sec. line a distance of 75 rods to inters. with said Kollock rd; thence in a NW direction following center line of Kollock road to place of beginning.

and to place, construct, operate, repair, maintain, and replace thereon and in or upon all streets, roads or highways abutting said lands an electric transmission or distribution line or system, it being understood and agreed that said transmission and-or distribution line shall be located approximately as the same is now surveyed and staked upon said ground, ~~xxx~~ and to consist of approximately 5 pole locations and 3 anchor locations, and to cut and trim trees, brush and grasses to the extent necessary to keep them clear of said electric line or system and to cut down from time to time all dead, weak, leaning or dangerous trees or brush that are tall enough to strike the wires in falling, or that might be or become a fire hazard, and to remove all brush and grasses near the poles that might become a fire hazard.

In granting this easement it is understood that at pole locations only a single pole and appurtenances will be used, and that the location of the poles will be such as to form the least possible interference to farm operations, so long as it does not materially increase the cost of construction.

The undersigned covenants that She... is ~~are~~ the owner of the above described lands and that the said lands are free and clear of encumbrances and liens of whatsoever character except those held by the following persons:

IN WITNESS WHEREOF the undersigned has set his hand and seal this 15 day of Feb., ~~xxx~~ 1965

Grace L. Miller
Underwood Wash R.I. Box 212

STATE OF WASHINGTON }
COUNTY OF SKAMANIA } ss.

I, the undersigned, a Notary Public in and for the State of Washington, do hereby certify that on this day there personally appeared before me

Grace L. Miller

a single person—~~husband and wife~~, to me known to be the person described in and who executed the foregoing instrument, and acknowledged to me that he signed the same as his free and voluntary act and deed, for the uses and purposes therein mentioned.

IN WITNESS WHEREOF I have hereunto ~~set~~ my hand and seal this 15 day of February, ~~xxx~~ 1965



Cheryl Chen
Notary Public in and for the State of Washington,
Serving No. Bonneville

S. F. No. 1854-A—OS—5-62—5M.

SECTION PLAT

Sec. 20 Twp. 3 N. R. 10

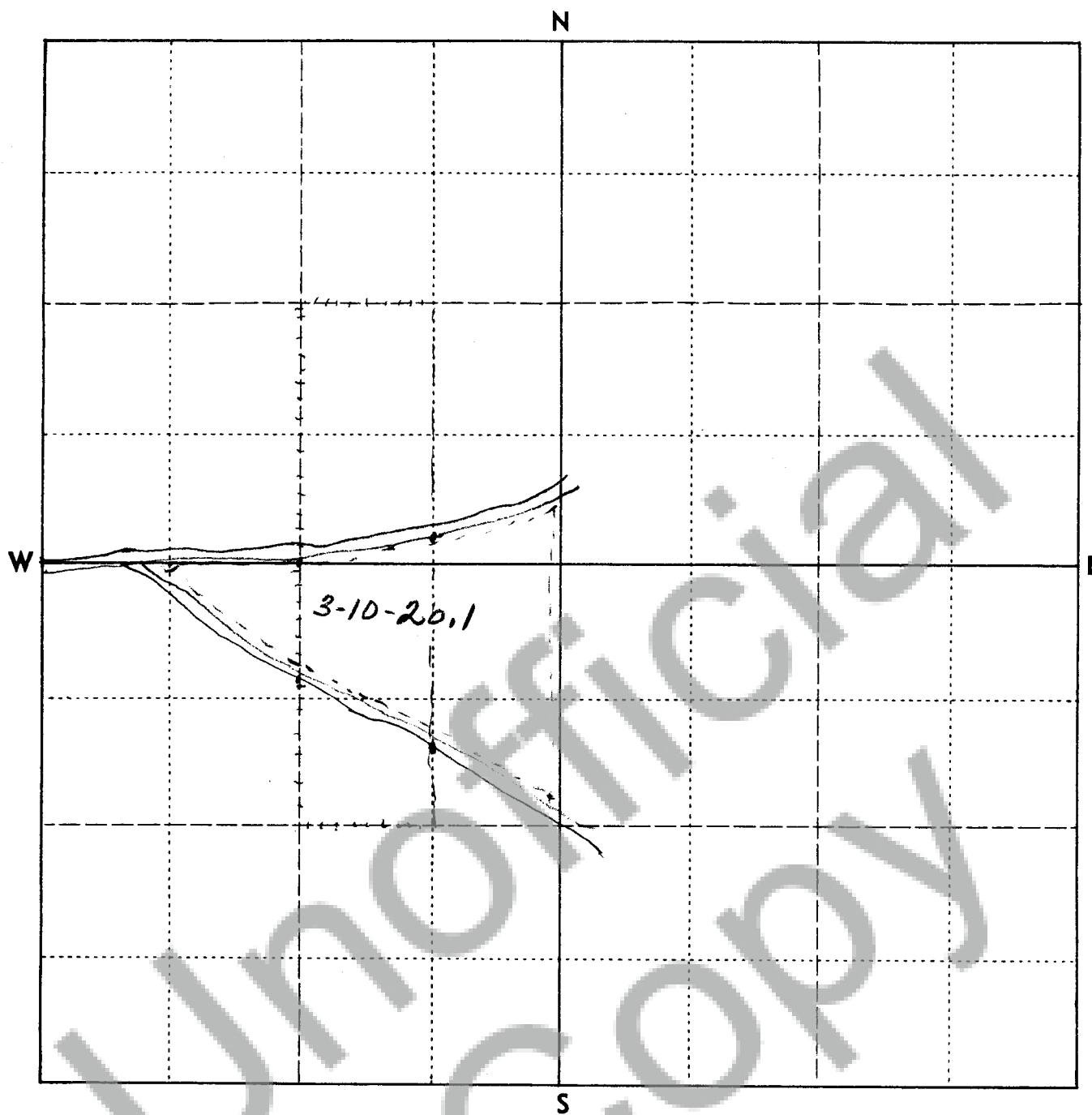

1. Outline property described in application.
2. Show by a cross (X) the location of point of diversion (surface water source) or point of withdrawal (ground water source). For ground water applications, show by a circle (O) the locations of other wells or works within a quarter of a mile.
3. Indicate traveling directions from nearest town.

Scale: 1 inch = 800 feet (each small square = 10 acres)