

RECORD OF SURVEY
A PORTION OF NW 1/4 AND THE NE 1/4 OF THE
SW 1/4, SECTION 26, T. 4 N., R. 7 E., OF THE W.M.,
SKAMANIA COUNTY, WASHINGTON

DEED REFERENCES

GRANTEE: ETHAN R. FROMME & MARTIN E. FROMME (TRUSTEES)
GRANTEE: FROMME FAMILY TRUST
A.F. NO. BOOK 146, PAGE 887
RECEIVED: NOVEMBER 1, 1984
GRANTEE: RICHARD BECKMAN
GRANTEE: FROMME FAMILY TRUST
A.F. NO. BOOK 202, PAGE 13
RECORDED: AUGUST 24, 2000
GRANTEE: WILLIAM M. FROMME
GRANTEE: MICHAEL ARTERBURY
A.F. NO. BOOK 81, PAGE 249
RECORDED: JUNE 16, 1982
GRANTEE: DARREL TILLOTSON
GRANTEE: DARREL TILLOTSON
A.F. NO. BOOK 100, PAGE 862
RECORDED: JULY 31, 1974

PROCEDURE

FIELD TRAVERSES WERE PERFORMED WITH A TRIMBLE S6 (1") AND ADJUSTED BY COMPASS RULE. THE FIELD TRAVERSES MET THE MINIMUM STANDARDS FOR SURVEYS AS DESIGNATED IN WAC 332-132-090.

SURVEY REFERENCES

1. SURVEY BY OLSON ENGINEERING FOR WIND RIVER LOTS (PLAT BK. B, PG. 19) REC. JANUARY 1977.
2. SURVEY BY OLSON ENGINEERING FOR KESLON, FROMME, REESE & OBERST (BK. 1, PG. 23) REC. MARCH 1980.
3. SURVEY BY LAWSON LAND SURVEYING FOR ARTERBURY (BK. 2, PG. 71) REC. JULY 1982.

CORNER HISTORY NOTE

ORIGINALLY ESTABLISHED IN MAY 1895 AS A NEW POST BY J. RICHARDSON WITH ACCESSORIES OF A 3/4" CEDAR NAIL, 15 LINKS AND A 6" HEALOCK NISW 15 LINKS. NO ORIGINAL EVIDENCE WAS DISCOVERED SO OLSON ENGINEERING SET A 3/4" IRON PIPE AT A SINGLE PROPORTIONED POSITION DURING THE PREVIOUS SURVEY FOR WIND RIVER LOTS (PLAT BK. B, PG. 19) REC. IN JANUARY 1977 (NOT VISITED DURING THIS SURVEY).

CORNER HISTORY NOTE

ORIGINALLY ESTABLISHED IN MAY 1895 AS A NEW POST BY J. RICHARDSON WITH ACCESSORIES OF A 3/4" CEDAR NAIL, 15 LINKS AND A 6" HEALOCK NISW 15 LINKS. NO ORIGINAL EVIDENCE WAS DISCOVERED SO OLSON ENGINEERING SET A 3/4" IRON PIPE AT A SINGLE PROPORTIONED POSITION DURING THE PREVIOUS SURVEY FOR WIND RIVER LOTS (PLAT BK. B, PG. 19) REC. IN JANUARY 1977 (NOT VISITED DURING THIS SURVEY).

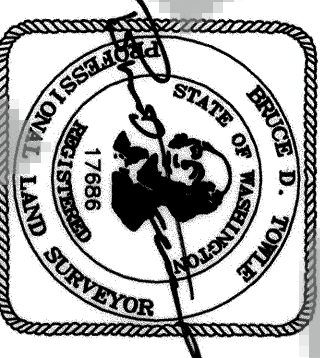

SURVEYOR'S CERTIFICATE

THIS MAP CORRECTLY REPRESENTS A SURVEY MADE BY ME OR UNDER MY DIRECTION IN CONFORMANCE WITH THE REQUIREMENTS OF THE SURVEY RECORDING ACT AT THE REQUEST OF
ETHAN FROMME.

IN JANUARY 2013

Bruce D. Towle
BRUCE D. TOWLE, PLS NO. 17866

AUDITOR'S CERTIFICATE

FILED FOR RECORD THIS 6th DAY OF January 2014
AT 2:16 P.M. IN BOOK 1 OF SURVEYS PAGE 1
AF 2014000015

AT THE REQUEST OF BRUCE D. TOWLE

Melissa Studelson
MELISSA STUDELSON
DEPUTY COUNTY AUDITOR

OLSON LAND SURVEYORS
ENGINEERS

SCALE 1"=100' DRAWN BY HSR
JOB NO. 8971.01.01 CALC. BY HSR
DATE JAN. 2013 SHEET 1 OF 1

4.101A11.80001.89001.89701.8971.1 SURVEY 1977, S.F. 0.505 D.M.G.
COPYRIGHT 2013, OLSON ENGINEERING, INC.



FOUND 3/4" IRON PIPE IN CONCRETE DURING PREVIOUS SURVEY FOR THE PLAT OF WIND RIVER LOTS (BK. B, PG. 19) REPAIRED WITH A 2-1/2" IRON CAP BY BISHOP (NOT VISITED DURING THIS SURVEY). SET THE C.C.R. REC. IN BK. 4/1, PG. 23.

FOUND 1-1/4" IRON ROD DURING PREVIOUS SURVEY FOR THE PLAT OF WIND RIVER LOTS (BK. B, PG. 19) REPAIRED WITH A 2-1/2" IRON PIPE W/BASS CAP BY BISHOP (NOT VISITED DURING THIS SURVEY). SET THE C.C.R. REC. IN BK. 4/1, PG. 28.

LEGEND

SET 1/2" X 24" IRON ROD WITH PLASTIC CAP (OLSON ENG PLS 17866) DURING THIS SURVEY.

- 1/2" X 24" IRON ROD WITH PLASTIC CAP (OLSON 9025) AS SET IN PREVIOUS SURVEY FOR KESLON, FROMME, REESE & OBERST IN MARCH 1980 (BK. 1, PG. 22).
- FOUND 1/2" IRON ROD WITH PLASTIC CAP SET BY LAWSON LAND SURVEYING DURING THE SURVEY FOR ARTERBURY REC. JULY 1982 (2/77) UNLESS NOTED OTHERWISE.