

RECORD OF SURVEY
NORTH LINE SEC. 6, T 7 N, R 6 E, W.M.,
SKAMANIA COUNTY, WASHINGTON

USA

TPN 08060000210000

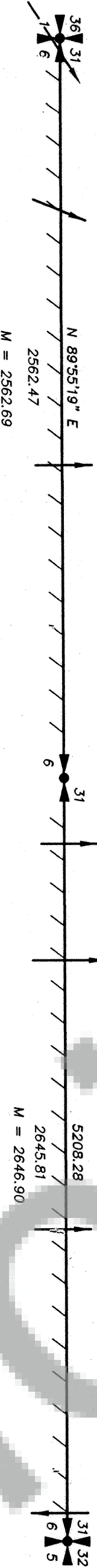

NW COR. 6-7N-6E (A-1)

(9-19-13) CARO & GILLASPIE (SSM) FOUND
A BRASS MONUMENT, WITH EXISTING
ACCESSORIES PER R.O.S. AFN 2009174354
ESTABLISHED ONE NEW ACCESSORY AS FOLLOWS:
1) 12" WHITE FIR N63E 8.16'

(FB No. S-278, PG. 31)

N 1/4 6-7N-6E (A-3)

(9-18-13) SCHINNELL, CARO & GILLASPIE (SSM)
FOUND A BRASS MONUMENT, WITH EXISTING
ACCESSORIES PER R.O.S. AFN 2009174354
(FB No. S-278, PG. 23)

(FB No. S-278, PG. 17)

POPE RESOURCES

TPN 07060000050000

RECORD OF SURVEY DESCRIPTION

THE NORTH LINE OF SECTION 6, TOWNSHIP 7 NORTH, RANGE 6 EAST, W.M.,
SKAMANIA COUNTY, WASHINGTON.

SURVEY REFERENCES

- 1) GLO NOTES CONTRACT No. 552, L.D.W. SHELTON (1899)
- 2) GLO PLAT No. 7-6-A (1901)
- 3) GLO NOTES CONTRACT No. 603, L.D.W. SHELTON (1903)
- 4) GLO NOTES CONTRACT No. 603, L.D.W. SHELTON (1903)
- 5) L.R. 171 94489, M.G. HOBBS, LS No. 15682 (1982)
- 6) R.O.S. VOL. 2, PG. 189, E.A. BUTLER LS No. 18896 (1985)
- 7) R.O.S. AFN 2009174354, P.R. GUSTIN LS No. 37529 (2009)

NARRATIVE

THE PURPOSE OF THIS SURVEY WAS TO MARK THE NORTH LINE OF SEC. 6,
T 7 N, R 6 E, W.M., FOR TIMBER MANAGEMENT AND HARVESTING ACTIVITIES.
NOTE EVIDENCE OF MARKING PRIOR TO LAST TIMBER HARVEST (BLAZES)
WERE NOTED ALONG THE ENTIRE LENGTH OF THIS LINE.

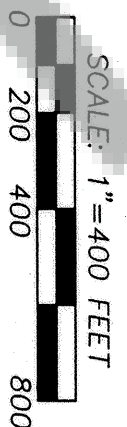

BASED ON MERIDIAN, R.O.S. AFN 2009174354,
RECORDS OF SKAMANIA COUNTY, WASHINGTON.

- LEGEND
- = CREEK AND DIRECTION OF FLOW
 - = LINE BLAZED AND MARKED IN ORANGE PAINT
 - = AND ORANGE FLAGGING

R.P.'S = 400 NAIL IN FACE AT BASE, ALUMINUM TAG
CHEST HEIGHT AND 6" PAINTED BAND HEAD HEIGHT

METHOD OF SURVEY: FIELD TRAVERSE USING A NIKON DTM 522 (5-SECOND)
TOTAL STATION. THIS SURVEY MEETS OR EXCEEDS THE ACCURACY AND PRECISION
STANDARDS AS OUTLINED IN W.A.C. 352-150-090.

SCHINNELL SURVEYING & MAPPING, PLLC MAKES NO WARRANTIES TO CLAIMS
OF OWNERSHIP RESULTING FROM UNWRITTEN TITLE SUCH AS BUT NOT LIMITED
TO ADVERSE POSSESSION, ACQUISCEENCE, ESTOPPEL, OR BONA FIDE RIGHTS.

SCHINNELL SURVEYING & MAPPING, PLLC
Professional Land Surveying
918 CENTRALIA COLLEGE BLVD, PO BOX 1614
CENTRALIA, WA 98531
Ph. (360) 736-0394 Fax (360) 736-3009

DRN BY: L. ANDERSON/ZL	DATE: 10-2-13	PROJECT No. 13-145
OK'D BY: K. SCHINNELL	SCALE: 1" = 400'	PG. 1 OF 1

SURVEYORS CERTIFICATE

THIS MAP CORRECTLY REPRESENTS A SURVEY MADE BY
ME OR UNDER MY DIRECTION IN CONFORMANCE WITH THE
SURVEY RECORDING ACT FOR OLYMPIC RESOURCE
MANAGEMENT (HINNERS)
IN SEPTEMBER 2013.

K. B. Schinnell *02-3-2013*
KEVIN B. SCHINNELL, (PLS 35153) DATE

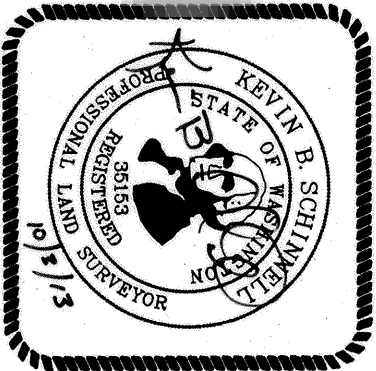

AUDITOR'S CERTIFICATE

FILED FOR RECORD THIS 9 DAY OF Oct., 2013 AT 12:14 PM, UNDER AUDITOR'S
FILE No. 2013002172, AT THE REQUEST OF SCHINNELL SURVEYING &
TIMOTHY TODD BY William Anderson
COUNTY AUDITOR DEPUTY

AUDITOR'S INDEXING DATA
NE 1/4 NE 1/4, NW 1/4 NE 1/4, NE 1/4 NW 1/4, NW 1/4 NW 1/4 6-7N-6E