

After recording, return to (Name, Address, Zip):

Ted Speer
16120 83rd WAY SE
Yelm WA 98597

NOTICE OF MINING LOCATION (Vein or Lode Claim)

Grantor (Locator/Individual): Ted Speer
Grantee (Name of Mine): KAMO
Abbreviated Legal Description: LOAD CLAIM
Assessor's Property Tax Parcel or Account No: 10N 8E Sec 15
Reference No(s) of Documents Assigned or Released:

STATE OF WASHINGTON, County of SKAMANIA
Mining District.

NOTICE HEREBY IS GIVEN that the undersigned locators, each a citizen of the United States or one who has declared an intention to become such, have discovered on 22 September, 2013, a vein or lode of locatable mineral-bearing rock in place upon the public domain of the United States which is open to mineral entry and location within the above state, county and mining district; and in accordance with the laws of the United States and of the State of Washington, have located and do hereby locate a claim upon such vein or lode by posting this notice of such discovery and location on a substantial post or monument at the point of discovery. The name of the claim is: KAMO Claim, further described* as follows:

Commencing at a post marked No. 1;
then 400 feet in a NE 30° magnetic direction to a corner post marked No. 2,
then 500 feet in a NW 300° magnetic direction to a corner post marked No. 3,
then 400 feet in a SW 210° magnetic direction to a corner post marked No. 4,
then 500 feet in a SE 120° magnetic direction to that corner post marked No. 1.
The locators claim 250 feet in a South East direction from the point of discovery to the end line and 200

feet on each side of the middle of the vein or lode, further claiming all the surface rights, privileges and minerals, with all dips, spurs, angles and variations, and other rights granted by existing laws and customs.

This claim is further described as being 0 feet from the following natural object or permanent monument in the vicinity: Discovery Post is 80 feet Northwest of Small Creek Culvert. 250 Feet South of Small Creek Culvert is Post #1 W. side of Road N.E. 29

* This diagram explains method of description of claim.

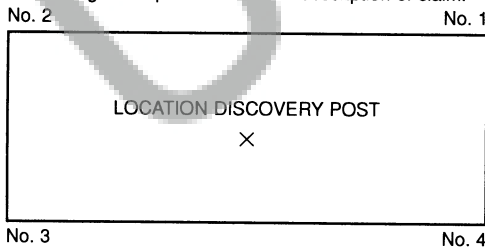

(OVER)



Form No. 284D - Notice of Mining Location (Vein or Lode Claim) ET

© 2007 Washington Legal Blank, Portland, OR www.wlbforms.com

NO PART OF ANY WASHINGTON LEGAL BLANK FORM MAY BE REPRODUCED IN ANY FORM OR BY ANY ELECTRONIC OR MECHANICAL MEANS.

The general course or strike of the vein or lode as nearly as may be determined is multiple vein
in ROAD cut, 50' cut Running NW-SE

with reference to the natural object or permanent monument described above.
This claim is situated in the NE (quarter section) of Section 15, Township
0100N, Range 0080E of the 33 Meridian, as surveyed by the U.S. Govern-
ment or protracted if the land is unsurveyed

The end lines of the claim are parallel to each other. The adjoining claims are NA

This notice is placed conspicuously at the discovery post, and posts are placed at each corner of the claim. The location of this claim is distinctly marked on the ground so that the boundaries of the claim may be readily traced.

Located September 22, 2013.

[Signature] Theodore Speer

Locator(s)

STATE OF WASHINGTON,

County of Skamania } ss.

I certify that I know or have satisfactory evidence that Theodore Speer
is/are the individual(s) who appeared before me, and who
acknowledged that he/she/they signed this instrument and acknowledged it to be his/her/their free and voluntary act
for the uses and purposes mentioned in the instrument.

DATED 10-1-13

[Signature]
Notary Public for Washington
My appointment expires 1-9-2016

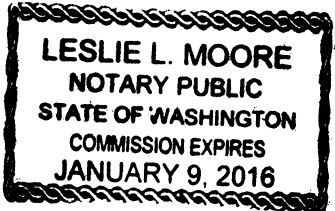

Important Notice: Because applicable state laws determine certain requirements, check with your local State and Federal agencies to ensure that all requirements are met.

MAP OF CLAIMS

TOWNSHIP 10N RANGE 8E SECTION 14 TOWNSHIP 10N RANGE 8E SECTION 15

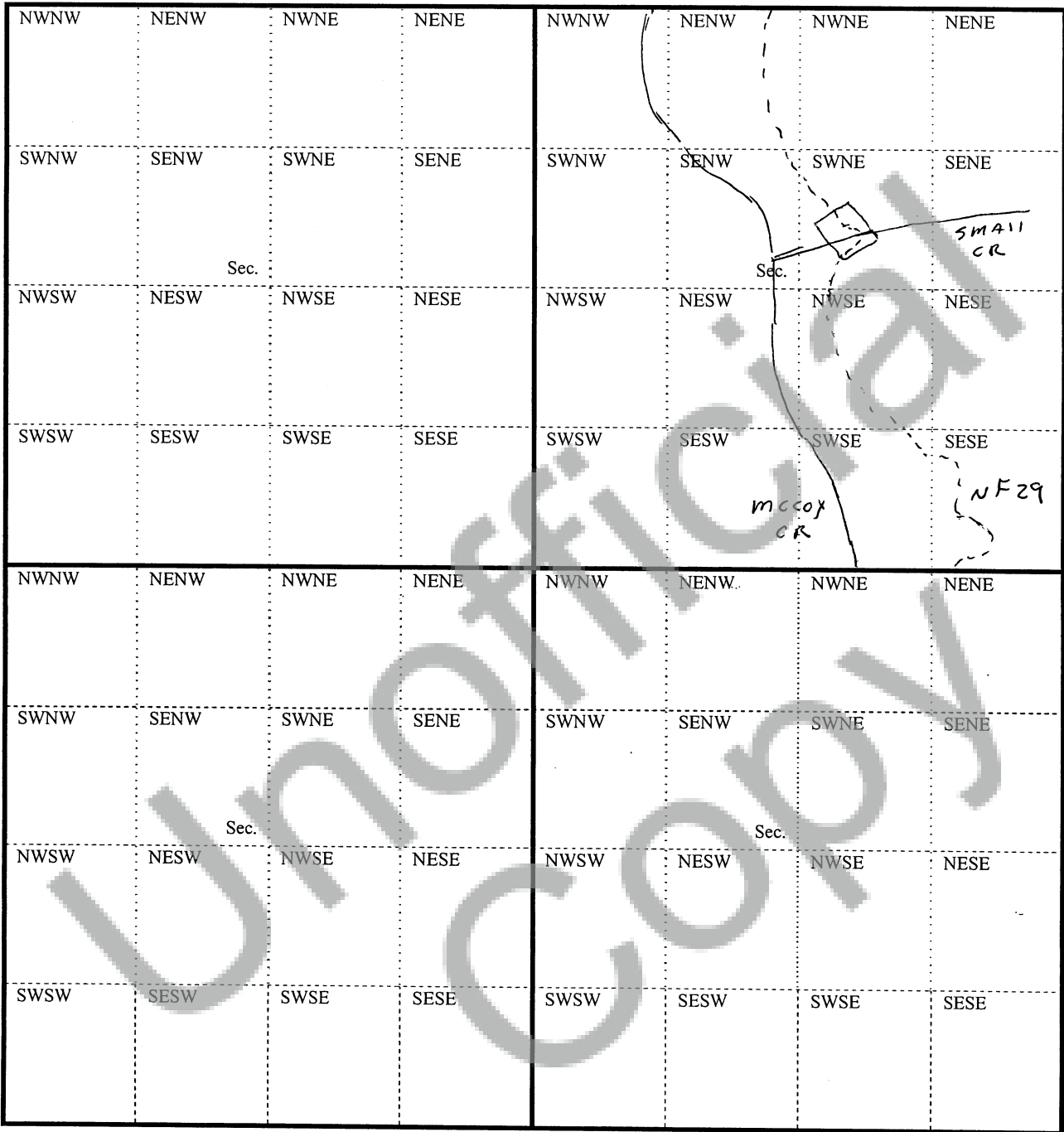

TOWNSHIP 10N RANGE 8E SECTION 21 TOWNSHIP 10N RANGE 8E SECTION 22

WHEN DRAWING YOUR CLAIMS, USE AN ORDINARY RULER.

THE PLAT SCALE : 1/6"=100'