

LAND CORNER MONUMENT RECORD

R. 5 E. LOCATION LC _____

	6	5	4	3	2	1
	7	8	9	10	11	12
T.			●			
1	18	17	16	15	14	13
	19	20	21	22	23	24
N						
	30	29	28	27	26	25
	31	32	33	34	35	36

8	9	10
	●	
17	16	15
20	21	22

TOWNSHIP 1 N RANGE 5 E SECTION 9/16

TYPE OF MONUMENT; TIES TO BEARING TREES, OBJECTS, etc. (SKETCH)

SET 3.5"x30" ALUMINUM MONUMENT WITH CAP
ALL BEARING TREES WERE PAINTED AND SIGNED

CAP DESCRIPTION:

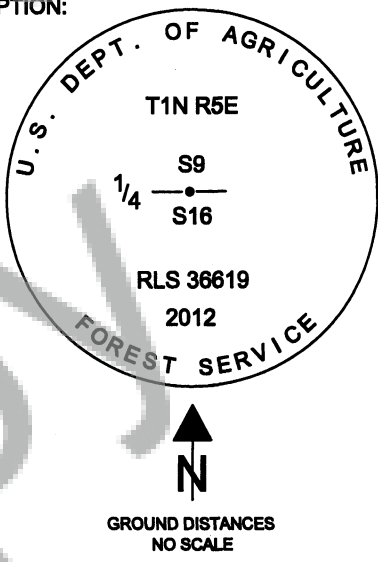
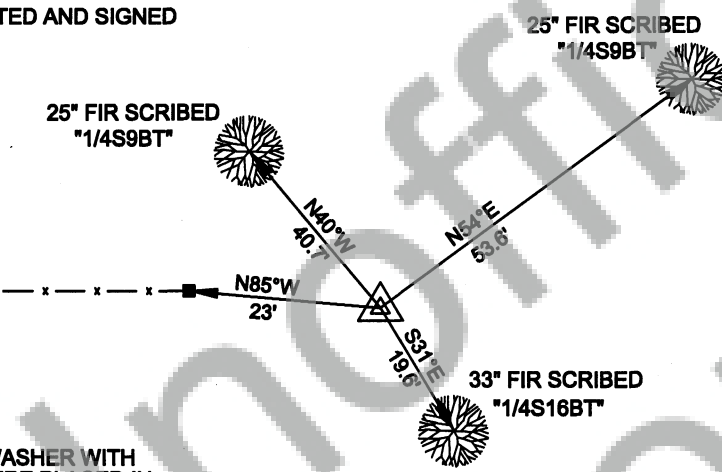

A NAIL AND WASHER WITH "LS 36619" WERE PLACED IN THE SIDE-CENTER OF NEW BT'S

REMARKS: (History of Corner, etc.)

CORNER HISTORY:

GLO 1859- ESTABLISHED BY LEWIS VAN FLEET AND JON NEWSON UNDER CONTRACT No. 47 AND SET A POST FOR 1/4 SECTION CORNER AND THE FOLLOWING BEARING TREES:
A WILLOW, 6" DIAMETER, BEARS N2°W, 36 LINKS
A MAPLE, 7" DIAMETER, BEARS SOUTH, 4 LINKS
1964- FRED WAITE SET AN IRON PIPE FROM CALL TO CREEK 53 CHAINS WEST. NO REFERENCES WERE MARKED. THE PIPE BEARS S85°E, 23 ' FROM AN OLD TIMBER FENCE CORNER. CORNER LIES +/-50 FEET SOUTHWESTERLY OF A SWITCHBACK IN THE CAPE HORN TRAIL. PROPERTY LINE IS POSTED SOUTHERLY FROM CORNER.

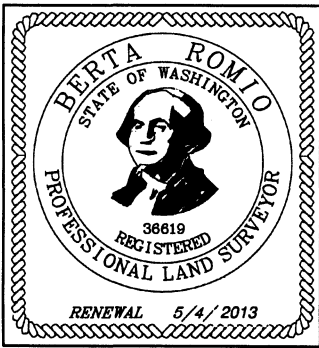

NAME ROBERTA ROMIO
DATE 12/2012
SIGNATURE Berta Romio