

After recording, return to (Name, Address, Zip):

Kelly Butts  
8019 20th Ave E  
Tacoma, WA 98404

<b>NOTICE OF LOCATION OF PLACER CLAIM</b>	
Grantor (Locator/Individual):	(1) Eli Reed (2) Kelly Butts
Grantee (Name of Mine):	Glory Hole
Abbreviated Legal Description:	T10N - R8E - Sec 15 S½ SW¼ SE¼
Assessor's Property Tax Parcel or Account No:	
Reference No(s) of Documents Assigned or Released:	

STATE OF WASHINGTON, County of Skamania, McCoy Creek  
Mining District.

NOTICE HEREBY IS GIVEN that the undersigned locators, each a citizen of the United States or one who has declared an intention to become such, have discovered on Feb 3, 2013, a placer deposit of locatable minerals upon the public domain of the United States which is open to mineral entry and location within the above state, county and mining district; and in accordance with the laws of the United States and of the State of Washington, have located and do hereby locate a placer claim of 20 acres by posting this notice of location on a substantial post or monument in a conspicuous place at the point of discovery inside the boundaries of the claim.

The claim is named the Glory Hole  
Claim, which is described as follows (fill out one of the two sections below):

(1) If location is made in conformity with public surveys: { This claim comprises the S½ SW¼ SE¼ of Section 15, Township 10N, Range 8E, of the Willanette Meridian, Skamania Co Washington

(2) If location is on unsurveyed land; or if on surveyed land and it is not practicable to describe by legal subdivisions: { One substantial post or stone monument appears at each corner of the claim. Starting at \_\_\_\_\_ then in a \_\_\_\_\_ direction \_\_\_\_\_ feet, more or less, to the beginning point of the description of the placer claim hereby located, to-wit: a substantial post or stone monument ("post") set in the ground, marked Post No. 1;  
then 500 feet in a West direction to a post marked No. 2;  
then 660 feet in a North direction to a post marked No. 3;  
then 1320 feet in a East direction to a post marked No. 4;

then 660 feet in a South direction to a post marked No. 5;  
then \_\_\_\_\_ feet in a \_\_\_\_\_ direction to a post marked No. 6;  
then \_\_\_\_\_ feet in a \_\_\_\_\_ direction to a post marked No. 7;  
then \_\_\_\_\_ feet in a \_\_\_\_\_ direction to a post marked No. 8;  
then \_\_\_\_\_ feet in a \_\_\_\_\_ direction to the post marked No. 1.  
This claim is situated in the SE (quarter section) of Section 15,  
Township 10N, Range 8E, of the \_\_\_\_\_  
Meridian, either as surveyed by the U.S. Government or protracted if the land is unsurveyed,

The locators intend to hold and work the above-described claim as provided by the laws of the United States and the State of Washington and claim all of the rights and privileges granted by existing laws and customs.

The adjoining claims are Pay Dirt

Located Feb 3, 2013

[Signature] 3-5-13  
ELI Reed  
[Signature] 3-5-13  
Kelly Butts  
Locator(s)\*

STATE OF WASHINGTON,  
County of Skamania ss.

I certify that I know, or have satisfactory evidence that ELI Reed  
Kelly Butts is/are the individual(s) who appeared before me, and who  
acknowledged that he/she/they signed this instrument and acknowledged it to be his/her/their free and voluntary act  
for the uses and purposes mentioned in the instrument.

DATED 3-5-13

Leslie L Moore  
Notary Public for Washington  
My appointment expires 1-9-2016

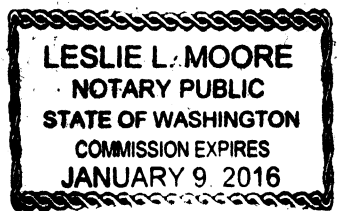

\* If this is an association placer claim, list all individual members of the association and state that they are locating the claim as an association placer claim.

Important Notice: Because applicable state laws determine certain requirements, check with your local State and Federal agencies to ensure that all requirements are met.

Sketch Map of Mining Claim(s)

Signature of Claimant: [Signature] Date: 3-5-13

Claim(s) Number(s): ORMC

Township 10N Range 8E Section 15 State Washington

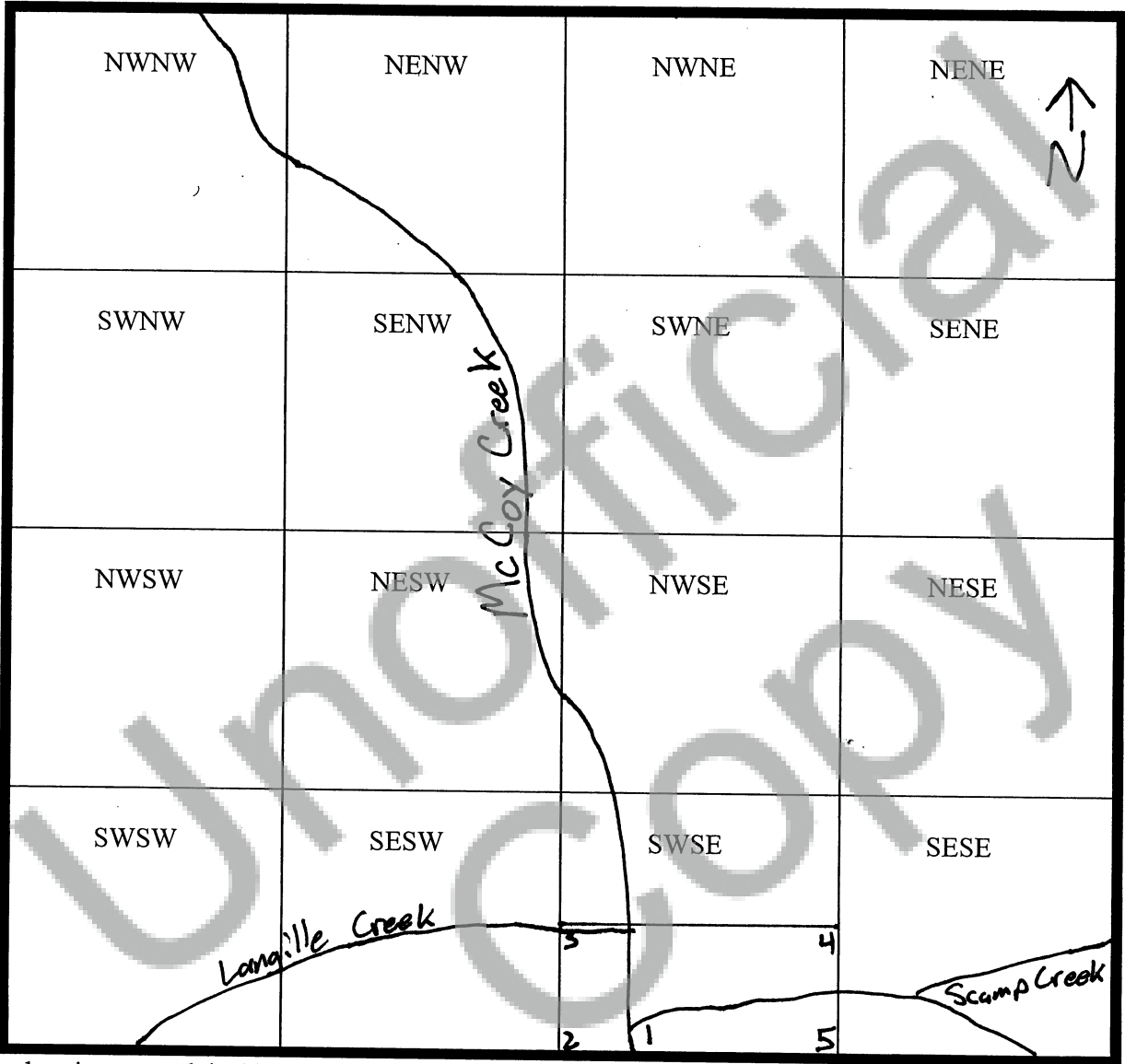

When drawing your claim(s), use an ordinary ruler. 1/8 of an inch equals 100 feet. Therefore a full sized lode claim (600' x 1500') would be 3/4" by 1-7/8". A full size, 20-acre placer claim (660' x 1320' - not an association placer mining claim) would be 1-5/8" by 13/16".