

**Boundary Survey**  
for the  
**US Forest Service**  
located in  
**Section 16, T.1 N., R.5 E., W.M.,**  
**Skamania County, Wa.**

The purpose of this survey was to identify specific boundary lines of acquired National Forest System Lands in the N1/2 of section 16, T. 1 N., R. 5 E., W. M. The Northwest corner and the North 1/4 corner of section 16 were originally set by Van Fleet & Newsum in 1859. There was no record of recovery or perpetuation until 1964, when Floyd Waite (LS2466) set iron pipes for these corners. From survey calls to a creek west of the 1/4 corner and the summit of Mt. Zion, while performing a survey of the Jack D. Collins property in section 8, Records of GLO corner perpetuations in the vicinity of Cape Horn are sparse. County road intersections and fence lines have been used to monument positions in the area. Many other surveys have used LS2466 locations for these corners, and I accept them as the best available evidence of the true locations.

The lots shown were created by an unrecorded survey by Hagedorn Inc. dated February 1973 of Sky Ranch or the Oregon View Tracts. Lot numbers referred to herein do not represent General Land Office government lotting found in an elongated section. The corners shown were located from a combination of GPS positions using Trimble R6 receivers and traditional traverse methods using a Nikon NPL-821 total station. Iron rods were recovered from the N1/4 corner common to sections 9 & 16, southerly, to the northerly RW of SR 141, from the cul-de-sac at the end of Oregon View Road, northerly along the easterly R/W of Oregon View Road; and along the west line of lot 11. Standard USFS aluminum monuments were placed over the recovered monuments as shown. The northwest corner of section 16 was visited and new references marked, but is shown as a calculated position due to OPUS processing failure of GPS observations at this point. Property lines were marked with tree blazes painted red and posted with orange carsonite posts at 150 intervals or less. Corner monuments were referenced by Bearing Trees measured to side center, painted with red bands, Land Survey monument signs nailed to the back, Bearing Tree tags facing the corner, and brass washers with registration number attached to scribed face.

This work was accomplished with the help of students from Clark Community College pursuing a degree in Land Surveying.

## AUDITOR'S CERTIFICATE

Filed for record this 28<sup>th</sup> day of February, 2013  
at 4:30 p.m. in Book 1 of Surveys, at Page 1  
at the request of the U. S. Forest Service. AF 2013 000 3911

(signed) Melvin Jackson  
Deputy County Auditor

## LEGEND

- (XXXXXX)  
 (XXXXXX)  
 \_\_\_\_\_  
 ●  
 □  
 Fd. 5/8" Iron Rod  
 Calculated position  
 Property line blazed and posted  
 with orange carsonite posts  
 Hagedorn Unrecorded Survey  
 Hagedorn Bk.1 P.263

## REFERENCES:

Unrecorded survey by L52466 1964  
Unrecorded survey by Hagedorn, Inc. 1973  
Skamania County survey records  
LCR 9/16 Bk. J P. 11  
Bk. 1 P. 116  
Bk. 1 P. 248  
Bk. 1 P. 263  
Bk. 2 P. 10  
AF 200716440  
AF 2008169859  
AF 2009174355

Skamania County Deed references  
Bk. 82 P. 358  
Bk. 109 P. 26  
Bk. 117 P. 4

## BASIS OF BEARING:

Washington State Plane  
Coordinate System  
South Zone  
NAD83(CORS96 EPOCH 2002)  
OPUS solutions  
Distances are ground distances.  
To convert to grid, multiply by 0.99959435  
Ø angle at the 1/4 corner = -1.1400"

SCALE IN FEET

# SURVEYOR'S CERTIFICATE

This survey was performed at the request of the Columbia River Gorge National Scenic Area manager, (signed) \_\_\_\_\_  
CREGNSA Mgr: \_\_\_\_\_

(signed) \_\_\_\_\_  
CRGNSA Mgt.

**U.S. Forest Service**  
**Columbia Lands Zone**

**Pacific NW Region 6**  
10600 NE 51st Circle  
Vancouver, Wa. 98682  
(360)891-5169  
Job no. CRG 09-05  
Sheet 1 of 2

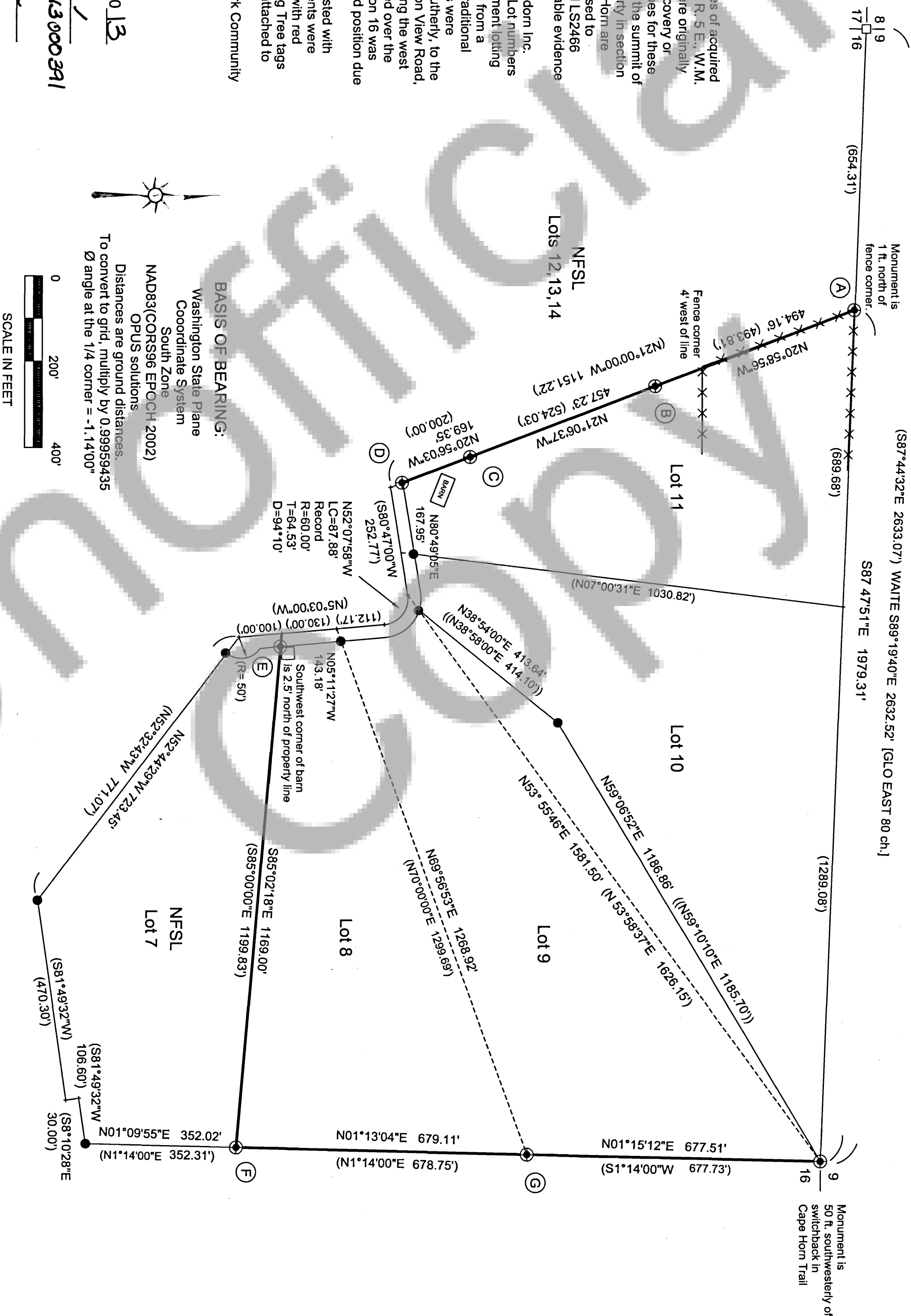
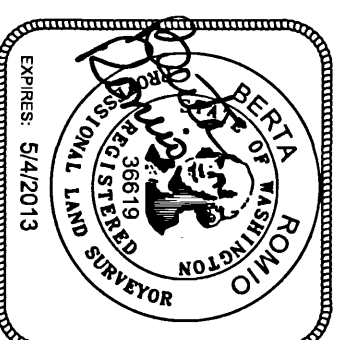



Boundary Survey  
for the  
US Forest Service

located in  
Section 16, T.1 N., R.5 E., W.M.  
Skamania County, Wa.

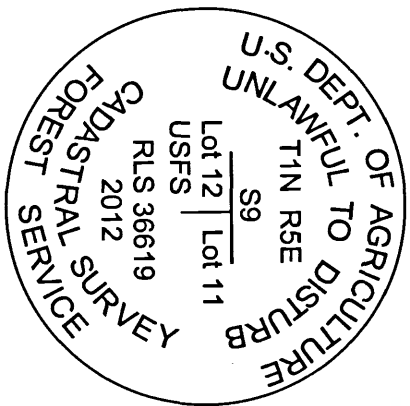

Found 5/8 " iron rod set by Hagedorn 1973. Set standard 3 1/2" x 30" aluminum post with 2 1/2" aluminum cap marked as shown over found iron rod.  
New Refs:  
11" dia. Maple brs. N15°W, 25.8 ft. dist. scribed "S9 BT"  
41" dia. D. Fir brs. S68°E, 67.0 ft. dist. scribed "TL1100 BT"  
23" dia. Alder brs. N2°W, 40.6 ft. dist. scribed "TL1200 BT"  
Corner lies 1 ft. north of fence corner  
Property line posted southerly from corner

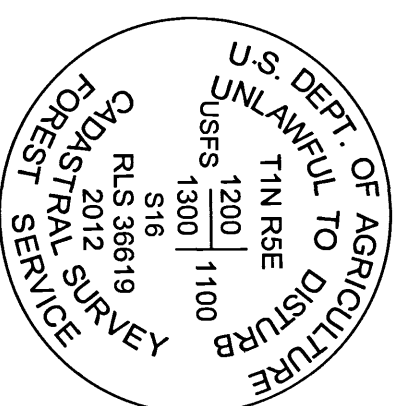

Found 5/8 " iron rod set by Hagedorn 1973. Set standard 3 1/2" x 30" aluminum post with 2 1/2" aluminum cap marked as shown over found iron rod.  
New Refs:  
19" dia. Maple brs. N5°E, 24.7 ft. dist. scribed "1100 BT"  
49" dia. D. Fir brs. S60°W, 75.2 ft. dist. scribed "1300 BT"  
Property line posted north and south from corner.

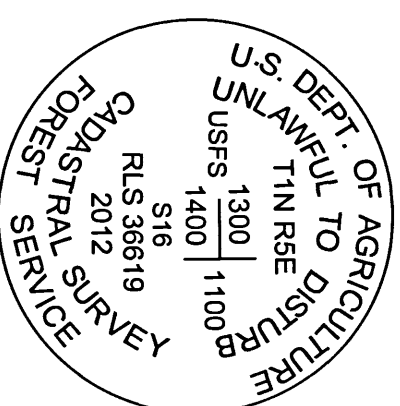

Found 5/8 " iron rod set by Hagedorn 1973. Set standard 3 1/2" x 30" aluminum post with 2 1/2" aluminum cap marked as shown over found iron rod.  
New Refs:  
32" dia. Maple brs. N50°W, 18.5 ft. dist. scribed "1300 BT"  
15" dia. Maple brs. S48°W, 25.8 ft. dist. scribed "1400 BT"  
Northwest corner of barn brs. S56°E, 62 ft. dist.  
Property line posted north and south from corner.

NW corner  
Section 16

Lewis Van Fleet & John Newson 1859 set a post for section corner from which:  
A willow 6" dia brs N75°W 20 lks dist.  
A fir 60" dia. brs. N5°E 50 lks dist.  
A fir 36" dia. brs S46°W 83 lks dist.  
A willow 5" dia brs S53°E 40 lks.

1964 Fred Waite set an Iron Pipe from call to top of Mt. Zion and call to creek 27 ch. east during a survey of the Jack Collins property in Section 8. No references given.

Found the 3/4" Iron Pipe set by F. Waite in 1964, in a east-west fence line between two large timbers, at the east end of a wooden reinforcement structure. Possible opened Alders and Large Firs in the area, but no marks visible.  
Marked new Refs:  
26" dia. Maple brs. S74°E, 40.4 ft. dist. scribed "T1N R5E S16 BT"  
25" dia. Alder brs. N63°W, 29.1 ft. dist. scribed "T1N R5E S8 BT"  
19" dia. Alder brs. N26°E, 27.4 ft. dist. scribed "T1N R5E S9 BT"  
11" dia. Alder brs. S30°W, 29.0 ft. dist. scribed "T1N R5E S17 BT"

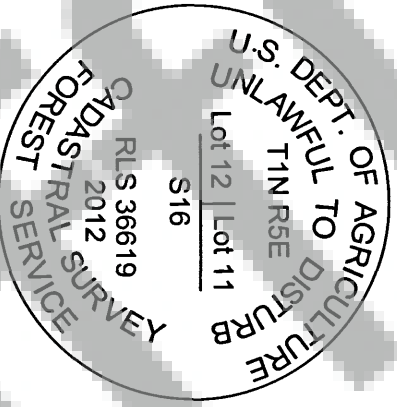

Found 5/8 " iron rod set by Hagedorn 1973. Set standard 3 1/2" x 30" aluminum post with 2 1/2" aluminum cap marked as shown over found iron rod.  
New Refs:  
13" Alder brs. S84°E, 11.4 ft. dist. scribed "X BT"  
22" Alder brs. N21°E, 18.9 ft. dist. scribed "Lot 11 BT"  
33" Maple N49°W, 24.2 ft. dist. scribed "Lot 12 BT"  
Corner lies 15 ft. north of access road.  
Property line posted north from corner.

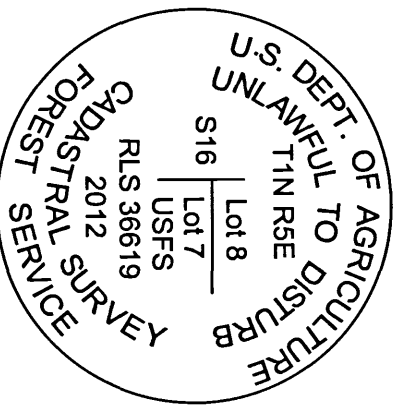

Found 5/8 " iron rod set by Hagedorn 1973. Set standard 3 1/2" x 30" aluminum post with 2 1/2" aluminum cap marked as shown over found iron rod.  
New Refs:  
22" Fir brs. N57°W, 64.7 ft. dist., no marks  
5/8" Iron Rod brs. S67°46'E, 128.55 ft. dist., on line to lots 6 & 7  
Southwest corner of barn brs. N40°E, 3 ft. dist.  
Corner lies 2 ft. westerly of concrete footing.  
Property line posted easterly from corner.

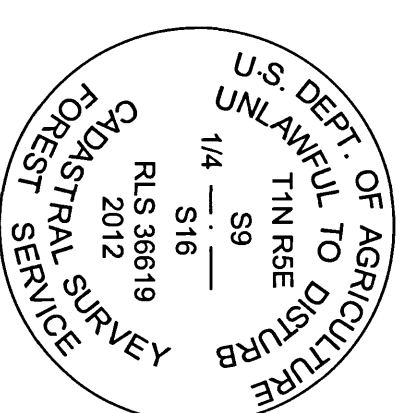

Lewis Van Fleet & John Newson 1859 set a post for quarter section corner from which:  
A Willow 6" dia brs N2°W, 36 lks dist.  
A Maple 7" dia. brs. South, 4 lks. dist.  
1964 Fred Waite set an Iron Pipe from call to creek 53 ch. west.  
No references given.

Fd. 1" Iron Pipe set by F. Waite 1964. Set standard 3 1/2" x 30" aluminum post with 2 1/2" aluminum cap marked as shown prot. 4" in mound of stone, over found pipe.  
Fd. Refs:  
Old timber fence corner brs. N85°W, 23.0 ft. dist.

New Refs:  
25" dia. D. Fir brs. N54°E, 53.6 ft. dist. scribed "1/4 S9 BT"  
33" dia. D. Fir brs. S31°E, 19.6 ft. dist. scribed "1/4 S19 BT"  
25" dia. D. Fir brs. N40°W, 40.7ft. dist. scribed "1/4 S9 BT"  
Corner lies 50' southwesterly of a switchback in the Cape Horn Trail  
Property line posted southerly from corner.

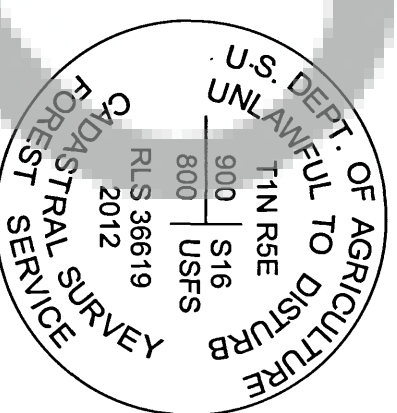

Found 5/8 " iron rod set by Hagedorn 1973. Set standard 3 1/2" x 30" aluminum post with 2 1/2" aluminum cap marked as shown over found iron rod.  
Refs:  
5/8" dia. Iron Rod w/ red plastic FS cap brs. S39°E, 25.8 ft. dist.  
33" dia. W. Fir brs. S82°W, 42.4 ft. dist. scribed "TL800 BT"  
15" dia. Maple brs. N2°W, 40.6 ft. dist. scribed "TL900 BT"  
Property line posted north and south from corner.

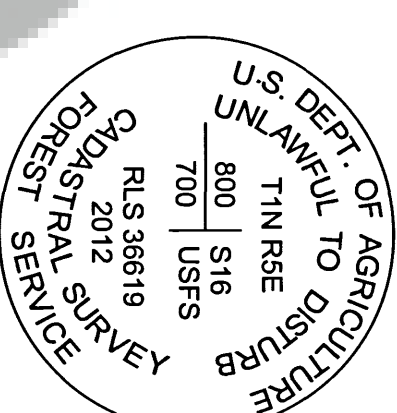

Found 5/8 " iron rod set by Hagedorn 1973. Set standard 3 1/2" x 30" aluminum post with 2 1/2" aluminum cap marked as shown over found iron rod.  
Refs:  
22" Fir brs. N24°E, 45.2 ft. dist. scribed "S16 BT"  
7" dia. Maple brs. S54°W, 17.6 ft. dist. scribed "X BT"  
22" dia. Maple brs. N81°W, 72.2 ft. dist. scribed "TL800 BT"  
Property line posted north and westerly from corner.

NOTE:  
Bearings to Bearing Trees were based on a 17°E magnetic declination. Washers with registration number were attached to scribed faces of all new bearing trees, distances were measured to nail at side center, red bands painted, Land Survey monument signs and Bearing tags attached.

AUDITOR'S CERTIFICATE

Filed for record this 28<sup>th</sup> day of February 2013  
at 4:50 p.m. in Book 1 of Surveys, at Page 1  
at the request of the U. S. Forest Service, AF 2013 000 391

(signed) William Anderson  
Deputy County Auditor

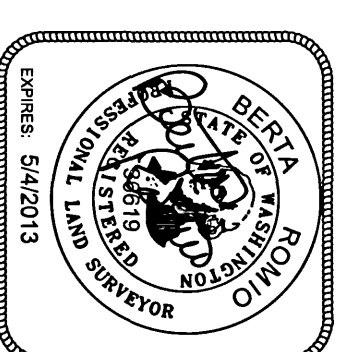

U.S. Forest Service  
Columbia Lands Zone  
Pacific NW Region 6  
10600 NE 51st Circle  
Vancouver, Wa. 98682  
(360) 891-5169  
Job no. CRG 09-05  
Sheet 2 of 2