

When recorded return to:

John Hadley
10315 NE 25th Street
Vancouver, WA 98664

Document: Quit Claim Deed
Grantor: Donna M. Pearson
Grantee: John S. Hadley, Jr.
Legal Desc.: SE ¼ Sec 32-2-6 EWM and NE ¼ Sec 5-1-6 EWM
Serial Nos. 010605000100⁶ and 020632001300^{6,5}

QUIT CLAIM DEED

THE GRANTOR(S), **DONNA M. PEARSON**, for and in consideration of Ten Dollars (\$10.00) and other good and valuable consideration, conveys and quit claims to **JOHN S. HADLEY, JR., a married man in his individual capacity**, the following described real estate, situated in the County of Skamania, State of Washington, together with all after acquired title of the grantor(s) herein:

SEE ATTACHED EXIBITS "A" and "B".

REAL ESTATE EXCISE TAX

29921

JAN 31, 2013

Dated: 1-9, 2013

PAID Exempt
Stacy L. Smith
SKAMANIA COUNTY TREASURER

Donna M. Pearson
Donna M. Pearson

Planning Department - Exemption over
approved by go 1/31/13

QCD Pearson to Hadley Page 1

STATE OF WASHINGTON
COUNTY OF CLARK

SS.

I certify that I know or have satisfactory evidence that Donna M. Pearson is/are the person(s) who appeared before me, and said person(s) acknowledged that they signed this instrument and acknowledged it to be their free and voluntary act for the uses and purposes mentioned in this instrument.

Dated: 01/09/2013

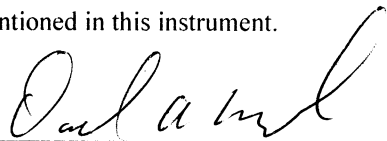

Notary name printed or typed:
Notary Public in and for the State of WASHINGTON
Residing at VANCOUVER,
My appointment expires: 11/15/2014

NOTARY PUBLIC
STATE OF WASHINGTON
DANIEL RENTON
MY COMMISSION EXPIRES
NOVEMBER 15, 2014

Unofficial Copy

Planning Department - Exemption over
20 acres approved by: 901/21/13
QCD Pearson to Hadley Page 2

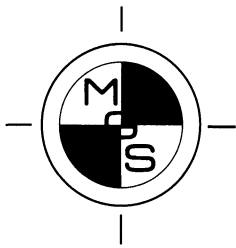

**MINISTER-GLAESER
SURVEYING INC.**

(360) 694-3313
FAX (360) 694-8410
2200 E. EVERGREEN
VANCOUVER, WA 98661

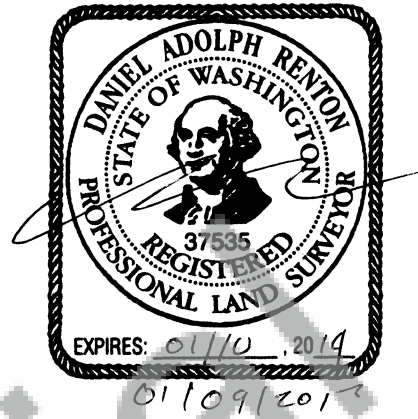

JANUARY 9, 2013

EXHIBIT A

**ADJUSTED
TAX LOT 100**

A parcel of land located in a portion of Government Lots 7 and 8 in the Northeast Quarter of the Northeast Quarter of Section 5, Township 1 North, Range 6 East, Willamette Meridian and also in a portion of the Southeast Quarter of the Southeast Quarter of Section 32, Township 2 North, Range 6 East, Willamette Meridian, Skamania County, Washington;

COMMENCING at the Northeast corner of Section 5, Township 1 North, Range 6 East, said point also being the Southeast corner of Section 32, Township 2 North, Range 6 East;

Thence North 89°10'23" West, along the South line of the Southeast Quarter of Section 32 for a distance of 1317.36 feet to the **TRUE POINT OF BEGINNING**;

Thence leaving said South line, South 57°32'03" West, for a distance of 1157.81 to the Northwest corner of that certain tract of land conveyed to Donna M. Pearson by deed recorded in Book 240, Page 167, records of said county.

Thence South 01°52'48" West, along the West line of the said Pearson tract for a distance of 219.03 feet to the Southwest corner of said Pearson tract, said point also being on the North Right-of-Way Line of State Route 14;

Thence leaving said West line of the Pearson tract and continuing, North 66°25'52" East, along said North Right-of-Way Line for a distance of 620.26 feet to the beginning of a 2914.79 foot radius tangent curve to the right;

Planning Department - Exemption over
20 years approved by: *gd 1/21/13*

Thence continuing along said Right-of-Way Line, along the arc of said 2914.79 foot radius tangent curve to the right for an arc distance of 295.08 feet, through a central angle of $5^{\circ}48'01''$ the long chord of which bears North $69^{\circ}19'52''$ East, for a distance of 294.95 feet;

Thence continuing along said North Right-of-Way Line, North $72^{\circ}13'52''$ East for a distance of 765.10 feet to the beginning of a 1004.93 foot radius curve to the right;

Thence continuing along said Right-of-Way Line, along the arc of said 1004.93 foot radius tangent curve to the right, for an arc distance of 182.18 feet, through a central angle of $10^{\circ}23'14''$, the long chord of which bears North $77^{\circ}25'28''$ East, for a distance of 181.93 feet;

Thence leaving said North Right-of-Way Line of State Route 14, North $00^{\circ}30'32''$ East, parallel with the East line of said Southeast Quarter of Section 32, for a distance of 617.13;

Thence North $89^{\circ}10'23''$ West, parallel with the South line of said Southeast Quarter of Section 32, for a distance of 763.53 feet to the West line of said Southeast Quarter;

Thence South $01^{\circ}11'45''$ West, along said West line, for a distance of 413.01 feet, to the **TRUE POINT OF BEGINNING**.

CONTAINING: 20.00 acres of land, more or less

TOGETHER WITH AND SUBJECT TO: easements, reservations, covenants and restrictions apparent or of record.

BASIS OF BEARING: Record of Survey, Auditors File Number #2006161074

Skamania County Assessor
Date 1-31-13 Parcel 2-6-32-1300

Planning Department - exemption over
20 years approved by: go 1/31/13

AFFIDAVIT TO ACCOMPANY EXCISE AFFIDAVIT

Serial Nos. 010605000100 and 020632001300
Skamania County, WA

John S. Hadley Jr., a married man in his separate capacity, and Donna M. Pearson, together own the two parcels described above. Hadley owns an undivided two-thirds ($\frac{2}{3}^{\text{rd}}$) interest in both parcels, and Pearson owns an undivided one-third ($\frac{1}{3}^{\text{rd}}$) interest in both parcels.

Hadley and Pearson have gone through the Skamania County Planning review process which has allowed them to increase the area of serial no. 010605000100 to 20 acres, with a corresponding decrease in the area of serial no. 020632001300. After the adjustment, both parcels will be recognized as legal lots of record by Skamania County, in accordance with the approval given under case file NSA-10-15, dated June 4, 2012.

In the process of accomplishing the boundary line adjustment, both parties wish to separate their interests, so that each party owns 100% of their respective parcel after the adjustment. Hadley has agreed to Quit Claim his interest in adjusted serial no. 010605000100 to Pearson, and Pearson has agreed to Quit Claim her one-third interest in adjusted serial no. 020632001300 to Hadley. There is no consideration as part of these conveyances.

Dated: 1-9 2013

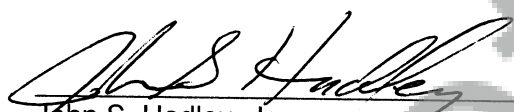
John S. Hadley, Jr.

Donna M. Pearson